

# **PHANTOM X2 Pro 5G**

User Manual

# Explosion diagram specification

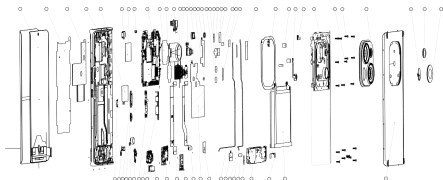

1	LCD&CTP_MODULE	2	MIDDLE_FRAME_HEAT_FILM
3	VC_THERMAL	4	MIDDLE_FRAME
5	PROTECT_FILM_VC	6	FRONT_CAMERA_FRAME
7	REAR_CAMERA_CONDUCTIVE_F OAM_MAIN_50M	8	PL_SENSOR_SILICA_RUBBER
9	MB	10	REAR_CAMERA_CONDUCTIVE_C OPPER_FOIL_MAIN_50M
11	REAR_CAMERA_CONDUCTIVE_C OPPER_FOIL_SUB_50M	12	FRONT_CAMERA
13	REAR_CAMERA_MAIN_50M	14	REAR_CAMERA_SUB_50M
15	REAR_CAMERA_13M	16	RECEIVER_MODULE
17	FLASH_LED_CONDUCTIVE_FOAM	18	RFPA_SHIELDING_HEAT_FILM
19	FRONT_CAMERA_SEAL_FOAM	20	CHG_SHIELDING_COPPER_FOIL
21	PAI_SHIELDING_COPPER_FOIL	22	RECEIVER_CONDUCTIVE_FABRIC
23	REAR_CAMERA_CONDUCTIVE_C OPPER_FOIL_13M	24	REAR_CAMERA_CONDUCTIVE_F OAM_13M
25	FRONT_CAMERA_CONDUCTIVE_ COPPER_FOIL	26	REAR_CAMERA_BTBT_LMMP_FOA M_13M
27	REAR_CAMERA_BTBT_CONDUCTI VE_FABRIC	28	WCN_SHIELDING_COPPER_FOIL
29	PA2_SHIELDING_COPPER_FOIL	30	NFC
31	REAR_CAMERA_DECO_CONDUCT IVE_FOAM	32	FPC_REAR_FLASH
33	FPC_RECEIVER	34	UP_HOUSING
35	SCREW_M1.4*L2.5*D2.5*H0.5	36	SCREW_M1.4*L3.5*D2.5*H0.5
37	REAR_CAMERA_DECO	38	REAR_FLASH_LENS

39	REAR_CAMERA_LENS_13M	40	REAR_CAMERA_LENS_SUB_50M
41	BATTERY_COVER	42	BATTERY
43	COAXIAL_CABLE_CONDUCTIVE_F ABRIC	44	SPEAKER_BOX
45	COAXIAL_CABLE_BLACK	46	LCD_BTBTB_LMMP_CONDUCTIVE_F OAM
47	GND_BTBTB_LMMP_CONDUCTIVE_ FOAM	48	MOTOR_LMMP_FOAM
49	FPC_MAIN_BTBTB_LMMP_FOAM	50	COAXIAL_CABLE_WHITE
51	FPC_RUBBER	52	PMU_SHIELDING_HEAT_FILM
53	FPC_LCD	54	SIM_CARD HOLDER
55	FPC_MAIN	56	SUB_BOARD_SIM
57	USB_RUBBER	58	SUB_BOARD_USB
59	SIDEKEY_FRAME	60	FPC_SIDEKEY
61	SUB_BOARD_ANT	62	MOTOR
63	SIDEKEY_POWER	64	SIDEKEY_VOL
65	FINGER_MODULE	66	SIDEKEY_METAL_STEEL

# Know your phone

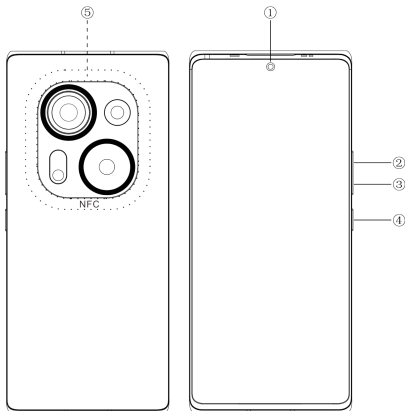

1. Front camera
2. Volume + key
3. Volume - key
4. Power key
5. NFC

# SIM/SD card installation

1. Power off mobile.
2. Refer to the following picture for SIM / SD card installation.

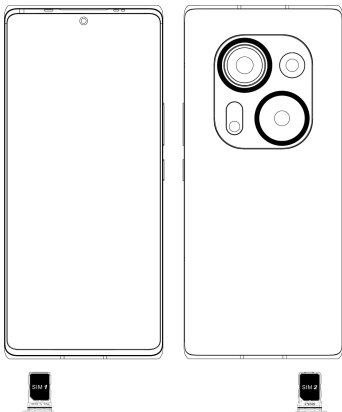

# Charging the phone

You can charge your device using a charger or by connecting it to the computer using a USB cable (comes with the phone).

Use only TECNO charger and cables. Other chargers or cables may damage the device. This will invalidate your phone warranty.

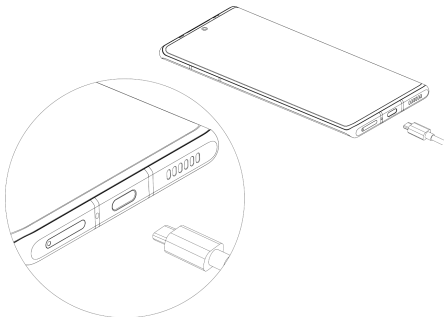

# FCC Caution

## **Labelling requirements.**

This device complies with Part 15 of the FCC Rules. Operation is subject to the following two conditions:

- (1) This device may not cause harmful interference.
- (2) This device must accept any interference received, including interference that may cause undesired operation.

## **Information to user.**

Any changes or modifications not expressly approved by the party responsible for compliance could void the user's authority to operate the equipment.

## **Information to the user.**

Note: This equipment has been tested and found to comply with the limits for a Class B digital device, pursuant to part 15 of the FCC Rules. These limits are designed to provide reasonable protection against harmful interference in a residential installation. This equipment generates uses and can radiate radio frequency energy and, if not installed and used in accordance with the instructions, may cause harmful interference to radio communications. However, there is no guarantee that interference will not occur in a particular installation. If this equipment does cause harmful interference to radio or television reception, which can be determined by turning the equipment off and on, the user is encouraged to try to correct the interference by one or more of the following measures:

- Reorient or relocate the receiving antenna.
- Increase the separation between the equipment and receiver.
- Connect the equipment into an outlet on a circuit different from that to which the receiver is connected.
- Consult the dealer or an experienced radio/TV technician for help.

## **Specific Absorption Rate (SAR) information:**

This mobile phone meets the government's requirements for

exposure to radio waves. The guidelines are based on standards that were developed by independent scientific organizations through periodic and thorough evaluation of scientific studies. The standards include a substantial safety margin designed to assure the safety of all persons regardless of age or health.

FCC RF Exposure Information and Statement The SAR limit of USA (FCC) is 1.6 W/kg averaged over one gram of tissue. Device types: AD9 (FCC ID: 2ADYY-AD9) has also been tested against this SAR limit. The highest SAR value reported under this standard during product certification for use at the ear is 0.781W/kg and when properly worn on the body is 0.321W/kg. This device was tested for typical body-worn operations with the back of the handset kept 10 mm from the body. To maintain compliance with FCC RF exposure requirements, use accessories that maintain a 10 mm separation distance between the user's body and the back of the handset. The use of belt clips, holsters and similar accessories should not contain metallic components in its assembly. The use of accessories that does not satisfy these requirements may not comply with FCC RF exposure requirements, and should be avoided.

### **Body-worn Operation**

This device was tested for typical body-worn operations. To comply with RF exposure requirements, a minimum separation distance of 1.0 cm must be maintained between the user's body and the handset, including the antenna. Third-party belt-clips, holsters, and similar accessories used by this device should not contain any metallic components. Body-worn accessories that do not meet these requirements may not comply with RF exposure requirements and should be avoided. Use only the supplied or an approved antenna.



**TECNO**

HiOS runs on Android™ OS.  
Android is a trademark of Google LLC.