



## Ucam Privacy



- End-to-end Encryption**  
Your live streams and video clips are immediately encrypted "on the edge" by Ucam. Even if breached or intercepted in transit, your content is end-to-end encrypted and private.
- Private Cloud & Storage**  
Monitor your home and enjoy your personal moments with full privacy. Only devices authorized by you can decrypt and view live stream footage and stored video clips from Ucam.
- Data Privacy & Ownership**  
All Ucam content is 100% owned by you - not tennis, not IoTEx, not corporations! With Ucam, you can have peace of mind knowing your data is not being mined, sold, or exposed.
- Secure Blockchain Identity**  
Get protected with blockchain-based identity and secure login. Access to your Ucam device and data is controlled by an uncrackable 256-bit private key stored locally on your mobile device - you are in full control!

## Ucam Features

- 360° & 1080p Full HD**  
Check on your home anytime from anywhere via the Ucam app. View sharp 1080p live stream video directly on your mobile device, with built-in pan, tilt, and zoom for full 360° coverage.
- Motion Detection**  
Whenever Ucam recognizes suspicious activity, a notification is automatically sent to your mobile device and a video clip is saved, which you can view anytime - never miss a thing!
- Two-way Audio**  
Communicate directly with your loved ones with Ucam's built-in speaker and microphone, or listen to crisp, real-time audio to enhance your live stream viewing experience.
- Night Vision**  
Equipped with 8 infrared LEDs, Ucam delivers unparalleled night vision with up to 36 feet of range. Monitor and protect your home and loved ones, even in total darkness.

# Quick Start Guide

tennis

## In The Box

- a. Ucam camera x1
- b. Power adapter x1 & Power cable x1
- c. Wall mount bracket x1
- d. Screws for bracket x2
- e. Wall plugs for bracket x2
- f. Quick Start Guide x1

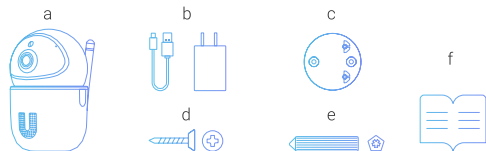

If any contents are missing or damaged, please contact [tennis support](#) immediately for replacement.

## Ucam Specs

Dimensions: 4.2" x 2.6" x 3.4"  
Weight: 8.0 ounces  
Resolution: Full HD 1080p (1920 x 1080)  
Lens: 3.6mm f/2.0  
Pan/Tilt Angle: Horizontal 355° & Vertical 50°  
Infrared LED: 8x IR-LEDs  
Night Vision: Up to 36 feet  
Ethernet: One port at 10/100 Mbps  
WiFi & Security: 2.4 Ghz (WPA, WPA2)  
Power Supply: DC 5V/1A

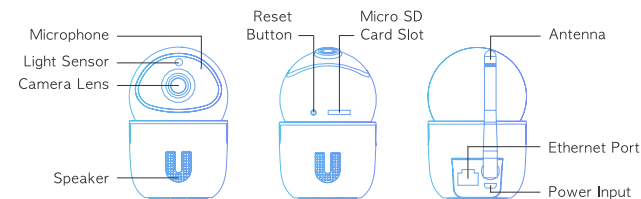

## Quick Setup

- Go to App Store or Google Play to search and download TennisU app or Scan the following QR codes to download TennisU app directly. Compatible with iOS 8.0+ and Android 5.0+.
- Connect the camera to a power outlet and wait for **20-25** seconds until you hear a sound. If there is no sound, press the reset button for 10 seconds until you hear a sound.
- Login to the TennisU app and follow the instructions to finish setup.



TennisU

- Set the camera on a flat surface or wall mount the camera. You are all set!



### WiFi Requirements

**Camera:** Ucam must be connected to 2.4 Ghz WiFi.  
**Phone/Tablet:** During setup, your phone or tablet must be connected to 2.4 Ghz WiFi. After setup, you may use either 2.4 Ghz or 5 Ghz WiFi.  
**Note:** Poor WiFi signal may affect Ucam video quality.

## Need Help?

Tutorial Videos: [tennis.com/tutorial](#)  
Troubleshooting & FAQs: [tennis.com/support](#)  
Warranty & Return Policy: [tennis.com/policy](#)  
Contact us: [support@tennis.com](mailto:support@tennis.com)

More Info



**FCC Statement**

1. This device complies with Part 15 of the FCC Rules. Operation is subject to the following two conditions:

(1) This device may not cause harmful interference.

(2) This device must accept any interference received, including interference that may cause undesired operation.

2. Changes or modifications not expressly approved by the party responsible for compliance could void the user's authority to operate the equipment.

**NOTE:**

This equipment has been tested and found to comply with the limits for a Class B digital device, pursuant to Part 15 of the FCC Rules. These limits are designed to provide reasonable protection against harmful interference in a residential installation.

This equipment generates uses and can radiate radio frequency energy and, if not installed and used in accordance with the instructions, may cause harmful interference to radio communications. However, there is no guarantee that interference will not occur in a particular installation. If this equipment does cause harmful interference to radio or television reception, which can be determined by turning the equipment off and on, the user is encouraged to try to correct the interference by one or more of the following measures:

Reorient or relocate the receiving antenna.

Increase the separation between the equipment and receiver.

Connect the equipment into an outlet on a circuit different from that to which the receiver is connected.

Consult the dealer or an experienced radio/TV technician for help.

This equipment complies with the FCC RF radiation exposure limits set forth for an uncontrolled environment.

This equipment should be installed and operated with a minimum distance of 20cm away from your body.