

iData K3 Pro

User Manual

Version: V1.0

Contents

| | |
|---|-----------|
| 1 Introduction | 1 |
| 1.1 iData K3 Pro appearance | 1 |
| 1.2 Battery charging | 1 |
| 2 How to use iData K3 Pro | 3 |
| 2.1 Turn on/off the device | 3 |
| 2.2 Lock/unlock the device | 3 |
| 2.3 Device buttons | 4 |
| 2.4 Home screen | 5 |
| 2.5 Status icons and indicators | 6 |
| 2.6 Basic settings | 7 |
| 3 Network and connection synchronization | 11 |
| 3.1 Data connection (optional) | 11 |
| 3.2 Wi-Fi network connection | 13 |
| 3.3 Bluetooth | 13 |
| 3.4 Computer connection by USB | 15 |
| 4 iData K3 Pro scan demonstration | 16 |
| 4.1 Install and use iScan Pro | 16 |
| 4.2 iScan Pro configuration | 16 |
| 5 How to manage iData K3 Pro | 18 |
| 5.1 Program software installation | 18 |
| 5.2 Uninstall the installer | 18 |
| 5.3 Manage applications | 19 |
| 6 Precautions and troubleshooting | 20 |
| 6.1 iData K3 Pro precautions | 20 |
| 6.2 Troubleshooting | 21 |

1 Introduction

1.1 iData K3 Pro appearance

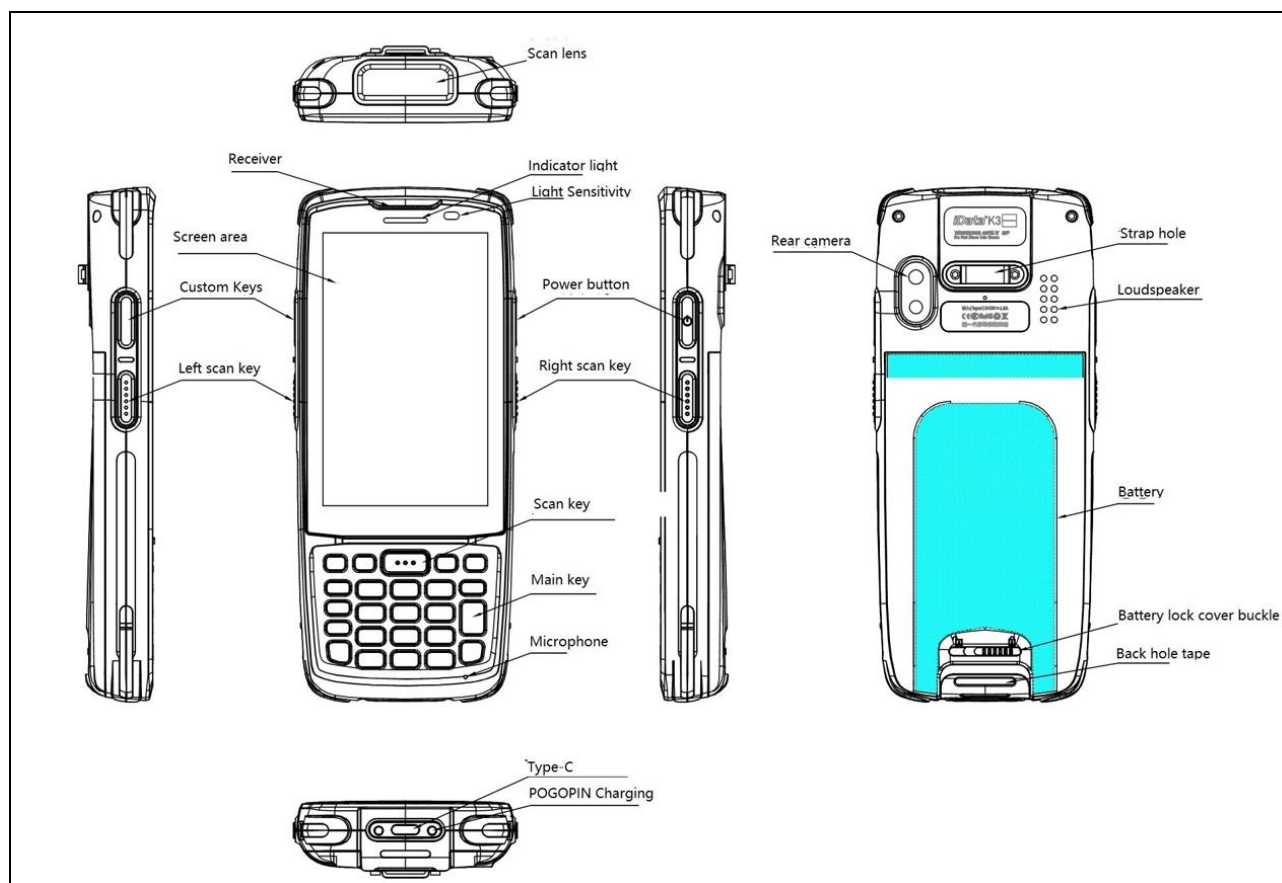

1.2 Battery charging

The battery can be charged by:

Method 1: a USB cable.

Method 2: The bottom charger*.

Method 3: The single charging cradle*.

Method 4: The 4-slot charging cradle*.

Note: Those marked with * need to be purchased separately.

When it's charging, the LED indicator light is red;

When it's fully charged, the LED indicator light turns green;

When the battery is low, iData K3 Pro will display a warning message;
When the battery is too low, iData K3 Pro will shut down automatically .

★ Attention

The battery charging time may be around 3 hours. Interrupted charging will not do damage to the battery. The battery life is determined by the different usage conditions of iData K3 Pro. For example, the usage of different functions, the usage patterns, the variable charging time , and data transfer conditions, etc.

★ Reminder

To ensure that iData K3 Pro has a longer standby time, please follow the tips as below:

- ◆ Connect the device to a DC power supply for charging while it's not in use;
- ◆ Shorten the sleep mode timer in *Settings* (Steps: *Home>Applications>Settings>>Display>Sleep*);
- ◆ Turn off all radio activity, WiFi, Bluetooth, etc. when it's not in use.

2 How to use iData K3 Pro

2.1 Turn on/off the device

After being fully charged, you can start using iData K3 Pro.

1. When turning on the device, press and hold the on/off button in the upper right corner of the device for a few seconds, the device will display the boot screen, and enter the system desktop after the boot progress is completed. It will take some time for device initialization, please wait patiently.
2. When turning off the device, press and hold the on/off button in the upper right corner of the device for a few seconds, and a shutdown option dialog box will pop up, click *Power-Shutdown* to turn off the device.

2.2 Lock and unlock the device

Lock the device

Short press the power on/off key to lock the device. If you do not run the device within the system default or screen lock time, the device will be locked automatically.

Unlock the device

Short press the on/off button, and slide up the unlock option on the main screen to unlock

2.3 Device buttons



iData K3 Pro device has a physical keyboard, 19 buttons in total, as shown in the picture below:

➤ Function keys definition as below

| No. | KeyCode | Definition | Function description |
|-----|----------|------------|--|
| 1 | POWER | Power key | Single click: Turn on/off the screen Short press 3s: Shut down/Restart the menu Long Press 9s: Force restart |
| 2 | BUTTON_1 | Scan key | |
| 3 | BUTTON_2 | Scan key | |
| 4 | BUTTON_3 | Scan key | |
| 5 | BUTTON_7 | PTT key | |
| 6 | BACK | Back key | |
| 7 | HOME | Home key | |

| | | | |
|----|------------|---------------|----------------------|
| 8 | MENU | Menu key | |
| 9 | DPAD_RIGHT | RIGHT | Fn mode: VOLUME_UP |
| 10 | DPAD_DOWN | DOWN | Fn mode: Lightness - |
| 11 | DPAD_UP | UP | Fn mode: Lightness + |
| 12 | DPAD_LEFT | LEFT | Fn mode: VOLUME_DOWN |
| 13 | DEL | Delete key | |
| 14 | ENTER | Enter key | |
| 15 | CAPS_LOCK | Aa Switch | |
| 16 | Code=102 | P1 | No Function |
| 17 | Code=103 | P2 | No Function |
| 18 | Code=105 | | No Function |
| 19 | FUNCTION | Fn Switch key | |

2.4 Home screen

iData K3 Pro device has 1 home screen, which can be switched by sliding up on the screen. Tap the corresponding icon to open the application displayed on home screen.

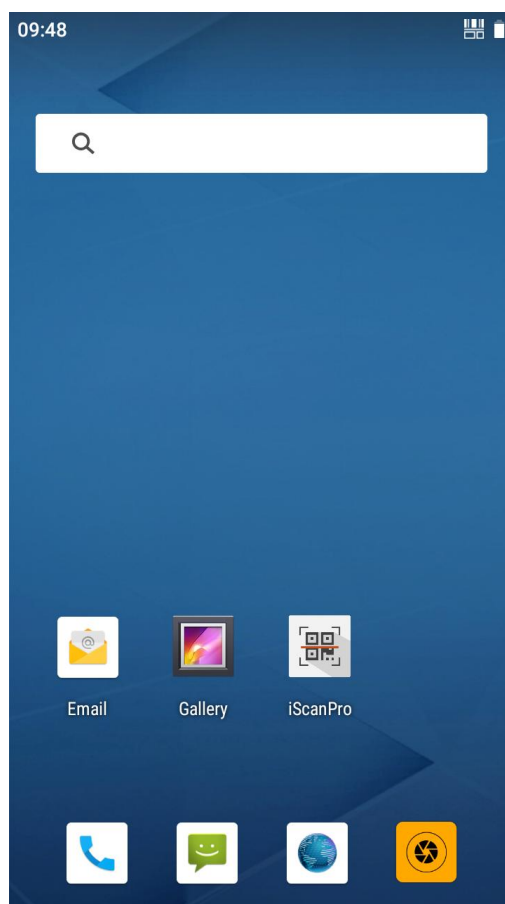

★ Reminder

- You can add or delete program icons on the main screen as you please;
- Tap the application tray to view all APPs.

2.5 Status icons and indicators

The status icons and indicators are located on the status bar at the top of the screen and display device status information and notifications.

Table 2-1 Status icons

| Icon | Description | Icon | Description |
|---|-------------|---|---------------|
|  | WLAN |  | Data signal |
|  | Bluetooth |  | Airplane mode |

| | | | |
|---|------------------|---|------------------------|
|  | USB connection |  | Limited network access |
|  | Battery charging |  | USB debugging |
|  | Fully charged |  | Mute mode |

★ Note

The device software is upgraded constantly, and the status indicator may be different from the ones displayed on screen, please refer to the actual situation.

2.6 Basic setting

2.6.1 Date & Time setting

You can update the date and time on your device if needed.

Find this icon:



->Setting

->System

->Date & Time

->Set the date or Time

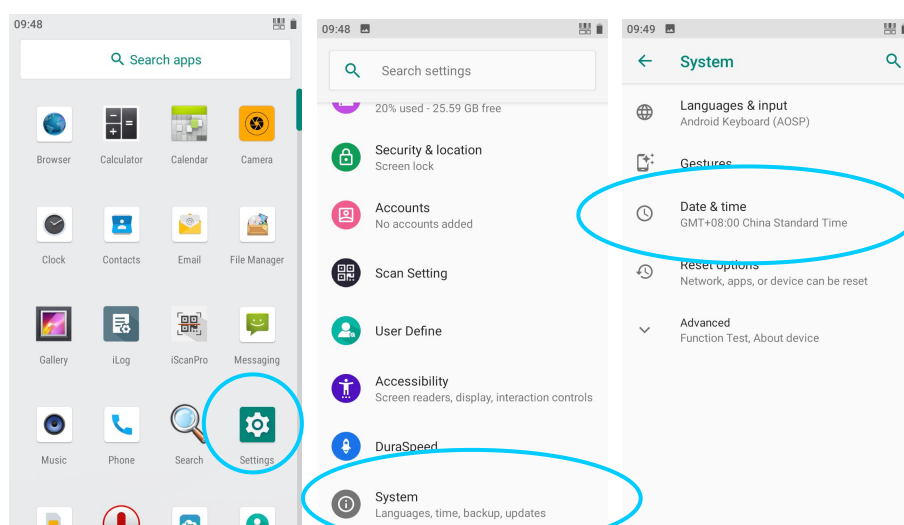

2.6.2 Display setting

Find this icon:



->Setting

->Display

->Lightness/Wallpaper/Sleep

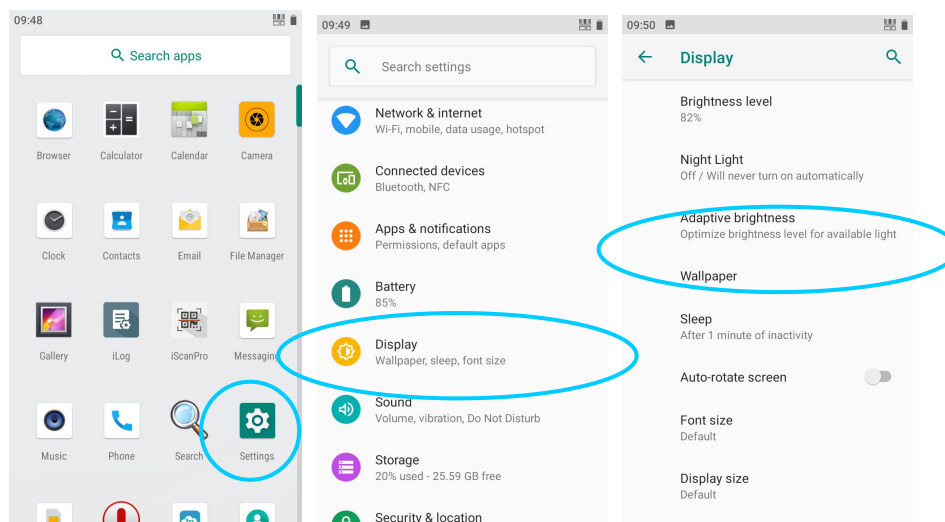

2.6.3 Ringtone setting

Find this icon:



->Setting

->Sounds

->Media/Alert/Ringtone volume

->Click *Advanced* to enter the next level of Sounds general settings

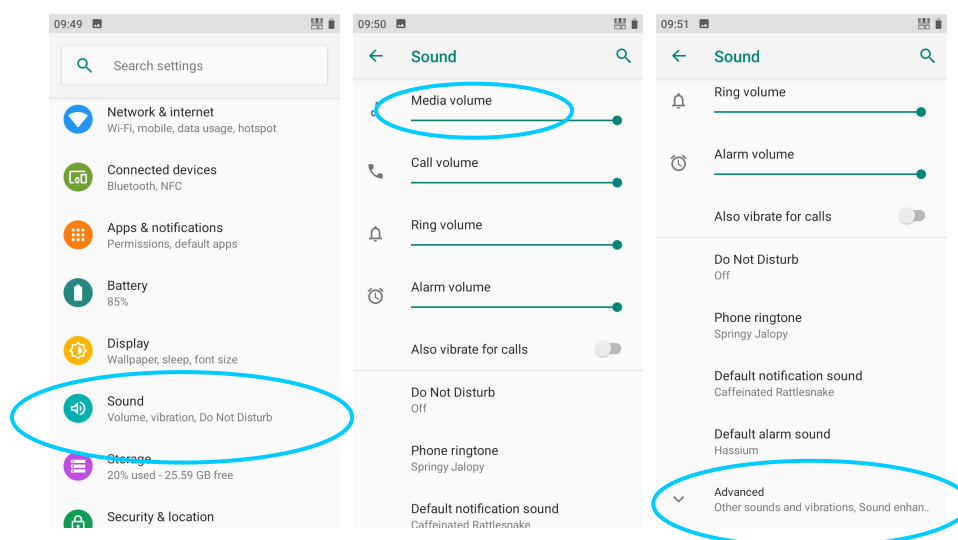

2.6.4 Safety setting

Find this icon:



- >Setting-System
- >Reset option
- >Clear all data
- >Reset to factory settings

Click *Clear all data*, the device will be reset to factory settings.

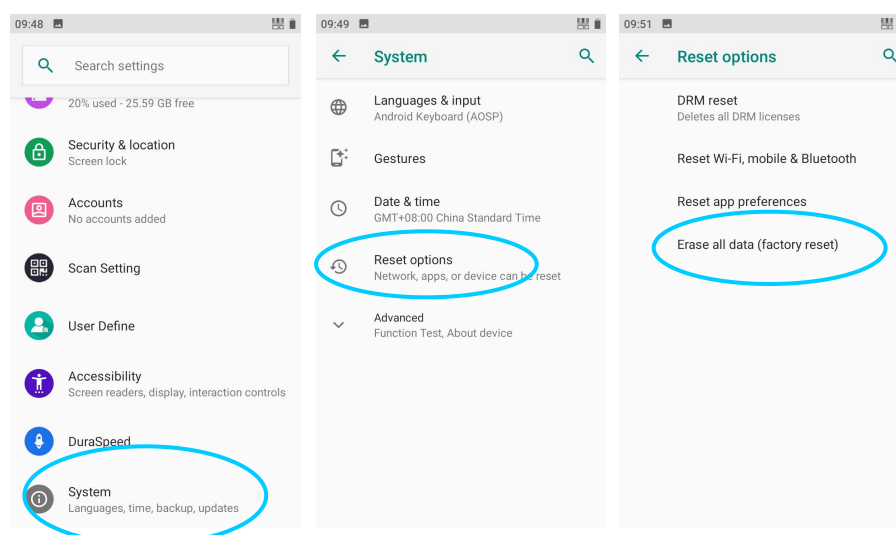

★ Reminder

This operation will erase the following data from the device:

- ♦ Account
- ♦ System and application data and settings
- ♦ Downloaded apps

The following data will not be cleared:

- ♦ Current system software and bundled apps

2.6.5 Language & Keyboard setting

Find this icon:



->Setting

->System

->Language & Keyboard

->Click *Language* and select the desired language from the list

->Click *Default* and select the desired keyboard from the list

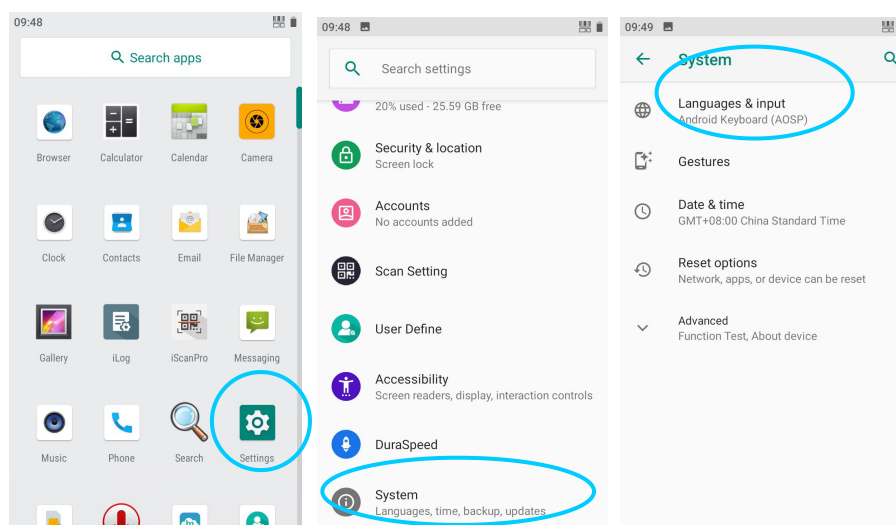

2.6.6 Shortcut

A shortcut icon can be added to home screen.

Click *Application Tray* on home screen, press and drag the desired icons to home screen.

3 Network and Connection Synchronization

3.1 Data connection(optional)

Network configuration

The network has been configured by factory setting. If it is deleted accidentally, you can manually select the network through software configuration.

Find this icon:



- >Setting
- >Network & Internet
- >Mobile network settings
- >Preferred network type

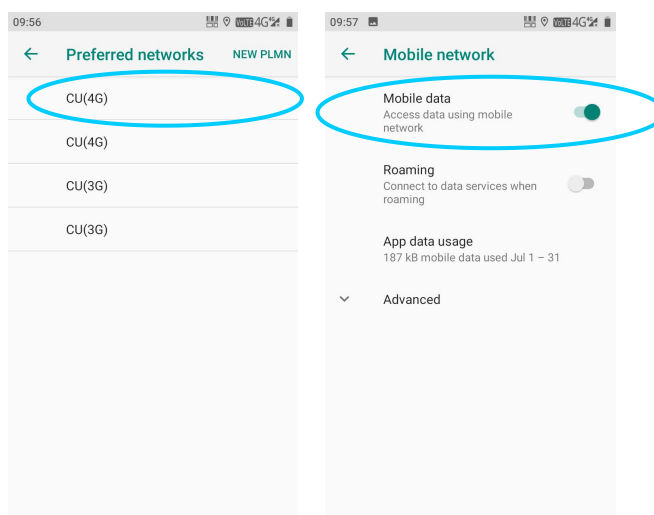

Set up a GPRS data connection to access the Internet

To set up a GPRS data connection, please make sure that the SIM card is preset in iData K3 Pro and the data connection function has been activated. Generally, the network has been configured by factory setting. If it is deleted accidentally, you can set the network per following instructions. We take *China Mobile* as an example.

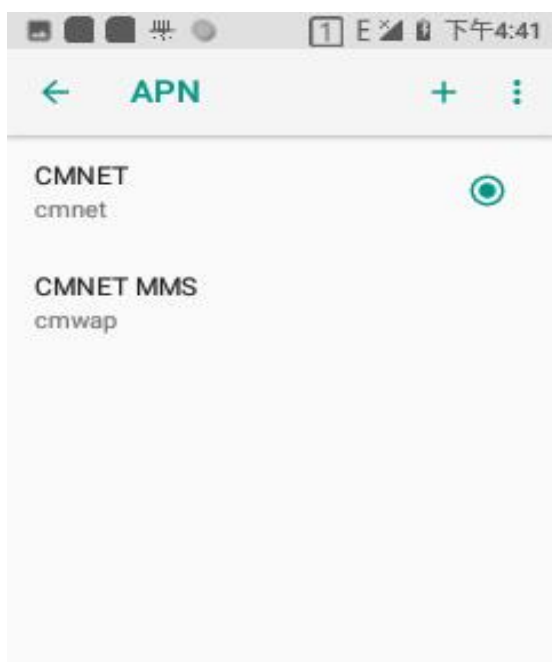

Name: CMNET

APN: cmnet

APN type: default, supl,net

Agent: Empty

Interface: Empty

User name: Empty

Password: Empty

Server: Empty

MMSC: Empty

MMS proxy: Empty

MMS interface: Empty

MCC: 460

MNC: 02

ID verification type: Empty

APN protocol: IPv4

APN Enable/Disable: APN enable

Bearer system: Empty

3.2 Wi-Fi Network connection

Find this icon:



->Setting

->Network & Internet

->WLAN

1. Click *WLAN off/on* button to turn it on and search for the network. If the WLAN is turned on, click *Scan*, and the device will list the networks within the search range;
2. Click the network to be connected, and enter the password in the pop-up password dialog box;
3. Click *connect* to complete the WiFi connection.

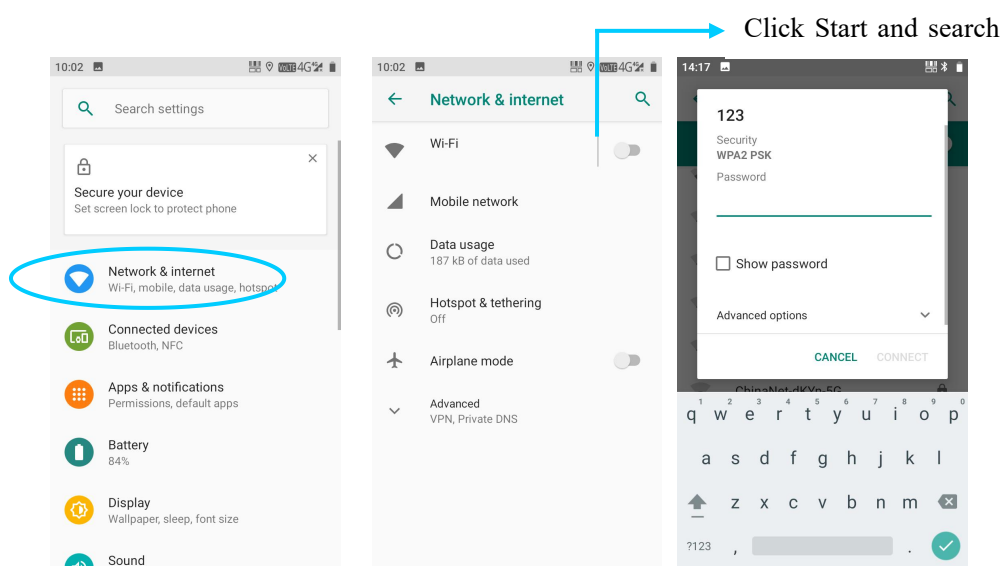

3.3 Bluetooth

Turn on the Bluetooth function in your device to establish a wireless connection and exchange information with other Bluetooth compatible devices (such as computers, mobile phones). The Bluetooth connection performs better when there are no solid obstacles in the range.

Find this icon:



->Setting

->Connected device

->Bluetooth

1. Click the *Bluetooth off/on* to turn on and search for other Bluetooth devices;
2. Click the desired device to pair in the searched list;
3. Enter the pairing code in the pop-up dialog box, click OK to connect the device;

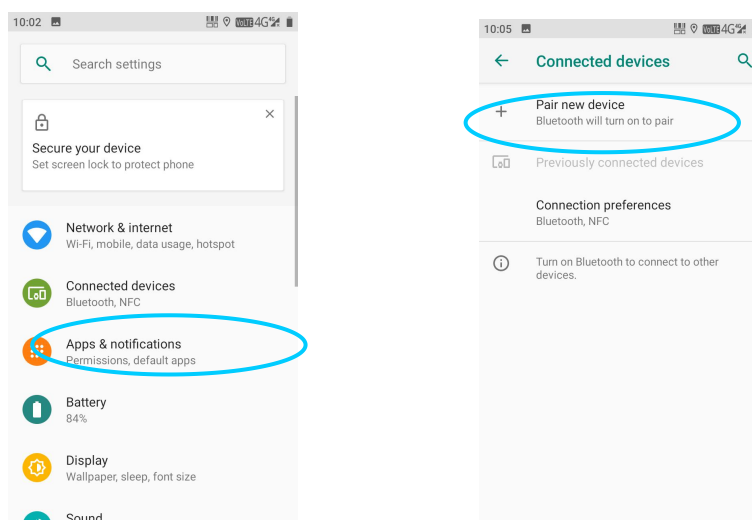

4. Click the *setting* on the right side of *connected device*, and you will see the options of *Escape* and *file transfer*, you can choose your desired operations.

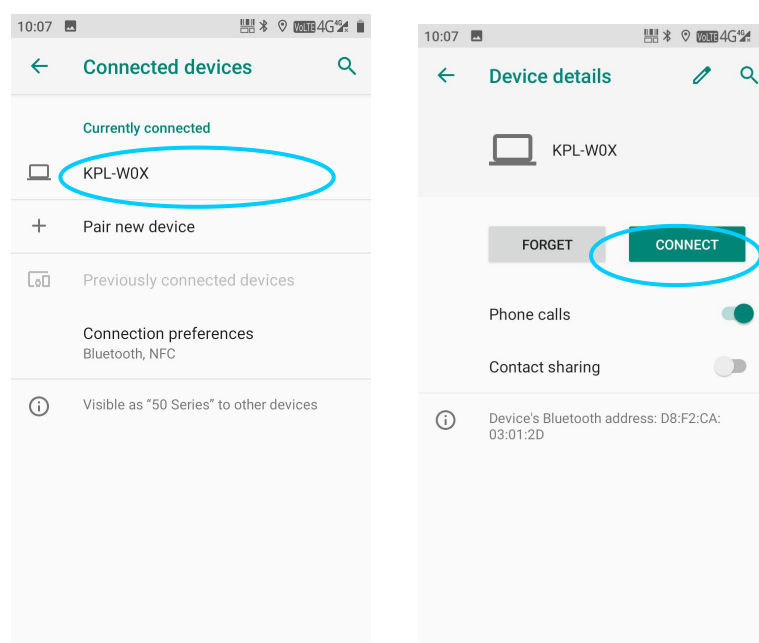

★ Reminder

- ♦ Make sure that the device to be connected with iData K3 Pro has enabled the Bluetooth function and turned on the Bluetooth visibility.
- ♦ During the connection process, please set the pairing code, this device does not support connection without passwords.

3.4 Computer connection by USB

Using a USB cable to connect the device to the computer can facilitate the transfer and processing of files such as pictures, videos, music between the device memory card and the computer.

1. Use a USB data cable to connect the device to the USB port of the computer;
2. The USB connection icon will be displayed in the device status bar, slide down the status bar, you can see the USB connection status, and you can choose the USB connection mode.

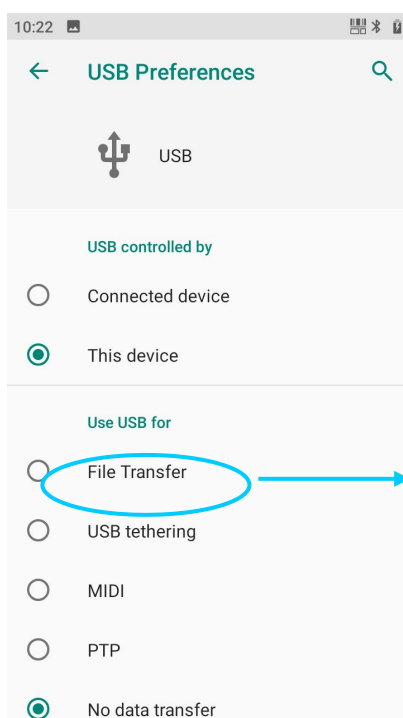

Click this option to open the USB storage device and copy files between your computer and device

4 iData K3 Pro Scan demonstration

4.1 Install and use iScan Pro

Before collecting data, you need to activate the scanning application on your device. Currently, iData K3 Pro manufacturer provides a demo scanner *iScan Pro* for free to obtain and decode barcode information.

Click to start the "*iScan Pro*" application on the desktop of iData K3 Pro, enter the scan test interface after startup, press the scan button or click the scan code function below to start scanning.

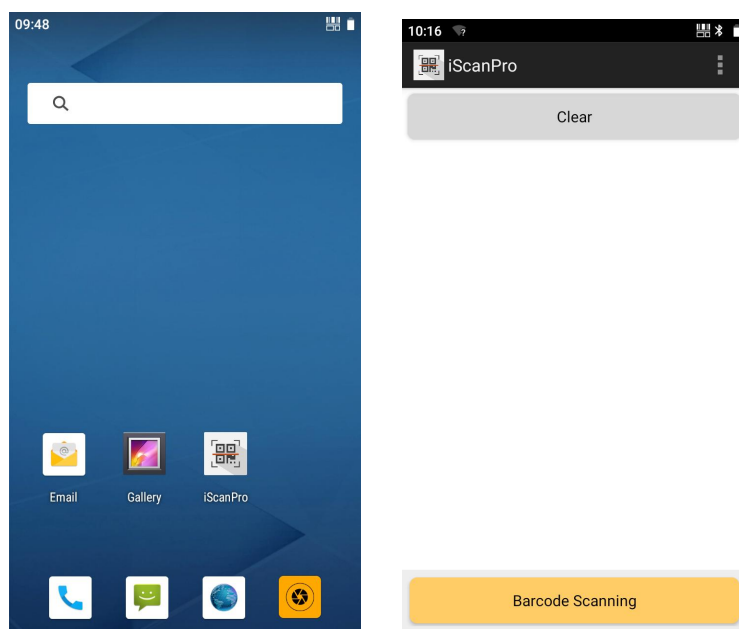

4.2 iScan Pro configuration

To collect data, make sure that the scanning application *iScan Pro* is properly started.

Find this icon:



->Setting

->Scan setting

->Input password: default 654321

->Enter scan setting

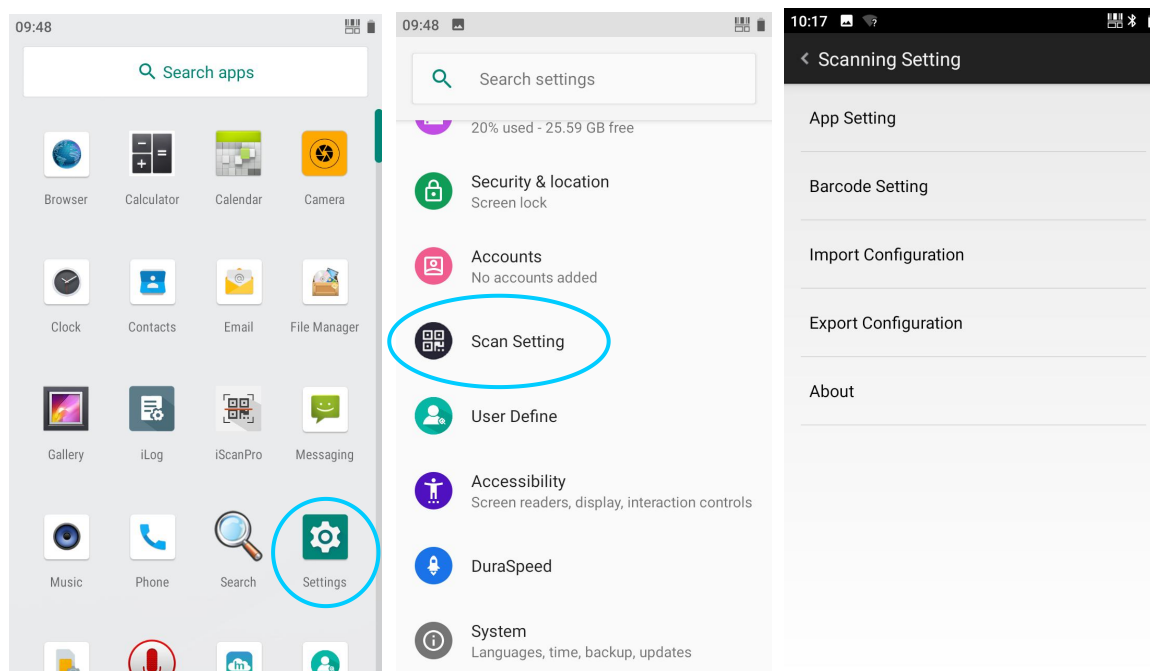

5 How to manage iData K3 Pro

5.1 Program software installation

iData K3 Pro adopts the Google Android operating platform, and the Android software suffix is apk. There are a few methods for iData K3 Pro to install the program software:

1. You can download the software installation package, and then use the *file manager* to install it.
2. You can log in to the iData MDM system and upload the software installation package in the system for push installation.

5.2 Uninstall the installer

You can uninstall the unnecessary program software to increase the operating speed of the device. Here are a few methods for your reference.

1. Go to Settings->Applications and Notifications, select the program software to be uninstalled in the pop-up application list, click the software, enter the application program information interface, then in the application program information interface, click *Uninstall*, and enter the next step to uninstall, click *Confirm*, and wait a few seconds until it's completed.
2. You can click the *application tray* to open the application interface, find the icon of the application that needs to be uninstalled, long press the icon and drag it to the *Trash* to uninstall the program.

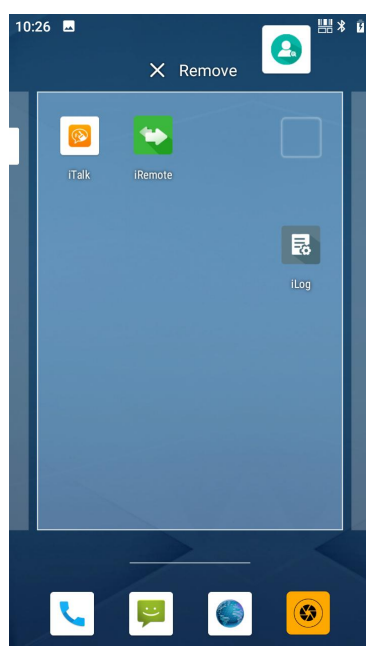

5.3 Manage applications

Users can enter the "Settings - Application and Notification" menu to enter the application management interface, and view the status of the program, for example: *Downloaded*, *In the memory card*, *Running*, etc.

They can also click the program to open the application information Interface, then they are able to perform operations such as force stop, uninstall, and deactivation of the program.

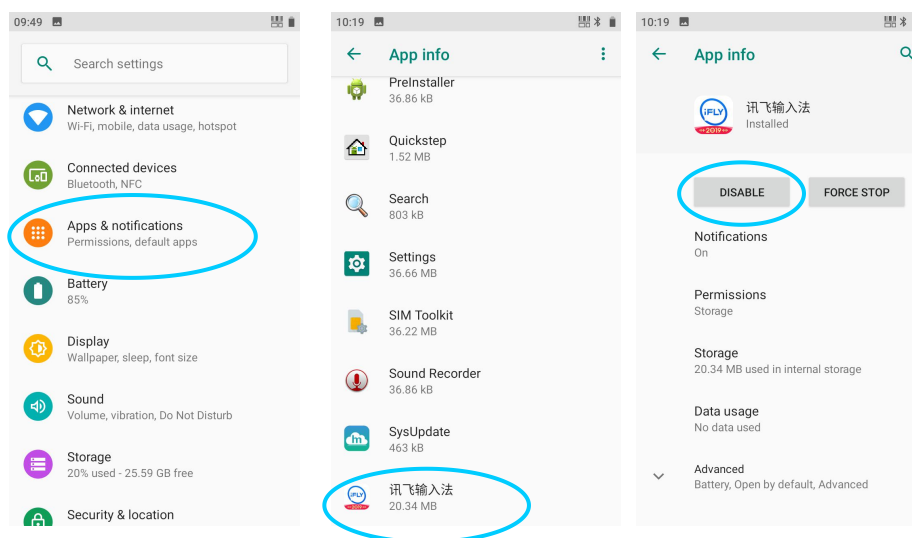

6 Precautions and Troubleshooting

6.1 iData K3 Pro precautions

In order to ensure that the device does not fail, please follow the tips below when using iData K3 Pro:

- ✧ Keep the device, its parts and accessories out of the reach of children.
- ✧ Keep the device dry. Rain, moisture, and liquids contain acids that can corrode electronic circuit boards.
- ✧ Do not store or use the device in dusty or unclean places.
- ✧ Do not store the device in an overheated place, high temperature will shorten the life of electronic components.
- ✧ Do not store the device in a place that is too cold, when the temperature of the device rises, moisture will generate from inside which may damage the circuit board.
- ✧ Do not attempt to disassemble the device, non-professional disassembly will damage the device.
- ✧ Do not touch the screen surface of iData K3 Pro with pens, pencils or other sharp objects to avoid scratching the screen.
- ✧ Do not throw, knock or strongly hit the device. Rough handling of the device will damage the components of the device and may cause device failure.
- ✧ Do not use harsh chemicals or strong detergents to clean the device. If the device becomes dirty, use a soft cloth dampened with a diluted glass cleaner solution to clean the surface.
- ✧ Please use a protective film to minimize wear and tear. Screen protectors increase the usability and durability of touch control screen.

Battery Safety Guidelines

- ✧ The device charging area must be kept away from debris, flammable materials or chemicals.
- ✧ When charging the battery, the temperature of the battery and the charger must be between (0°C~40°C).
- ✧ Do not use incompatible chargers. Using incompatible chargers may cause fire, explosion, leakage or other dangerous accidents.
- ✧ Do not disassemble, crush, twist, puncture or cut the battery.
- ✧ Do not short-circuit the device, or touch the battery terminals with metal or other conductive objects.
- ✧ Do not insert foreign objects into the device, expose the battery to water or other liquids, or expose the device to open flames, explosion sources, or other hazards.
- ✧ Do not place or store the device in an environment with excessive temperature.
- ✧ Do not place the device in a microwave or dryer.
- ✧ Do not throw the device into fire.

- ✧ If the battery leaks, do not let the liquid get on the skin or eyes. If it gets in by accident, please wash the contacted part with plenty of running water and seek medical advice immediately.

How to clean iData K3 Pro

- ✧ **Housing**
Use an alcohol cloth to wipe the housing, including each key and the area between the keys.
- ✧ **Screen**
The screen can be wiped with an alcohol wipe, but make sure no excess liquid around it. Dry the screen immediately with a soft, fiber-free cloth to prevent streaks on the device.
- ✧ **Scan window**
Wipe the scan window regularly with lens tissue or suitable optical cleaning materials.

6.2 Troubleshooting

Table 7-1 iData K3 Pro troubleshooting

| Problem | Possible cause | Solution |
|---|---|---|
| After pressing the power button, iData K3 Pro does not turn on | Battery is low or not charging | Charge iData K3 Pro |
| | System breakdown | Reset to factory setting |
| Chargeable battery doesn't charge | Battery failure | Replace the battery |
| | Battery temperature too high/low | Put the device in room temperature environment |
| During data communication, no data was transmitted or the transmitted data was incomplete | Wrong cable configuration | Reach out to the system admin |
| | Incorrect configuration or installation of communication software | Perform the installation or reinstall the synchronization software to update the driver |
| The function can not be activated by clicking | System is not responding | Restart the system |
| No sound | Volume is too low or closed | Adjust the volume |
| K3 shut down | iData K3 Pro is inactive | iData K3 Pro will lock screen when it's not in use |
| | Run out of battery | Connect charging cradle to charge |
| K3 operation becomes slow | Too many files stored in K3 | Delete unused memos and records. If necessary, keep these recordings on the main unit (or use a memory card to increase storage capacity) |
| | Too many applications installed in K3 | Delete user-installed applications in K3 to restore memory. |
| K3 doesn't decoding | No scanning application | Load the scanning application in iData K3 |

| Problem | Possible cause | Solution |
|---------|-----------------------------|---|
| | loaded | Pro |
| | The barcode is not readable | Make sure the barcode is complete |
| | Low battery life | If there's no beam when pressing the trigger, check the battery level |

Table 7-2 Bluetooth troubleshooting

| Problem | Possible cause | Solution |
|---|---|---|
| iData K3 Pro can not find any Bluetooth device nearby | Too far away from other Bluetooth devices | Move the device closer to other Bluetooth devices, within 10 meters |
| | Nearby Bluetooth devices not turned on | Turn on the Bluetooth mode of the devices |
| | The Bluetooth device is not in visible mode | Set the Bluetooth device into visible mode |
| Bluetooth devices are visible but not connectable | This machine does not support connections without passwords | Set passwords for Bluetooth devices |

Table 7-3 Cable troubleshooting

| Problem | Possible cause | Solution |
|--------------------|-------------------|------------------|
| Not able to charge | Bad cable contact | Change the cable |

Table 7-4 WI-FI connection troubleshooting

| Problem | Possible cause | Solution |
|-----------------------|---------------------------------------|------------------------------|
| Can not connect to AP | "ID verification failed" is displayed | WLAN Password is not correct |

FCC Certification

This device complies with part 15 of the FCC Rules.

Operation is subject to the following two conditions:

- (1) This device may not cause harmful interference, and
- (2) this device must accept any interference received, including interference that may cause undesired operation.

NOTE: This equipment has been tested and found to comply with the limits for a Class B digital device, pursuant to part 15 of the FCC Rules. These limits are designed to provide reasonable protection against harmful interference in a residential installation. This equipment generates, uses and can radiate radio frequency energy

and, if not installed and used in accordance with the instructions, may cause harmful interference to radio communications. However, there is no guarantee that interference will not occur in a particular installation. If this equipment does cause harmful interference to radio or television reception, which can be determined by tuning the equipment off and on, the user is encouraged to try to correct the interference by one or more of the following measures:

- Reorient or relocate the receiving antenna.
- Increase the separation between the equipment and receiver.
- Connect the equipment into an outlet on a circuit different from that to which the receiver is connected.
- Consult the dealer or an experienced radio/ TV technician for help.

Warning: Changes or modifications to this unit not expressly approved by the part responsible for compliance could void the user's authority to operate the equipment.

RF Exposure Information (SAR)

This mobile phone meets the government's requirements for exposure to radio waves. This phone is designed and manufactured not to exceed the emission limits for exposure to radio frequency (RF) energy set by the Federal Communications Commission of the U.S. Government. The exposure standard for wireless mobile phones employs a unit of measurement known as the Specific Absorption Rate, or SAR. The SAR limit set by the FCC is 1.6 W/kg. Tests for SAR are conducted using standard operating positions accepted by the FCC with the phone transmitting at its highest certified power level in all tested frequency bands.

Although the SAR is determined at the highest certified power level, the actual SAR level of the phone while operating can be well below the maximum value. This is because the phone is designed to operate at multiple power levels so as to use only the power required to reach the network. In general, the closer you are to a wireless base station, the lower the power output.

The highest SAR value for the model phone as reported to the FCC when tested for use at the ear is 1.02 W/kg, in hotspot mode is 1.35 W/kg, and when worn on the body, as described in this user guide, is 1.06 W/kg (Body-worn measurements differ among phone models, depending upon available accessories and FCC requirements.)

While there may be differences between the SAR levels of various phones and at various positions, they all meet the government requirement.

The FCC has granted an Equipment Authorization for this model phone with all reported SAR levels evaluated as in compliance with the FCC RF exposure guidelines. SAR information on this model phone is on file with the FCC and can be found under the Display Grant section of www.fcc.gov/oet/ea/fccid after searching on FCC ID: 2ADE3IDATAK3PRO .

For body-worn operation, this phone has been tested and meets the FCC RF exposure guidelines for use with an accessory that contains no metal and positions the handset a minimum of 1 .5 cm from the body. Use of other accessories may not ensure compliance with FCC RF exposure guidelines. If you do not use a body worn accessory and are not holding the phone at the ear, position the handset a minimum of 1 .5 cm from your body when the phone is switched on.

© 2022 **WUXI IDATA TECHNOLOGY CO., LTD.** All rights reserved.

This guide is the user manual of iData K3 Pro series products provided by **WUXI IDATA TECHNOLOGY CO., LTD.**, based on the existing information. We do not guarantee that the content of this guide is completely in line with the latest status, so we reserve the rights to modify it at any time without notice.

Without the written permission of **WUXI IDATA TECHNOLOGY COMPANY LTD.**, no one is allowed to reproduce, extract, back up, modify, disseminate, translate into other languages, or transfer all or part of this guide for commercial use.

Should you have any questions about the equipment, you can email to marketing@idataglobal.com

WUXI IDATA TECHNOLOGY CO., LTD.

Address: Floor 11, Building B1, Wuxi (Binhu) National Sensing Information Center,
No.999 Gaolang East Road, Wuxi City, Jiangsu Province ,P.R.C.

E-mail: sales@idataglobal.com

Website: www.idataglobal.com