

Starter Robot Kit Bluetooth Version

Robot Tank
Three-Wheeled Robot Car

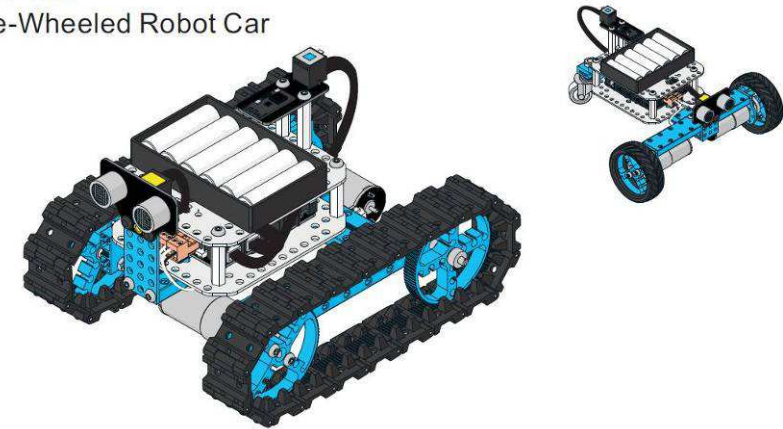

FCC Information

This equipment has been tested and found to comply with the limits for a Class B digital device, pursuant to Part 15 of the FCC Rules. These limits are designed to provide reasonable protection against harmful interference in a residential installation. This equipment generates, uses, and can radiate radio frequency energy and, if not installed and used in accordance with the instructions, may cause harmful interference to radio communications. However, there is no guarantee that interference will not occur in a particular installation. If this equipment does cause harmful interference to radio or television reception, which can be determined by turning the equipment off and on, the user is encouraged to try to correct the interference by one or more of the following measures:

- Reorient or relocate the receiving antenna.
- Increase the separation between the equipment and receiver.
- Connect the equipment into an outlet on a circuit different from that to which the receiver is connected.
- Consult the dealer or an experienced radio/TV technician for help.

If you cannot eliminate the interference, the FCC requires that you stop using your product. Changes or modifications not expressly approved by the party responsible for compliance could void the user's authority to operate the equipment. This device complies with Part 15 of the FCC Rules. Operation is subject to the following two conditions: (1) this device may not cause harmful interference, and (2) this device must accept any interference received, including interference that may cause undesired operation.

| | |
|-------------------|---|
| Product | Makeblock Starter Robot Kit (Bluetooth Version) |
| Model | 90020 and 90021 |
| Responsible Party | Company Name: MAKER WORKS TECHNOLOGY INC Address: 385 S. LEMON AVE., #E276 WALNUT, CA 91789, USA |
| Phone | 323-908-8554 |



Parts List Pictures for reference only

| | | |
|--------------------------|------------------------------|--------------------------|
| 1x Beam 0824-96 | 2x Shaft Collar 4mm | 6x Nylon Stud M4x30 |
| 1x Beam 0824-128 | 4x Flange Bearing 4x8x3mm | 12x Plastic Rivet R4060 |
| 2x Beam 0824-144 | 2x BaseBracket | 6x Plastic Rivet R4120 |
| 1x Bracket 3x3 | 1x Battery Holder for (6) AA | 30x Plastic Ring 4x7x2mm |
| 1x Plate 3x6 | 1x Hex Screwdriver | 2x DC Motor-25 |
| 1x Bracket P3 | 1x Cross Screwdriver | 1x Makeblock Orion |
| 1x Caster Wheel | 2x Hex Allen Key | 1x Me Ultrasonic Sensor |
| 2x DC Motor-25 Bracket | 1x Wrench | 1x Me Bluetooth Module |
| 2x Shaft Connector 4mm | 22x Screw M4x8 | 1x Micro USB cable |
| 4x Timing Pulley 90T | 12x Screw M4x14 | 1x 6P6C RJ25 Cable-20cm |
| 2x Tire 68.5x22mm | 3x Nut M4 | 1x 6P6C RJ25 Cable-35cm |
| 38x Track | 1x Nut M8 | |
| 38x Track Axle | 8x Headless Set Screw M3x5 | |
| 2x Threaded Shaft 4x39mm | 8x Screw M3x8 | |

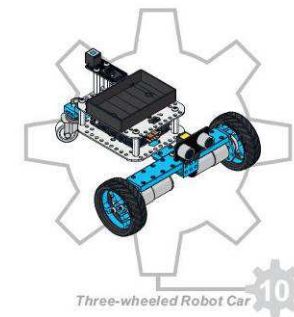

Please visit
http://wiki.makeblock.cc/index.php/Makeblock_Robot_Starter_Kit
to view the programming guide.

Building the Robot Tank

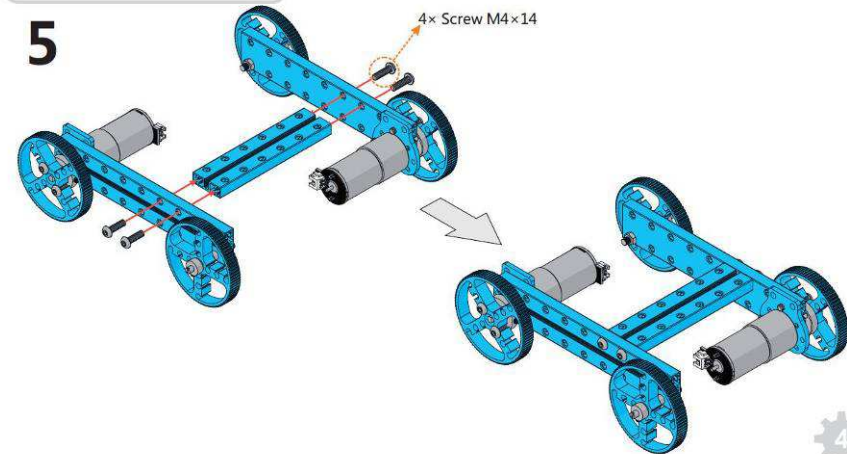
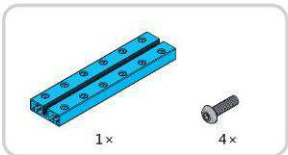
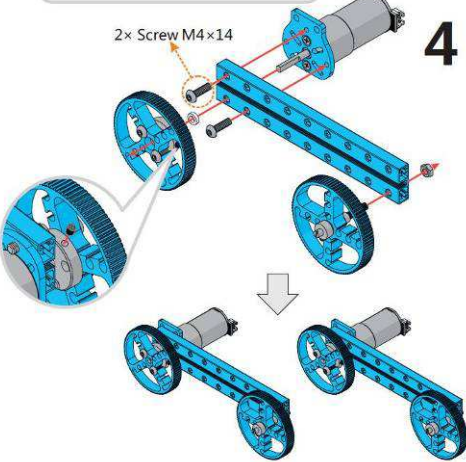
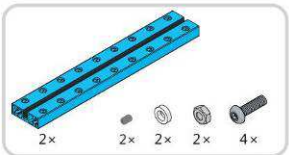
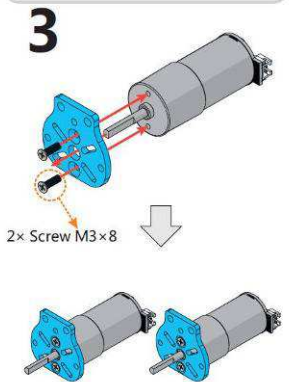
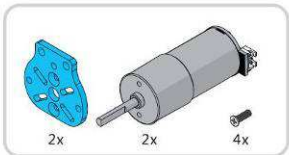
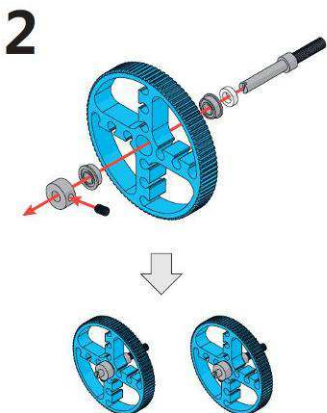
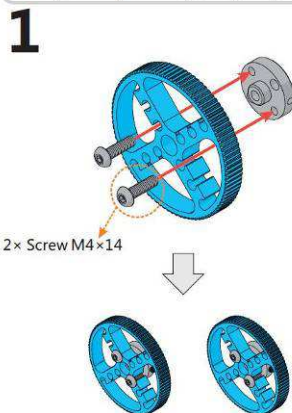
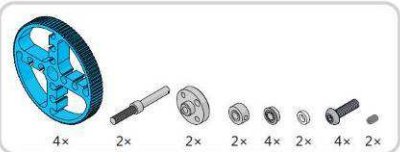
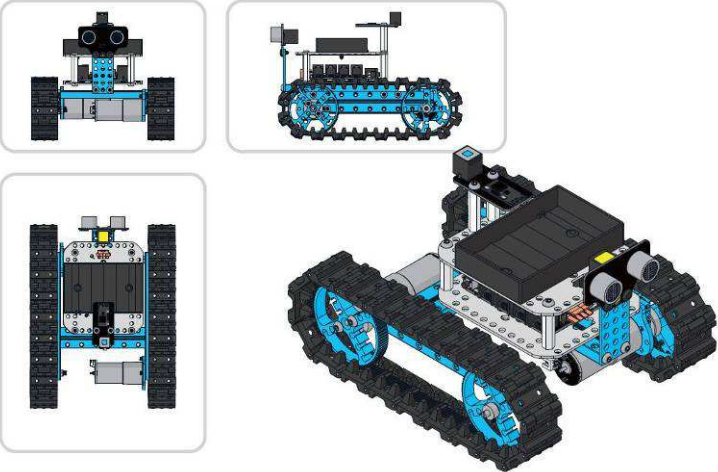



6

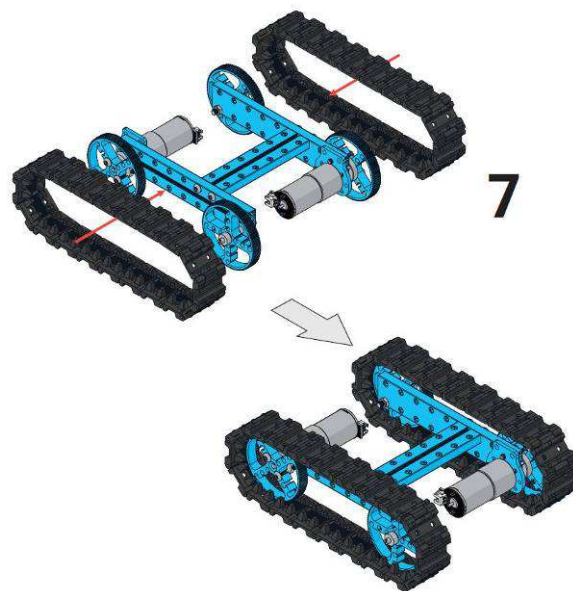
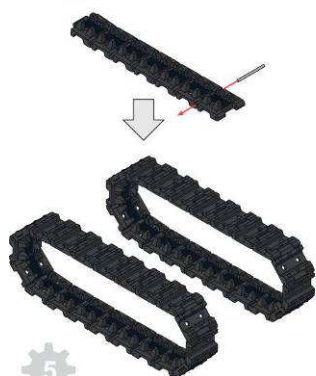

7

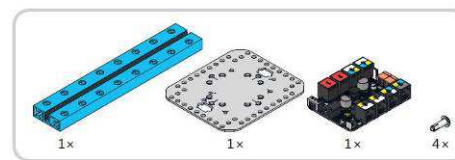

8

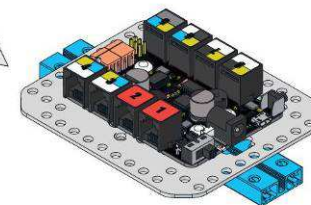
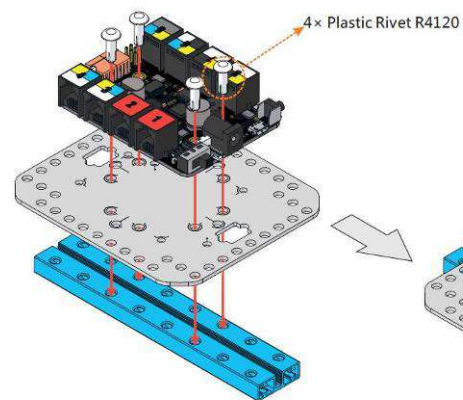

6

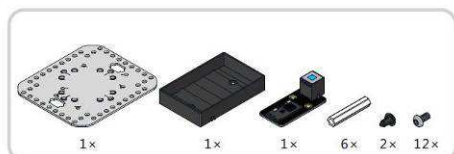

9

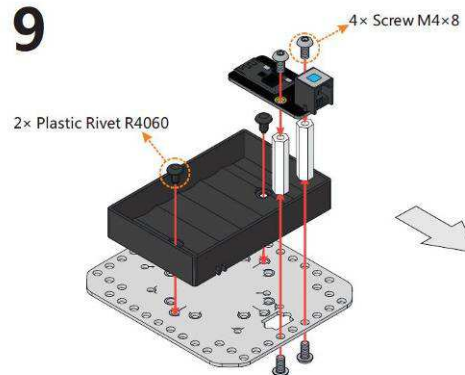

10

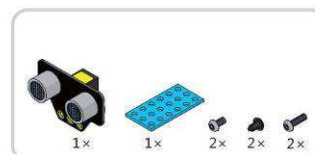
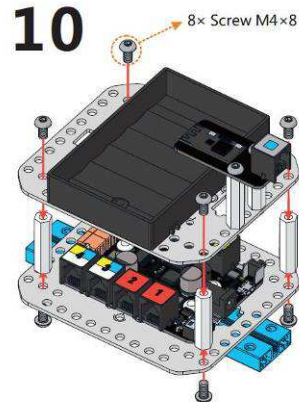

11

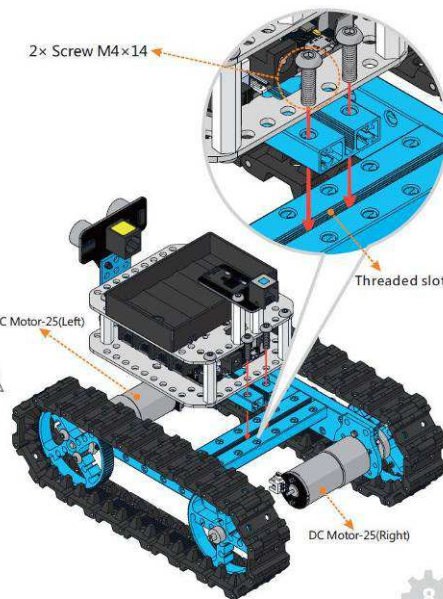
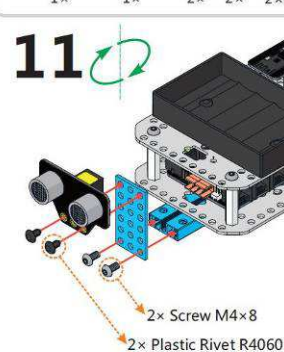

8

Wiring and Programming

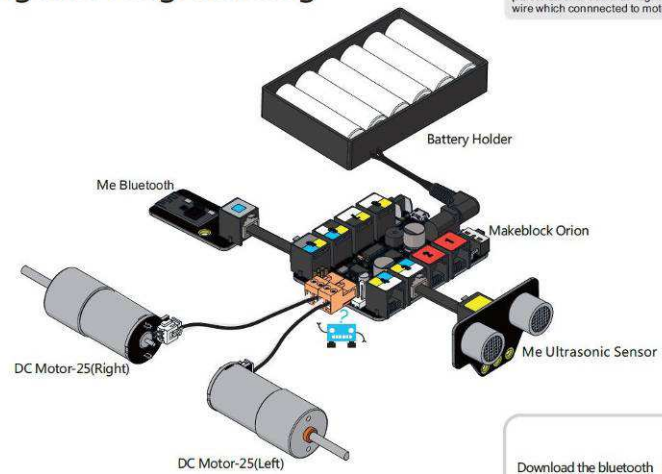

Download the bluetooth control App by scanning the QR code



You may need to switch the order of two wires to correct the rotation direction.

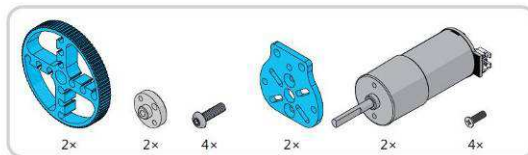

1

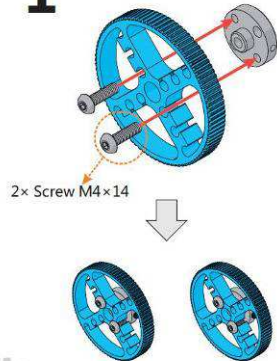

2

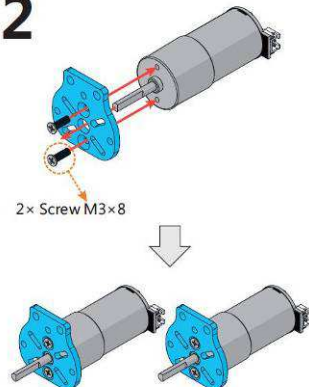

Building the Three-Wheeled Robot Car

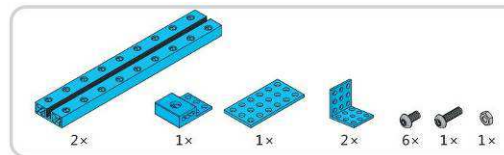
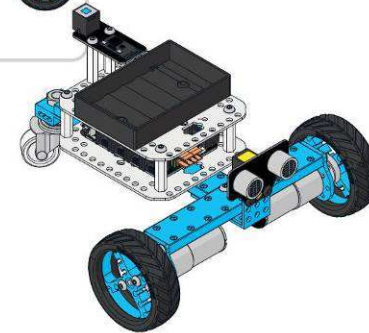
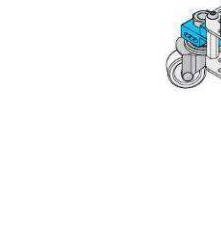
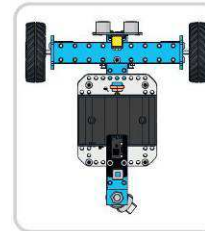
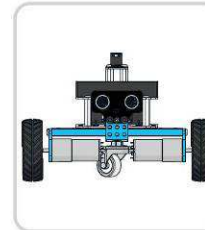

3

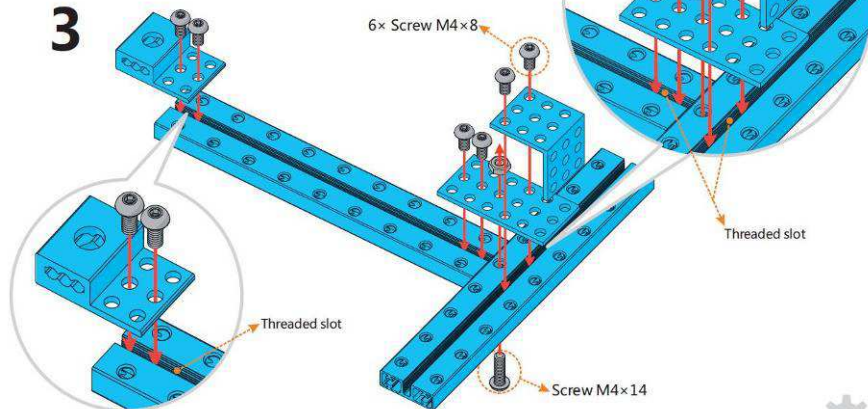



4

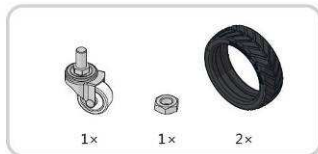
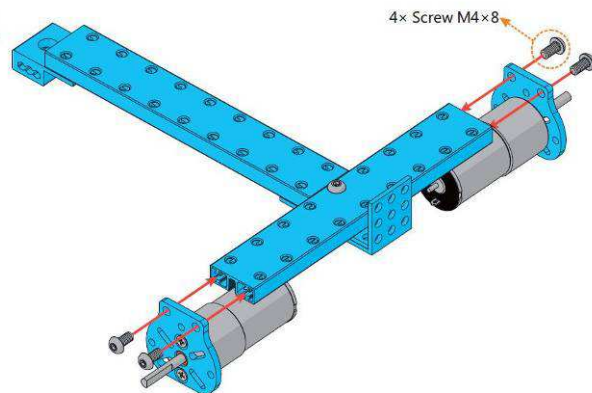

6

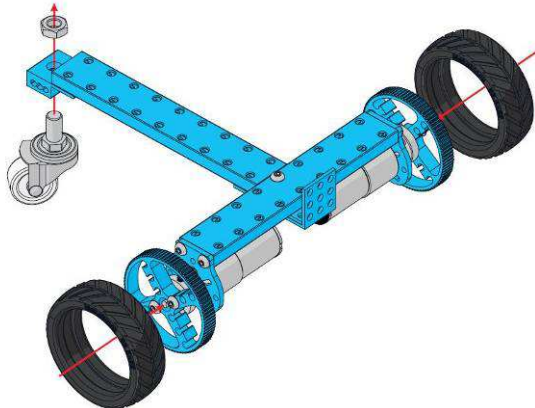

5

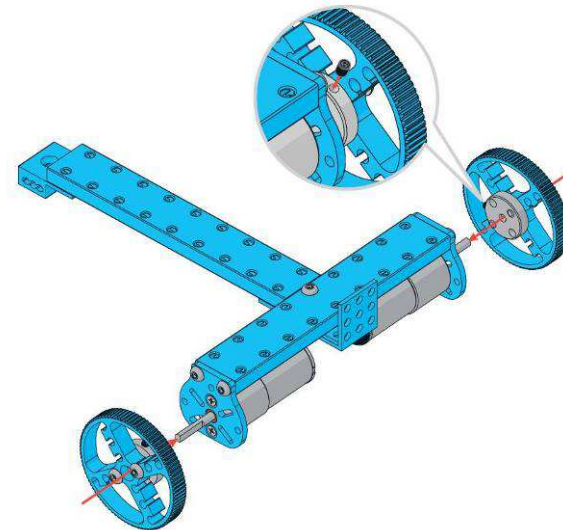

7

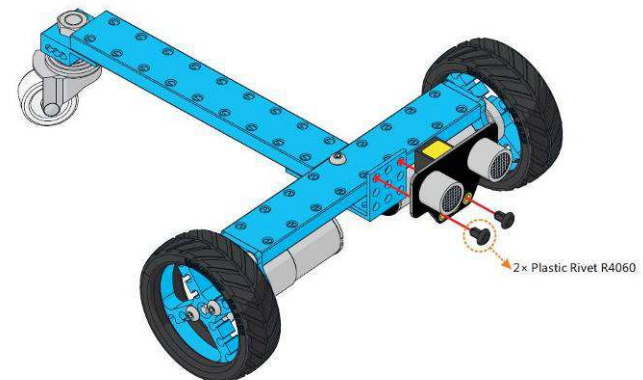

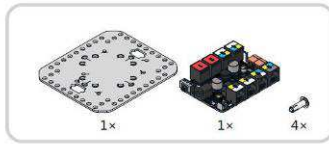

8

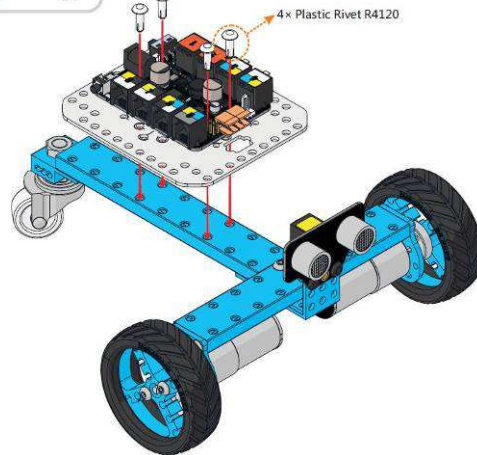

Wiring and Programming

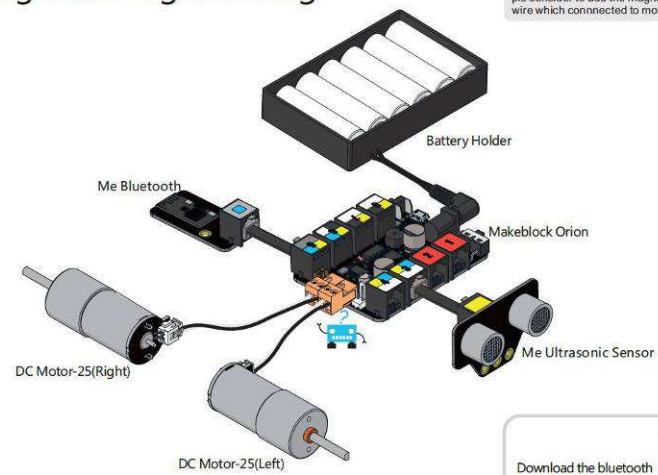

To reduce the electromagnetic interference, pls consider to add the magnetic ring to the wire which connected to motors.



You may need to switch the order of two wires to correct the rotation direction.

Download the bluetooth control App by scanning the QR code



<http://app.makeblock.cc/>

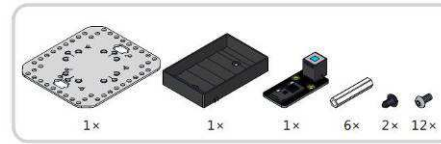

9

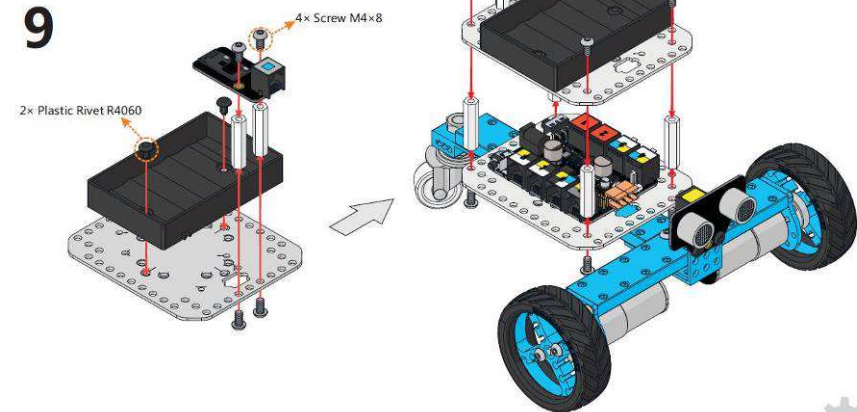

You can build more on Makeblock

