



## Hyndsight Vision Systems, Inc. Instructions for Use



### Operating instructions for the CRUZ and Journey product lines by Hyndsight Vision Systems Inc

Applies to the following models:

HVS-001CR(camera)

HVS-001MR(monitor)



## WARRANTY

This Limited Product Warranty shall apply to Hyndsight Vision Systems, Inc. products including all accessories as contained within the original package. Hyndsight Vision Systems, Inc. warrants that products from its authorized distributors and retailers will meet the applicable product specifications and be free from all defects in material and workmanship during the Limited Product Warranty Period, one year starting from the date of original purchase, assuming the products are used in accordance with the user manual and other documentation provided at the time of purchase. This Limited Product Warranty is subject to the following terms and conditions:

1. To obtain warranty service, a proof of purchase in the form of an original or copy of the sales receipt from the original retailer is required.
2. This Limited Product Warranty is only valid and enforceable in the country/region where the product is sold.

[www.hyndsightvision.com](http://www.hyndsightvision.com)

Made in China for Hyndsight Vision Systems, Inc.

2017-1-7

3. This Limited Product Warranty is at sole option of Hyndsight Vision Systems, Inc. to either repair or replace the defective product during the Limited Product Warranty Period. Hyndsight Vision Systems, Inc. will not replace missing components from any package purchased through online auctions.
4. To obtain warranty service, contact your local Hyndsight Vision Systems, Inc. authorized retailer or Hyndsight Vision Systems, Inc. for shipping instructions and an RMA number.
5. This Limited Product Warranty covers expenses for inspecting and repairing the product during the Limited Product Warranty Period. The defective product shall be delivered by the purchaser at his/her own expense to the designated premises together with the proof of purchase and RMA number.
6. Hyndsight Vision Systems, Inc. will return the repaired or replaced product to the drop-zone for collection by the customer in good working condition. All replaced faulty products or components will become property of Hyndsight Vision Systems, Inc..
7. If Hyndsight Vision Systems, Inc. repairs or replaces the product, the repaired or replaced product shall continue to be warrantied for the remaining time of the original warranty period or for three (3) months from date of repair or replacement, whichever is longer.
8. Hyndsight Vision Systems, Inc. reserves the right to add, delete, or amend the terms and conditions at any time without prior notice on its website, [www.hyndsightvision.com](http://www.hyndsightvision.com).
9. A two (2) year warranty is extended to the Flush Mount, as well as to all purchases made in the United Kindgom.
10. This limited warranty shall not apply if the damage was caused by any of the following:
  - a. The product serial number has been removed, erased, defaces, altered, or is illegible.
  - b. The damage resulting from the use of the product in a manner other than its normal and customary manner.
  - c. Deterioration of the product due to normal wear and tear.
  - d. The damage arising from improper installation, unauthorized repair, alteration, or modification to this product by third parties other than Hyndsight Vision Systems, Inc. or its designee.
  - e. The damage arising from operation with components or accessories not officially authorized or provided by Hyndsight Vision Systems, Inc. or used in ways other than its intended use.
  - f. The damage arising from exposure to abnormally corrosive conditions or operation with extreme heat/cold or humidity.

## TABLE OF CONTENTS

Warranty .....	1-2
Product Specifications .....	3
Intended Use .....	3
Important Safety Notice .....	3-4
Caution .....	4
Kit Contents .....	5
Troubleshooting .....	6
Charging .....	6-7
Single Camera Set-Up .....	7
Monitor Set-Up.....	7-13.
Compliance Information.....	13-14

## PRODUCT SPECIFICATIONS

Transmission Frequency: 2.4 GHz

Unobstructed Effective Range: up to 300 ft.

Power Supply Input, per adapter: 100-240 V AC 50/60 Hz 0.4A

Power Supply Output, per adapter: 5V DC 2.0A

Monitor (CRUZ & Journey 1) - 5.0" sunlight-readable display (4.8" viewable)

Monitor (Journey 2) - 4.8" TFT LCD

Camera (CRUZ) - Tight Angle Lens

Camera (Journey 1 & 2) - Wide Angle Lens

Screen Resolution: 800x480

Real time video stream for recording function

Style and color may vary

## INTENDED USE

Hyndsight Vision Systems wireless cameras and monitors are to be used as an aid for visualizing blind spot conditions or for monitoring locations not always in clear sight. Use of your own common sense and judgment is always indicated before and during use of this product. Hyndsight is not responsible for accidents or actions that result under use of this product

## IMPORTANT SAFETY NOTICE

Program you settings before you operate any vehicle.

Do not program product while driving or while in motion. When adjusting settings, stop in a safe and legal manner before doing such operations.

Hyndsight Vision Systems, Inc. products are designed for use in outdoor activities. While using your Hyndsight product, safety rules must be followed to prevent accidents that can result in injury or death to yourself and/or others.

Distractions can be dangerous and result in an accident in which you or others could be injured. Please do not solely rely on screen image alone. No technology is a replacement for your attentiveness.

[www.hyndsightvision.com](http://www.hyndsightvision.com)

Made in China for Hyndsight Vision Systems, Inc.

2017-1-7

Do not disassemble the Camera or Monitor.

Do not attempt to remove the internal, non-replaceable battery in the Camera or the Monitor. Do not expose the product to abnormal conditions such as extreme heat or humidity or prolonged sun exposure.

When disposing of the unit, have the batteries removed and recycled by a professional waste electronics treatment provider.

Do not use paint thinner or rubbing alcohol to clean unit.

Do not subject unit to strong impact. Do prevent the Camera and Monitor from falling.

Do not submerge the Camera or Monitor in water. Do not subject unit to prolonged exposure to rain, snow, and other outside environments.

Do charge the units indoors in dry conditions. Do not charge the units around water or during rain when unit is installed outdoors. Doing so may cause electrical shock and/or injury to you or the device.

Sunglasses with polarized lenses may impair the visibility of the display.

This monitor is not intended to be used as a medical monitor and its use should not replace proper adult supervision. You should check your child's activity at regular intervals as this monitor will not alert parents to the silent activities of a child.

Strangulation Hazard - Children have STRANGLED in cords. Keep cords out of reach of children.

## CAUTION

In order to prevent improper operation of the AC Adaptor, please read the user manual carefully. For your safety, please use only the AC Adaptor provided. The manufacturer will not be responsible for any losses caused by converters and chargers not provided by the manufacturer. IMPORTANT Please use only the socket match with the AC Adaptor. Use of improper socket may cause electrical and fire damage. Only charge the Camera and Monitor in dry environments. Charging the Camera and/or Monitor in the rain or in a wet environment may cause electrical shock, fire, personal injury and/or product destruction. Improper use of the Camera and/or Monitor and accessories will void the warranty.

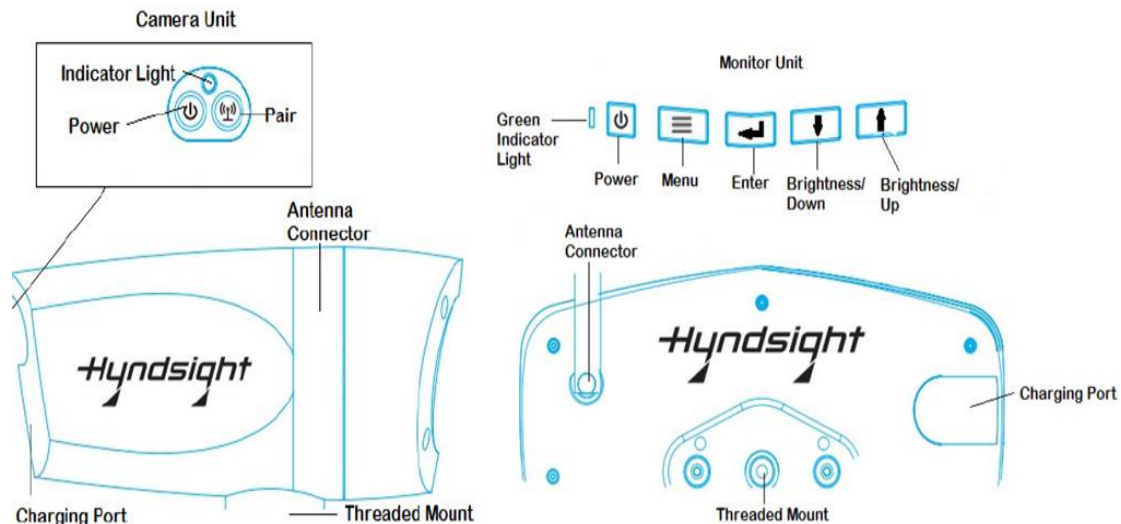

#### FLUSH BRACKET MOUNTING

To attach the Camera or Monitor to the desired smooth, clean, flat, non-porous surface, follow the instructions below.

Note: The mounting surface and the Suction Cup should be clean and dry. Wipe with a clean, damp cloth and let dry completely. The Flush Mount should be installed at room temperature (avoid extreme heat or cold). Do not moisten the Suction Cup.

- \_ Thoroughly clean the smooth, flat, non-porous surface, making sure the surface is dry and free of scratches.
- \_ Twist the Camera or Monitor onto the flush mount's threaded mounting stud. Do not remove the Rubber Washer.
- \_ Hold the Camera in place and firmly tighten the Lock Ring.
- \_ Position the Suction Cup Lever in the "down" position.
- \_ Position the Suction Cup on your mounting area. In order to remove the Flush mount easily, HVS recommends that the Suction cup Release Tab be at the bottom of the installation area.
- \_ Push the Suction Cup firmly against the mounting surface (the Suction Cup Lever should be in the "down" position). Press the Suction Cup Button and pull the Suction Cup Lever up and over the Button. You will feel the Button move out during this procedure; this action locks the Suction Cup into place.

[www.hyndsightvision.com](http://www.hyndsightvision.com)

Made in China for Hyndsight Vision Systems, Inc.

2017-1-7

- \_ Loosen the Flush Mount Adjusting Knob, position the Camera or Monitor, and then retighten the Adjusting Knob.
- \_ Check the Camera's position as necessary by loosening the Adjusting Knob. Tighten securely when in position.
- \_ To release the Suction Cup, move the Suction Cup Lever back into its "down" position. Lift the Suction Cup Release Tab to help break the hold.

#### TROUBLESHOOTING

#### TROUBLESHOOTING

Problem	Solution
Camera won't pair automatically	Press the Menu button Select Pair by pressing Enter The Monitor's green indicator light should flash and the screen will go white, during which time you should press the Pair button on the Camera.
Camera 1 icon is displayed as in use, but no image is showing and I can't pair to it	Press the Menu button Select Enable Multi-Camera Select Pair by pressing Enter Toggle to an inactive (gray) Camera icon Press Enter The Monitor's green indicator light should flash and the screen will go white, during which time you should press the Pair button on the Camera Remember to Unpair Cameras 2-4 before Powering off.
No Signal	Make sure antennas are attached and devices are within effective range. Weather, interference and other such factors may reduce the unit's ability to convey video.
Difficulty seeing screen	Adjust angle of Monitor. Also, polarized sunglasses may affect viewing.
All four Camera icons are blue but I don't have all 4 Cameras paired	Unpair unused Camera icons using Monitor; turning off the Camera alone does not unpair it from the Monitor. Press the Menu button Toggle to a camera icon that shows to be paired but is not. Select Unpair by pressing Enter Repeat the above steps to Unpair any occupied camera icons that actually do not have a paired Camera

For screen shots and instruction videos, please visit our website at [www.hyndsightvision.com](http://www.hyndsightvision.com) or check out our YouTube page.

A digital copy of the instruction manual can be found at [www.hyndsightvision.com](http://www.hyndsightvision.com)

#### CHARGING

Fully charge both devices before using.

To Charge Your Hyndsight System

Connect the USB cable to the Wall Charger.

Insert the straight jack into the Camera/Monitor.

Plug in the Wall Charger.

Red light appears when charging. Red light turns off when charge is complete (3-4 hours).

Hyndsight Systems are equipped with multiple functions depending upon if Multi-Camera mode is

Disabled (only one camera can be used) or Enabled (more than one camera can be used).

#### SINGLE CAMERA SET-UP

Remove the protective screen cover from the Monitor before using. HVS recommends pairing Cameras before mounting them to desired surfaces. Using your best judgment, attach Camera and Monitor Antennas either before or after mounting Devices to desired surfaces. Note: Unpair, Select, and Scan settings are disabled in Single Camera mode.

[www.hyndsightvision.com](http://www.hyndsightvision.com)

Made in China for Hyndsight Vision Systems, Inc.

2017-1-7

### To Power on\* Your Hyndsight System

Hold Monitor Power button for 3-4 seconds until the orange Hyndsight screen appears.

Green Indicator Light will light up to show Monitor is on.

Hold Camera Power button for 3-4 seconds. An image will appear on the Monitor after you release the Power button.

Indicator Light will illuminate to show Camera is on.

\*Always power up Monitor before Camera to help sync automatically. If Camera and Monitor do not sync automatically, follow the steps below:

Press the Menu button.

Scroll to Pair using or.

Select Pair by hitting the Enter button.

Monitor screen will go white and the Green Indicator Light will flash.

While Monitor's Green Indicator Light is flashing, press the Pair button on Camera and an image will appear on Monitor.

### Monitor Set-Up

#### 1. ICON/ Button



1. Signal intensity   2. Current use lens number   3. Memory card   4. Image  
 5. Monitor recording   6. Camera recording   7. Monitor battery energy display  
 8. Camera battery energy display   9. Current date time  
 10. Power indicator light   11. Power switch button   12. Menu button  
 13. Confirm / enlarge butto   14. record /down button   15. Preview / up button

#### 2. Special note

1. Arrow button (↓↑) Choose the left main menu options after the confirmation button to confirm. The sub menu settings, use the arrow button to choose the left (↓↑), after the confirmation button to confirm option settings accordingly

2. Menu button, after entering the option, this key is used to exit and return to the previous layer

Main menu:



1. Sub menu:

1.1. Pair 

Matching options

Choice → pair → pair → cam1-cam4 ;

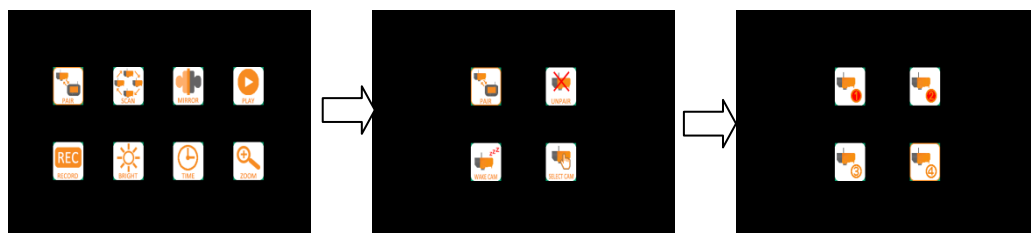

Remark:

Camera number display color description

Paired numbers show red;

Unpaired number display white;



Show red, can not be selected to match. Can only be selected in the submenu UNPIR delete, can be selected to match.

1.2. UNPIR 

Delete selected camera

Choice → pair → UNPIR → cam1-cam4 ;

[www.hyndsightvision.com](http://www.hyndsightvision.com)

Made in China for Hyndsight Vision Systems, Inc.

2017-1-7



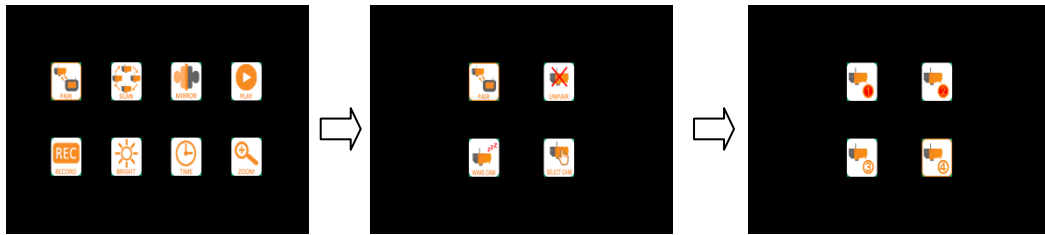

Remarks:

Camera number display color description

Number display red representation is also shown to be matched, non book except;

Number display white, can be deleted;

### 1.3 WAKE CAM

Select camera power saving mode

Choice → pair → WAKE CAM → cam1-cam4 ON/OFF;



Remarks:

Working mode ON;

Sleep mode OFF;

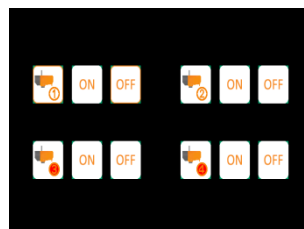
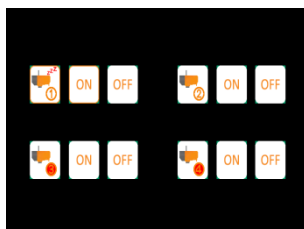

Camera number display color description

Number display red, that can not be selected to set;

Number display white, that can be selected to set;

[www.hyndsightvision.com](http://www.hyndsightvision.com)

Made in China for Hyndsight Vision Systems, Inc.

2017-1-7

## 1.4 SETECT CAM

Select camera view

Choice → pair → SETECT CAM → cam1-cam4

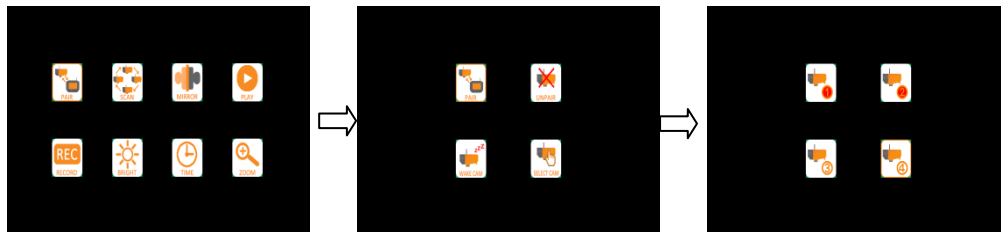

Remarks:

Camera number display color description

The number shows red, indicating no choice;

Number display white, indicating that you can choose;

## 2. SCAN

Start scan 

Choice → SCAN → ON/OFF

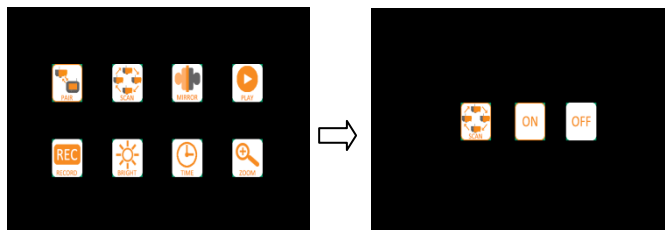

## 3.MIRROR

Start mirror 

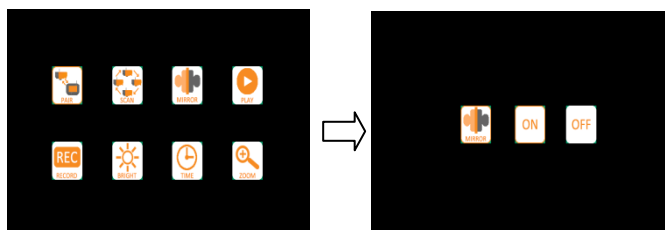

Choice → mirror → ON/OFF

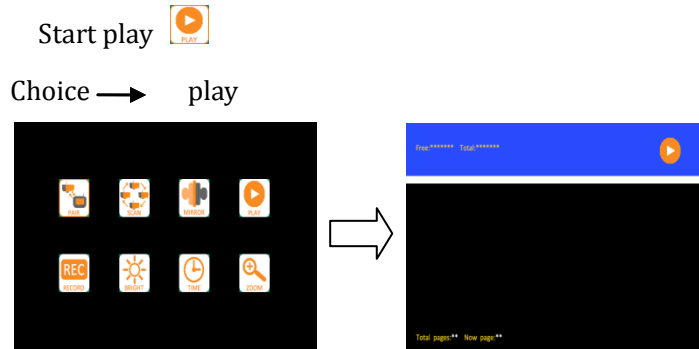

## 4.PLAY



Press  key to pause 1 times, and then press this key to continue playing;

When playing, press the arrow button to rewind the tape  (-X1, -X2....); Press the arrow button to fast forward  (X1,X2....);

Press the menu  button to play, stop, press the power  button , return to the top or exit

## 5.RECORD

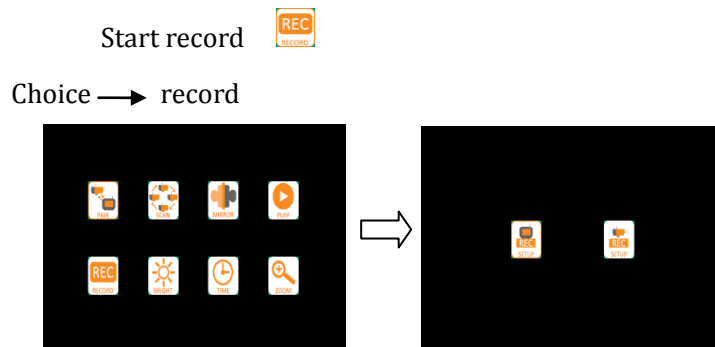

### 5.1 rec setup Monitor

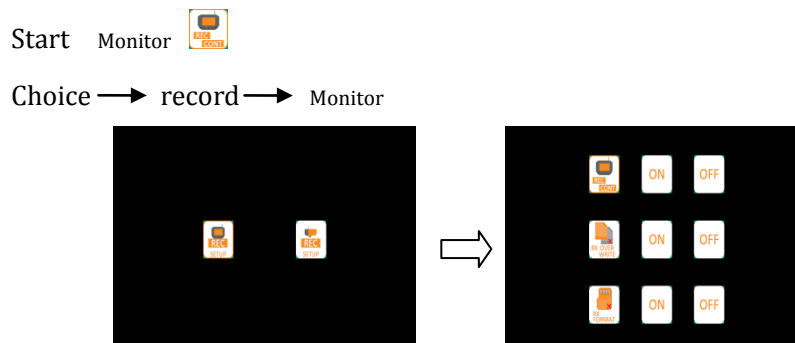

Choice → **rec setup** → off/on

Set to open or close the recording;

### 5.2 rx over write

[www.hyndsightvision.com](http://www.hyndsightvision.com)

Made in China for Hyndsight Vision Systems, Inc.

2017-1-7

**Start rx over write**

Choice → **rx over write** → off/on

When the memory card space is insufficient to cover the original record;

**5.3 rx fomrat****Start rx format**

Choice → **rx fomrat** → off/on

Data formatting or delete record;s

**6. rec setup camera**

Start camera 

Choice → record → **camera**

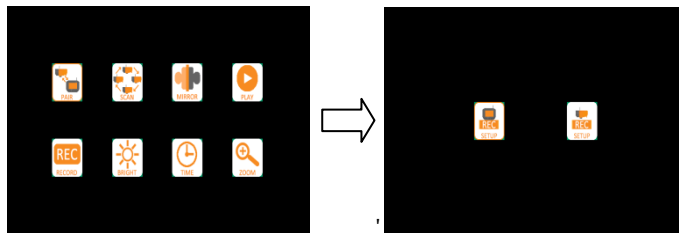
**6.1 rec setup camera****Start rec setup**

Choice → **rec setup** → on/off

Set to open or close the recording;

**6.2 tx over write****Start tx over write**

Choice → **rx over write** → on/off

When the memory card space is insufficient to cover the original record;

**6.3 tx format****Start rx format**

Choice → **rx fomrat** → on/off

Data formatting or delete records;

**7. BRIGHT**

Start bright 

Choice → **bright**

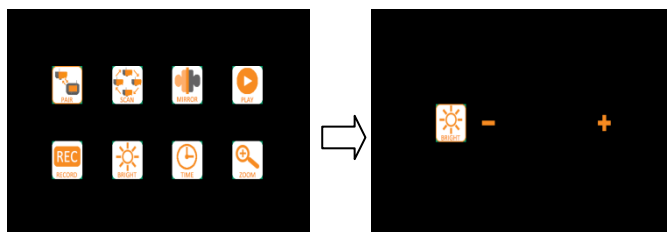

**Brightness adjustment, through the arrow keys to adjust the brightness level**



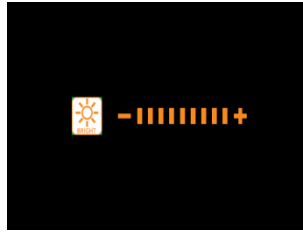
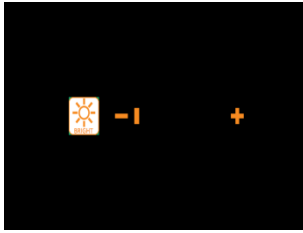

## 8.TIME

Start time 

Choice → time



Time and date adjustment, set by arrow;

## 9.ZOOM

Start zoom 

Choice → zoom



Mage magnification, through the arrow keys select amplifier series, (X1, X1.5, X2);

## Compliance Information

### USA

This device complies with Part 15 of the FCC Rules. Operation is subject to the following two conditions: (1) this device may not cause harmful interference, and (2) this device must accept any interference received, including interference that may cause undesired operation. Note: This equipment has been tested and found to comply with the limits for a Class B digital device, pursuant to part 15 of the FCC Rules. These limits are designed to provide reasonable protection against harmful interference in a residential installation. This equipment generates uses and can radiate radio frequency energy and, if not installed and used in accordance with the instructions, may cause harmful interference to radio communications. However, there is no guarantee that interference will not occur in a particular installation. If this equipment does cause harmful interference to radio or

[www.hyndsightvision.com](http://www.hyndsightvision.com)

Made in China for Hyndsight Vision Systems, Inc.

2017-1-7

television reception, which can be determined by turning the equipment off and on, the user is encouraged to try to correct the interference by one or more of the following measures:

- Reorient or relocate the receiving antenna.
- Increase the separation between the equipment and receiver.
- Connect the equipment into an outlet on a circuit different from that to which the receiver is connected.
- Consult the dealer or an experienced radio/TV technician for help.

Any Changes or modifications not expressly approved by the party responsible for compliance could void the user's authority to operate the equipment.

This equipment complies with FCC radiation exposure limits set forth for an uncontrolled environment. This equipment should be installed and operated with minimum distance 20cm between the radiator & your body. This transmitter must not be co-located or operating in conjunction with any other antenna or transmitter.

Canada

Operation is subject to the following two conditions:

(1) This device may not cause interference, and (2) this device must accept any interference, including interference that may cause undesired operation of the device.

L'exploitation est autorisée aux deux conditions suivantes: (1) l'appareil ne doit pas produire de brouillage, et (2) l'utilisateur de l'appareil doit accepter tout brouillage radioélectrique subi, même si le brouillage est susceptible d'en compromettre le fonctionnement.

Under ISERC regulations, this radio transmitter may only operate using an antenna of a type and maximum (or lesser) gain approved for the transmitter by ISERC. To reduce potential radio interference to other users, the antenna type and its gain should be so chosen that the equivalent isotropically radiated power (e.i.r.p.) is not more than that necessary for successful communication.

Conformément à la réglementation ISERC, le présent émetteur radio peut fonctionner avec une antenne d'un type d'un gain maximal (ou inférieur) approuvé pour l'émetteur par ISERC. Dans le but de réduire les risques de brouillage radioélectrique à l'intention des autres utilisateurs, il faut choisir le type d'antenne et son gain de sorte que la puissance isotrope rayonnée équivalente (p.i.r.e) ne dépasse pas l'intensité nécessaire à l'établissement d'une communication satisfaisante.

CAN ICES-3 (B) / NMB-3 (B)