

HACHIKO' DOG SENSOR USER MANUAL

The logo for HACHIKO features the word "HACHIKO" in a bold, sans-serif typeface. The letters "H", "A", "C", "K", "O" are black, while the letters "H", "I", and "I" are orange. The orange "H" is positioned between the black "C" and "K", and the orange "I"s are positioned between the black "H" and "K". The orange "I"s have a small orange dot above each one, resembling a dog's ears or a stylized 'i'.

First Time usage - turn on the device and enroll it to HACHIKO' Smartphone APP

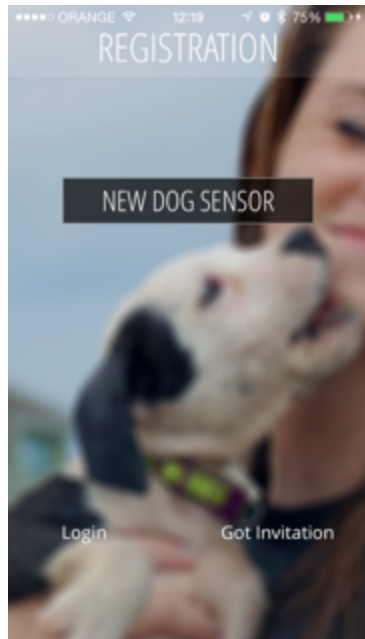

PUSH on “NEW DOG SENSOR”

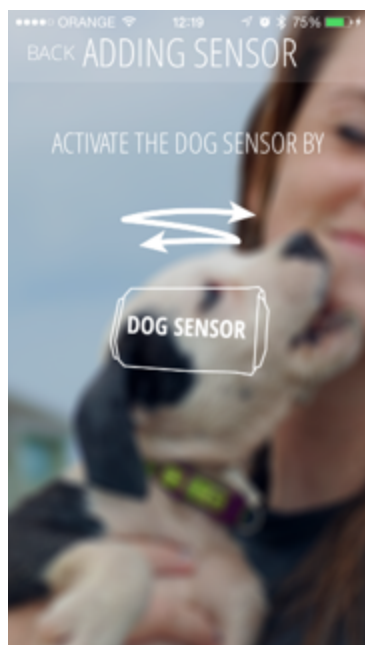

ACTIVATE THE SENSOR- TURN ON THE DOG SENSOR BY SHAKING IT FOR 3 SECONDS.

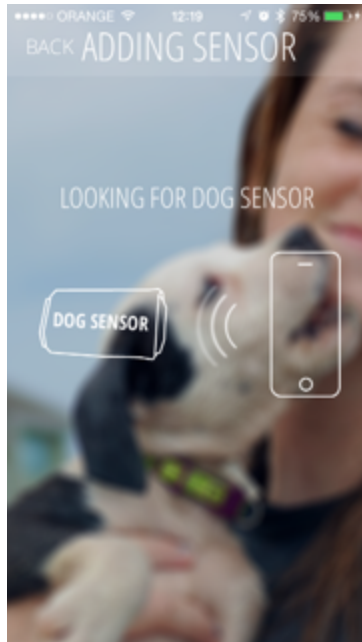

Smartphone Searches FOR HACHIKO SENSOR to start enrollment procedure



Smartphone connecting to HACHIKO SENSOR

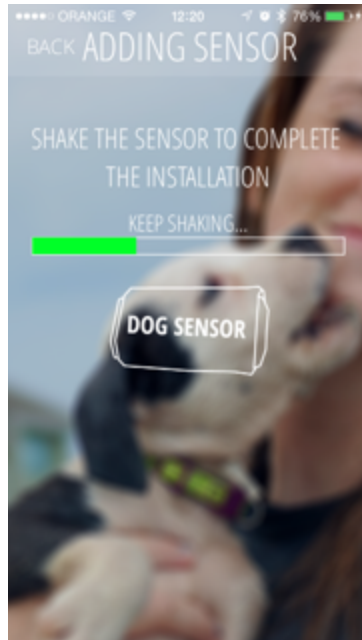

Shake HACHIKO SENSOR till progress bar is full- to complete enrollment.

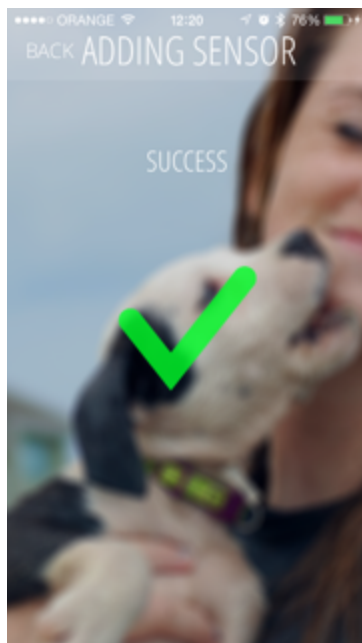

Turning on HACHIKO SENSOR and enrollment successfully ended

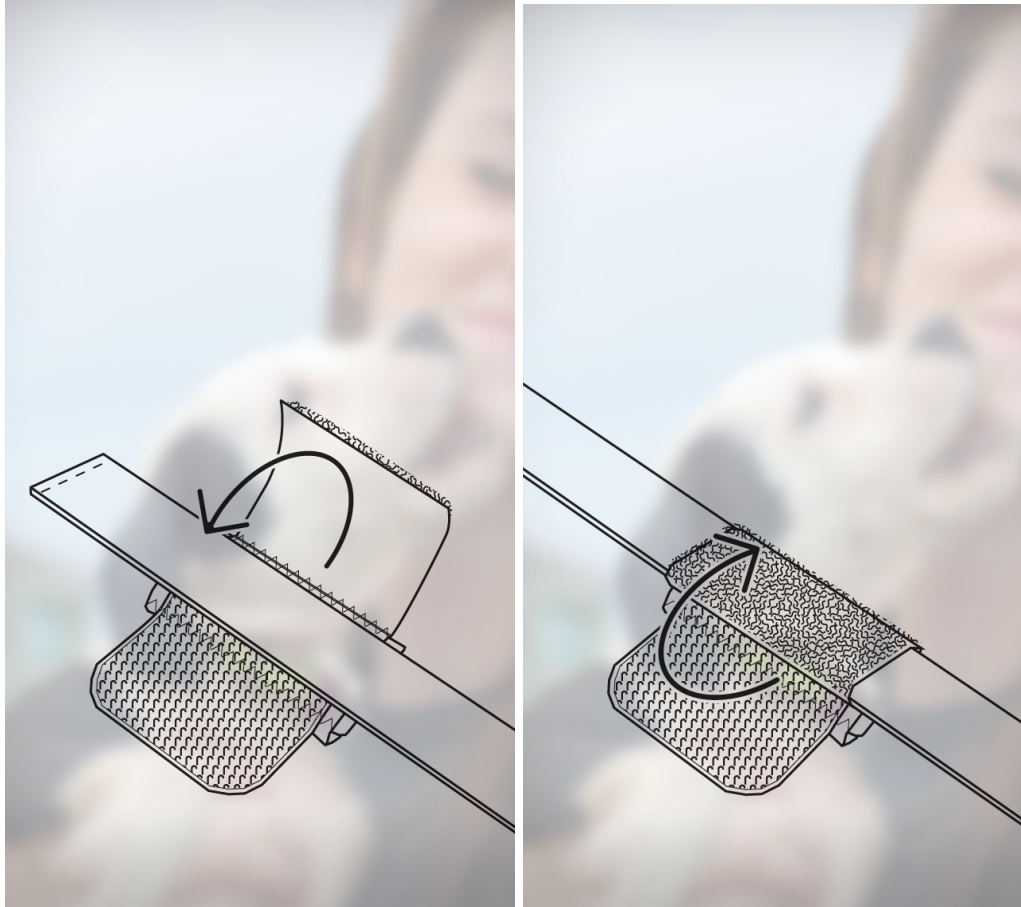

Attache HACHIKO SENSOR to dog collar by following the above pictures.

On daily basis

The collar time to time connects to your iphone application and sends number of steps which done by your pet by connecting its build in smart bluetooth - BT4.0
Please insure to turn on your iphone' BT device.

FCC Compliance Statement

This device has been tested and found to comply with the limits for a Class B digital device, pursuant to Part 15 of

the FCC Rules. These limits are designed to provide reasonable protection against harmful interference in residential

installations. This equipment generates uses and can radiate radio frequency energy and, if not installed and used in

accordance with the instructions, may cause harmful interference to radio and television reception.

However, there is no guarantee that interference will not occur in a particular installation. If this device does cause such

interference, which can be verified by turning the device off and on, the user is encouraged to eliminate the interference

by one or more of the following measures:

- Re-orient or re-locate the receiving antenna.***
- Increase the distance between the device and the receiver.***
- Connect the device to an outlet on a circuit different from the one that supplies power to the receiver.***
- Consult the dealer or an experienced radio/TV technician.***

WARNING! Changes or modifications to this unit not expressly approved by the party responsible for compliance could

void the user's authority to operate the equipment.

This device complies with FCC Rules Part 15: Operation is subject to two conditions: (1) This device may not cause

harmful interference, and (2) this device must accept any interference that may be received or that may cause

undesired operation.

To comply with FCC Section 1.310 for human exposure to radio frequency electromagnetic fields, implement the following

instruction:

A distance of at least <<0.5cm>>. between the equipment and all persons should be maintained during the

operation of the equipment.