

# SHARPER IMAGE®

Disco Ball Speaker



## User Guide

SBT651

### In the box



Disco Ball Speaker

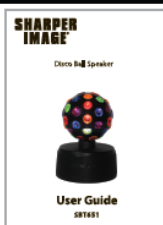

User Guide



AUX-IN Cable



Micro USB Charging Cable

### Powering the Speaker

1. Connect the small end of the Micro USB charging cable to the Micro USB charging port on the speaker.
2. Connect the large end of the Micro USB charging cable to a USB port on your computer or other USB charging device.
3. The LED charging light is RED when charging. It will shut off when the speaker is fully charged.

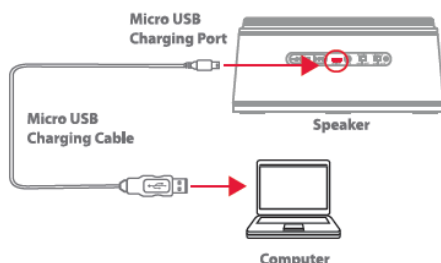

### Location of Controls



1. [-/⏮] button:
  - Quick press - skip to previous song
  - Long press - decrease volume
2. [▶/⏸] button: Play/pause music
3. [⏭/+] button:
  - Quick press - skip to next song
  - Long press - increase volume
4. DC5V Micro USB charging port
5. AUX IN port
6. Bluetooth Audio ON/OFF switch
7. Party Light ON/OFF switch

### Pairing the speaker with a Bluetooth enabled device

1. Move the BLUETOOTH AUDIO ON/OFF switch on the speaker to the ON position. A tone will be heard and the LED Bluetooth indicator light will quickly flash BLUE.
2. Keep the speaker and Bluetooth enabled device within 3 feet of each other during the pairing process.
3. Set your Bluetooth enabled device to search for discoverable Bluetooth devices.



If there are no paired devices in range when the speaker is turned on, it will go into pairing mode automatically. If a paired device is in range, the speaker will connect to it automatically.

#### On an iPhone

- Go to SETTINGS > BLUETOOTH (Make sure Bluetooth is turned ON)

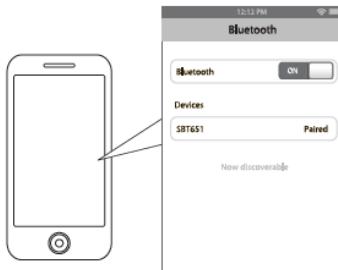

### Pairing the speaker with a Bluetooth enabled device (cont'd)

#### On a Blackberry

- Go to SETTINGS/OPTIONS > BLUETOOTH
- Enable BLUETOOTH

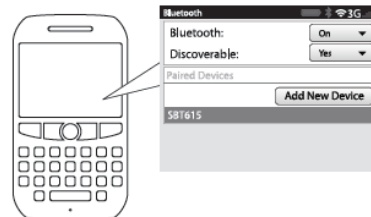

#### On an Android Phone

- Go to SETTINGS > BLUETOOTH
- Search for devices (Make sure Bluetooth is turned ON)

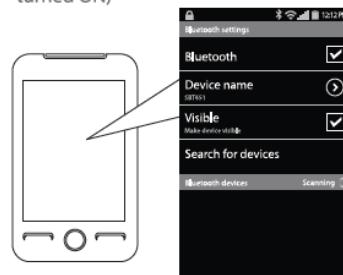

#### On other Cell Phones/Devices

- Review the instruction manual that came with your phone/device.

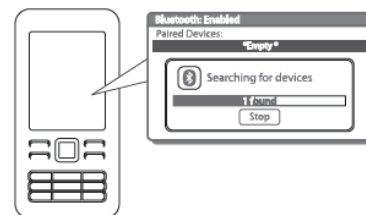

4. When your Bluetooth enabled device finds the speaker, select "SBT651" from the list of found devices.
5. If required, enter the password 0000. Select OK or YES to pair the two units.
6. After a successful registration, a tone will be heard and the LED Bluetooth indicator light will slowly flash BLUE.

**NOTE:** If you would like to connect the speaker to another device, you must unpair the unit from the currently paired device first. On your device's Bluetooth settings, select "SBT651", then select "unpair". The speaker will return to pairing mode.



The screenshots above are typical of many Bluetooth enabled devices in the market today, and are used to assist in the explanation of the pairing process. Your Bluetooth enabled device's interface and interaction with the speaker may slightly differ from the illustrations above.

## Using your Bluetooth speaker

- To turn on your Bluetooth speaker, move the BLUETOOTH AUDIO ON/OFF switch from the OFF to ON position.
- Check that the Bluetooth feature is active on your Bluetooth enabled device. When you turn on the speaker, your Bluetooth enabled device will automatically connect.
- If you are using the speaker for the first time, go to the "PAIRING THE SPEAKER" section of this User Manual and pair the speaker to your desired Bluetooth device.

## Playing Music

To enjoy wireless music on your Bluetooth speaker, make sure you are connected to a Bluetooth enabled device (see "Pairing the Speaker with a Bluetooth Enabled Device"). Once connected, you can control the music and volume with the controls on your connected device.

### Playing Music

- Press [▶|] to pause the music.
- To resume playback, press the [▶|] button again.

### Skipping Songs

- Press the [⏮/+] button to skip to the next track.
- Press the [-/⏭] Button to return to the previous track.

### Adjusting the volume

- Long press the [⏮/+] Button to increase the volume.
- Long press the [-/⏭] Button to decrease the volume.

## Activating the disco ball/party light

To activate the Disco Ball/Party Light, slide the LIGHT ON/OFF switch to the ON position. The Ball will rotate and emit RED, BLUE and GREEN lights.

## Using as a wired speaker

1. Slide the BLUETOOTH AUDIO ON/OFF Button to the ON position.
2. Connect one end of the 3.5mm Auxiliary cable to the AUX IN port of the speaker and the other end to an external device's headphone port (smartphone, MP3 player or tablet).
3. Open a media player on your device and press PLAY to start playing your music.
4. Use the controls on your connected device to control music playback and volume.

## Troubleshooting Tips

 I can pair the Bluetooth speaker with my Bluetooth device, but I cannot hear any music.

1. Turn up the volume on your Bluetooth device.
2. You may have to unpair the speaker, then re-pair to your device.

 I cannot get the Bluetooth speaker into Pairing mode.

1. Make sure the unit is turned ON.
2. Move the BLUETOOTH AUDIO ON/OFF switch on the speaker to the ON position. A tone will be heard and the LED Bluetooth indicator light will quickly flash BLUE.
3. The speaker is now in pairing mode.

 My Bluetooth device is not able to pair with the Bluetooth speaker.

1. Move the BLUETOOTH AUDIO ON/OFF switch on the speaker to the ON position. A tone will be heard and the LED Bluetooth indicator light will quickly flash BLUE.
2. Keep the speaker and Bluetooth enabled device within 3 feet of each other during the pairing process.
3. Check that YOUR device's Bluetooth feature is turned ON.
4. Try repeating the pairing process. See "Pairing the speaker with a Bluetooth enabled device".

## Legal information

Caution: Any changes or modifications not expressly approved could void the user's authority to operate the equipment.

Note: This equipment has been tested and found to comply with the limits for a Class B digital device, pursuant to part 15 of the FCC Rules. These limits are designed to provide reasonable protection against harmful interference in a residential installation. This equipment generates, uses and can radiate radio frequency energy and, if not installed and used in accordance with the instructions, may cause harmful interference to radio communications. However, there is no guarantee that interference will not occur in a particular installation. If this equipment does cause harmful interference to radio or television reception, which can be determined by turning the equipment off and on, the user is encouraged to try to correct the interference by one or more of the following measures:

- Reorient or relocate the receiving antenna.
- Increase the separation between the equipment and receiver.
- Connect the equipment into an outlet on a circuit different from that to which the receiver is connected.
- Consult the dealer or an experienced radio/TV technician for help.



## Limited Warranty

### 90 Days Limited Warranty

In the unlikely event that this product is defective, or does not perform properly, you may within ninety (90) days from your original date of purchase return it to the authorized service center for repair or exchange.

### TO OBTAIN WARRANTY SERVICE:

- Call the Customer Support number located below, or go to our website portal to receive an SRO number.
- Provide proof of the date of purchase within the package (Dated bill of sale).
- Prepay all shipping costs to the authorized service center, and remember to insure your return.
- Include a return shipping address (no P.O. Boxes), a telephone contact number, and the defective unit within the package.
- Describe the defect or reason you are returning the product.

Your product will be repaired or replaced, at our option, for the same or similar model of equal value if examination by the service center determines this product is defective. Products received damaged as a result of shipping will require you to file a claim with the carrier.

The shipping address of the authorized service center is:

 **Southern Telecom, Inc.**  
**Attention: Customer Service (2nd Floor)**  
**14-C 53rd Street**

Should you have any questions or problems concerning this product, please contact our customer service department at:

Customer Support:  
Phone: 1-877-768-8481  
Monday-Friday 8AM-10PM(EST)

 [www.southern telecom.com](http://www.southern telecom.com)  
Click on "Product Support"

### Warranty service not provided

This warranty does not cover damage resulting from accident, misuse, abuse, improper installation or operation, lack of reasonable care, and unauthorized modification. This warranty is voided in the event any unauthorized person opens, alters or repairs this product. All products being returned to the authorized service center for repair must be suitably packaged.

### Limitation of Warranty:

• THE WARRANTY STATED ABOVE IS THE ONLY WARRANTY APPLICABLE TO THIS PRODUCT. ALL OTHER WARRANTIES, EXPRESS OR IMPLIED (INCLUDING ALL IMPLIED WARRANTIES OF MERCHANTABILITY OR FITNESS FOR A PARTICULAR PURPOSE) ARE HEREBY DISCLAIMED. NO VERBAL OR WRITTEN INFORMATION GIVEN BY AIT, INC. ITS AGENTS, OR EMPLOYEES SHALL CREATE A WARRANTY OR IN ANY WAY INCREASE THE SCOPE OF THIS WARRANTY.

• REPAIR OR REPLACEMENT AS PROVIDED UNDER THIS WARRANTY IS THE EXCLUSIVE REMEDY OF THE CONSUMER. AIT, INC. SHALL NOT BE LIABLE FOR INCIDENTAL OR CONSEQUENTIAL DAMAGES RESULTING FROM THE USE OF THIS PRODUCT OR ARISING OUT OF ANY BREACH OF ANY EXPRESS OR IMPLIED WARRANTY ON THIS PRODUCT. THIS DISCLAIMER OF WARRANTIES AND LIMITED WARRANTY ARE GOVERNED BY THE LAWS OF THE STATE OF NEW YORK. EXCEPT TO THE EXTENT PROHIBITED BY APPLICABLE LAW, ANY IMPLIED WARRANTY OF MERCHANTABILITY OR FITNESS FOR A PARTICULAR PURPOSE ON THIS PRODUCT IS LIMITED TO THE APPLICABLE WARRANTY PERIOD SET FORTH ABOVE.

Some states do not allow the exclusion nor limitation of incidental or consequential damages, or limitations on how long an implied warranty lasts so the above limitations on exclusions may not apply to you. This warranty gives you specific legal rights, and you also may have other rights that vary from state to state.

Sharper Image® name and logo are registered trademarks. Manufactured and marketed by Southern Telecom under license. © Sharper Image. All Rights Reserved.

# SHARPER IMAGE®