

User Guide

Wireless Keyboard



K365

FCC ID:2ACGLK365



Caution: to properly operate this product please read the user manual thoroughly.

Schematic diagram



Using



- 1) Open the protective case
- 2) 180 degrees rotate
- 3) Adjust the rotation axis angle
- 4) 360 degrees rotate

Installation and removal

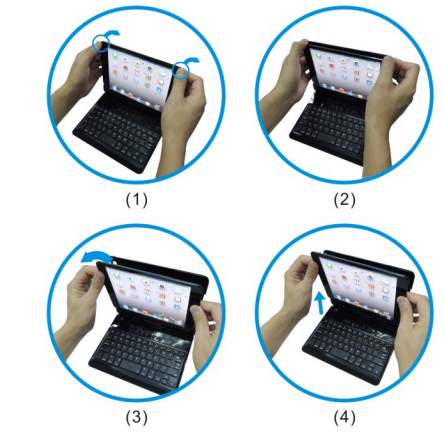

- 1) Removing back protective piece. Hold tablet PC on both sides (picture) gently push back cover off the tablet PC with thumb (back piece held in place by two tabs.)
- 2) Proceed to "peel" cover away from tablet PC
- 3) Take tablet PC out
- 4) Take tablet PC out upwards.

Keyboard



Welcome

Congratulation on selecting the Bluetooth Wireless Keyboard for your high tech devices. The super slim keyboard is quiet and crafted out of high grade plastic. In this present age of portable tech gadgets this is an ideal product for your iPad.

Overview

- | | | |
|--|--------------|-------------------|
| <input type="checkbox"/> Main screen/Esc | ⏮ PrevTrack | 🔒 Lock screen |
| 📶 Brightness - | ⏸ Play/pause | 🌐 Change Language |
| 💡 Brightness + | ⏭ NextTrack | fn Function |
| 🖱 Virtual Keyboard | 🔇 Mute | ⌫ Delete |
| 🔍 Search | 🔊 Volume - | ⌘ Command |
| 🖼 Preview photo | 🔊 Volume + | 📶 Connect |

- **fn-combination key**, press FN key can input the blue characters above on the keyboard or control the blue keys.

Prompted

Blue LED blinking: Pairing
Red LED on: Charging
Green LED on: Battery is fully charged
Green LED blinking: Low in Battery
Yellow LED on: Caps lock

Installation Guide

- Step 1.Charging the battery**
1. For the first time user, Please charge the keyboard for at least 6 hours before using it. Thereafter, charge for at least 2 hours when the battery runs low.
 2. The LED (green) will blink when battery is low. The LED (green) will stay solid when fully charged.
 3. Connect the charging cable (included) to charge keyboard

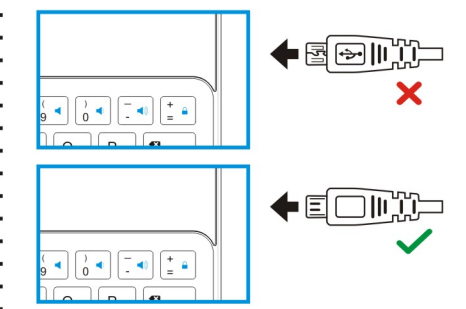

How to Charge the battery:
To charge the keyboard, Connect the 5V.DC input from the keyboard into the computer USB port with the connector cable provided. The Keyboard can function while charging.

Step 2.Pairing your Bluetooth Keyboard with your iPad/iMac/ iPhone or other Bluetooth enabled device.
The following sample shows how to pair the Bluetooth keyboard with your iPad.

Before you can use your keyboard, you have to pair it with your iPad. Pairing allows your keyboard to communicate wirelessly with your iPad.You only have to perform the pairing once.

1. Turn on the keyboard and press the key on the keyboard. The LED light will blink blue. Then on the screen of the iPad, you search for Settings-->Bluetooth.
- 2.Enable the Bluetooth function, and it will search for the Bluetooth keyboard automatically. When the Bluetooth keyboard is discovered, select the "Bluetooth keyboard" from the iPad screen, a passkey will appear on the screen of the iPad. Type in the passkey provided and press the ENTER key on the keyboard. Your Bluetooth keyboard will then be successfully paired with your iPad.

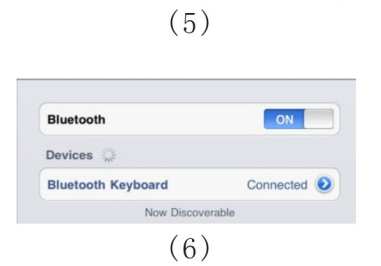
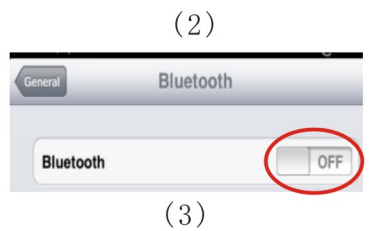
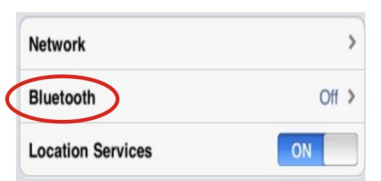
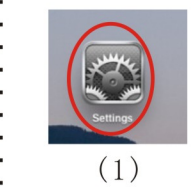

Troubleshooting

If the keyboard is not working with the iPad (or other Bluetooth devices) make sure:

- 1) The Bluetooth function on the iPad (or other Bluetooth devices) is enabled.
- 2) The Bluetooth keyboard is within 33 feet of the iPad.
- 3) The passkey is entered correctly.
- 4) Make sure the keyboard is charged, recharge if low.
- 5) If the pairing between the keyboard and tablet PC is failed or wrong character and typing delayed. Please do pairing again with the following procedures:
 - Delete all the Bluetooth device on the tablet PC
 - Switch off the Bluetooth function on the tablet PC
 - Reboot the tablet PC
 - Switch on Bluetooth function on your tablet pc and pair again

Product Specifications

- 1)Transmit Range: up to 10 meters
- 2)Range of Frequency: 2.4GHz Spectrum
- 3)Operating Voltage: 3.7Vdc (powered by Li-ion)
- 4)Operation current: <5mA
- 5)Standby current: 1.0mA
- 6)Sleep current: <0.25mA

This device complies with Part 15 of the FCC Rules: Operation is subject to the following two conditions:
1. This device may not cause harmful interference and
2. This device must accept any interference that is received, including any interference that may cause undesired operation.

Changes or modifications to this unit not expressly approved by the party responsible for compliance could void the user's authority to operate the equipment.