

AIRESION 艾瑞杰
科技，开创未来。

产品的配色或外观可能会与本手册图中所示有所不同
产品规格可能会有因为改善性能而变化
恕不另行通知

Color and appearance may differ with the icons in this manual
Product specifications may vary due to the improved performance
without notice

AIRESION

HDP200

LED微型投影仪用户手册
LED Portable Projector User Manual

F
家庭

A
娱乐

B
商务

目 录

F
家庭

A
娱乐

B
商务

| | |
|---------------------------|----|
| 简介和特点 | 03 |
| 主要安全事项 | 04 |
| 使用前注意事项 | 04 |
| 维护和保养 | 05 |
| 注意事项 | 05 |
| 主要安全事项 | 06 |
| 其他事项 | 07 |
| 摆放，连接和按键功能 | 07 |
| 物品清单 | 07 |
| 投影机外形视图 | 08 |
| 投影光线出口，调焦，喇叭单元出口 | 09 |
| 外接电源输入接口DCIN | 10 |
| 音频输出接口 | 10 |
| HDMI接口 | 10 |
| 连接视频设备，DVD机，电视，机顶盒等 | 10 |

目 录

F
家庭

A
娱乐

B
商务

| | |
|-------------------|----|
| 连接手机等HDMI设备 | 11 |
| 连接电脑 | 11 |
| 蓝牙功能 | 11 |
| 三个功能键操作 | 11 |
| 指示灯显示状态 | 12 |
| 使用方法 | 13 |
| 产品功能 | 13 |
| 产品正面，背面和侧面 | 14 |
| 使用屏幕调整菜单 | 15 |
| 投影机尺寸和距离 | 16 |
| 移动电源功能 | 16 |
| 常见故障排除 | 17 |
| 更多信息 | 18 |

简介和特点

感谢你使用我公司LED投影仪！

你可以通过阅读本手册，全面了解本机的使用，体验其完善的功能及简洁的操作方法。本机针对家庭、娱乐、商务等环境而设计的一款便携式LED投影设备，让你随时随刻享受大屏幕的精彩生活。

本机集成高性光学投影引擎功能，良好简洁的用户操作界面，从而提高可靠性和易用性。

- LED驱动DLP技术，随时带给你更鲜艳、明亮和流畅的视频感受。
- 投影技术用的是0.3” DMD，LED三色（RBG）投影；
- 854X480像素分辨率，屏幕比例16：9，投射距离0.3~3M；80LM@7w；
- RGB三基色LED，超过1万小时使用寿命，更自然的色彩；对比度900:1；
- HDMI/MHL信号输入；
- 可显示1670万种色彩；
- 4000mAh 锂电池播放，无须外接电源（约播放2~4小时）；
- 投影机可对手机、平板等充电。

(本产品 and 用户手册有待进一步改进或补充恕不另行通知)

主要安全事项

为保证安全使用本产品，请按照使用说明进行操作；

使用前主要事项

- 不要随意拆卸、改装。抛掷、跌落投影机，否则会造成投影机损坏；
- 投影机出现故障只能由专业人员进行维修；
- 电池是集成设备，不要修改。电池只能由合格的服务人员更换；
- 请不要将金属或尖锐物品插入投影机通风口，或掉入投影机中。这样会导致投影机的损坏。遇到这种情况，请迅速关闭电源，并联络售后维修人员处理；
- 请勿于投影机上面放置液体，若液体溅入投影机内部，请联络服务中心，请求维修投影机；
- 请在通风良好，温度0~35摄氏度/湿度0~85%的环境中使用本投影机；
- 请不要阻挡出风口和散热口，不要把投影机放在被褥、毛毯等其他柔软物表面上使用；切勿用布或其他物体覆盖整机使用，投影机通风口严重受阻，内部过高的温度会损坏投影机，可能引起火灾的危险；
- 不要在强光和强磁场中使用本投影机；

- 不要在脏污、灰尘中使用本投影机；
- 使用投影机时，切勿直视投影机光束，强光可能损害眼睛；

维护和保养

- 请使用柔软干燥布来清洁投影机表面和镜头；

注意事项

- 勿使用苯或其他稀析剂等易燃物质清洁本产品；
- 勿使用指甲或其他尖锐物清洁镜头；
- 勿使用湿布或水直喷到产品表面来清洁本产品；
- 如产品进水，会引起触电、火灾或故障；
- 如投影仪镜头表面有水，可能出现白点；
- 产品的外观或颜色可能因型号而异；
- 清洁投影仪内部，请联系服务中心；
- 投影仪内部有积尘或异物请联系服务中心。

主要安全事项

- 电源相关事项
- 插紧电源插座；
- 勿使用破损电源线；
- 勿湿手拔插插头；
- 勿过弯或过度缠绕电源线；
- 使用中移动本设备时，请保证在电源线有效线长内；
- 使用完毕或充电完毕时请将电源插头拔开。
- 摆放相关事项
- 散热孔四周不要有物体挡着，以防机器过热；
- 轻拿轻放本产品；
- 推荐安装支架使用，以保证良好的散热。
- 使用时注意事项
- 勿筷子、硬币、发夹等金属物或尖锐的物体插入投影机通风口或插口；
- 如若进水或异物进入，立即关闭电源并联络服务中心；
- 勿置重物与投影机上。

- 勿直视投影机镜头；
- 请不要反复快速的拨动开关；
- 拨动到关机状态后，请在电源指示灯熄灭后，再拨动到开机位置。

其他事项

- 产品表面长时间开机工作后约有40度，属正常现象，请小心手持设备移动；
- 当投影机因跌落等因素导致外壳裂或机器破裂时，请致电服务中心；

摆放和连接

包装清单

| 投影机 | 电源适配器 | AC线 | MHL线 | 三星转接头 | 支架 | 用户手册 | 保修卡/合格证 |
|---|---|---|---|---|--|---|---|
|  |  |  |  |  |  |  |  |

投影机外形视图

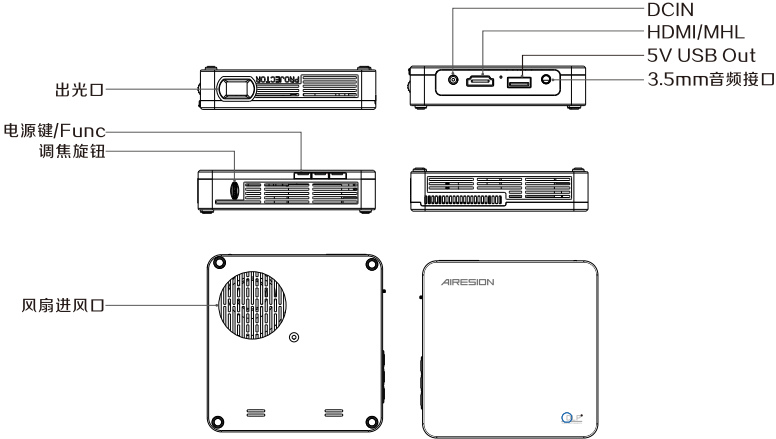

投影光线出口、调焦、喇叭单元出声口

投影光线出口

- 如图中所示，投影光线出口；投影光线出口前方至显示画面之间不要有物体阻挡；
- 勿用眼睛直接观看投射出来的光束；
- 勿用尖锐物品碰到光机镜片。

调焦旋钮

- 推动令旋钮转动，直到画面聚焦，精确显示；
- 精密部件，勿暴力按压旋钮；
- 屏幕尺寸大小随投影机离显示画面距离的变大而变大，旋钮只调节聚焦而无法调节画面大小。

喇叭单元出声口

- 不要有物体阻挡声音的传播；
- 因为本投影机追求便携性能，喇叭单元尺寸较小，如需要更高音质，请外接高性能音频设备。

外接电源输入接口 DCIN

- 如图中所示的DCIN使用本机包装内附带的电源适配器，通过此接口连接电源插座和投影机之间，从而对机器充电，直接供电投影机工作。
- 请使用配送的适配器，切勿使用来源不明，功率不足，或者规格不对的其他适配器。本适配器规格必须是12V电压， 2A或者2A以上的更大电流。

USB 5V OUT

- 如图中所示的USB接口，使用包装内附带的USB线，实现对手机、相机等电子设备的锂电池充电；关机状态轻按电源键开启此功能。（注：在开机状态时，若接入MHL设备，此时USB对外充电功能关闭）

音频输出接口

- 使用音频输出接口，连接投影机设备和更高端音频设备，尽享视听娱乐。

HDMI接口

连接视频设备，DVD机，电视，机顶盒等

- 使用HDMI /HDMI或HDMI /DVI缆线（未提供）连接投影机的HDMI端口与视频设备的HDMI端口。

连接手机等HDMI设备

- 使用HDMI-MHL缆线连接投影机的HDMI端口与手机等设备的MHL端口。
注意：HHL为即插即用，若不能显示，请确认您的设备是否支持MHL,您可与设备制造商联系确认。

连接电脑

- 使用HDMI缆线连接投影仪的HDMI端口与PC的相关端口。笔记本电脑自带HDMI接口的可以直接用大小头HDMI缆线（未提供）连接。

蓝牙功能

- 开机状态下，按下Func键，调到“蓝牙”项，按音量+或者音量-，打开或关闭蓝牙。连接蓝牙音响时，需将音响调节为对码或等待连接状态，然后打开投影机蓝牙功能，投影机会自动连接。

三个功能键操作

- 开机状态时，接入HDMI/MHL视频信号短按电源键，可打开功能菜单，不断按下电源按键会出现不同的“主”菜单内容，具体参考后面的（4.4使用屏幕调整菜单）；
- 使用+，-键向不同方向选择不同“主”菜单内容下面的“子”菜单选项；再使用FUNC键确认。

开关键操作

- 关机状态时，长按电源键两秒，红色电源指示灯闪亮，约等2秒后，绿灯亮投影机会进入开机状态；
- 开机状态时，长按电源键两秒，画面显示关机，约三秒后投影机进入关机状态；
- 当投影机进入工作状态时，会有轻微的风扇噪声和投影机的振动感，属于正常现象。

指示灯显示状态（如下图）

| | 橙色 | 绿色 | 熄灭 |
|----|------------|------|--------|
| 左灯 | 充电中 | 电池充满 | 未连接充电器 |
| 右灯 | USB 5V充电开启 | 开机 | 关机 |

风扇进出风口

- 投影机属于高热产品，过高的温度会导致投影机设备死机，工作寿命锐减，这些都是建立在良好的散热风道的情况下的，但使用产品时，各进风口和排风口对机器内部温度均有重大影响，特别是风扇附近的进出风口，使用投影机时，请确保这部分的四周空气流畅。

使用方法

产品功能

- 采用新型DLP技术的光学引擎，显示屏采用854X480像素。采用3原色LED光源，寿命长达10000小时以上，最高亮度为80流明；
- 多个输入端口，提高了与外围设备（例如USB、DCin、HDMI等）的连接能力；
- 音频输出，配有高达1W的双扬声器，完全满足日常演示、听歌、看视频的应用；
- 自定义调整，可对每个输入端口进行调节；
- 便捷的功能键操作。

产品正面、背面和侧面



使用屏幕调整菜单



没外接信号电源的情况下开机出现如上图所以（无信号，调不出任何菜单）



接入信号，按“▲”、“▼”键可直接调节音量

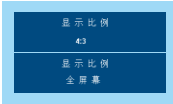

按下FUNC键，如上图，按动“▲”“▼”键，令下面的一行在全屏幕或4:3中切换

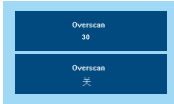

按下FUNC键，如上图，按动“▲”“▼”键，令下面的一行在Off或者数字40~50中切换



按下FUNC键，如上图，按动“▲”“▼”键，令下面的一行在电影/标准/游戏/图片/鲜艳/中切换

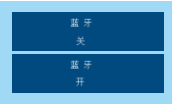

按下Func键，如上图，按下“▲”“▼”键，可打开或关闭蓝牙



按下FUNC键，如上图，按动“▲”“▼”键，令下面的一行在中文或者英文中切换

投影机尺寸和投影距离

转动调焦旋钮精确调整焦距，以获得清晰图像，投影机尺寸和投影距离如下：

| 全屏画面尺寸（单位：英寸） | 投影距离（单位：米） |
|---------------|------------|
| 26~28 | 1m |
| 41~43 | 1.5m |
| 55~57 | 2m |

以上数据只供参考，建议在40~60寸之间使用

移动电源功能

- 在投影关机状态下,短按电源键开启此功能，此时右灯亮橙色，可以对外部设备充电。如果10秒钟内没有连接被充电设备,本机自动关机,右灯熄灭,停止输出5V。如需要再次启动，请短按电源键开启。
- 在投影开机状态下，USB或者HDMI端子（需要MHL线材）会自动对外部设备充电。不论投影开机或者关机，USB或者HDMI端子只有一个可以输出5V，本机自动识别。

常见故障排除

| | 故障现象 | 解决方案 |
|---------|------------|-------------------------|
| 故障现象 | 已断电 | 检查电源缆线连接 |
| | 需要支架 | 请选用选配支架配件 |
| | 无法选择外部输入电源 | 确保正确连接至设备正确端口 |
| 屏幕和外部来源 | 看不到画面图像 | 确保电源线正确连接或电池有电（没外接电源时） |
| | | 确保选择了正确的输入来源 |
| | | 检查连接器是否正确连接投影机背部端口 |
| | 图像不清晰 | 调整焦距 |
| | | 确保在有效投影范围内（0.2米以上） |
| | 噪声异常 | 确认非风扇噪音外的其他声音，请联络当地服务中心 |
| | 信息灯乱闪 | 请参阅信息灯工作状态指示 |
| | 仅显示蓝屏 | 请确保外部设备正确连接，再检查缆线 |
| 按键和菜单 | 按键不起作用 | 检查菜单中色度、亮度、对比度等调节 |
| | | 检查输入信息源是否正确 |
| | | 检查电池是否有电（非外接电源时） |
| | | 顶部指示灯是否处于工作状态 |

更多信息

| | |
|--------|--------------|
| 产品名称 | LED微型投影仪 |
| 分辨率 | 854X480 |
| 显示系统 | DLP |
| 光源 | RGB三原色LED |
| 色域 | 大于110% |
| 电源 | DC12V |
| 整机功耗 | 24w |
| 外形尺寸 | 100x100x22mm |
| 重量 | 160克 |
| HDMI端口 | 标准 |
| 音频端口 | 标准 |
| 扬声器 | 8Ω/1W x 2 |
| USB端口 | 标准 |
| 工作温度 | 0~35℃ |
| 相对工作温度 | 10%~90% |

Catalog



| | |
|--|----|
| Introduction and features | 21 |
| Important notes | 22 |
| Matters need attention before usage | 22 |
| Use care and maintenance | 23 |
| Safety Caution | 24 |
| Placing, connection Functions of keys | 25 |
| Packing list | 25 |
| External View of Projector | 26 |
| Lighting exit of Projector, Focusing, and Exit of Speaker Unit | 27 |
| Input port of external power supply DCIN | 28 |
| USB 5V OUT | 28 |
| Output Port for Audio device | 28 |
| HDMI Port | 28 |
| Connection With Cellphone etc Hdmi Devices | 29 |
| Connection With Computer | 29 |

Catalog



| | |
|---|----|
| Bluetooth function | 29 |
| The operation of three function buttons | 30 |
| The operation of ON/OFF key | 30 |
| Instruction of indicator light | 30 |
| Air inlet of fan | 31 |
| Usage | 31 |
| The front, back and side faces of the Product | 32 |
| Menu adjustment by screen | 33 |
| The Dimension and distance of the Projector | 34 |
| The function of portable charger | 34 |
| Common Trouble Shooting | 35 |
| More Information | 36 |

Introduction and features

Thank you for using our LED Projector!

By reading this manual, you can learn the usage of this projector and experience the perfect function and simple operation. The device is a portable LED projector designed for family, entertainments, business etc, which allows you to enjoy the colorful life of large screen.

This projector is integrated with high-performance projection engine function, and simple, good users interface, resulting in the improvement of reliability and usability. The technology of LED driver can bring you more colorful, brighter and smoother video entertainment at any time any place.

- The DLP technology of LED driver brings you more colorful, brighter and smoother entertainment of video.
- With resolution to be 854X480, the scale of screen is 16:9,the distance of projection is from 0.3m to 3m;50Lm@7w;
- RGB tri-phosphor LED, the service life is over 10 thousand hours, with more natural color; Contrast ratio is 700:1;
- HDMI/MHL signal input;
- 16700 thousands of color is available to display;
- Display by 4000mAhLi battery, without the connection of external power supply (around 2-4H);
- This projector is also capable of charging mobile phone, tablet etc.

(This product and manual may be further improved without notification.)

Important notes

In order to use this projector safely, please operate it according to this manual.

Matters need attention before usage

- Please do not disassemble, re-assemble, throw, or drop the device, otherwise damage to the device will be caused.
- Only professionals are allowed to repair it upon malfunction .
- Please don't change the battery as it's integrated .Only qualified service personal are allowed to change it.
- Please don't insert metal or sharp objects into vent or drop them into projector. This will damage the projector. Please turn off the device and contact with after-sales upon above situation.
- Please don't place any liquid on top of the projector and contact with after-sales requiring for repair in case of liquid-dropping into the device.
- Please use this device under the circumstance of good ventilation, temperature to be 0~35℃, humidity to be 0~85%.
- Please don't block the vent and thermovent, and don't use it on cover, carpet etc soft objects; Covering the machine with cloth or other objects to operate the machine is forbidden. If the vent is severely blocked, internal temperature will be over-high and will damage the machine,

which will finally cause fire.

- Please don't use this machine under strong light or a strong magnetic field.

Use care and maintenance

Please use soft and dry cloth to clean the surface and lens of the projector.

Matters need attention:

- Please don't use benzol or other dilute agent or inflammable objects to clean this product.
- Please don't use snails or other sharp objects to clean the lens.
- Please don't clean the product with wet cloth or spray it with water directly.
- If the product is inflowed with water, electric shock, fire or malfunction may happen.
- If there is water on lens appearance of the projector, white spot may appear.
- The cosmetic or color may differ by different models.
- If you need to clean the internal of the projector, please contact service center for help.
- If there is dust or foreign matters in the projector, please contact with service center for help.

Safety Caution

- Relative matters with power supply.
- Plug tightly with the power supply socket.
- Please don't use damaged power cord.
- Please don't plug or insert by wet hands.
- Please don't over-bend or twist the power cord.
- Please make sure the power cord is long enough when moving the projector.
- Please unplug the plug after usage or charging.
- Relative matters with the placing of the projector.
- Make sure there is no object blocking the vent in case of over-heat.
- Please place the projector softly.
- It is recommended to use the holder to make sure good heat dissipation.
- Matters need attention in usage
- Please don't insert chopsticks, coins, hairpins etc metal objects into vent or plug socket.
- If the product is inflowed with water, please turn off the device and contact with service center.
- Please don't put any heavy object on the Projector.
- Please don't watch directly into the lens of the Projector.

- Please don't slide the switch button quickly over and over again.
- Please only turn on the machine again after the power supply indicator turning-off upon the switch status of OFF.

Other matters:

- After a long time of working, the surface temperature of the device will be around 40 degree, but it's normal, please move the device carefully.
- When the housing or machine is broken by dropping etc, please contact with service center.
- Please note that after the turn-off of the Projector, the body machine will be still high, and the fan will still last running for around 10 seconds.

Placing, connection

Packing list

| The Projector | Adapter | AC wire | MHL wire | USB Convert | Triangle Stand | Users manual | Warranty card/ Certificate of Approval |
|---|---|---|---|---|--|---|---|
|  |  |  |  |  |  |  |  |

External View of Projector

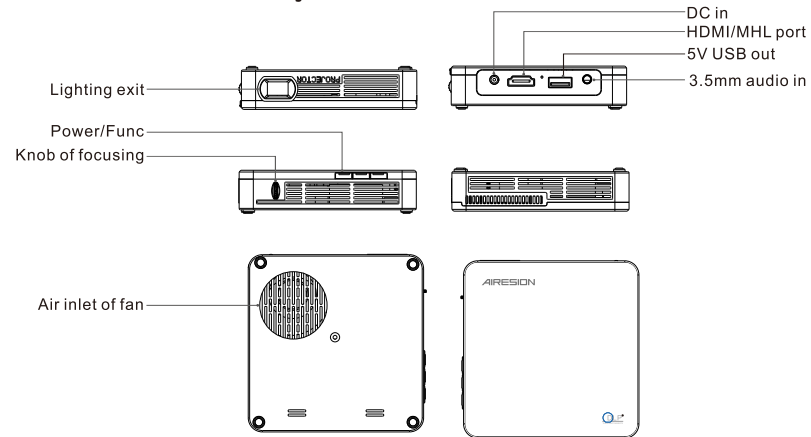

Lighting exit of Projector, Focusing, and Exit of Speaker Unit

Light exit of the Projector

- As shown in the image, please don't put any objects between the front of light exit and the showing image.
- Please don't watch directly into the light from projection.
- Please don't click the lens with sharp objects.

Knob of focusing

- Rotate the focusing knob to focus the image.
- This is a Precision Component, please don't press it hardly .
- The size of screen will change along with the change of distance of the Projector from the showing image. This knob only adjust the focusing degree, but not the size of the showing image.

Exit of Speaker Unit

- Please make sure there is no object blocking the transmission of the sound.
- As this projector is in the pursuit of portable performance, the size of Speaker Unit is small, if you need higher tone quality, please connect a high-quality audio device externally.

Input port of external power supply DC IN

- Please use the adapter attached in the package, shown in the image. By this connector to connect the machine with power socket for charging or powering up the projector.
- Please use the adapter attached in the package, unknown, with insufficient power or wrong specification adapters are forbidden to use. Adapter for this machine is with 12V voltage and 2A or up current.

USB 5V OUT

- By using USB connector, shown in image, as well as the attached USB cord in package, can achieve the function of charging Li-battery of cell phones, camera etc electronic devices. Press the power key gently to start this function under the status of power off.
(Remark: If connected with MHL device under the status of power on, the function of charging external devices by USB wire will be turned off.)

Output Port for Audio device

- Using output Port for Audio device to connect the Projector and a higher end audio device to enjoy the video entertainment.

HDMI port

- Connection with video device, DVD, TV, STB etc.

By HDMI port or HDMI/DVI wire (not in attachment) to connect the projector and other video device.

- **Connection With Cellphone Etc Hdmi Devices**

To connect the HDMI port of the projector and the MHL port of the cellphone etc devices by HDMI-MHL wire.(Note:MHL is plug and play. If it doesn't show up, please check if your device support MHL, and you can confirm with the manufacturer of your device.)
Conne

- **Connection With Computer**

To connect HDMI port of the Projector and the relative port of the PC by HDMI wire. For notebook, its built-in HDMI port can be connected with A-C HDMI wire(not in attachment).

Bluetooth function

Press FUNC key when the machine is on, and adjust the menu to "Bluetooth", then press Vol+ or Vol - to open or turn off the function of Bluetooth.

In order to connect the Bluetooth Speaker, please adjust the speaker to be code or the status of waiting for connection. Then open the Bluetooth function in the projector, it will connect them automatically.

The operation of three function buttons

- Connect HDMI/MHL video signal under the status of power on,Short Press Power key to display function menu, different menu contents will appear by pressPower key continuously. Please refer to 4.4 Menu adjustment by screen for details.
- To selectsubmenu under menu by +/- keys, and to confirm by FUNC key.

The operation of ON/OFF key.

- Press the power key for 2 seconds under the status of OFF, the power indicator of red light will flash on, and around 2 seconds later, the green light will be on, it means the machine is power on.
- Press the power key for 2 seconds under the status of ON, the screen will display turning off the machine,and around 3 seconds later, the machine will be turned off.
- It is normal to have slight noise from the fan and vibration from the Projector when it's working.

Instruction of indicator light

| | Orange light | Green light | OFF |
|-------------|---------------------------------|-------------------|-----------------------------|
| Left light | Charging | Charging complete | Non-connection with Adapter |
| Right light | Startup of charging with USB 5V | Turn-on status | Turn-off status |

Air inlet of fan

- The Projector is a high temperature product. Over-high temperature will cause the projector crash and the working life decrease. Those depend on good heat-dissipation passages; Every air inlet and outlet are important to the internal temperature of the machine, especially those around the fan. Please make sure the air flow is good around this part when using the projector.

Usage

Product functions

- Employ Optical Engine of new DLP technology, with the resolution of the screen is 854x480. Adopt three-primary-color LED light source, with the working life can achieve above 10000 H. The brightness in high-lite mode is 50 lumen.
- More than one pieces of input ports, this increases the connection with external devices(such as USB,DC in, HDMI etc).
- Audio out: Facilitated with up to 1W speaker, which can totally meet the requirements of daily demonstration , listening music and watching video etc.
- User-defined adjustment, which can adjust each input port.
- Convenient operation of functional keys.

The front, back and side faces of the Product



Menu adjustment by screen



Image without external signal after turning on the machine, (Menus won't appear without signal).

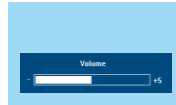

▲/▼ keys can adjust the volume directly without external signal.

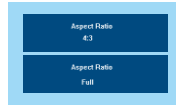

Press FUNC key, as above image, full screen display and 4:3 display. then by pressing ▲/▼ keys to switch between

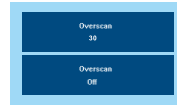

Press FUNC key, as above image, then by pressing ▲/▼ keys to switch between OFF and figure 40-50.



Press FUNC key, as above image, then by pressing ▲/▼ keys to switch between movie, standard, game, picture and color.



Press Func key, shown as above image, by press ▲/▼ to turn on and off the function of Bluetooth.



Press FUNC key, as above image, then by pressing ▲/▼ keys to switch between Chinese and English.

The Dimension and distance of the Projector

By rotating the focusing knob to adjust the image and get the clear image. The Dimension and distance of the Projector are as below:

| Full screen (unit: inch) | Project distance (unit: M) |
|--------------------------|----------------------------|
| 26~28 | 1m |
| 41~43 | 1.5m |
| 55~57 | 2m |

Above data are only for reference. It is suggested to use the machine between 40 to 60 inch.

The function of portable charger

- In order to start this function, please short press the power key when the machine is turned off, and the right light will be orange. USB can be used to charge external devices. If there is no external device being connected with the projector within 10 seconds, it will shut down automatically, the right light will be off, and it will stop 5V output. Please short press the power key again for using this function again.
- The projector will charge external devices automatically through USB or HDMI port (MHL wire will be needed). when it's turned on. No matter it's off or no, it only support one port to output 5V, either USB or MHL port. The machine will identify itself.

Common trouble shooting

| | Toubles | Solution |
|-----------------------------|--|--|
| Installation and connection | Power outage Need holder Unable to select external Input power supply | Check the connection with the power supply |
| | | Please use attached holder in item list. |
| | | Make sure the connection with the device is correct. |
| Screen and external source | No images | Make sure the connection is correct, or the battery is well charged (when there is no external power supply). |
| | | Make sure you have chosen the correct input source. |
| | | Check if the connector with the port on back face of the Projector is well connected or not. |
| | Unclear images | The adjustment of focal length |
| | | Please make sure it's in valid distance (above 0.2 meters); |
| | Abnormal noise | Please check if the noise come from other parts except the fan.If yes, please contact with local service center. |
| | Flicking indicators | Please refer to the introduction of indicator status. |
| | Only display Blue screen | Please make sure the connection with external device is correct, then check the wires. |
| Key and menu | The image is too dark bright or abnormal | Check the adjustment of color degree, brightness, contrast ratio etc in menu. |
| | | Check if the input signal source is correct or not. |
| | | Check if the battery is well charged or not when there is no external power supply |
| | | Check the top indicator is normal or not. |

More information

| | |
|---------------------------|-------------------------------|
| Product name | LED Portable Projector |
| Resolution | 854X480 |
| Display system | DLP |
| Light source | RGB three-primary colours LED |
| Colour gamut | > 110% |
| Power supply | DC12V |
| Power Consumption | 24w |
| Dimension | 100x100x22mm |
| Weight | 160g |
| HDMI Port | Standard |
| Audio Port | Standard |
| Speaker | 8 /1W x 2 |
| USB Port | Standard |
| Working temperature | 0~35 |
| Relative working humidity | 10%~90% |

FCC Statement:

This device complies with part 15 of the FCC Rules. Operation is subject to the following two conditions: (1) This device may not cause harmful interference, and (2) this device must accept any interference received, including interference that may cause undesired operation.

This equipment has been tested and found to comply with the limits for a Class B digital device, pursuant to part 15 of the FCC Rules. These limits are designed to provide reasonable protection against harmful interference in a residential installation. This equipment generates, uses and can radiate radio frequency energy and, if not installed and used in accordance with the instructions, may cause harmful interference to radio communications. However, there is no guarantee that interference will not occur in a particular installation. If this equipment does cause harmful interference to radio or television reception, which can be determined by turning the equipment off and on, the user is encouraged to try to correct the interference by one or more of the following measures:

- Reorient or relocate the receiving antenna.
- Increase the separation between the equipment and receiver.
- Connect the equipment into an outlet on a circuit different from that to which the receiver is connected.
- Consult the dealer or an experienced radio/TV technician for help.

Caution: Any changes or modifications not expressly approved by the party responsible for compliance could void the user's authority to operate the equipment.