

Quick Start Guide

TCL

Getting to know your Alcatel SMARTFLIP™



Phone setup

1. Remove back cover by gently pulling up on the indentation on the bottom left of the cover.
2. Insert the NANO SIM card by carefully sliding it into the SIM slot with the gold contacts facing down and the slanted corner to the left.
3. Insert the optional microSD™ card into the microSD slot, ensuring that the gold contacts are facing down and the flat edge is facing up.
4. Insert the battery, making sure the gold contacts align. Gently push down on the battery until it clicks into place.
5. Replace the back cover, pressing firmly on the sides to ensure the cover snaps back into place.

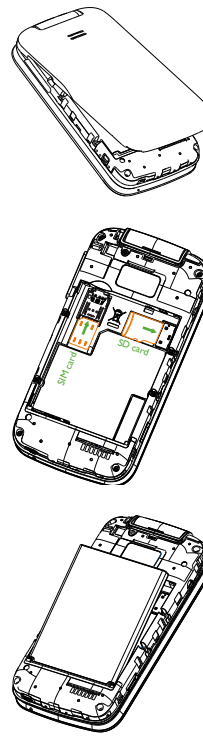

Personalize

Set wallpaper

1. From the Home screen, press **OK** (OK) to open app list.
2. **Navigate** (N) to **Settings** (S) and press **OK** (OK) to select.
3. **Navigate down** (D) to **Display** and press **OK** (OK) to select.
4. **Navigate down** (D) to **Wallpaper** and press **OK** (OK) to select.
5. **Navigate** (N) to select one of the wallpaper, then press the **Left Menu** (L) to view, or press **OK** (OK) to select.

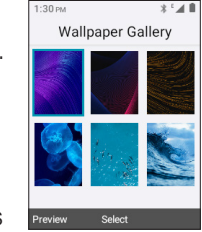

Lock and unlock your screen

To create a passcode

1. From the Home screen, press **OK** (OK) to open app list.
2. **Navigate** (N) to **Settings** (S) and press **OK** (OK) to select.
3. **Navigate down** (D) to **Phone settings** and press **OK** (OK) to select.
4. **Navigate down** (D) to **Security > Screen Lock** and press **OK** (OK) to select.
5. **Navigate** (N) to **On**, and press **OK** (OK) to enable lock screen with password.
6. Create a 4 digit passcode using the dial pad, press **OK** (OK) to next.
7. Enter this passcode once again and press **OK** (OK) to create.

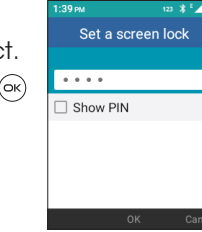

To lock the phone screen

Closing the phone will lock the screen.

To unlock the phone screen

Open the phone and enter your password using the dial pad to unlock the screen.

Calls and Voicemail

HD Voice Capable

HD Voice means clearer conversations with reduced background noise when both participants are using HD Voice compatible phones and the call is made over Cricket's LTE network or a compatible network.*

Make a Call

1. From the Home screen, enter the phone number then press **Call/Answer** (C) to place the call.
2. If you make a mistake, press the **Back key** (B) to delete the incorrect digits.
3. You can also press **Call/Answer** (C) to access your **Call log**. **Navigate down** (D) to scroll and select the desired number. Press **Call/Answer** (C) to place the call.
4. During the call, you may press **Left Menu** (L) to mute, **Right Menu** (R) to open options, or **OK** (OK) to enable speaker.
5. To end the call, press **Power/Hang Up key** (P).

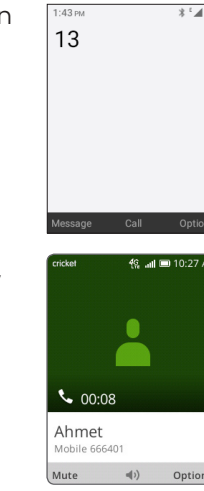

Check voicemail

Press and hold (1) to call and listen to your voicemail.

* To experience Cricket HD Voice, both callers must have a compatible HD Voice capable device and make the call over Cricket's LTE Network or a compatible network. Cricket's LTE coverage is not equivalent to its overall network coverage. HD Voice calls made on a compatible device and on the LTE network may not experience an HD Voice connection at times of network congestion. Other carriers' networks may interoperate with Cricket's LTE network to support an HD Voice call.

Text and picture messaging

Send a Text Message

1. From the Home screen, press **OK** (OK) to open app list.
2. **Navigate** (N) to **Message** (M) and press **OK** (OK) to select.
3. Press **Left Menu** (L) to create a new message.
4. Enter the phone number of the recipient in the **To** bar, or press **Right Menu** (R) to **Select from Contact** or **Select contact group**.
5. **Navigate down** (D) to access SMS bar to type in the message.
6. Press **OK** (OK) to send text message.

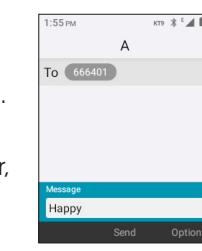

Send a Multimedia Message

1. Repeat steps 1-4 above.
2. Press **Right Menu** (R) to access **Options**.
3. **Navigate down** (D) to **Add Attachment** and press **OK** (OK) to select.
4. Select Pictures, Videos, Audio or Contact to attach.
5. Once your image is attached, press **OK** (OK) to send.

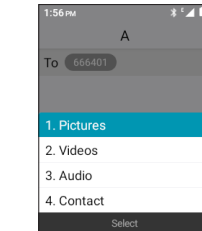
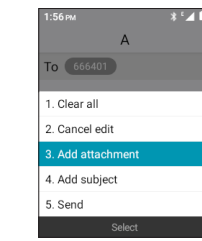

More information

On the web

Detailed support information including a full user manual and device specifications are available at www.cricketwireless.com/support/devices

On the phone

- Call Customer Care at **1-855-246-2461** or
- Dial **611** from your cell phone

Accessories

- Battery
- Micro USB charger
- Cricket SIM card
- Quick start guide
- Safety information guide
- Terms of service

For more information about accessories, please visit your local Cricket store or go to www.cricketwireless.com/shop/accessories.

Note: Store and online inventories may vary.

Product meets FCC Radio Frequency Exposure Guidelines—FCC ID 2ACCJN059. This device complies with Part 15 of the FCC Rules. Operation is subject to the following two conditions: (1) this device may not cause harmful interference, and (2) this device must accept any interference received, including interference that may cause undesired operation. © 2022 Cricket Wireless LLC. All rights reserved. Cricket and the Cricket logo are registered trademarks under license to Cricket Wireless LLC. Alcatel is a trademark of Nokia used under license by TCL Communication Technology Holdings Limited. SMARTFLIP is a trademark of TCL Communication Technology Holdings Limited. © 2022 TCT Mobile Limited. All rights reserved.

Camera and video

Take a Picture

1. From the Home screen, press **OK** (OK) to open app list.
2. **Navigate** (N) to **Camera** (C) and press **OK** (OK) to select.
2. Press **OK** (OK) to take a photo.

Record a Video

1. With the **Camera** (C) open, press **Right Menu** (R) to access **Options**.
2. Press **OK** (OK) to select **Take video** to switch to video mode.
3. Press **OK** (OK) to start/stop recording.

Access Pictures or Videos

Pictures and videos are saved in the **Gallery** (G) app.

1. From the Home screen, press **OK** (OK) to access the app list.
2. **Navigate** (N) to **Gallery** (G), and press **OK** (OK) to select.
3. Select a picture or a video and press **Right Menu** (R) to access options such as Delete, Edit, and Share.

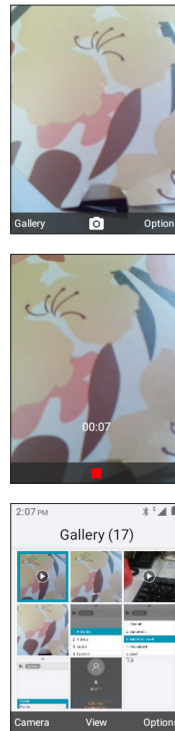

E-Mail

Email setup (Gmail®, Yahoo!, etc.)

1. From the Home screen, press **OK** (OK) to open app list.
2. **Navigate** (N) to **Tools > Email** (E) > one of the Email providers and press **OK** (OK) to select.
3. Press **Right Menu** (R) to select **Next** and set up your email account.
4. Follow the required steps by entering your name, email address, password, and other fields. Once complete, you will be able to access your email account from this device.

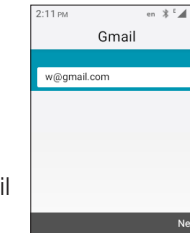

Note: Press (M) key to enter special characters like the @ symbol.

Create and send an email message

1. Press **Left Menu** (L) to **compose** a new email from the Inbox screen.
2. Enter recipient(s) email address(es) in the **To** field, press **OK** (OK) to confirm and add new recipient(s).
3. Type the subject and the content of the message.
4. If necessary, press **Right Menu** (R) to add **Cc/Bcc** or add attachment to the message.
5. If you do not want to send the mail right away, press **Right Menu** (R) and select **Save as draft** to save a copy.
6. Press **Left Menu** (L) to send.

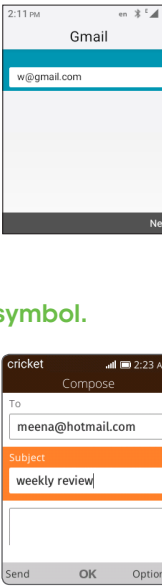

Mobile Web

Browse the web

1. From the Home screen, press **OK** (OK) to open app list.
2. **Navigate** (N) to **Browser** (B) press **OK** (OK) to select.
3. **Navigate up** (U) to Search or type URL, then use the keypad to enter either search criteria or a website address. Press **OK** (OK) to search or load the website.
4. Use **Navigation** (N) to scroll around the webpage, and use **OK** (OK) to select links when browsing.
5. Press **Back key** (B) to return to the previous page.

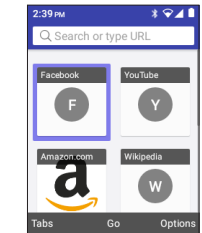

Connectivity

Connect your Bluetooth device

1. From the Home screen, press **OK** (OK) to open app list.
2. **Navigate** (N) to **Settings** (S) and press **OK** (OK) to select.
3. Highlight **Wireless & networks** and press **OK** (OK) to select.
4. **Navigate down** (D) to **Bluetooth** and press **OK** (OK) to select.
5. Press **Left Menu** (L) to **Turn on** to enable Bluetooth.
6. Once your desired Bluetooth device shows in the list, **Navigate** (N) to the device and press **OK** (OK) to pair. If asked, confirm passkey to complete pairing.
7. Once your device is paired, it will show up in **PAIRED DEVICES** list in the Bluetooth menu.

Connect to a Wi-Fi network

1. Follow steps 1-3 above.
2. **Navigate down** (D) to **Wi-Fi** and press **OK** (OK) to select.
3. Press **Left Menu** (L) to **Turn on** to enable Wi-Fi.
4. **Navigate** (N) to the desired Wi-Fi connection and press **OK** (OK) to select.
5. **Navigate** (N) to **Password** and use keypad to enter Wi-Fi password.
6. Press **OK** (OK) to **Connect**.

Useful Tools

Use these tools to keep you organized and entertained.

- Gallery:** View photos and organize your photos.
- Recorder:** Recording Voice.
- Calendar:** Keep your schedule in your pocket. Track your events with notes and get schedule reminders.
- Clock:** Set alarms, use the timer or stopwatch to keep you on track.
- Note:** Add and view note list.
- Calculator:** Figure out tips, add up your bills and other calculations.
- Music:** Listen to music loaded on or downloaded to your phone.
- My Cricket:** Sign in to view your account, features.

Using Navigation

Getting Started

- **Navigate** (N) is located above the number pad that frames **OK** (OK).
- Press Up, Down, Left, or Right on the ring to navigate the screen.
- To make a selection, press **OK** (OK).
- Shortcuts accessible from the Home screen:
 - **Navigate up** (U) to access Settings.
 - **Navigate down** (D) to access Recent apps list.
 - **Navigate left** (L) to access Email.
 - **Navigate right** (R) to access Contacts list.
 - Press **OK** (OK) to access the App tray.

