

TCL 30_{SE}

QUICK START GUIDE

SAVE
PAPER
SAVE
TREES

PLEASE CONSIDER THE
ENVIRONMENT BEFORE PRINTING



English - CJB2J80LCAAA

Printed in China

6165A

Your Mobile

Keys and connectors

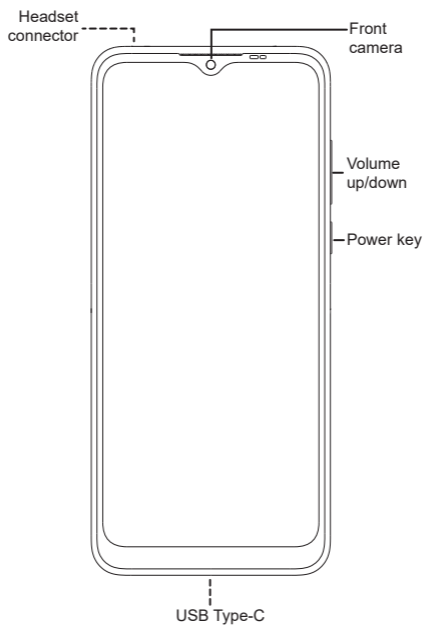

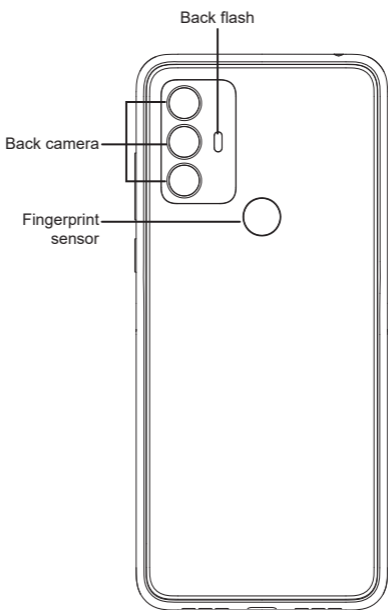

Getting started

- ① Charge the battery.

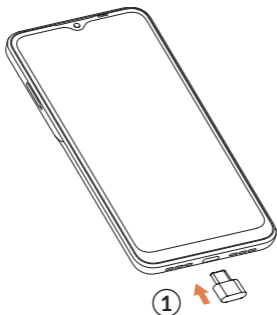

- ② Insert or remove the microSD card.
- ③ Insert or remove the SIM card.

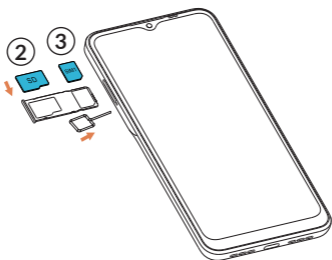

Home screen

You can bring all of the items (applications, shortcuts, and folders) that you use most frequently to your Home screen for quick access.

Touching the **Home** button always takes you back to the main Home screen.

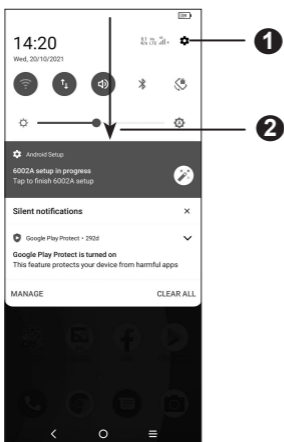

- 1 Open **Settings** to view the full list of settings
- 2 Touch and drag down to open the Notification panel



Phone call

Making a call

Enter the desired number from the keyboard and touch  to make a call.

Answering a call

When you receive a call:

- Touch **ANSWER**, or swipe up  to answer;
- Touch **DECLINE**, or swipe down  to reject;
- Touch  **Reply** to reject the call by sending a preset message.

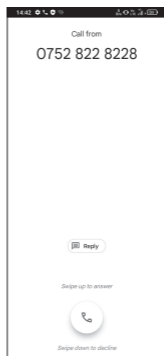

Contacts

You can view and create contacts on your phone and synchronize these with your Gmail contacts or other applications on the web or on your phone.

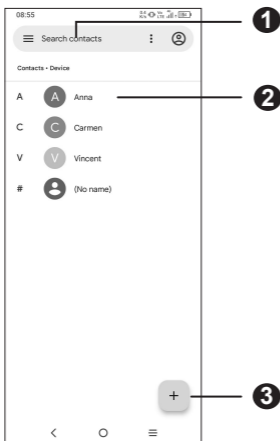

- 1** Search in **Contacts**
- 2** Open the Quick contact panel
Touch and hold to share or delete the selected contact
- 3** Add new contact

Messaging

You can create, edit, and receive SMS and MMS.

An SMS will be converted to MMS automatically when media files (image, video, audio, etc.) are attached or subject or email addresses are added.

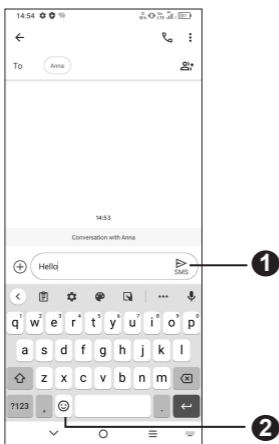

- 1 Send the text message
- 2 Insert emoticons

Gmail

The first time you set up your phone, you can select to use an existing Gmail account or to create a new one.

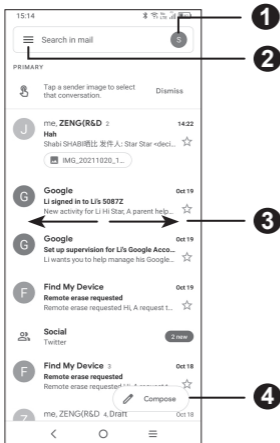

- 1 Account information
- 2 See options and settings
- 3 Swipe right or left to archive the email
- 4 Create an email

Help

- Check out the TCL website at tclusa.com for tutorials and answers to frequently asked questions, and to download the User Manual.
- To get support for your phone, visit the TCL website: <https://www.tcl.com/mx/es.html>
- Update your phone's software
Go to **Settings > System > System Update** to check software updates.
- Back up your personal data
Go to **Settings > System > Backup > Backup by Google One** and turn it on.
- Reset your phone
Go to **Settings > System > Reset > Factory data reset > RESET PHONE.**



General Information

- Visit the TCL website at <https://www.tcl.com/mx> for tutorials and answers to frequently asked questions, and to download the User Manual.
- To get support for your phone, visit the TCL website (<https://www.tcl.com/mx/es/service-support-mobile.html>), or dial the number listed below:

Argentina: 08001220682

Chile: 800000147

Colombia: 18009520823

Ecuador: 800000635

Mexico: 8008909908

Peru: 080000698

The Dominican Republic: 8887600164

Uruguay: 405296624

Venezuela: 08001005368