

合格证
QC PASS

深圳市神牛摄影器材有限公司

地址: 深圳市宝安区福海街道塘尾社区耀川工业区厂房2栋
电话: 0755-29609320(8062) 传真: 0755-25723423 邮箱: godox@godox.com

GODOX Photo Equipment Co., Ltd.

Add: Building 2, Yaochuan Industrial Zone, Tangwei Community, Fuhai Street, Bao'an District,
Shenzhen, China Tel: +86-755-29609320(8062) Fax: +86-755-25723423 E-mail: godox@godox.com

godox.com

Made in China



Godox

双色温LED摄影灯
Bi-color LED Video Light

SL100^{Bi}

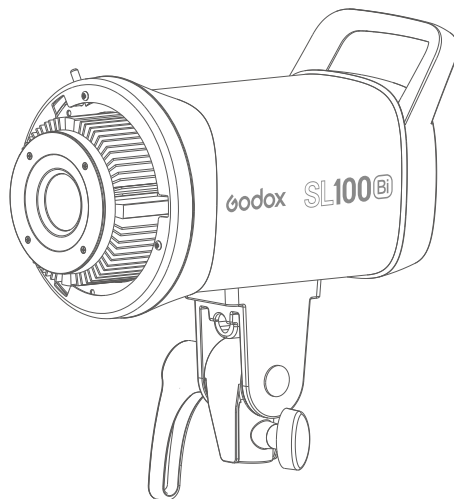

使用手册
Instruction Manual

Foreword

Thank you for purchasing Godox product!

SL Series LED Video Light SL100Bi is suitable for live recording, video shooting, and many other occasions with stable light resource, even illumination and adjustable color temperature.

Features:

- Freely adjust color temperature from 2800K to 6500K
- With stable light source and adjustable light brightness from 0% to 100%
- With 11 Fx special effects mode to simulate various of shooting scenes
- Can be remote controlled by 2.4G and smartphone APP
- Bowens-mount support various of accessories
- Clear LCD display
- With excellent heat dissipation

Warning

When using your photographic equipment, basic safety precautions should always be followed, including the following:

- ⚠ Read and understand all instructions before using.
- ⚠ Close supervision is necessary when any appliance is used by or near children. Do not leave appliance unattended while in use.
- ⚠ Care must be taken as burns can occur from touching hot parts.
- ⚠ Do not operate appliance with a damaged cord or if the appliance has been dropped or damaged – until it has been examined by a qualified serviceman.
- ⚠ Position the cord so that it will not be tripped over, pulled, or contact hot surfaces.
- ⚠ If an extension cord is necessary, a cord with a current rating at least equal to that of the appliance should be used. Cords rated for less amperage than the appliance may overheat.
- ⚠ Always unplug appliance from electrical outlet before cleaning and servicing and when not in use. Never yank cord to pull plug from outlet. Grasp plug and pull to disconnect.
- ⚠ This appliance is not waterproof device. To reduce the risk of electric shock, do not immerse this appliance in water or other liquids.
- ⚠ Do not disassemble. Should repairs become necessary, this appliance must be sent to an authorized maintenance center. Incorrect maintenance behavior may cause electric shock when the appliance is subsequently used.
- ⚠ When this appliance is working, please do not cover the Thermovent, and please do not look directly at or touch the COB lamp beads under any circumstances.

Name of Body

• Light Head

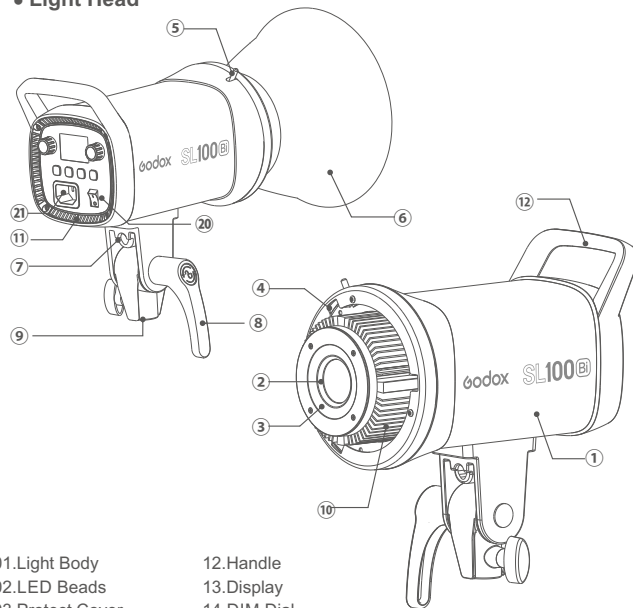

- 01.Light Body
- 02.LED Beads
- 03.Protect Cover
- 04.Bowens-mount
- 05.Accessory Locking Ring
- 06.Reflector
- 07.Umbrella Input
- 08.Direction Adjust
- 09.Bracket
- 11.Air Inlet

- 12.Handle
- 13.Display
- 14.DIM Dial
- 15.CCT/FX Dial
- 16.FX Button
- 17.GR Button
- 18.CH Button
- 19.Bluetooth
- 20.Power On/Off
- 21.Power Jack

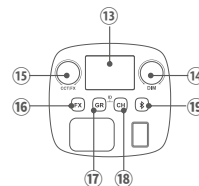

LCD Panel

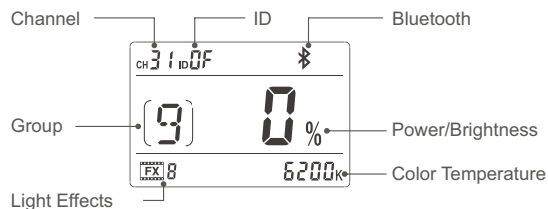

What's in the Box

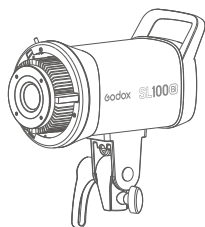

Light Body *1

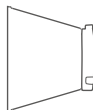

Reflector *1



Protection Cover *1



Power Cord *1



Instruction Manual *1

Optional Accessories

The product can be used in combination with the following accessories sold separately, so as to achieve best photography effects: RC-A6 Remote Control, Power Inverter, Softbox, Photographic Umbrella, Light Stand, Honey Comb, Beauty Dish, Snoot, etc.

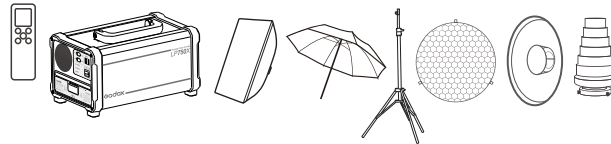

Power Source

Connect the LED light to power source with power cable. Then, press the power switch to turn it on off.

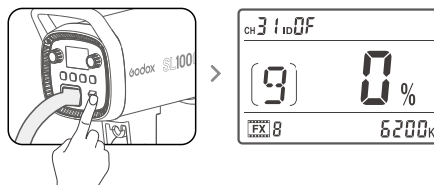

Operation

Brightness Adjustment: turn the DIM dial to adjust brightness from 0% to 100%. Turn the CCT/FX dial to decrease the value while rightwards to increase. And adjust 1 value in normal operation while 10 values in quick operation.

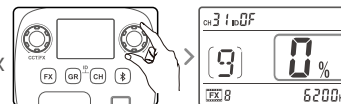

Color Temperature Adjustment:

in LED continuous lighting mode, turn the CCT/FX select dial to adjust color temperature from 2800K to 6500K. Turn the select dial on the left to decrease the value while rightwards to increase.

Switch 100 unit values at normal speed and 500 unit values at quick speed.

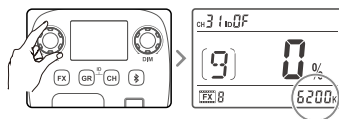

Light Effects Mode

Short press the FX button to enter or exit the special effects. When entering the FX modes, FX icon will be displayed on the LCD panel. Then, turn the CCT/FX select dial on the left to choose one mode from the 11 special effects modes to achieve creative shooting.

Display	FX1	FX2	FX3	FX4	FX5	FX6	FX7	FX8	FX9	FX10	FX11
Scene	Flash 1	Flash 2	Flash 3	Storm 1	Storm 2	Storm 3	TV	Broken	Candle	Fire	Firework

2.4G Wireless Setting

With 2.4G wireless system, LED Video Light SL100Bi has receive and control function. Up to 16 groups of LED lights can be controlled. 32 channels and 99 wireless IDs are available with strong anti-interference capability. Please set the channels, groups and IDs of LED light to the same as those of RC-A6 remote control (optional) before usage.

CH Channel adjustment: short press CH button and the CH values will be blinking on the display. Turn the DIM dial on the right to adjust channels from 1 to 32. Turn the select dial leftwards to decrease the value while rightwards to increase. Press the CH button again to confirm.

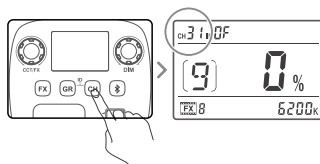

GR Group adjustment: short press GR button and the GR values will be blinking on the display. Turn the DIM dial on the right to adjust groups from 0 to 9 and A to F. Turn the select dial leftwards to decrease the value while rightwards to increase. Short press the GR Button again to exit from GR setting.

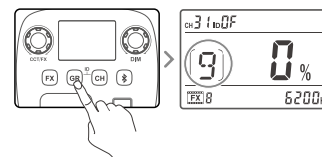

ID Setting: long press the CH and GR button together until the ID values is blinking on the display. Turn the DIM dial on the right to adjust IDs from OFF and 1 to 99. Turn the select dial leftwards to decrease the value while rightwards to increase. Then, long press CH and GR button to exit from ID setting.

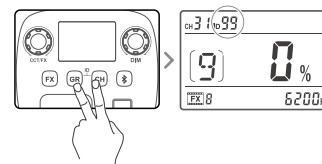

Bluetooth Setting

1. Bluetooth MAC code checking: short press the Bluetooth button until Bluetooth MAC code is displayed. Press the Bluetooth button again and the MAC code will disappear. And the code will be displayed after returning to the main interface.

2. Scan the QR code to download the "GodoxLight" smartphone APP(can be used in Android and Apple). For more smartphone APP operations, please open the "help" in APP to gain detailed guidance.



3. Bluetooth reset function: long press the SET button for 2 seconds and the Bluetooth icon will blink because of resetting. And the icon will stop blinking after being successfully reset.

Note: The APP can be used directly on the firstly installed device (smartphone or iPad). When change to other mobile device (smartphone or iPad), the light shall be reset before the normal connection of APP.

Failures Reminder

-  lighting indicates fan failure,  flashing indicates failure.
-  lighting indicates high temperature alarm,  flashing indicates high temperature protection status and light automatically enters the shutdown procedure.

Technical Data

LED Light	SL100Bi
Power Supply	AC100V~240V(50/60HZ)
Output Power	100W
Channel	32
Group	16(0~9/A B C D E F)
ID	OFF/1 -99
Color Temperature	2800K~6500K
Light Adjustment Range	0%~100%
100% Illuminance(LUX) (with standard reflector, testing distance, 1m)	Max. 32100
CRI	≥96
TLCI	≥97
Temperature of Working Environment	-10° - 40°
Light Effect Mode	11
Control Method	Smartphone APP/2.4G Wireless
Bluetooth Transmission Distance	≈30m
2.4G Wireless Transmission Distance	≈30m
Beam Angle	120°
Dimension	243*205*127mm
Net Weight	1.6kg (not include reflector)
BT Frequency Range	2402.0-2480.0MHz
Max. Transmitting Power	5dbm

Changes made to the specifications or designs may not be reflected in this manual.

Maintenance

- This product, except consumables e.g. battery, power cable and connect cable, is supported with a one-year warranty.
- Avoid sudden impacts and the product should be dedusted regularly.
- Maintenance of the flash must be performed by our authorized maintenance department which can provide original accessories.
- Unauthorized service will void the warranty.
- If the product had failures or was wetted, do not use it until it is repaired by professionals.
- Changes made to the specifications or designs may not be reflected in this manual.

FCC Statement

This device complies with part 15 of the FCC Rules. Operation is subject to the following two conditions: (1) This device may not cause harmful interference, and (2) this device must accept any interference received, including interference that may cause undesired operation.

Any Changes or modifications not expressly approved by the party responsible for compliance could void the user's authority to operate the equipment.

Note: This equipment has been tested and found to comply with the limits for a Class B digital device, pursuant to part 15 of the FCC Rules. These limits are designed to provide reasonable protection against harmful interference in a residential installation. This equipment generates uses and can radiate radio frequency energy and, if not installed and used in accordance with the instructions, may cause harmful interference to radio communications. However, there is no guarantee that interference will not occur in a particular installation. If this equipment does cause harmful interference to radio or television reception, which can be determined by turning the equipment off and on, the user is encouraged to try to correct the interference by one or more of the following measures:

- Reorient or relocate the receiving antenna.
 - Increase the separation between the equipment and receiver.
 - Connect the equipment into an outlet on a circuit different from that to which the receiver is connected.
 - Consult the dealer or an experienced radio/TV technician for help.
- To maintain compliance with FCC's RF Exposure guidelines, This equipment should be installed and operated with minimum distance between 20cm the radiator your body; Use only the supplied antenna.

Warranty

Dear customers, as this warranty card is an important certificate to apply for our maintenance service, please fill in the following form in coordination with the seller and safe-keep it. Thank you!

Product Information	Model	Product Code Number
Customer Information	Name	Contact Number
	Address	
Seller Information	Name	
	Contact Number	
	Address	
	Date of Sale	
Note:		

Note: This form shall be sealed by the seller.

Applicable Products

The document applies to the products listed on the **Product Maintenance Information** (see below for further information). Other products or accessories (e.g. promotional items, giveaways and additional accessories attached, etc.) are not included in this warranty scope.

Warranty Period

The warranty period of products and accessories is implemented according to the relevant Product Maintenance Information. The warranty period is calculated from the day (purchase date) when the product is bought for the first time. And the purchase date is considered as the date registered on the warranty card when buying the product.

How to Get the Maintenance Service

If maintenance service is needed, you can directly contact the product distributor or authorized service institutions. You can also contact the Godox after-sale service call and we will offer you service. When applying for maintenance service, you should provide valid warranty card. If you cannot provide valid warranty card, we may offer you maintenance service once confirmed that the product or accessory is involved in the maintenance scope, but that shall not be considered as our obligation.

Inapplicable Cases

The guarantee and service offered by this document are not applicable in the following cases: ①. The product or accessory has expired its warranty period; ②. Breakage or damage caused by inappropriate usage, maintenance or preservation, such as improper packing, improper usage, improper plugging in/out external equipment, falling off or squeezing by external force, contacting or exposing to the improper temperature, solvent, acid, base, flooding and damp environments, etc; ③. Breakage or damage caused by non-authorized institution or staff in the process of installation, maintenance, alternation, addition and detachment; ④. The original identifying information of product or accessory is modified, alternated, or removed; ⑤. No valid warranty card; ⑥. Breakage or damage caused by using illegally authorized, nonstandard or non-public released software; ⑦. Breakage or damage caused by force majeure or accident; ⑧. Breakage or damage that could not be attributed to the product itself. Once met these situations above, you should seek solutions from the related responsible parties and Godox assumes no responsibility. The damage caused by parts, accessories and software that beyond the warranty period or scope is not included in our maintenance scope. The normal discoloration, abrasion and consumption are not the breakage within the maintenance scope.

Maintenance and Service Support Information

The warranty period and service types of products are implemented according to the following **Product Maintenance Information**:

Product Type	Name	Maintenance Period(month)	Warranty Service Type
Parts	Circuit Board	12	Customer sends the product to designated site
	Battery	3	Customer sends the product to designated site
	Electrical parts e.g.battery charger, power cord, sync cable, etc.	12	Customer sends the product to designated site
Other Items	Flash tube, modeling lamp, lamp body, lamp cover, locking device, package, etc.	No	Without warranty

Godox After-sale Service Call 0755-29609320-8062