

Item No.:DLB502-SP

Installation guide

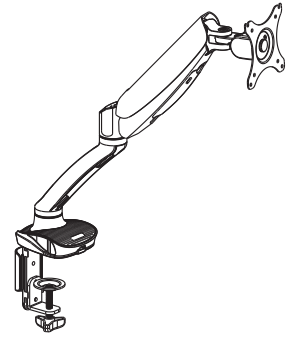

VESA
100x100
75x75

10"~27"

max
1.5-5kg

-85°~15°

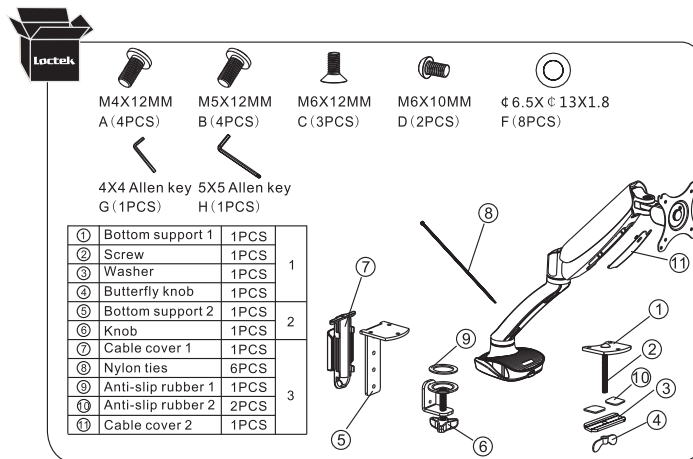

STEP1

Preparations before installing monitor

- 1.Make sure there are VESA holes 100x100mm or 75x75mm in the monitor.If not, the mount couldn't be installed.
- 2.Remove the original fixed base of monitor.Be careful not to scratch the screen.

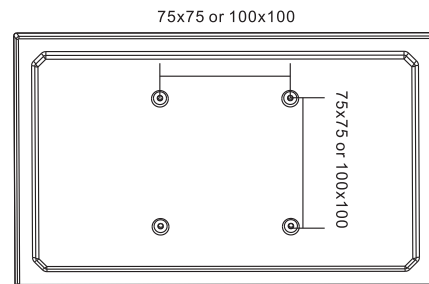

STEP2-A

Option 1:Install the bracket to the desk

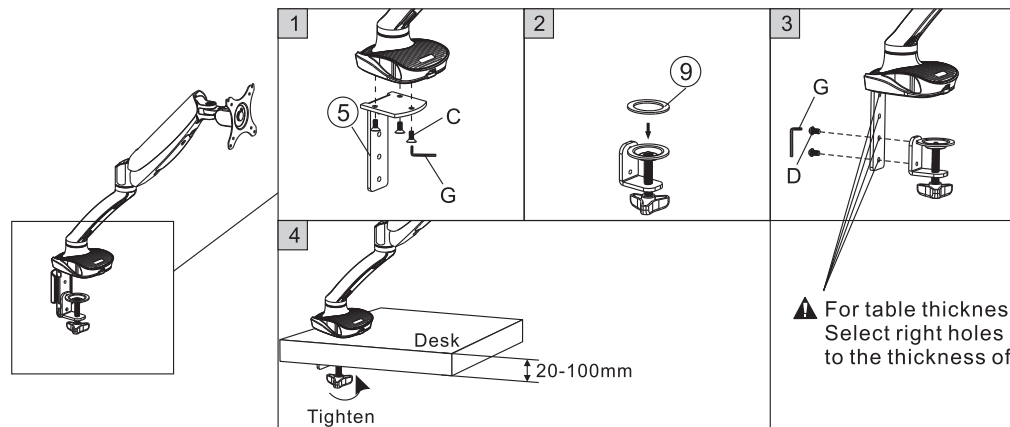

STEP2-B

Option 2:Install the bracket to the desk

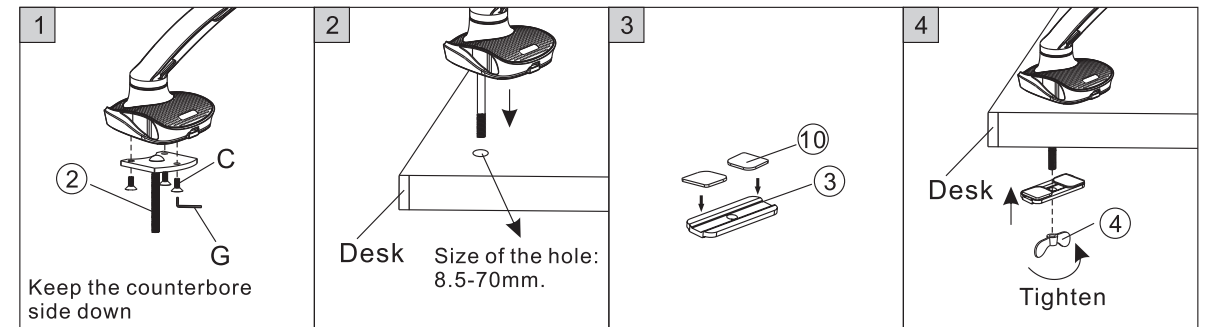

STEP3

Attaching the monitor to the plate

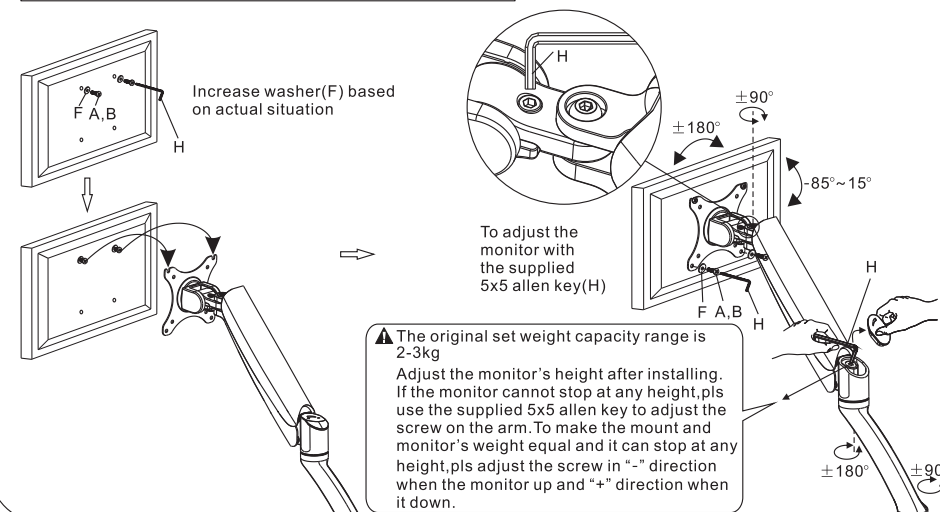

STEP4

Using cord management

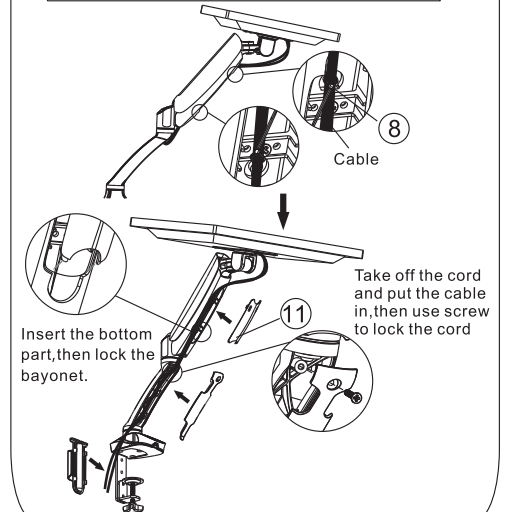

STEP5

Data cable attachment instructions

USB port connection is transferred from the computer chassis to the base front of the desktop mount. The signal input port is to supply sound signal to the speaker.

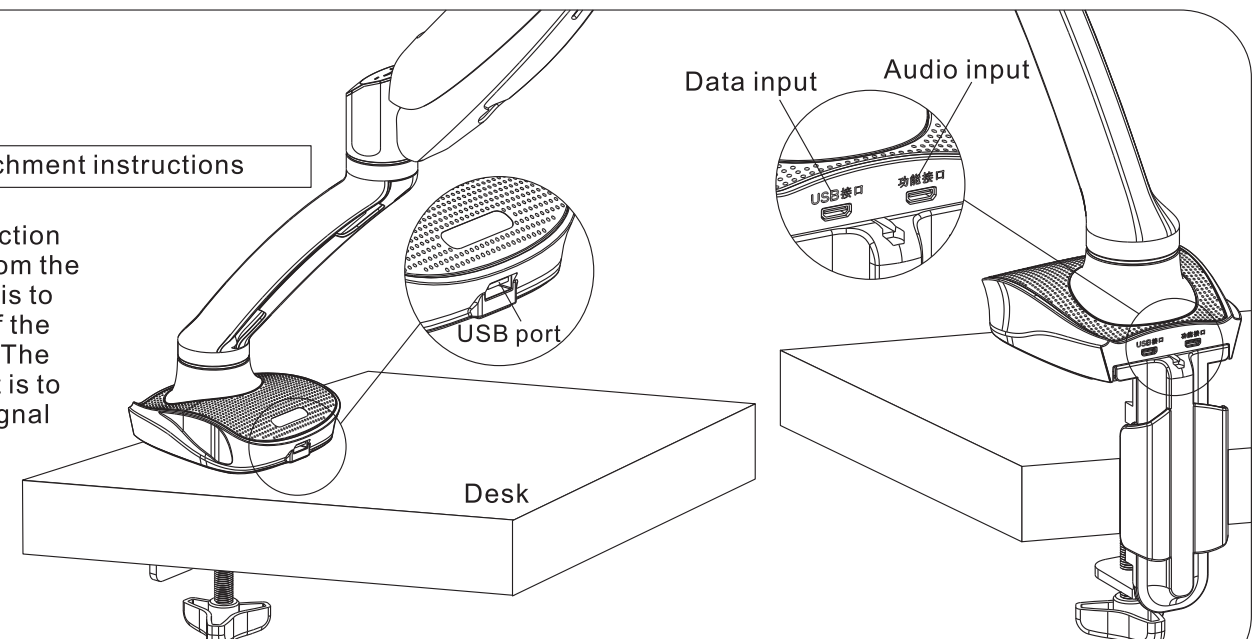



CAUTION

- This product contains small items that could be a choking hazard if swallowed.Keep these items away from young children.
- Make Sure these instructions are read and completely understood before attempting installation.If you are unsure of any part of this installation,please contact a professional installer for assistance.
 - The desk or mounting surface must be capable of supporting the combined weight of the mount and the display,otherwise the structure must be reinforced.
 - Safety gear and proper tools must be used.A minimum of two people are required for this installation.Failure to use safety gear can result in property damage,serious injury or death.
 - please check joint parts every two months,making sure the screws are loosened or not.

This product was designed to be installed on desk.Before installing, make sure the mount will support the combined load of the equipment and hardware.Never exceed the maximum load capacity 5 KG,or else it may result in product failure or personal injury.

Note:this product is intended for indoor use only.Use of this product outdoors could lead to product failure or personal injury.

Warning:

- 1.This product contains high pressure gas spring parts, please do not put it into fire, high temperature, or disassemble it, which will lead to unexpected personal injury. The obsolete products can be sent back to the manufacturer or handed over to professional institutions.
To ensure the sealing performance of the gas spring, it is suggested to have complete adjustment to the upper arm (with spring) one time or several times every month.
- 2.This device complies with part 15 of the FCC Rules. Operation is subject to the following two conditions: (1) This device may not cause harmful interference, and (2) this device must accept any interference received, including interference that may cause undesired operation.
- 3.Changes or modifications not expressly approved by the party responsible for compliance could void the user's authority to operate the equipment.

Manufacturer: Loctek Visual Technology Corp.
Factory Address: No.588 Qihang South Road,Binhai Industrial Zone,Yinzhou District,Ningbo China. ZIP code: 315145
Tel: 86-574-88070236/88070218
Fax: 86-574-88098788
Email: sales1@china-logitek.com sales2@china-logitek.com
Web: www. loctek.com
www.globalsources.com/logitek.co
www.china-logitek.com