

Hair removal & rejuvenation instrument User Manual

Model: B208



Beijing Anchorfree Technology Co.,Ltd.

Content

Chapter 1 Product Introduction	4
Chapter 2 Product Safety	6
2.1 Optical Safety	6
2.2 Electric Safety	6
2.3 Fire Protection	6
2.4 Safety Device	7
2.5 Safety Signs	7
Chapter 3 Specifications	7
3.1 Technical Specifications	7
3.2 Environment Request	7
3.3 Tip Type and Operation Items	8
Chapter 4 Installation	8
4.1 Connect Power Line	8
4.2 Change Tip	8
Chapter 5 Operation	9
5.1 Start Device	9
5.2 Operation Board	9
5.3 Handpiece Operation	10
Chapter 6 Maintenance	10
6.1 Daily maintenance	10
6.2 Service	10
Chapter 7 Repair Guide	11
Chapter 8 Clinical Treatment	11
8.1 Working Mechanism	11
8.2 About Operation	12
8.3 Operation Procedure	12
8.4 Result	13
8.5 Discomfortable Feeling	13
8.6 Notes after Treatment	13

Company Introduction

Beijing Anchorfree Technology Co., Ltd. was established in 2003, which is a government-supported high-tech company. In 2008, we took part in China Chamber of International Commerce (CCOIC) and serve as an honorary member. Since its inception, the company has been adhering to the "integrity, pragmatic; innovative, progressive" business philosophy, insisting on "Professional, Exceptional" slogan, focusing on R & D, manufacturing, sales and service of non-invasive medical and cosmetic equipments.

By nearly 10 years of hard work in the domestic market, the company won a good reputation and rapid development. At present, our products cover 7 series like CO2 fractional laser, mid-infrared 1550nm fractional laser, 808nm hair removal diode laser, IPL (intense pulsed light), RF (RF), E-light, water oxygen jet system, vacuum / cavitation / cryolipolysis system.etc. These totally about 50 models are exported to five continents in over 80 countries.

In 2007 we completed ISO9001 and ISO13485 international quality system certification as the first in China. With the efforts the vast majority of our products have been given medical CE certification; we have established a strong R & D center with nearly 30 people in R&D team. A number of our research results have filled the domestic blank and got patents, among which 4 results got invention patents, 8 results got utility model patents.

Beijing Anchorfree actively promotes the international development strategy, and has established a close working relationship with many international well-known agents. We have set up overseas branches like Anchorfree (Japan) Co., Ltd., Anchorfree (Hong Kong) International Co., Ltd., BTF.etc. In future we will still increase international market efforts to expand and promote the progressive realization of branding, marketing, team, technology, management to meet the international standards.

Looking ahead, we will seize the opportunity to increase the product innovation ability, speed up the process of internationalization and achieve scale development of economical leaps. Anchorfree bounds to become internationally competitive, internationally renowned leading enterprise of medical and beauty equipments, to establish "Anchorfree" as an international brand, to achieve the dream of "repay to the community and serve for the customer" of Anchorfree people!

Telephone: 0086-010-81504710

Fax: 010-81502271

Web: www.anchorfree.com

Chapter 1 Product Introduction

1.1 Parts Introduction

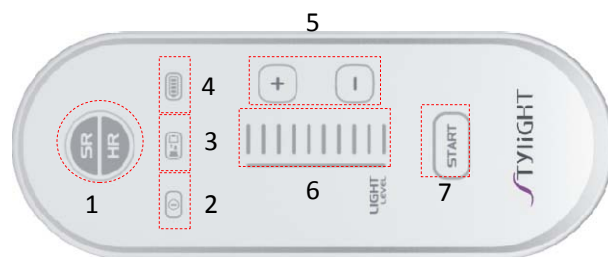
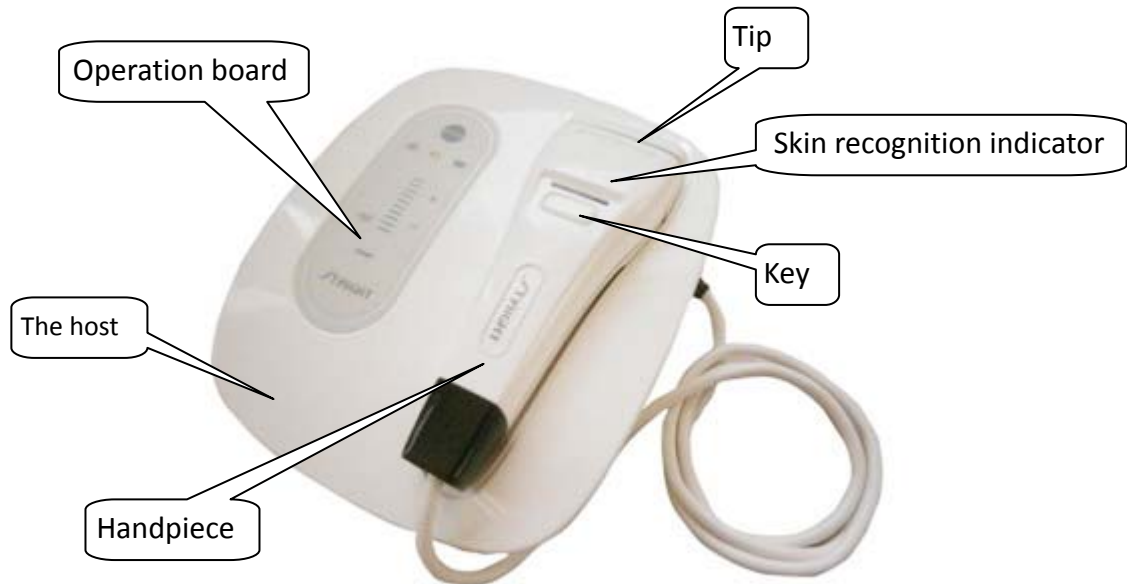

1. Mode indicator
2. Power supply light
3. Tip life indicator
4. Charging indicator
5. Energy level adjusting
6. Energy level
7. Standby/Ready

1.2 Packing List



(The host+handpiece) ×1



Warranty card×1



User manual×1



Power line×1



Tip×1

1.3 label

1) Handpiece LOGO



2) Product nameplate



Class II equipment

Degree of protection against electric shock: type BF applied part

WEEE-Waste Electronic Electrical and Electronic Equipment



CE Mark



PSE Mark



Follow operating instructions



Chapter 2 Product Safety

2.1 Optical Safety

- 1) Avoid any light reflected by jewelry, watch, mirror etc;
- 2) Intense light can harm eyes and cause fire or burning. Don't directly watch the light from the tip. You shall wear glasses or use opacity material for eyes protection;
- 3) Send much light energy to skin can cause skin hurt;
- 4) When you don't use the equipment, please cut off the power supply and put the handpiece on the stand;
- 5) Keep the tip clean and keep the tip glass from stick any other things;
- 6) Before change the tip, the equipment shall be at standby situation

2.2 Electric Safety

- 1) Be sure that rated input voltage written on the label is coincident with the supply in the location (AC100v-240v、50Hz/60Hz) ;
- 2) The maintain process can only be carried out after the power has been shut off and the electric line has been unplugged. Otherwise, there is danger to the personnel or the equipment;

2.3 Fire Protection

- 1) Don't use this equipment near something easy to get burnt or get explosion;
- 2) Take protective measures to prevent the intense pulse light from lighting the treating room or flammable nearby;
- 3) If this equipment is not used for long time, you shall cut off the power supply

2.4 Safety Device

Fuse: When there is more electricity, use will automatically disconnect to protect equipment and person.

2.5 Safety Signs

“AC100V-240V 50Hz/60Hz” is power supply

Chapter 3 Specifications

3.1 Technical Specifications

Working mode	①HR (hair removal) ② SR (skin rejuvenation)
Tip kinds	2 kinds
Spectra scope	530nm~1100nm/650nm~1100nm
Tip size	4.4cm×1.6cm
Energy density	0 ~ 7J/cm ²
Pulse number	2(HR) /5 (SR)
Energy level	1~ 10
Power supply	AC100V-240V, 50Hz/60Hz
Rated input power	150W
Net weight	1.75kg
Equipment size	L270mm×W230mm×H120mm
Package size	L300mm×W300mm×H135mm

3.2 Environment Request

- 1) Environmental temperature of working: 10°C ~ 30°C
- 2) Environmental temperature of store: -10°C ~ 55°C
- 3) Relative humidity of working: ≤70%
- 4) Relative humidity of store: ≤93%
- 5) Air pressure: 860hPa ~ 1060hPa
- 6) Environment request: avoid direct radiation of intense light

Note:

If the temperature in the room is too low, or the equipment has not been used for many days, the temperature of the whole system must recover to 15 °C or higher. And then start the equipment.

3.3 Tip Type and Operation Items

Type	Tip size	Item	Wave length
HR	44mm×16mm	Hair removal	530nm-1100nm
SR	44mm×16mm	Skin rejuvenation	650nm-1100nm

Chapter 4 Installation

4.1 Connect Power Line

Connect power line to the host (following picture):



4.2 Change Tip

1) Connect A with A1 and connect B with B1 (following picture)

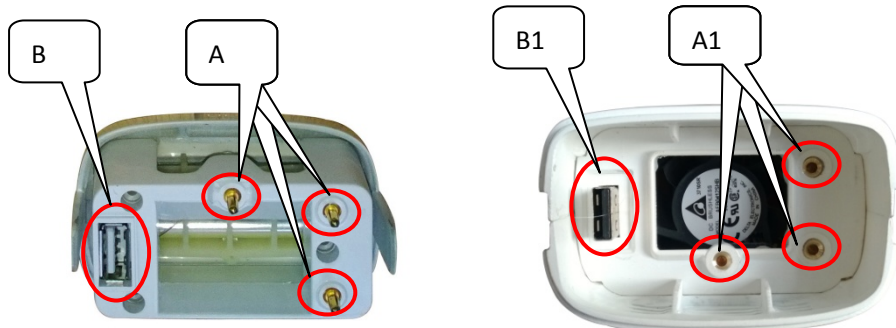

- 2) The change is finished (following picture)



Chapter 5 Operation

5.1 Start Device



- 1) Connect power supply; indicator light is red and SR or HR will start;



5.2 Operation Board

- 1) **Mode selection:** Connect different tips, the equipment will change to relative working mode automatically (SR light means skin rejuvenation mode, HR light means hair removal mode)

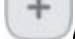
- 2) **Standby/Ready selection:** Press  key to change to Standby or Ready

- 3) **Energy level adjustment (Ready situation):** Press  /  key to adjust energy level

5.3 Handpiece Operation



(This is the light in handpiece and the key in handpiece)



Start the equipment and press ;

Then the light in handpiece will illuminate;

Make the tip touch skin and the lights in handpiece will illuminate;

Press the key in the handpiece and then the tip makes shots, three blue lights will flash;

HR makes 2 shots and SR makes 5 shots, after that the handpiece will make charging for 5s;



After treatment, press and stop power supply

Chapter 6 Maintenance

6.1 Daily maintenance

Each day, after using the machine, use a piece of wet rag to wipe the host and the tip

6.2 Service

When you ask for our after sale service, you have to provide this equipment's product number and guarantee card.

Note:

If you maintain and modify this machine without allow, the beauty operator may be in the danger of voltage;

The guarantee will be invalid if you use or adjust this machine improperly.

Chapter 7 Repair Guide

Trouble	Troubleshooting
Device could not start	Connect the power line well
	Contact with us
Skin could not be identified	Change the tip
	Contact with us
Can not make shots	The lights in handpiece will not illuminate
	Change the tip
	Contact with us
The touch keys is not sensitive	Contact with us

Chapter 8 Clinical Treatment

8.1 Working Mechanism

The skin absorbs light energy selectively; IPL works on skin and results in light-biology action which changes the inner construction of fiber and collagen to stimulate collagen growth and recover its elasticity

1) Treatment items:

- Hair removal: Hair of arms and legs, hairline, lip hair, armpit hair;
- Skin rejuvenation: Whole body, improve coarse pores and bad skin conditions

2) Energy level scope:

Hair removal: Whiter skin-----energy level 4-7;
 Blacker skin----- energy level 3-5
 Skin rejuvenation: Whiter skin-----energy level 4-7
 Blacker skin----- energy level 3-5

3) Treatment course

Hair removal: 5-7 days each time, can use this device for a long period;

Skin rejuvenation: 5-7 days each time, can use this device for a long period;

8.2 About Operation

1) Adjust energy level

- a) Adjust energy level from low to high: Don't adjust much for one time;
- b) Test before operation: watch whether the shot is normal before treatment;
- c) Deep color skin shall use low energy level;

2) Note during operation

- 1) Long hair can absorb more light energy and this may hurt skin. So before hair removal, cut off the longer hair (leave hair 2~3mm long) ;
- 2) Forehead, upper lip, chin —Skin is very thin, so use low energy level; Customer may feel a little pain during hair removal;
- 3) Make the tip fully touch skin to ensure skin absorb enough light and heat;
- 4) During HR operation mode, delay between two treatments shall be 30s

8.3 Operation Procedure

- 1) Clean skin;
- 2) Start equipment and adjust relative energy level;
- 3) We advise users to wear goggles;
- 4) HR mode: first make test on skin with no hair: if skin turns a little red and a little heat, it means the energy level you set is available, then you can remove hair;
- 5) SR mode: first make test on skin under jawbone: if skin turns a little red and a little heat, it means the energy level you set is available, then you can treat with face from the bottom up;
- 6) Make treatment on entire parts; During treatment watch skin's reflection for adjusting in time;
- 7) Clean treated parts after treatment;
- 8) Treated skin needs moisturizing and avoid sunshine

Suggestion:

- A) Before treatment, smear some beauty products on skin with moisturizing, whitening or renovating functions according to skin's situation;
- B) After treatment, use home beauty products on skin with moisturizing, whitening or renovating functions to make skin smooth and shiny

8.4 Result

After treatment if skin turns a little red, a little heat and last for long, a little pain, hair is curve, it means the treatment is successful;
Normally each treatment needs 1-2 times' continual shots.

8.5 Discomfortable Feeling

During treatment, customer may feel differently;
Some may feel himself is bit by small mosquito;
After hair removal, skin may feel hot for an hour

8.6 Notes after Treatment

1. If there are blain and ulceration coming into being in the skin after the treatment, it is recommended to use antibiotic ointment and anti-burn ointment to treat.
2. Customer can use high multiple sunscreen and keep the skin moistly.
3. After treatment, skin around the treated parts may be fragile, if this, customer shall not make up and avoid friction (since it may cause skin hurt)
4. NOTE: This equipment has been tested and found to comply with the limits for a digital device, pursuant to Part 18 of the FCC Rules. These limits are designed to provide reasonable protection against harmful interference in a residential installation. This equipment generates, uses and can radiate radio frequency energy and, if not installed in accordance with the instructions, may cause harmful interference to radio communications. However, there is no guarantee that interference will not occur in a particular installation. If this equipment does cause interference to radio or television reception, which can be determined by turning the equipment off and on, the user is encouraged to try to correct the interference by one or more of the following measures:

- o.Reorient or relocate the receiving antenna
- o.Increase the separation between the equipment and receiver
- o.Connect the equipment into an outlet on a circuit different from that to which the receiver is connected
- o.Consult the dealer or an experienced radio/TV technician for help