



Smart Touch Solution

ITV-R01 USER'S Manual

Touch Air Remote

Specification



Model name	ITV-R01T
Interface	RF 2.4GHz
Interface(receiver)	USB2.0
Dimension	136mm(L) X 45.4mm(H) X 24.2mm(W)
Weight	46g (71g with battery)
Temperature	-10 ~ 50
Battery	DC1.5V Type AAA * 2ea
Distance	20m
Power consumption	6mA (MAX)
Voltage	1.9V ~ 3.6V
OS	Windows XP,VISTA,8 / Androids

Touch Air Receiver

Specification



USB Dongle Usage

1. Plug in the USB port and wait 30 sec when installs at first time.
2. Replug in the USB Port If fails installing.

Model name	ITV-R01R
Interface	RF 2.4GHz(2.402~2.478GHz)
Interface(receiver)	Full Speed USB2.0 compliant
Dimension	18mm(L) X 6mm(H) X 13mm(W)
Weight	1g
Temperature	-10 ~ 50
Modulation	GFSK
RF Channels	39 within the 2.4GHz ISM band
External Crystal	16MHz
Voltage	4.5V ~ 5.5V (USB)
OS	Windows XP,VISTA,8 / Androids

Warning

- THIS DEVICE COMPLIES WITH PART 15 OF THE FCC RULES. OPERATION IS SUBJECT TO THE FOLLOWING TWO CONDITIONS: (1) THIS DEVICE MAY NOT CAUSE HARMFUL INTERFERENCE, AND (2) THIS DEVICE MUST ACCEPT ANY INTERFERENCE RECEIVED, INCLUDING INTERFERENCE THAT MAY CAUSE UNDESIRE OPERATION.
- NOTE: THE GRANTEE IS NOT RESPONSIBLE FOR ANY CHANGES OR MODIFICATIONS NOT EXPRESSLY APPROVED BY THE PARTY RESPONSIBLE FOR COMPLIANCE. SUCH MODIFICATIONS COULD VOID THE USER'S AUTHORITY TO OPERATE THE EQUIPMENT.

Touch Air Remote

View & Features



- More accurate pointing than gyro products.
- Less tiredness when doing the mouse pointing.
- Power consumption :
Lower than any other RF remotes , around 6mA(max)
against normal RF remote's 12mA including ordinary
touchpad, Gyro remote, trackballs, etc.
- ➔ Long last with the power of battery (max 1 year)
- Design :
Ergonomic design with nice grip by hand.
More cute & pretty than Toy products.
- Size :
Small , portable size enables to control easily
your PC, TV with one hand.
- Can use at pc, STB, TV with various OS (windows pc, apple pc,
Android pc) to control easily by accurate mouse pointing.

Touch Air Remote

Quick Reference Guide

[User Manual]

1. Insert batteries (AAA *2ea)
2. Put the USB receiver into the USB port of your Computer (TV, system)

[sleep mode]

3. Smart sleep mode" for saving power after 5 minutes without touching it.
- wake up by pushing mouse click buttons or, cursor buttons
4. Fn on : media buttons ON
(Play & Pause / REW & FF / Vol up & down / Mute)
- Push the Fn key again to resume the mouse pointing with click buttons.
- Touch the touchpad 2times also enables the Fn Key off automatically. (media buttons off)

[Pairing]

5. Basically this Smart Remote is already connected (pairing done) with USB dongle.
- But when pairing is disconnected by accident or by any activity unintended :
- Please Keep pushing the "Esc" button for 3 seconds to pair with the USB receiver.
- keep the distance with the USB receiver close around 30 cm while doing this pairing

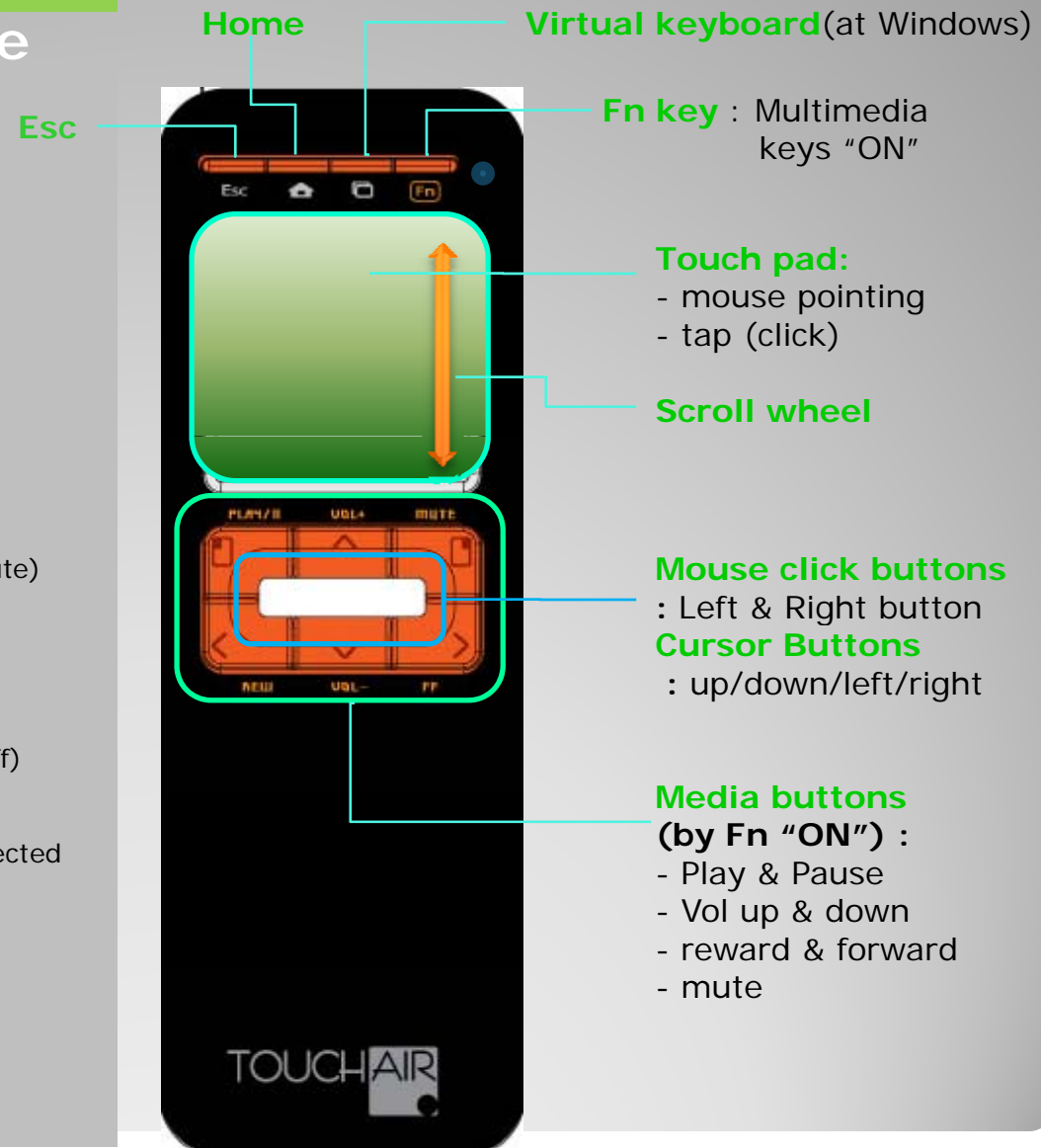

Touch Air Remote

[Warning]

To avoid the risk of injury, damage to the Remocon,

- avoid long periods of repetitive motions or incorrect body position, poor work habits which can be associated with physical discomfort and injury to nerves, tendons, muscles.
 - : If you feel pain, numbness, weakness, swelling, burning, cramping, stiffness in your hands, wrists, arms, shoulders, neck, back, please consult a qualified health professional.
- Be careful to keep children away from this Remocon
 - : Small parts of this Remocon can form a choking hazard for children(especially under 3years old).
- Do not immerse this Remocon in water or other liquid.
- Do not use this Remocon if it has sustained any kind of damage.
- Do not heat, open, puncture, mutilate, or dispose the Batteries in fire.
- Do not mix new and old batteries(this may cause batteries to run out of power quickly) or different types of batteries (ex: carbon-zinc with alkaline or rechargeable with disposal).
- Do Not Attempt to :
 - take apart, open, service, or modify this device. Doing so could present the risk of electric shock or other hazard.
 - Any evidence of any attempt to open and/or modify the device, including any peeling, puncturing will void the Limited Warranty.
- This RF device(frequency around 2.4Ghz) can be causing interference to other radio-communications devices such as Radio, TV, Wireless LAN, Cordless phones, etc.
 - : Relocate the antenna of the other devices, or move this device farther away from them.
 - : To avoid Wireless LAN's speed issues, set your LAN's channel around "11"~"13".

[Packages]

Remote Controller, USB receiver , Manual

[System Requirement]

- Windows XP or Higher // Mac OS 10.0 X or Higher support USB port.
- USB 2.0 or Higher version.

Touch Air Remote

[Regulatory Information]

This device is complied with CE, FCC, KCC Standards.

This device is for only home or office use. Not intended for use in machinery, medical, industrial applications.

This Class B digital apparatus complies with Part 15 of the U.S. Federal Communications Commission (FCC) rules, Canadian ICES-003 and RSS-210. Operation is subject to the following two conditions :

(1) this device may not cause interference, and (2) this device must accept any interference received, including interference that may cause undesired operation. This device is rated as a commercial product for operation at +41°F (+5°C) to +95°F (+35°C).

This device is made strictly in compliance with RoHS and WEEE.

[Disposal of Waste Electrical and Electronic Equipment]

: in the European Union and Other Countries/Regions with Separate Collection Systems

This symbol on the product or its packaging means that this product must not be disposed of with your household waste. Instead, it is your responsibility to hand this over to an applicable collection point for the recycling of electrical and electronic equipment.

This separate collection and recycling will help to conserve natural resources and prevent potential negative consequences for human health and the environment, which inappropriate disposal could cause due to the possible presence of hazardous substances in electrical and electronic equipment.

For more information about where to drop off your electrical and electronic waste, please contact your local city/municipality office, your household waste disposal service, or the shop where you purchased this product.

[Limited Warranty]

- We warrant this device for one(1) year, under normal use and service, on the date of acquisition as shown on receipt or similar proof of payment.
- You must submit proof of payment in the form of a bona fide, dated receipt, or invoice (or a copy) evidencing that you are the beneficiary of this Limited Warranty and that your request for a remedy is made within the Warranty Period.
- This Limited Warranty does not cover, and no warranty of any kind is provided with respect to any subjective or aesthetic aspects of this device.

● This Limited Warranty shall be invalid if this device:

- is used for commercial purposes (including rental or lease).
- is modified or tampered with.
- is damaged by power surge, misuse, abuse, negligence, accident, wear and tear, mishandling, misapplication, or other causes unrelated to defects in this device.
- is damaged by programs, data, viruses, or files, or during shipments.
- is not used in accordance with the accompanying documentation and use instructions.
- is repaired, modified or altered by other such as unauthorized center causes or contributes to any defect or damage.

● Limitation on Duration of Implied Warranties.

: If you are a consumer, you may also have an implied warranty and/or condition under the laws of some jurisdictions, which is hereby limited to the duration of the Warranty Period.

Some jurisdictions do not allow limitations on how long an implied warranty or condition lasts, so the foregoing limitation may not apply to you.

● National statutory Rights.

: This Limited Warranty gives You specific legal rights and You may also have other rights which vary from jurisdiction to jurisdiction.

Where any term of this Limited Warranty is prohibited by such laws, it shall be null and void,

but the remainder of the Limited Warranty shall remain in full force and effect if its allocation of risks is not materially disturbed.



ITVERS

1224-LifeCombi Yeouido-Dong Yeongdeungpo-Gu Seoul Korea (150-732)

Contact : Brian Kim

TEL : +82 2 780 1185 // **FAX** : +82 2 780 1195

mobile : +82 10 7252 9111

Skype : brian-takeoffer

Email : takeoffer@naver.com // brian@itvers.com

Web : <http://www.itvers.com>