

SIZE: 381mm x 63.5mm
FINISHED SIZE: 3 Folds to 63.5mm x 63.5mm
COLOR: Print Black, two sides, Bleed 2 edges
STOCK: 60# white Offset

FRONT

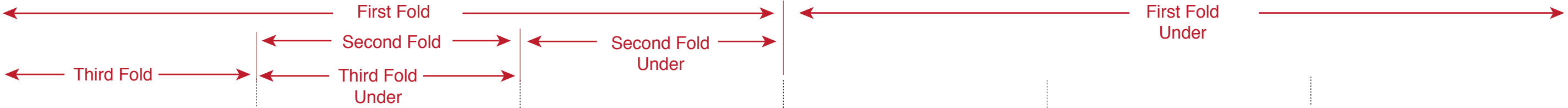

ROYAL®
Speaker Stick

Rechargeable Remote
Bluetooth Speaker

Operating
Instructions



© Copyright,
Royal Consumer Information Products, Inc.
2013, All Right Reserved.

SpeakerStickIM0913

ROYAL®
Consumer Information Products, Inc.
1160 U.S. Highway 22 East
Suite 301
Bridgewater, NJ. 08807
Made in China

Structure/Parts

1. Dust Cover (Switch and Micro USB Port Entry)
2. Power Switch (On/Off)
3. Micro USB: Charging Port

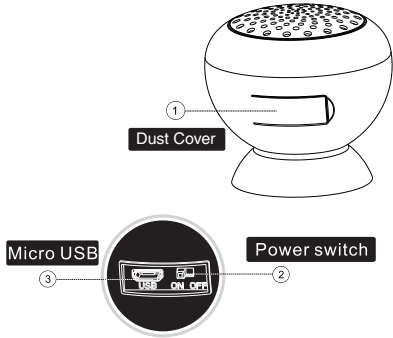

Structure/Parts Continued

4. + : Play Next/Volume Up (Held Down)
 5. - : Play Preview/Volume Down (Held Down)
 6. < : Play/Pause; Answer/Hang Up Phone Calls
 7. Microphone (During Hands-free Calls)
 8. Suction Cup
 9. LED Indicator
- Red light on: Charging
 - Blue light on: Fully charged
 - Blue light flashing quickly: Bluetooth pairing;
 - Blue light flashing slowly: Bluetooth paired successfully.

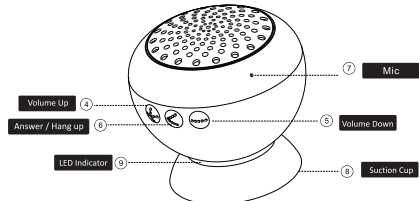

Usage

Charging the Speaker Stick

With the Speaker Stick switched **OFF**, connect it via USB cable (included) to a computer. The LED indicator will illuminate **red** and will go out when charge is completed (approximately 1.5-2 hours).

Pairing Speaker

Switch **ON** the Speaker Stick. The speaker will sound and the LED indicator will be flashing quickly indicating that it is ready to auto-pair. Make sure all other devices that have a Bluetooth option is turned **OFF**. Prepare your phone, tablet, PC or other Bluetooth device to pair the unit via Bluetooth. Click on the **ROYAL BT10 SPEAKER** file from your device. Wait a moment till the devices are paired. Once the pairing is completed, **CONNECTED** will appear on your device. A beep will sound and a LED indicator will flash slowly on your speaker. Go to your music or video file and enjoy wireless music or sound.

Listening to your Audio Device

You can control the Speaker Stick by using buttons from the speaker. Press "<" button to Play/Pause/Resume audio playback. Press "-/+>" to go to previous/next track. Also, you can control the volume by pressing and holding the "+/+>" buttons (beeps will sound when it reach minimum / maximum volume level).

Usage Continued

Phone Call Entry

You can control incoming calls using buttons from the speaker. For an incoming call, the speaker and the cell phone will ring your call tone. Both may sound depending on your device settings. To Answer/Hang up the phone, short press "<" button. To Reject the phone call, long press "<" button. Once the phone call ends, your music will begin from where it was stopped.

Notes

1. Pairing code is not required
2. Once you have successfully paired the Speaker Stick, your device should pair automatically every time your BT connection is activated.
3. Ensure your AUX input is unplugged and your device has been BluetoothR enabled.
4. Hands-free call is only available on BT connected status. Bluetooth is a bidirectional transmitting device; transmitting distance is highly related to audio player. Compatible BT players are recommended.
5. The sound performance and operating distances could also be affected when BT transmitting devices is under poor signal environment, or under low battery capacity.

BACK

Usage Continued

6. Only the silicone gel housing is splash resistant. Do not submerge the unit in water.
7. Because of different surfaces the Speaker Stick may not stay affixed for extended time. Try different surfaces for the best possible location.

Specification

Product:

Product Size: 2.4" x 2.3"
Weight: 3.17 oz
Loudspeaker: 1.574"
Related Power: 3W
Interface: Micro USB

Bluetooth Parameter:

Operation Frequency: 2.40 GHz - 2.48 GHz
Power Output (peak): Class 2/4 dbm
Receiving Sensitivity: -90db @ 0.1% BER
Operation Range: Up to 30 feet

Battery Parameter:

Capacity: 320mAH, 3.7V, Polymer Li-ion Battery
Music Playback Time: 5-7 Hours at 70% volume
Charging Standards: DC 5V, 500mA
Charging Time: 1.5-2 Hours

Accessory:

USB Cable: 1pcs
User Guide: 1pcs
Certification of Quality:

State of California Proposition 65 Warning

The following state is required by the State of California.
Warning: This product contains chemicals known to the State of California to cause cancer, birth defects, or other reproductive harm. Wash hands after handling.

ROYAL Consumer Information Products	Product Registration Information	S&S
Register Your Product online at: www.royal.com		
Date of Purchase: _____	Model: _____	
Place of Purchase: _____		
Lot / Serial Number: _____		
Customer Support: 1-800-272-6229 (US) 1-888-266-9380 (Canada) 01-800-849-4826 (Mexico)		
PLEASE KEEP THIS INFORMATION FOR YOUR RECORDS.		

Warranty, Registration & Technical Support

BE SURE TO KEEP A COPY OF YOUR SALES RECEIPT!

Standard Warranty

ROYAL CONSUMER INFORMATION PRODUCTS, INC. ("ROYAL") 1160 U.S. Highway 22 East, Suite 301, Bridgewater, NJ 08807-2931 USA WARRANTS that your NEW product is free of defects of workmanship and materials. If there us a defect or malfunction of this product, Royal will repair it free of charge as follows:

PARTS: New or comparable rebuilt parts in exchange for defective parts for ONE (1) YEAR from date of customer purchase.

LABOR: Royal provides labor warranty for NINETY (90) DAYS from date of end-user purchase. Product must be sent postage prepaid and insured to Royal in accordance with the responsible for return shipping charges from Royal, and for parts or services no longer covered under warranty.

This warranty does not apply to persons who purchased these product second-hand or used. This warranty does not include adjustments, parts and/or repair by circumstances beyond the control of Royal, including but not limited to fire or other casualty, accident, neglect, abuse, mis use, abnormal use or battery leakage damage.

THERE ARE NO OTHER EXPRESSED WARRANTIES EXCEPT AS STATED HEREIN. AFTER THE PERIOD OF EXPRESSED WARRANTY SET FORTH HEREIN, THERE ARE NO EXPRESSED OR IMPLIED WARRANTIES AND THOSE EXCLUDED INCLUDE THOSE OF MERCHANTABILITY AND FITNESS FOR PARTICULAR PURPOSE.

Royal shall NOT be held liable for CONSEQUENTIAL DAMAGES resulting from any failure, defect or malfunction of this product. Some States do not allow the exclusion of limitation of incidental or consequential damages, so the above limitations may not apply to you.

Warranty Procedures

To Obtain Service Under the Terms of this Warranty:

Please do the following:

1. Send a copy of your original sales receipt showing original purchase date, along with mailing address and a note describing the problem to:

Royal Consumer Information Products, Inc.
Warranty Processing
50 Hilton Street
Easton, PA 18042

Do Not Return the Product to this Address!

2. You will receive a return authorization number within 7-12 business days from the date your return request is received if it is determined that there is a basis for a replacement product. The return authorization from receive will list the return procedures, applicable change, if any, and the correct shipping address for the returned product.

Product Support Hotline

For question on the use of this product call 1-800-272-6229 (in Canada call 1-888-266-9380) or in Mexico call 01-800-849-4826, Monday through Friday during normal business hours.
You can also e-mail Royal at hotline@royal.com.

FEDERAL COMMUNICATIONS COMMISSION (FCC) RADIO
FREQUENCY INTERFERENCE STATEMENT INFORMATION TO THE
USER

CAUTION: Changes or modifications to this unit not expressly approved by the party responsible for compliance could void the user's authority to operate the equipment.

NOTE: This equipment has been tested and found to comply with the limits for a Class B digital device, pursuant to Part 15 of the FCC Rules. These limits are designed to provide reasonable protection against harmful interference in a residential installation. This equipment generates, uses and can radiate radio frequency energy and, if not installed and used in accordance with the instructions, may cause harmful interference to radio communications. However, there is no guarantee that interference will not occur in a particular installation. If this equipment does cause harmful interference to radio or television reception, which can be determined by turning the equipment off and on, the user is encouraged to try to correct the interference by one or more of the following measures:

1. Reorient or relocate the receiving antenna.
2. Increase the separation between the equipment and receiver.
3. If applicable, connect the equipment into an outlet on a circuit different from that to which the receiver is connected.

Consult the dealer or an experienced radio/TV technician for assistance.

Connection of peripherals to this unit requires the use of grounded, shielded cables to ensure compliance with the Class B FCC limits.

FCC WARNING

This device complies with Part 15 of the FCC Rules. Operation is subject to the following two conditions:

- (1) This device may not cause harmful interference, and
- (2) this device must accept any interference received, including interference that may cause undesired operation.

NOTE 1: Any changes or modifications to this unit not expressly approved by the party responsible for compliance could void the user's authority to operate the equipment.