

P1

## Welcome

Thanks for choosing this laser presenter. It gives you remote control of your onscreen presentations with a range of up to 35 feet which is a perfect idea for a large conference room. This presenter supports the most common presentation tools including Page Up, Page Down, Start & Exit slideshow > Screen black. It also has a laser pointer that helps you focus in on your key messages. Just plug and play, no software is required. It allows you to control your presentation with one touch easily in the palm of your hand, and enjoy freedom of movement as you present.

**Be sure to carefully read this User's Guide first for the proper use of this product and keep it for future reference.**

© 2012 All rights reserved.

## IMPORTANT SAFETY AND HEALTH INFORMATION

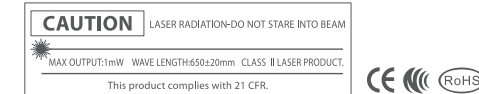

## Package contents

- Wireless 2.4GHz Laser Presenter x 1
- User's Manual x 1
- Cable x 1
- Warranty Card x 1

## Minimum System Requirements

- Windows® 98SE / 2000 / ME / XP / Vista / 7 / 8 or Above, Mac OS X® v.10.4 (or later)
- IBM or PC Compatible or Notebook with USB port

## Product Features



★When the status indicator is flashing, please change battery.



★Note: When The receiver is plugged into the presenter, the power cutoff automatically.

P2

## Getting Started

### STEP 1 Pull out the receiver



### STEP 2 Connecting the Receiver

Take USB receiver plug it to PC USB port (product will auto link).



### STEP 3 Open the Powerpoint file and test the key functions

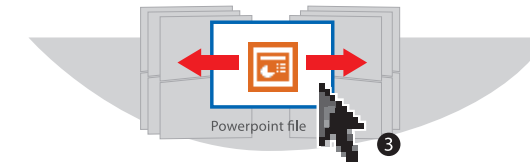

## Trouble Shooting

Question	Possible cause	How to resolve
Need to install software for first use of this product?		No, this is a plug and play device.
Need to link ID before first use?		No need
Possible to use 2 or more of this product in a room at the same time?		Yes
Remote control malfunction	Interfered by other RF signal	To Implement ID Link (see Switching Channels)
Laser pointer and remote control both malfunction	Put batteries in wrong direction or run out of battery power	Check the batteries

P3

## Switching Channels

Plug receiver to your PC USB port Within the 20-second stand-by time, press and simultaneously 2 seconds until the red LED of Status indicating becomes blinking for 2 times, the ID link has been successfully done.



## Countdown timer setting

Take out USB receiver and press laser button to awake LCD display (Display will show the data when last time you plugged in the USB receiver and cut off the power, for example 06:00)

- Press S, the ":" of 06:00 will blink
- Press page up and page down to adjust the time (for example 09:00)
- Press S again to confirm. The ":" will stop blinking.
- Press "start" and the timer will start to count down (08:59, 08:58, 08:57.....)
- The timer will automatically vibrate for 10 seconds at 10:00, 05:00, 02:00 and 00:00. You can press laser button to stop the vibration.
- During the counting down, long pressing S will delete the time setting and it will show 01:00 as default. You can press "pause" to pause the counting down.

## Care and Maintenance

- For cleaning, you are advised to use a soft, slightly moistened cloth.
- Avoid using solvents or abrasive substances.
- Do not open the presenter: for maintenance, consult qualified staff only.

## Safety Notice

1. This product complies with FCC and CE rules.
2. This product has no serviceable parts. Use of controls or adjustments of procedures other than the user guide may result in danger.

P4

## Specifications

Frequency range	2.4GHz
Remote range	About 30 meters
Power	AAA battery x 2
Output power	Under 1mW
Size	134 (L) x 34(w) x 27 (h) millimeters
Weight	43g

P5



# G800

2.4GHz 綠光雷射無線簡報器/使用說明書

2.4GHz Wireless Green laser Presenter User's Guide



E-SENSE Technology Co.,Ltd.  
8F.,No.10,Lane 366, Sec.2 Jhongshan Rd.,Jhonghe City  
Taipei County 235, Taiwan  
Tel:+886-2-22448868 ext.55  
Fax:+886-2-22448813  
sucytsai@e-sense.com.tw <http://www.e-sensetech.com/>

P7

## FCC Statement

This device complies with part 15 of the FCC rules. Operation is subject to the following two conditions: (1) this device may not cause harmful interference, and (2) this device must accept any interference received, including interference that may cause undesired operation. Changes or modifications not expressly approved by the party responsible for compliance could void the user's authority to operate the equipment.

NOTE: This equipment has been tested and found to comply with the limits for a Class B digital device, pursuant to part 15 of the FCC Rules. These limits are designed to provide reasonable protection against harmful interference in a residential installation. This equipment generates uses and can radiate radio frequency energy and, if not installed and used in accordance with the instructions, may cause harmful interference to radio communications. However, there is no guarantee that interference will not occur in a particular installation. If this equipment does cause harmful interference to radio or television reception, which can be determined by turning the equipment off and on, the user is encouraged to try to correct the interference by one or more of the following measures:

- Reorient or relocate the receiving antenna.
- Reorient or relocate the receiving antenna.
- Reorient or relocate the receiving antenna.
- Consult the dealer or an experienced radio/TV technician for help important announcement