

SMART SHADES MANUAL

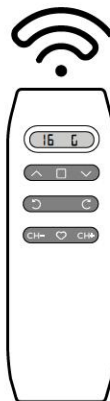
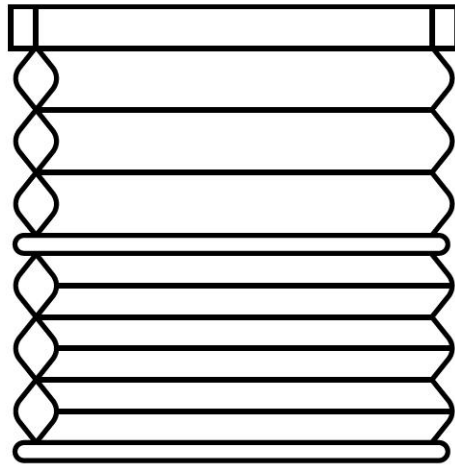

CONTENTS

ZIGBEE BATTERY MOTOR

1. Parameters	1-2
2. Voice Control	3-8

16-CHANNEL REMOTE CONTROL

1. Parameters	9
2. Install The Battery	10
3. Remote Function	11
4. Programming	12-20
5. App Connection	21

CERTIFIED STATEMENT

1. FCC Statement	22-23
------------------	-------

ZIGBEE BATTERY MOTOR

1. PARAMETERS



When received, the motor is in a no signal state.
To activate it, please remove the blocker.

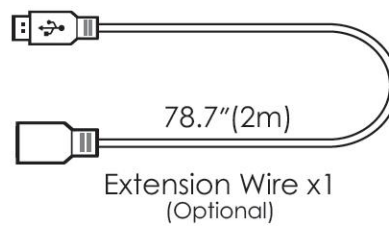
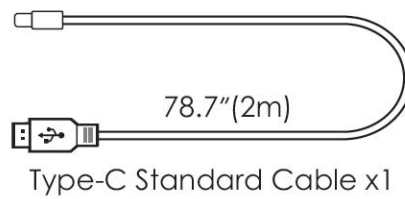
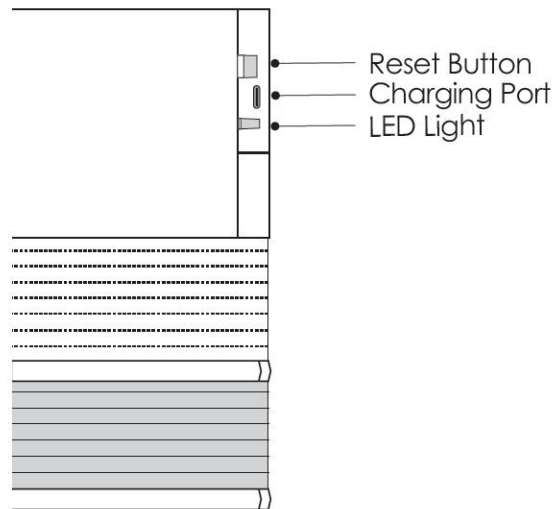
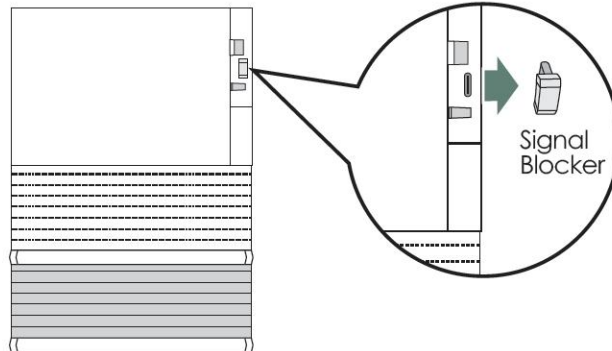

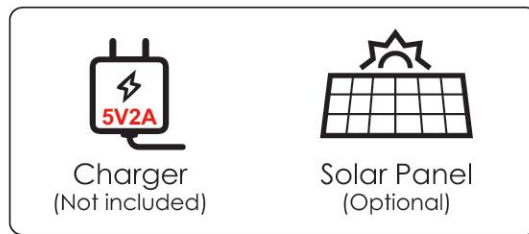

1. Please fully charge the motor for at least 8 hours before the first use.
2. Once fully charged, the motor can be used for 3-6 months depending on usage frequency.



Low Battery:
Orange light
flashing

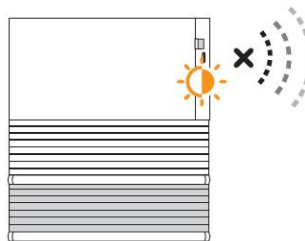

Charging:
Blue light
flashing every 8s

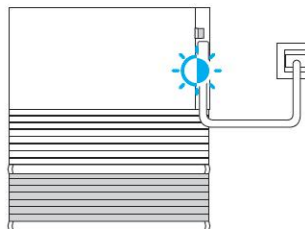

Fully Charged:
Blue light stays on

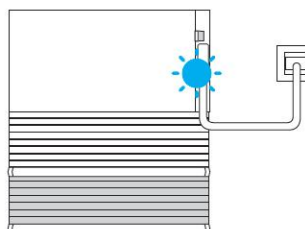

2. VOICE CONTROL



Please check if the top and bottom limits are already set before connecting to Alexa.

The following models of Alexa can connect directly to window shades, but for other models, a hub is required.

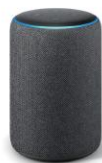

Echo Plus
(2nd Gen)



Echo Studio



Echo
(4th Gen)



Echo Show 10
(3rd Gen)



Echo Show
(2nd Gen)



Echo Hub



Echo Show 8
(3rd Gen)

Step 1 Alexa Connection

01.

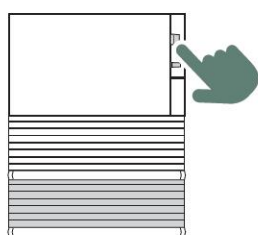

Hold for **6s**



Shade jogs **x2**

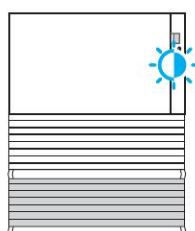

Blue light flashing

02.



Please say
"Alexa, discover my devices"



If Alexa doesn't reply with 'I've found the first device', please go to the 'All Devices' page in the Alexa app to check if it has been successfully connected.



Step 2 Set Device Name

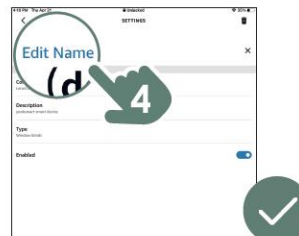
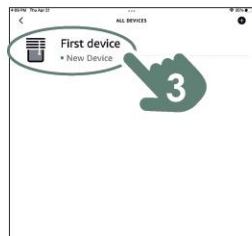
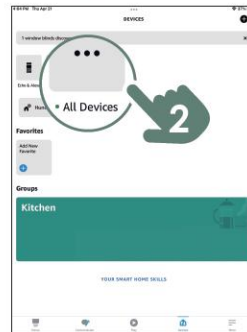
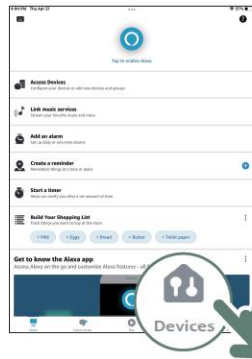

Step 3 Send Voice Commands



Please say

Alexa, open/close (device name).
Alexa, open/close (device name) to 1~100%.



If you use the echo4, please refer to the following instructions:



Echo (4th Gen)



Please say

Alexa, open/close (device name). 

Alexa, open/close (device name) to 1~100%.



Voice commands may vary for different Echo devices and firmware versions. Please try different commands.

Day Night Shade Percent Opening Introduction

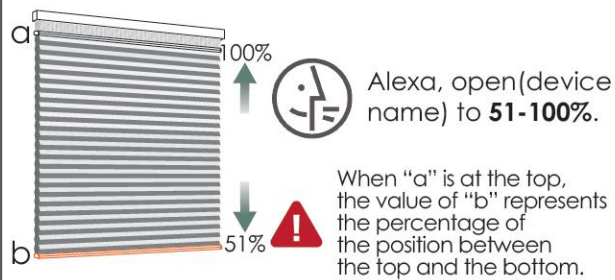
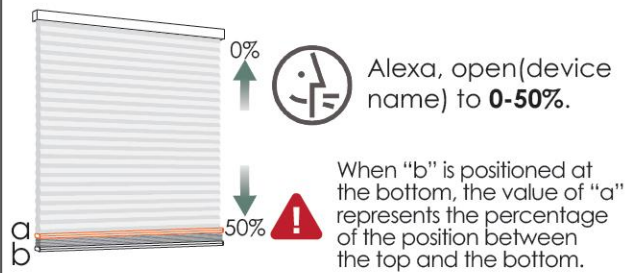

Step 4 Control the Shade Via Alexa Routine



If you want to customize voice commands to control the shade opening percentage, you can set this up through Alexa routine.

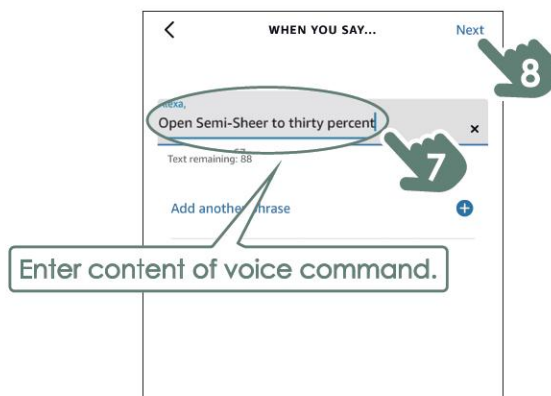
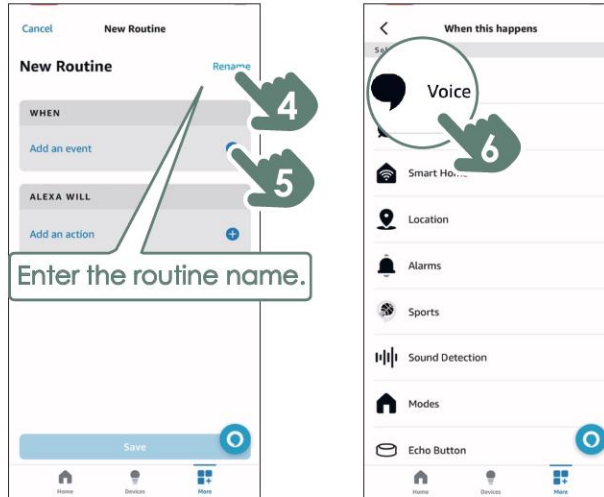
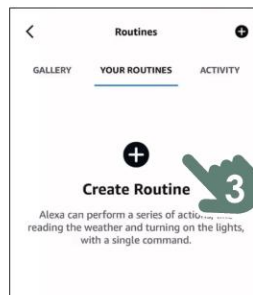
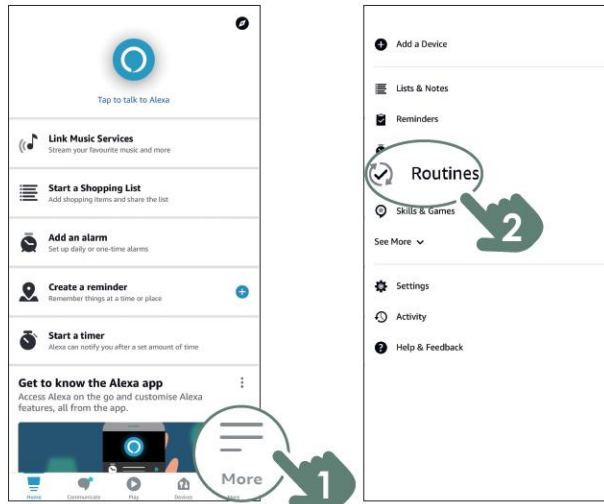

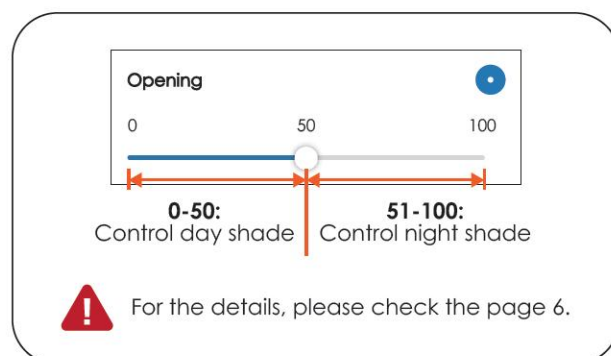
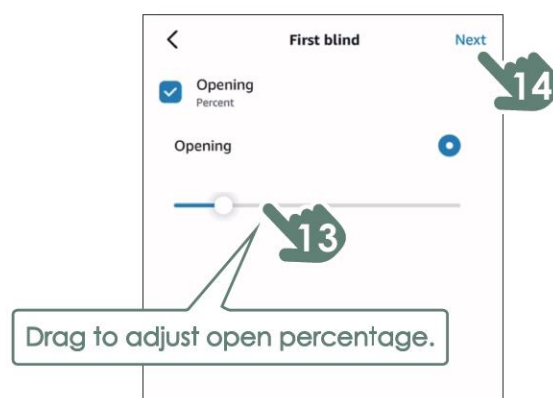
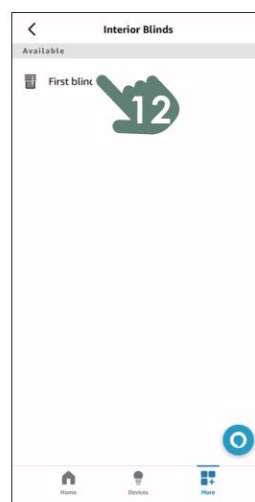
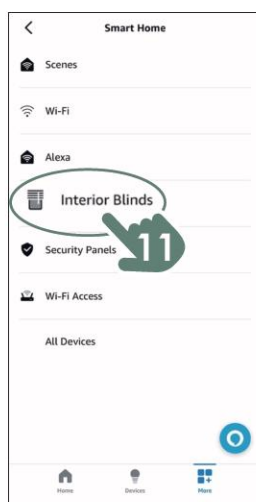
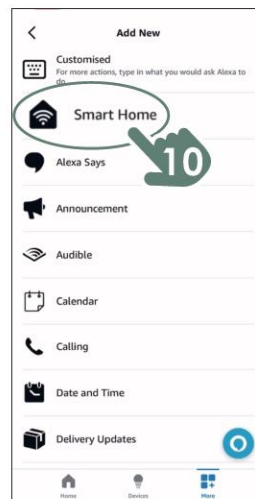
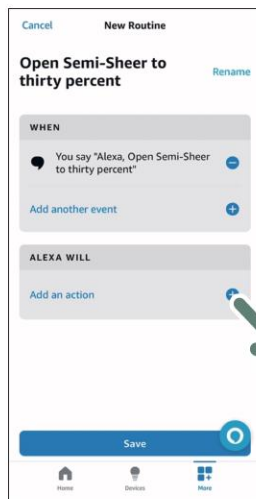

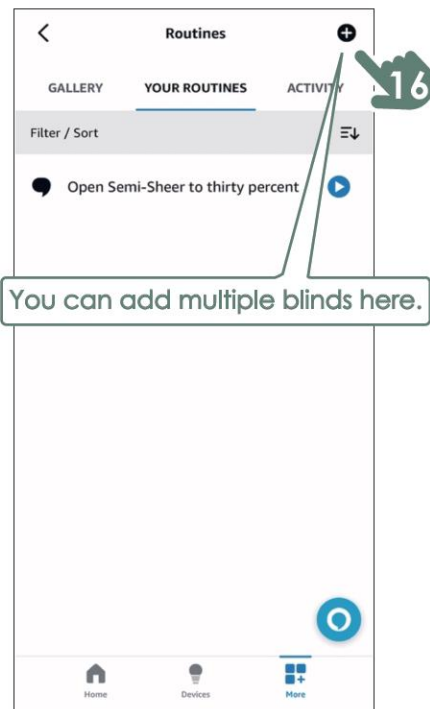
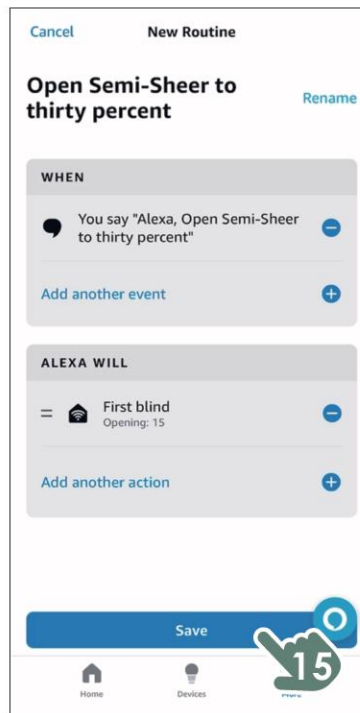

To better control your (device name), you can set up multiple routines based on different usage scenarios, such as fully open, fully closed, or half-open etc.



Congratulations!
Now you can free control
the blinds via Alexa routine!

16-CHANNEL REMOTE CONTROL

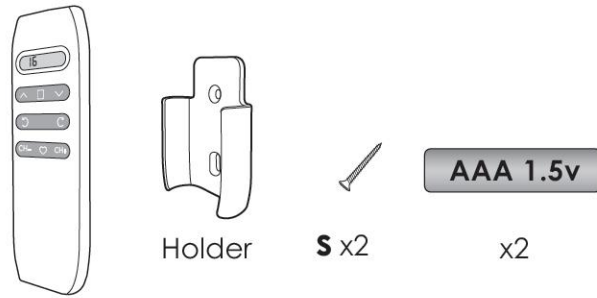

1. PARAMETERS

FRONT

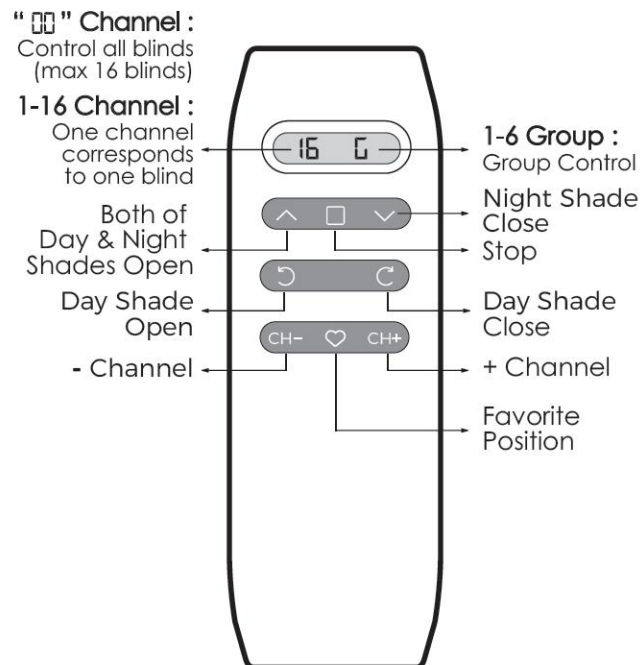

BACK

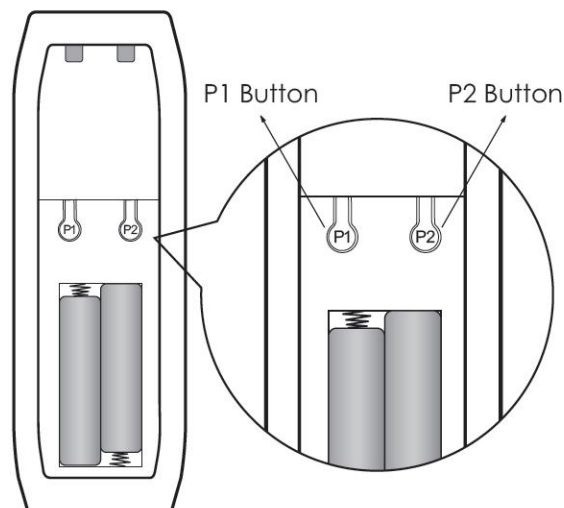

2. INSTALL THE BATTERY



Your blind has been programmed before shipment.
Please use it directly after installation.

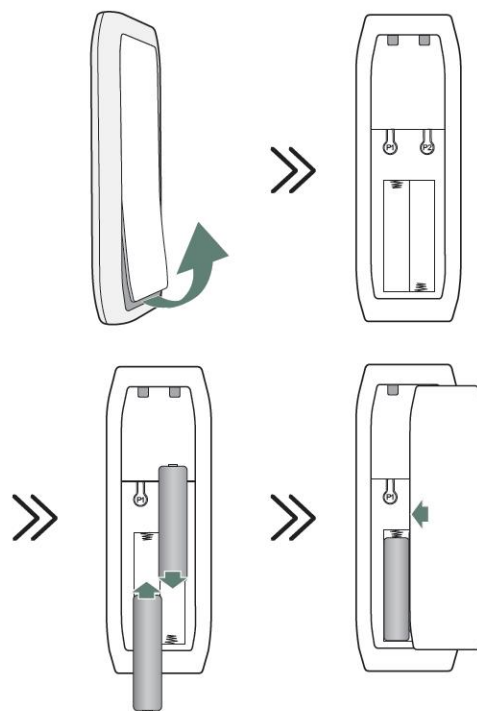

Install the Remote Holder on Wall

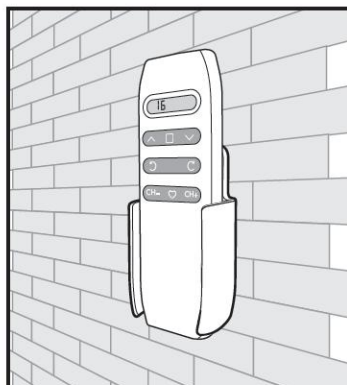
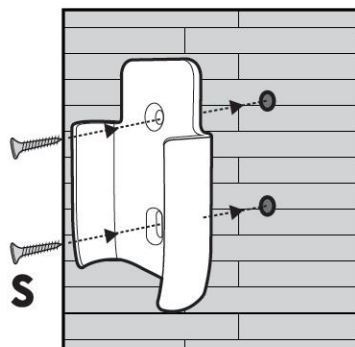

3. REMOTE FUNCTION



Please ensure that the remote is not in setting mode before following the steps below:
If it's in setting mode, please refer to page 12 to exit setting mode.



Press " ^ "



Both of day & night shades open

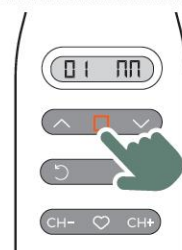

Press " □ "



Stop



Press " v "

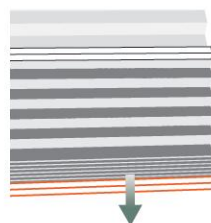

Night shade close



Press " > "

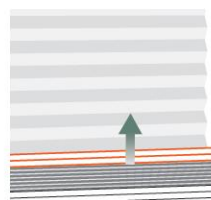

Day shade open

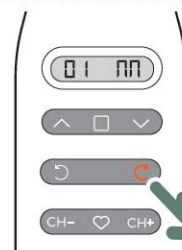

Press " C "

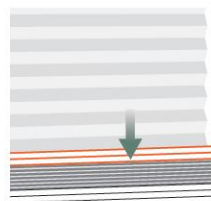

Day shade closes until it reaches the position of the night shade

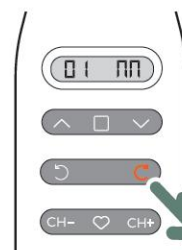

Press " C " again

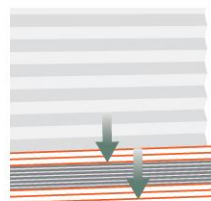

Both of day shade and night shade close until the day shade is completely extended

4. PROGRAMMING

Enter Setting Mode

01.

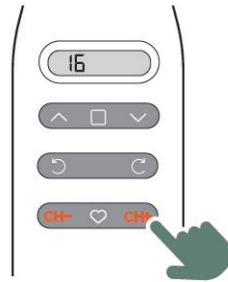

Press "CH-" or "CH+",
choose the channel
you want to set from "1-16"

02.

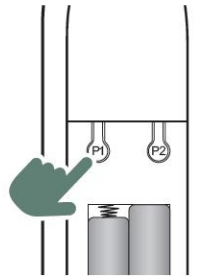

Hold "P1" for **3s**

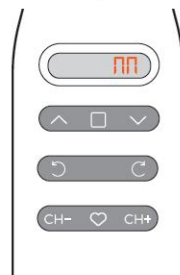

"P1" flashes

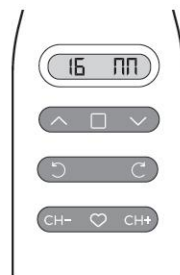

enter setting mode.



It will exit setting mode if hold "P1" for 5s again
or no operation for 3 mins.

Set Favorite Position

- 1. The favorite position is not set at factory.
- 2. Before setting the favorite running position, please ensure that the top and bottom limit positions have been set.
- 3. Please ensure that the remote is in setting mode before following the steps below:

01. Move the day shade to the desired favorite position, but can't full open and close the day shade.

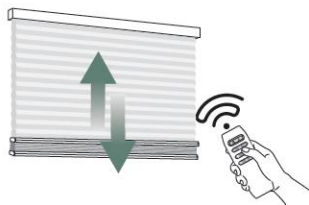

02.

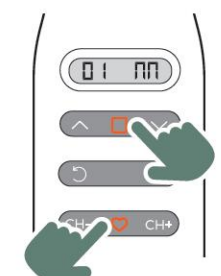

Press "♥" & "□"

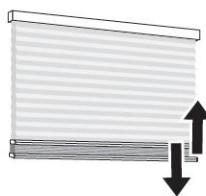

Shade jogs x2



Delete Favorite Position

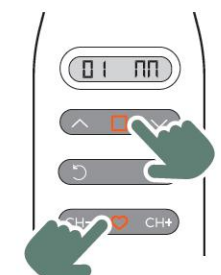

Press "♥" & "□"

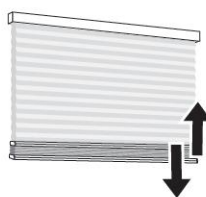

Shade jogs x1



How to Adjust Shades Running Speed



1. Please ensure that the remote is in setting mode before following the steps below:
2. If the motor does not jog, it may have reached the maximum or minimum speed. There are three speed settings available.

Add speed

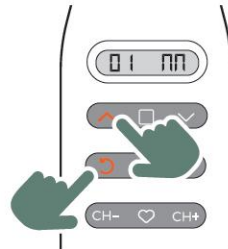

Press " ^ " & " ➤ "



Shade jogs **X1**



Reduce speed

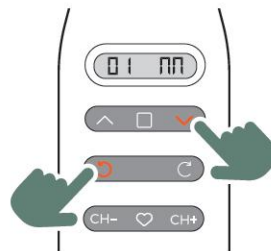

Press " v " & " ➤ "



Shade jogs **X1**



Delete Top Limit Position



Please ensure that the remote is in setting mode before following the steps below:

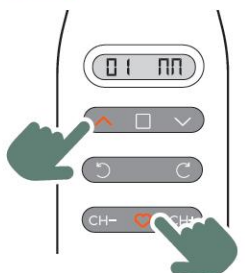

Press " ^ " & " ♥ "

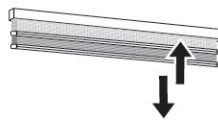

Shade jogs x1



Delete Bottom Limit Position



Please ensure that the remote is in setting mode before following the steps below:

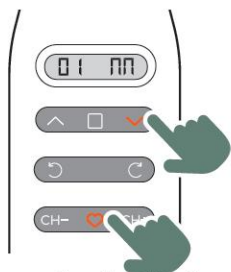

Press " v " & " ♥ "



Shade jogs x1



Delete Top & Bottom Limit Positions



1. The favorite position will also be deleted.
2. Please ensure that the remote is in setting mode before following the steps below:

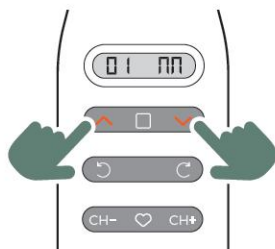

Press " ^ " & " v "

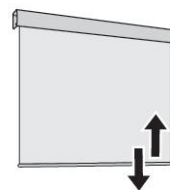

Shade jogs x1



Please set the limit position before running the shade.

Set Top Limit Positions



Please ensure that the remote is in setting mode before following the steps below:

01.

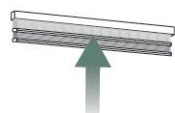

Move the day shade to the desired top limit position.

02.

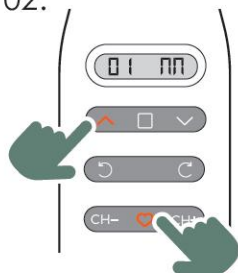

Press "▲" & "♥"

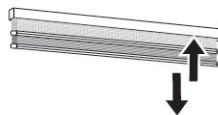

Shade jogs x2



Set Bottom Limit Positions



Please ensure that the remote is in setting mode before following the steps below:

01.



Move the day shade to the desired bottom limit position.

02.

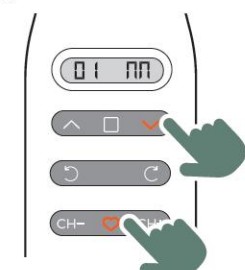

Press "▼" & "♥"



Shade jogs x2



Unpair the Motor



1. All paired remotes on the current channel won't be able to control the motor after the step.
2. Please ensure that the remote is in setting mode before following the steps below:

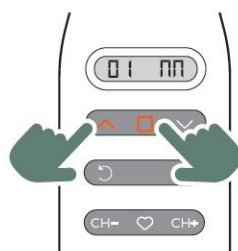

Press "▲" & "□"



Shade jogs x1



Reset the Motor

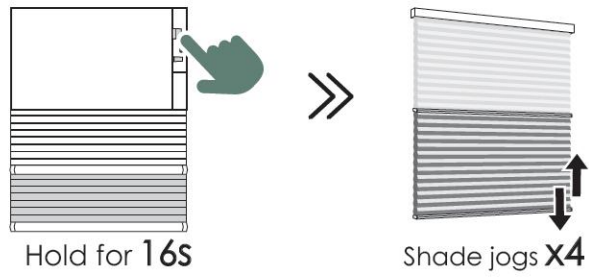

Zigbee Battery Motor will enter in sleep mode after being reset. Please unlock before repairing.



Sleep Mode

Unlock:

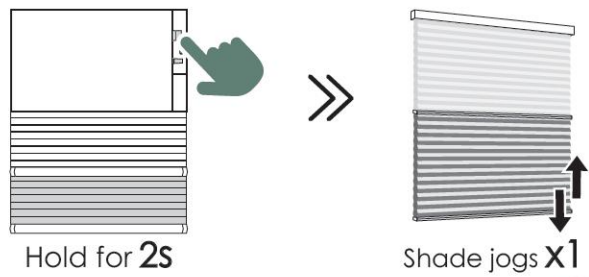

Lock:

01.

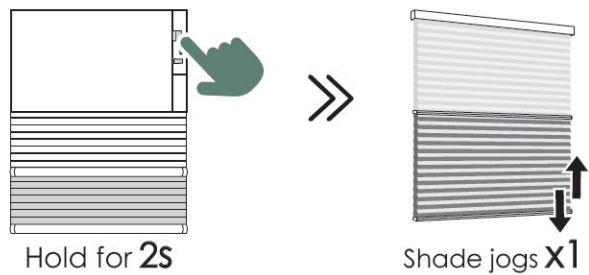

02.

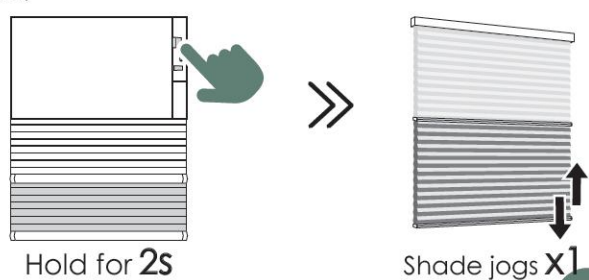

Check the motor status:

Under normal operation mode

 The top and bottom limit positions are already set.

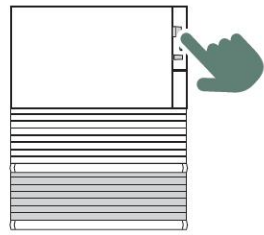

Press **x1**



Move up or down

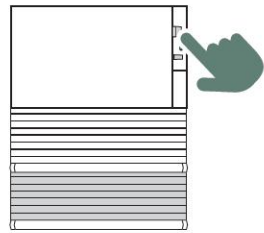

Press **x1**



Stop

Under sleep mode

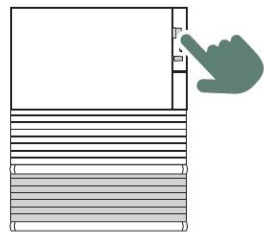

Press **x1**

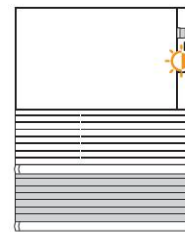

Orange light
flashing **x3**

Re-pair the Motor



Please ensure that the remote is in setting mode before following the steps below:

01.

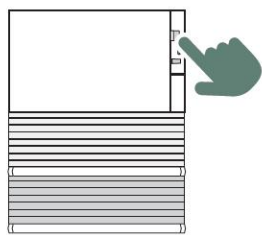

Hold for **2s**



Shade jogs **x1**

02.

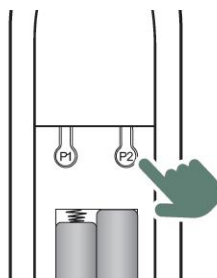

Press " P2 " **x1**



Shade jogs **x2**



Please repeat step 2 when the motor has no response.

03.

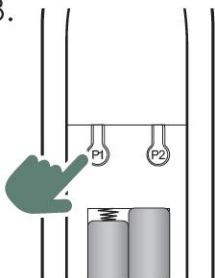

Press " P1 " **x1**



Add New Remote "B"



Please ensure that the remote is in setting mode before following the steps below:

01. Paired remote "A"

A

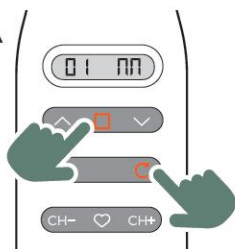

Press "CH-" & "CH+"



Shade jogs x1

02.

B

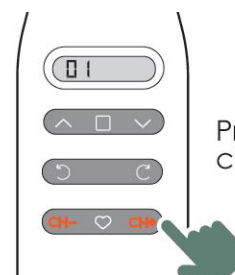

Press "CH-" or "CH+",
choose to channel number

03. Ensure that the unpaired remote "B" has entered setting mode. Please refer to Page 12 for this step.

04.

B

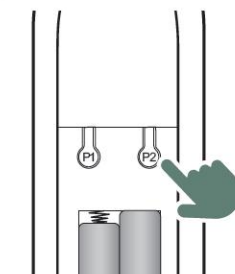

Press "P2" x1



Shade jogs x2

05.

B

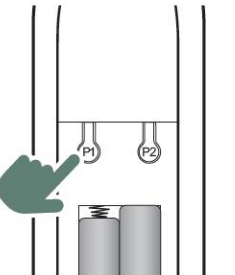

Press "P1" x1



5. APP CONNECTION

Method 1



Please ensure that the remote is in setting mode before following the steps below:

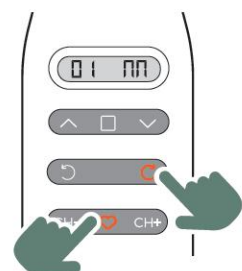

Press "♥" & "C"



Shade jogs X1

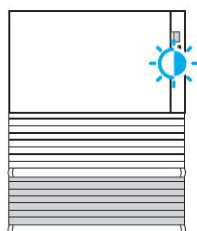

Blue light flashing



Method 2

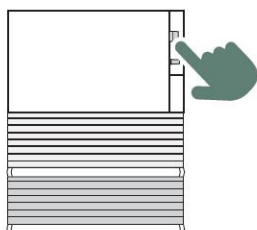

Hold for 6s



Shade jogs X2

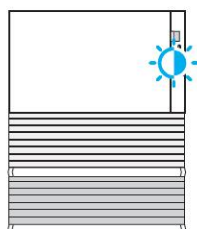

Blue light flashing



CERTIFIED STATEMENT

1. FCC STATEMENT

15.19

This device complies with Part 15 of the FCC Rules. Operation is subject to the following two conditions: (1) This device may not cause harmful interference. (2) This device must accept any interference received, including interference that may cause undesired operation.

15.21

Note: The grantee is not responsible for any changes or modifications not expressly approved by the party responsible for compliance. Such modifications could void the user's authority to operate the equipment.

15.105(b)

NOTE: This equipment has been tested and found to comply with the limits for a Class B digital device, pursuant to part 15 of the FCC Rules. These limits are designed to provide reasonable protection against harmful interference in a residential installation. This equipment generates uses and can radiate radio frequency energy and, if not installed and used in accordance with the instructions, may cause harmful interference to radio communications. However, there is no guarantee that interference will not occur in a particular installation. If this equipment does cause harmful interference to radio or television reception, which can be determined by turning the equipment off and on, the user is encouraged to try to correct the interference by one or more of the following measures:

- Reorient or relocate the receiving antenna.
- Increase the separation between the equipment and receiver.
- Connect the equipment into an outlet on a circuit different from that to which the receiver is connected.
- Consult the dealer or an experienced radio/TV technician for help.

Radiation Exposure Statement:

This equipment complies with FCC radiation exposure limits set forth for an uncontrolled environment. This equipment should be installed and operated with minimum distance 20cm between the radiator & your body.

Radiation Exposure Statement

This equipment complies with FCC radiation exposure limits set forth for an uncontrolled environment. This equipment should be installed and operated with minimum distance 20cm between the radiator & your body.

Déclaration d'exposition aux radiations:
Cet équipement est conforme aux limites d'exposition aux rayonnements IC établies pour un environnement non contrôlé. Cet équipement doit être installé et utilisé avec un minimum de 20cm de distance entre la source de rayonnement et votre corps.

ISED Compliance

This device contains licence-exempt transmitter(s)/receiver(s) that comply with Innovation, Science and Economic Development Canada's licence-exempt RSS(s). Operation is subject to the following two conditions:

1. This device may not cause interference.
2. This device must accept any interference, including interference that may cause undesired operation of the device.

L'émetteur/récepteur exempt de licence contenu dans le présent appareil est conforme aux CNR d'Innovation, Sciences et Développement économique Canada applicables aux appareils radio exempts de licence. L'exploitation est autorisée aux deux conditions suivantes :

1. L'appareil ne doit pas produire de brouillage;
2. L'appareil doit accepter tout brouillage radioélectrique subi, même si le brouillage est susceptible d'en compromettre le fonctionnement.

