

aidioX₁



Directions for use

For details, please refer to the following website:



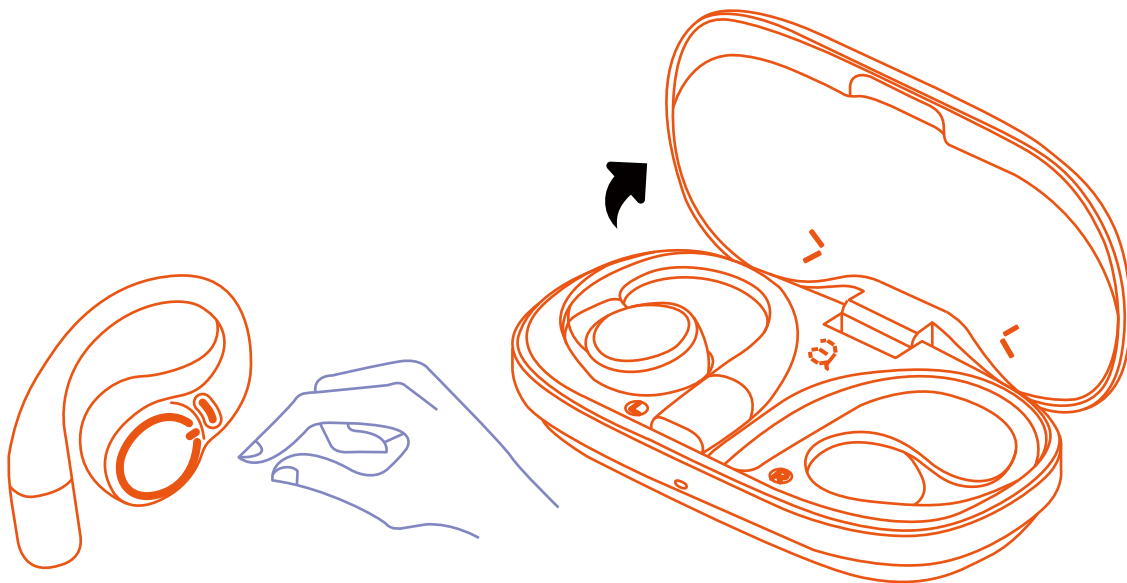

Reminder: Open the charging case upwards.
Please tear off the insulating film of the earbuds
before use, and turn on the earbuds after
putting them back into the charging case.

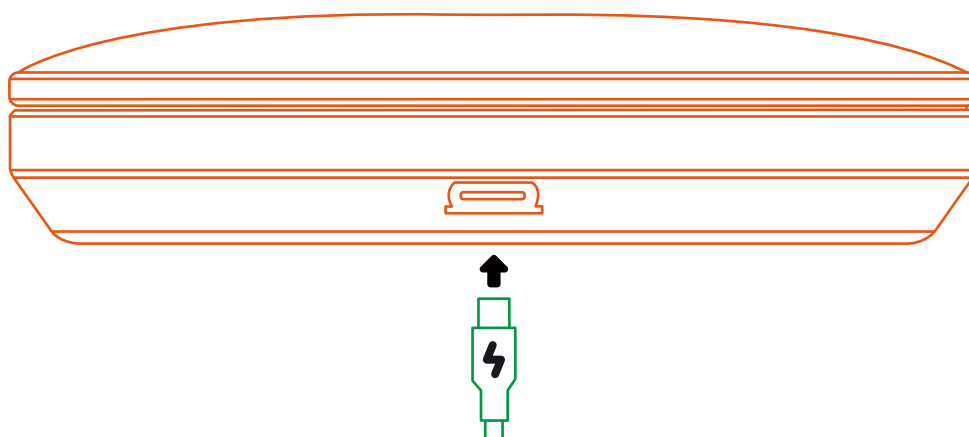

Connect Bluetooth



For the first time, please open the charging case, when the earbuds flash red and blue alternately, it means that they can be paired.

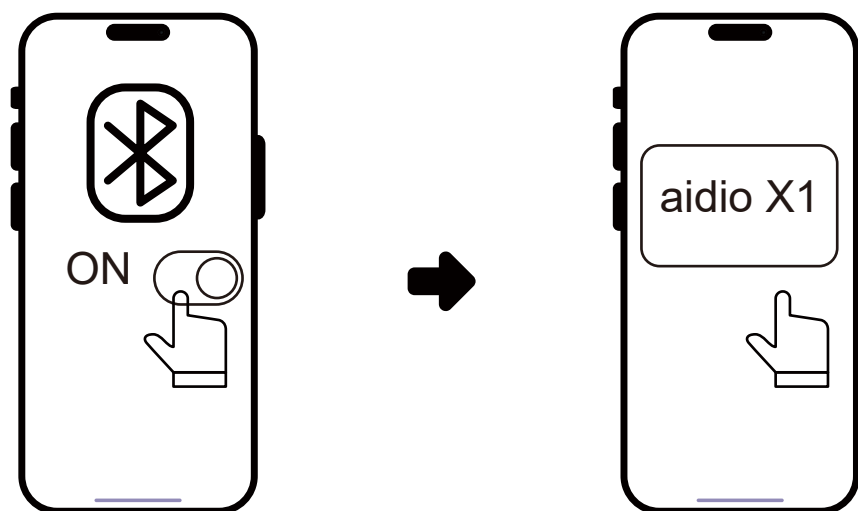

03

Music play and pause

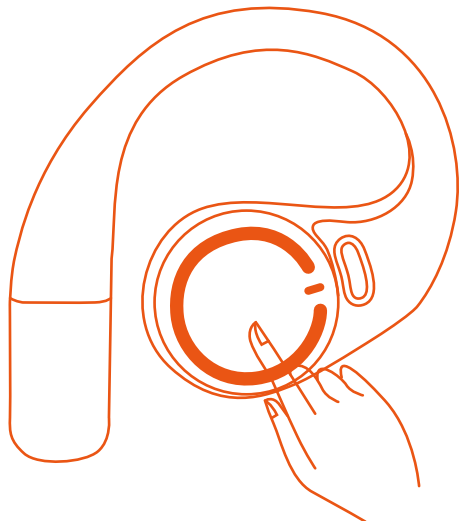

Both left and right ears can be clicked twice to play or pause
Music.

04

Switching Songs

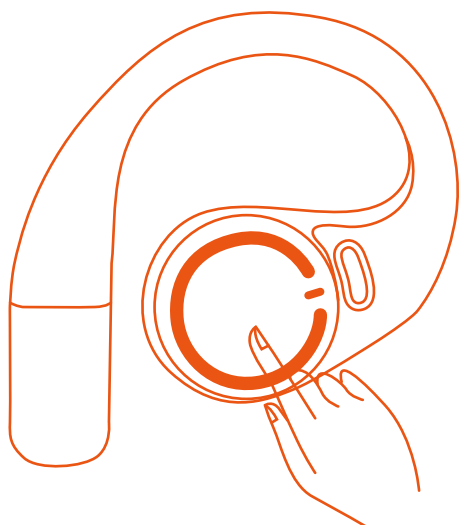

Tap your left ear 3 times to switch
to the previous song.



05

Low volume

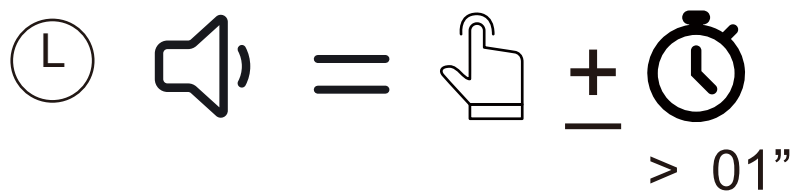
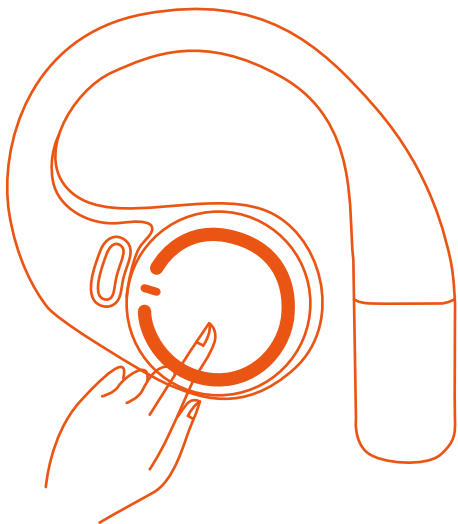

Long touch your left earbud to turn down the headphone volume.

06

Turn up the volume

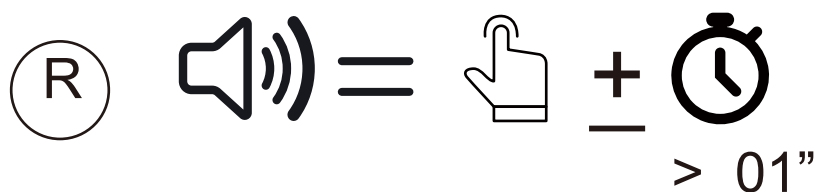
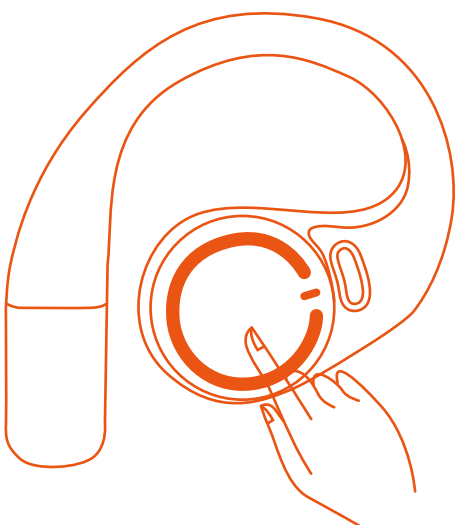

Long touch your right ear to turn up the volume of your headphones.

Incoming power control



1 tap to answer the call.



Tap 2 times to hang up or decline.

FCC warning

This device complies with part 15 of the FCC Rules. Operation is subject to the following two conditions: (1) This device may not cause harmful interference, and (2) this device must accept any interference received, including interference that may cause undesired operation.

Any changes or modifications not expressly approved by the party responsible for compliance could void the user's authority to operate the equipment.

This equipment has been tested and found to comply with the limits for a Class B digital device, pursuant to part 15 of the FCC Rules. These limits are designed to provide reasonable protection against harmful interference in a residential installation. This equipment generates, uses and can radiate radio frequency energy and, if not installed and used in accordance with the instructions, may cause harmful interference to radio communications. However, there is no guarantee that interference will not occur in a particular installation. If this equipment does cause harmful interference to radio or television reception, which can be determined by turning the equipment off and on, the user is encouraged to try to correct the interference by one or more of the following measures:

- Reorient or relocate the receiving antenna.
- Increase the separation between the equipment and receiver.
- Connect the equipment into an outlet on a circuit different from that to which the receiver is connected.
- Consult the dealer or an experienced radio/TV technician for help.

FCC Radiation Exposure Statement:

This equipment complies with FCC radiation exposure limits set forth for an uncontrolled environment.

This transmitter must not be colocated or operating in conjunction with any other antenna or transmitter.

FCC ID:2A988-007A00100750

FCC ID:2A988-007A00100758