

100mm

100mm

#### SETUP

- Download the Degrii app and sign in or create an account. You'll need it for installation (wiring) and set up of your thermostat.

DOWNLOAD THE APP BY  
SCANNING THIS QR CODE



OR DOWNLOAD DIRECTLY FROM THE  
APPLE APP STORE OR GOOGLE PLAY



- In the app home page, click "+ New Device" and add your Degrii thermostat. Follow the app instructions to complete the installation.

\* Installation height < 2m

## QUICK START GUIDE

#### Welcome To Degrii

Hello and welcome to Degrii. You made an excellent choice in joining the Degrii family by opting for our edge-cutting smart thermostat. We provide you with a complete home climate control system that works with the Degrii remote thermostat. It has the ability to add up to 12 remote thermostats, easy control using our mobile apps, lifetime access to personalized energy-saving tips based on time-tested scientific algorithms, and a dedicated support team who are always available to help you troubleshoot your Degrii products. We're excited to have you on our team!

#### IN THE BOX

- 1 Back Panel × 1

2 Thermostat × 1

3 Screws × 3
- 4 Anchor × 3

5 Quick Start Guide × 1

6 Labels × 1

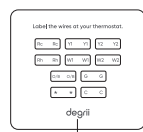
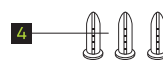
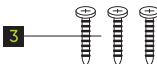
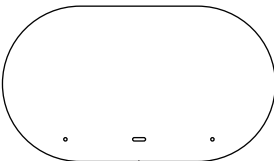
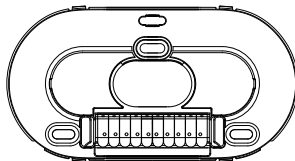

#### EXPLANATION OF SYMBOLS ON UNIT

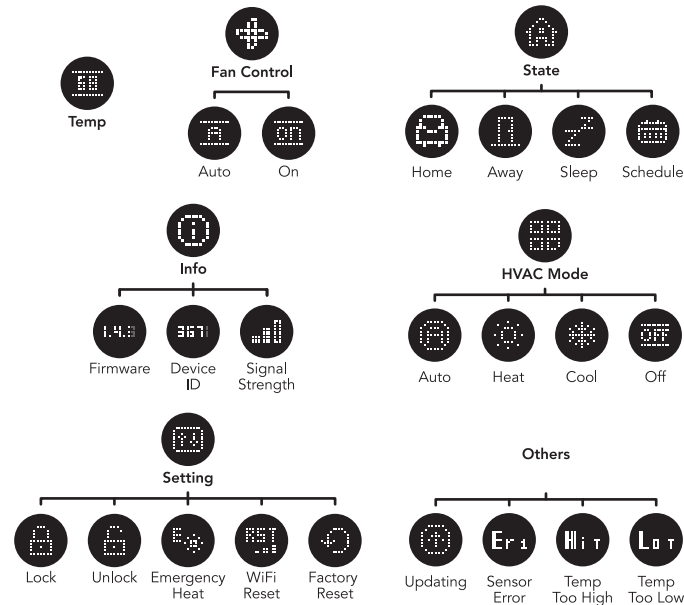

#### NEED HELP?

Contact our support wizards:  
<https://support.degrii.com>



Scan the QR code  
to learn more

#### COMPATABILITY

- Compatible with 24-volt systems such as forced air, hydronic, heat pump (including dual fuel), oil, gas, and electric.
- The Degrii smart thermostat is compatible with most single-stage and multi-stage conventional and heat pump heating and cooling systems.
- Not compatible with modulating equipment (Redlink, Comfortmater, Climate Talk).

| Electrical Requirements  | 24VAC  |
|--|--|
| Wires  | No need for Common (C-wire)                                  |
| Conventional (Furnace and Air Conditioning)                      | Up to 2 stages heat<br>Up to 2 stages cool                   |
| Heat Pumps   | Up to 4 heat stages<br>Up to 2 stages cool                   |
| Accessory (Humidifier, Dehumidifier, Emergency heat, Ventilator) | One Accessory support available                              |
| Transformer (Boiler and Air Conditioning)                        | Can support all combinations of single and dual transformers |

#### SPECIFICATIONS

Model: THM  
Bluetooth: BLE V5.0  
INPUT: 24VAC ~60Hz 0.15A max  
Connectivity: WiFi 802.11b/g/n, 2.4GHz  
  
Operation Temperature: 32~130°F (0~55°C)  
Operation Humidity: 5%~95%RH (non-condensing)  
Storage Temperature: -22~140°F (-30~60°C)  
Storage Humidity: 5%~95%RH (non-condensing)

#### WARNING

- Ensure power to your HVAC system is off at the breaker before adjusting any wires at your thermostat or control board.
  - Do not attempt to open or modify in any way the Degrii thermostat or accessories contained within this package.
  - Ensure the thermostat is installed in a location away from direct sunlight. Direct sunlight will affect temperature readings.
  - Associated Bluetooth logos are registered trademarks owned by Bluetooth SIG, Inc. and any use of such marks by Degrii Labs, Inc. is permitted under license. Other trademarks and trade names are those of their respective owners.
1. Assurez-vous que l'alimentation du disjoncteur de votre système CVC est coupée avant d'ajuster les fils de votre thermostat ou de votre tableau de commande.
2. Dans tous les cas, n'essayez pas d'ouvrir ou de modifier le thermostat Degrii ou accessoires contenue dans ce paquet.
3. Assurez-vous que le thermostat est installé dans un endroit éloigné de la lumière directe du soleil. La lumière directe du soleil affectera les lectures de température.
4. Les logos associés au Bluetooth sont des marques déposées appartenant à Bluetooth SIG, Inc. et toute utilisation de ces marques par Degrii Labs, Inc. Est autorisée sous licence. Les autres marques et noms commerciaux appartiennent à leurs propriétaires respectifs.

#### IC/ISED WARNING

**ISED Requirements:**  
This device complies with Innovation, Science, and Economic Development Canada license-exempt RSS standard(s). Operation is subject to the following two conditions:  
(1) this device may not cause interference, and  
(2) this device must accept any interference, including interference that may cause undesired operation of the device.

Le présent appareil est conforme aux CNR d'innocation, Sciences, et Développement économique Canada applicables aux appareils radio exempts de licence. L'exploitation est autorisée aux deux conditions suivantes:  
(1) l'appareil n doit pas produire de brouillage, et  
(2) l'utilisateur de l'appareil doit accepter tout brouillage radioélectrique subi, même si le brouillage est susceptible d'en compromettre le fonctionnement.

The device is compliant with RF exposure guidelines, users can obtain Canadian information on RF exposure and compliance. The minimum distance from body to use the device is 20cm.

Le présent appareil est conforme Après examen de ce matériel aux conformité ou aux limites d'intensité de champ RF, les utilisateurs peuvent sur l'exposition aux radiofréquences et la conformité and compliance d'acquérir les informations correspondantes. La distance minimale du corps à utiliser le dispositif est de 20cm.

#### FCC-ID WARNING

This equipment has been tested and found to comply with the limits for a Class B digital device, pursuant to part 15 of the FCC Rules. These limits are designed to provide reasonable protection against harmful interference in a residential installation. This equipment generates uses and can radiate radio frequency energy and, if not installed and used in accordance with the instructions, may cause harmful interference to radio communications. However, there is no guarantee that interference will not occur in a particular installation. If this equipment does cause harmful interference to radio or television reception, which can be determined by turning the equipment off and on, the user is encouraged to try to correct the interference by one or more of the following measures:

- Reorient or relocate the receiving antenna.
- Increase the separation between the equipment and receiver.
- Connect the equipment into an outlet on a circuit different from that to which the receiver is connected.
- Consult the dealer or an experienced radio/TV technician for help.

Any changes or modifications not expressly approved by the party responsible for compliance could void the user's authority to operate the equipment.

This device complies with part 15 of the FCC Rules. Operation is subject to the following two conditions: (1) This device may not cause harmful interference, and (2) this device must accept any interference received, including interference that may cause undesired operation.

**FCC RF EXPOSURE STATEMENT:**  
This equipment complies with FCC radiation exposure limits set forth for an uncontrolled environment. This equipment should be installed and operated with minimum distance of 20cm between the radiator & your body.  
This transmitter must not be co-located or operating in conjunction with any other antenna or transmitter.

#### WARRANTY INFORMATION

Degrii warrants to the original owner of the Product that the Degrii thermostat will be free from defects in materials and workmanship for a period of one (1) year from the date you purchased your product from Degrii or an authorized retailer. Degrii will, at its sole option, either (a) repair or replace any defective product or component or (b) accept the return of the Product and refund the money actually paid by the original purchaser for the Product through the payment method used by the purchaser. This warranty is not transferable and applies only to the original purchaser. Repairs or replacements may be made with new or refurbished products or components, at Degrii's sole discretion. If the product or a component incorporated in that product is no longer available, Degrii may, at its own discretion, replace the product with the available model nearest to the original model's form, functionality, and performance.

### 用户手册

成品尺寸:100\*100mm

材质:105g双铜

印刷:四色 + PANTONE 2290C

工艺:双面水油 风琴5折页

Mars