



Pain Therapy Device

Model: P.T.S-X

User Manual

(Version: V2. 0)

Guangzhou Xinbo Electronic Co., Ltd

Contents

FOREWORD	3
1. SAFETY GUIDE	3
1.1 Warnings	4
1.2 Precautions	5
1.3 Contraindications	8
1.4 Adverse Reactions	8
1.5 Special Population	9
2. DEVICE DESCRIPTION	9
2.1 General Description	9
2.2 Brief Operation Description	9
2.3 Intended Use / Indications for Use	9
2.4 Device Drawing	10
2.5 Device Components	17
2.6 Treatment plan	19
2.7 Specifications	20
3. INSTRUCTIONS OF USE	22
3.1 Recharging the Pain Therapy Device.	22
3.2 To insert the Pain Therapy Device onto the Electrodes.	23
3.3 To operate the Pain Therapy Device directly or with the remote control.	23
3.4 To prepare the different electrodes to use with PTS-X.	24
3.5 Operation details	69

3.6 Electrode Pads Guideline	70
4. CLEANING AND MAINTENANCE	71
For Pain Therapy Device	71
For Fabric Electrodes	71
For Patch Electrode Pads	71
Storage	71
Notes For Patch Electrode Sticky Pads	71
Method for disposing the electronic devices and accessories	71
5. STORAGE	72
6. TROUBLE SHOOTING	72
7. DISPOSAL	75
8. WARRANTY CARD	75
9. LABEL SYMBOLS	76
10. ELECTROMAGNETIC COMPATIBILITY	77

FOREWORD

Thank you very much for choosing DR-HO'S Pain Therapy Device. Before using the device, please read the User's manual carefully and follow the **SAFETY GUIDE** to operate it correctly for best results. The User's manual should be kept for your future reference.

1. SAFETY GUIDE

Please read the entire instructional manual before using the Pain Therapy Device. It will give you a better understanding of how the product works. If you are not sure which kind of medical conditions you are suffering with, you should preclude yourself from using this

device, consult your Chiropractor, Physiotherapist, Osteopath or Medical practitioner. The Pain Therapy Device is intended to use for relaxing the tight muscles, improving blood circulation and relieving the pain through the stimulation of nerves and healthy muscles.

1.1 Warnings

DO NOT USE THIS DEVICE UNDER THESE CONDITIONS
<ul style="list-style-type: none">● You should consult your physician when starting any new treatment, including the use of this device.
<ul style="list-style-type: none">● This device must not be used on persons with cardiac pacemakers, implanted defibrillator, other implanted metallic or electronic devices.
<ul style="list-style-type: none">● The long-term effects of chronic electrical stimulation are unknown.
<ul style="list-style-type: none">● MR Unsafe – keep away from magnetic resonance imaging (MRI) equipment.
<ul style="list-style-type: none">● Implanted with a life-supporting medical electronic device such as an artificial heart or lung or respirator.
<ul style="list-style-type: none">● In the presence of electronic monitoring equipment (e. g., cardiac monitors, ECG alarms), which may not operate properly when the electrical stimulation device is in use.
<ul style="list-style-type: none">● On open wounds, rashes, swollen, red, infected or inflamed areas or skin eruptions; On top of, or in proximity to, cancerous lesions.
<ul style="list-style-type: none">● Over areas of damaged skin, scratches, blisters or sensitive skin from shaving or hair removal.
<ul style="list-style-type: none">● Do not apply the pads to your head, face, the front and sides of the neck, the throat, or on both sides of the thorax at the same time.
<ul style="list-style-type: none">● Stimulation over the carotid sinus nerves, particularly in patients with a known sensitivity to the carotid sinus reflex.
<ul style="list-style-type: none">● Do not directly Stimulate over the front of your neck or mouth. This could cause severe muscle spasms resulting in closure of your airway, difficulty in breathing, or adverse effects on heart rhythm or blood pressure.

<ul style="list-style-type: none">● Do not place pads directly over the heart. Electrical current into the heart may cause cardiac arrhythmias.
DO NOT USE ON THESE INDIVIDUALS
<ul style="list-style-type: none">● Children or infants, because the device has not been evaluated for pediatric use.
<ul style="list-style-type: none">● Person's incapable of expressing their thoughts or intentions.
DO NOT USE THIS DEVICE DURING THESE ACTIVITIES
<ul style="list-style-type: none">● Do not use in the bath or shower.
<ul style="list-style-type: none">● Always set timer to your desired time before sleep, so the device will turn off when treatment is over.
WARNINGS AND PRECAUTIONS REGARDING THE PADS
<ul style="list-style-type: none">● Apply pads to normal, healthy dry clean skin only. Do not apply pads onto wound or damaged skin because it will be painful and may disrupt the healing process.
<ul style="list-style-type: none">● If you experience any skin irritation or redness after using this device, do not continue stimulation in that area until skin has returned to normal.
<ul style="list-style-type: none">● 2 pads from the same wire must be placed on the body in order to work. Be sure the pads are not touching each other; otherwise, impulses will not be felt.

1.2 Precautions

<ul style="list-style-type: none">● If you feel abnormal symptoms during the treatment, please stop using the unit and consult a doctor before resuming treatment.
<ul style="list-style-type: none">● During the treatment, if you wish to move the electrodes to another part of your body, switch OFF the unit first, and then move the electrodes before resuming treatment.
<ul style="list-style-type: none">● If you have any problems on setting, maintaining or using this device, please contact manufacturer or customer service. Please report to manufacturer if the device malfunctions. Don't open or repair the device by yourself.
<ul style="list-style-type: none">● Dust may affect the performance of the unit, please use a soft cloth to clean the device as needed.

<ul style="list-style-type: none">● Please use the device according to the requirement of the Users' manual, otherwise the effectiveness of the device will be affected.
<ul style="list-style-type: none">● Please keep the device from the reach of infants, children or pets, inhalation or swallowing of small parts is dangerous and can be potentially fatal.
<ul style="list-style-type: none">● Please use accessories that are specified/authorized by manufacturer only. The use of unauthorized accessories may cause damage to the unit or danger to the operator / patient.
<ul style="list-style-type: none">● If you are allergic to plastic, please don't use this device.
<ul style="list-style-type: none">● Long cables have the potential to strangle, therefore, please be careful when using cables around the neck and shoulder areas.
<ul style="list-style-type: none">● Do not fold the sticky electrode pads, this may cause the pads to not function properly. Store the pads on the plastic pad holder or on the protective clear plastic sheet when not in use.
<ul style="list-style-type: none">● Do not apply ointment or any solvent to the electrode pads or to your skin because it will cause the pads to not stick and function properly. The sticky electrode pads are already pre-gelled and will adhere to your skin when moist.
<ul style="list-style-type: none">● Do not use the unit in areas of high humidity, such as the bathroom or in the shower as this may cause moisture damage to the electronics in the unit.
<ul style="list-style-type: none">● Do not attach the electrode to the same area on the skin for more than 40 minutes each time as this may cause skin irritation.
<ul style="list-style-type: none">● During treatment ensure that metallic items with conductive capabilities such as necklaces, belts, rings etc. are kept away from the electrodes.
<ul style="list-style-type: none">● Make sure the wire is securely plugged into the device, the wires are well connected, and the pads are stuck tightly on the skin area where you wish to treat to ensure effective therapy. Loose pads on the skin can cause uncomfortable pins and needle sensations.
<ul style="list-style-type: none">● If using rechargeable 1. 5V batteries; use a CE / UL approved battery charger. Never connect the unit directly to a battery charger or to other powered equipment.
<ul style="list-style-type: none">● Simultaneous connection of a patient to this device and a high frequency surgical equipment may result in burns at the site of Pain Therapy Device electrodes and possible damage to Pain Therapy Device.

<ul style="list-style-type: none">● Pads should not be in contact to each other, if they are, you will not feel the stimulation.
<ul style="list-style-type: none">● Do not share pads with another person. This may cause a skin irritation or skin infection. Individuals should have their own set of electrode pads for personal use.
<ul style="list-style-type: none">● Do not leave pads attached to the skin after treatment.
<ul style="list-style-type: none">● Do not use the unit in the presence of a flammable anesthetic gas mixture, compressed Oxygen or Nitrous Oxide.
<ul style="list-style-type: none">● If the unit is not working properly or you feel uncomfortable during use, stop the treatment.
<ul style="list-style-type: none">● Do not use for any other purpose except for what it is intended for.
<ul style="list-style-type: none">● Do not use the device while wearing other electronic devices.
<ul style="list-style-type: none">● Do not use while operating a vehicle.
<ul style="list-style-type: none">● Do not bend or pull the end of the cord.
<ul style="list-style-type: none">● Replace the cord when it was broken or damaged.
<ul style="list-style-type: none">● Do not throw the batteries into fire. The batteries may explode.
<ul style="list-style-type: none">● Dispose of the device, batteries and components according to applicable legal regulations. Unlawful disposal may cause environmental pollution.
<ul style="list-style-type: none">● Do not use this device if pregnant.
<ul style="list-style-type: none">● If you have diagnosed heart disease or have any heart problem, you should follow precautions recommended by your physician.
<ul style="list-style-type: none">● If you have suspected or diagnosed epilepsy, you should follow precautions recommended by your physician.
<ul style="list-style-type: none">● Do not use the device in the presence of the following:<ul style="list-style-type: none">a. When there is a tendency to hemorrhage following acute trauma or fracture.b. Following recommendation of doctor after surgery because stimulation may disrupt the healing process.d. Over areas of the skin that are damaged, cut, with rash or blistered;

<ul style="list-style-type: none">● You may experience skin irritation or hypersensitivity due to the electrical stimulation or electrically conductive medium (gel).
<ul style="list-style-type: none">● The stimulation settings should be based on your needs and comfort level.
<ul style="list-style-type: none">● Should be used only with the leads and electrodes recommended for use by the manufacturer. Always follow instructions on electrode placement.
<ul style="list-style-type: none">● Should not use while driving, operating machinery, or during any activity in which involuntary muscle contractions may put the user at undue risk of injury.
<ul style="list-style-type: none">● Caution should be used in the presence of the following: Over the menstruating or pregnant uterus; and Over areas of the skin which lack normal sensation.

1.3 Contraindications

For the following patients, they should not use the device:

- Patients who have a cardiac pacemaker, implanted defibrillator, or other implanted metallic or electronic device. Such use could cause electric shock, burns, electrical interference, or death.
- Patients whose pain syndromes are undiagnosed.
- During Pregnancy.
- Infants or young children.
- Those who cannot express themselves.

1.4 Adverse Reactions

- Person with highly sensitive skin may experience skin irritation with the electrodes.
- You may experience uncomfortable pins and needle sensations during the treatment if the electrode pads are sticking loosely on the skin, or if the electrodes lack moisture and does not stick properly to the skin or if you have a scratch or opening on the skin. If you experience any unexpected negative reactions with the treatments, stop using the device and consult with your physician first before resuming treatments.
- Treating one region of the body for extended periods of time can cause muscle fatigue and soreness. Try limiting the treatment time between 40 to 60 minutes each time, about 3 to 5 times per day, or less if you do experience soreness after a prolonged treatment on the same area.

1.5 Special Population

This device should not be used by patients with:

- ① Pacemakers, Defibrillators or extreme Cardiac Irregularities, Metals Implants or Electronic Auxiliary Devices
- ② Tendency toward internal Bleeding
- ③ Epilepsy
- ④ Pregnant Women

2. DEVICE DESCRIPTION

2.1 General Description

DR-HO'S Pain Therapy Device is a state-of-the-art pain management device with a combination of TENS, EMS and NMES therapy technology.

2.2 Brief Operation Description

- DR-HO'S Pain Therapy Device is a nerve and muscle stimulator designed for easy operation.
- It has 3 modes of therapy you can select from, and you can adjust the intensity of the stimulation to your comfort level.

You can turn the power ON/OFF, plus adjust the intensity and select the mode directly by pressing the buttons on the device. Power cannot be turn ON with the remote control.

- You can also use the remote control to adjust the intensity and select the mode.
- The (M) button on the device and on the remote control is used to select the mode of therapy, the (+) and (-) buttons on the device and on the remote control is used to increase or decrease the intensity of the stimulation.
- The device works by sending gentle electrical pulses to attached electrode pads which helps to conduct these pulses to the skin area being treated. The pulses will go through the skin to stimulate the nerves which will cause the muscles to contract and relax in tune with the frequency of the stimulation.
- A variety of electrodes are purposely designed to be used with this Pain Therapy Device, model PTS-X, to make the application easier and more comfortable for the User.
- All the accessories can only be purchased from your local distributor.

2.3 Intended Use / Indications for Use

The Pain Therapy Device (Model: P.T.S-X) has TENS, EMS and NMES technology:

TENS:

For relief of pain and management of pain associated with sore and aching muscles in the upper and lower back, the back of the neck, upper extremities (shoulder and arm), lower extremities (leg and feet) due to strain from exercise, work or normal household work activities by applying current to stimulate the nerves.

- For relief of pain associated with arthritis.
- For symptomatic relief and management of chronic intractable pain

EMS:

- To stimulate healthy muscles in order to improve and facilitate muscle performance.
- To temporarily increase local blood circulation in healthy muscles.

NMES:

- For relaxation of muscle spasm.
- Increase of blood flow circulation.
- Prevention or retardation of disuse muscle atrophy.
- Muscle re-education.
- Maintaining or increasing range of motion.
- Immediate post-surgical stimulation of calf muscles to prevent venous thrombosis.
- For Users with conditions or diseases that are associated with impaired (poor) blood flow in the legs/ankle/feet. NMES through the foot electrodes is intended to use as an adjunctive treatment (as an additional treatment to your existing treatment) to temporarily reduce lower extremity pain, swelling and cramping.

2.4 Device Drawing

Drawing of the Pain Therapy Device and Remote Control below:



Fig.2.4.1 Product Image

Drawing of all electrodes is as below:

Electrodes	Photos of electrodes showing the exterior and interior	Size of Electrode	Weight
Ankle & Foot Therapy Electrodes (outer / inner)		8208mm ²	145g
Ankle Therapy Electrodes (outer / inner)		8208mm ²	111g
Calf Circulation Promoter Electrodes (outer / inner)		4400mm ²	89g
Knee Therapy Electrodes (outer / inner)		13188mm ²	202.5g

Shoulder Therapy Electrodes (outer / inner)		8362mm ²	163g
Elbow Therapy Electrodes (outer / inner)		3532.5mm ²	87g
Wrist & Thumb Therapy Electrodes		2119.5mm ²	84g
Knee Therapy Electrodes		14277.7mm ²	607g

Backrest Therapy Electrodes		11960mm ²	394g
Belt Electrodes - I		3953mm ²	143.5
Belt Eelectrodes - II		3953mm ²	125.5g
Neck Comforter Electrodes		2123mm ²	500.5g

Neck Brace Electrodes		2123mm ²	435.5g
Large Patch Electrode		9600mm ²	27g
Small Patch Electrode		8820mm ²	11.5g
Circulation Promoter Pro (CP-Pro)		32550mm ²	1508.5g
Back belt with electrodes (Fabric type)		7590mm ²	154.5g

Arm Band with Electrodes (Fabric type)		5525mm ²	43g
Shirt with electrodes		Shoulder: 6175mm ² Waist: 10925mm ²	112g
Triple Action Back Belt with Electrodes (Fabric type)		9500mm ²	342g
Leg Rest with Electrodes - I (Fabric type)		9600mm ²	747g
Leg Rest with Electrodes - II (Fabric type)		8880mm ²	524.5g

Knee Band with Electrodes (Fabric type)		9250mm ²	253g
Neck Therapy Pro - I		2826mm ²	1520g
Neck Therapy Pro - II		2826mm ²	291.5g
Neck Therapy Pro - IV		2123mm ²	310.5g
Backrest Electrodes		8400mm ²	77g

※ Application parts: All Electrodes.

2.5 Device Components

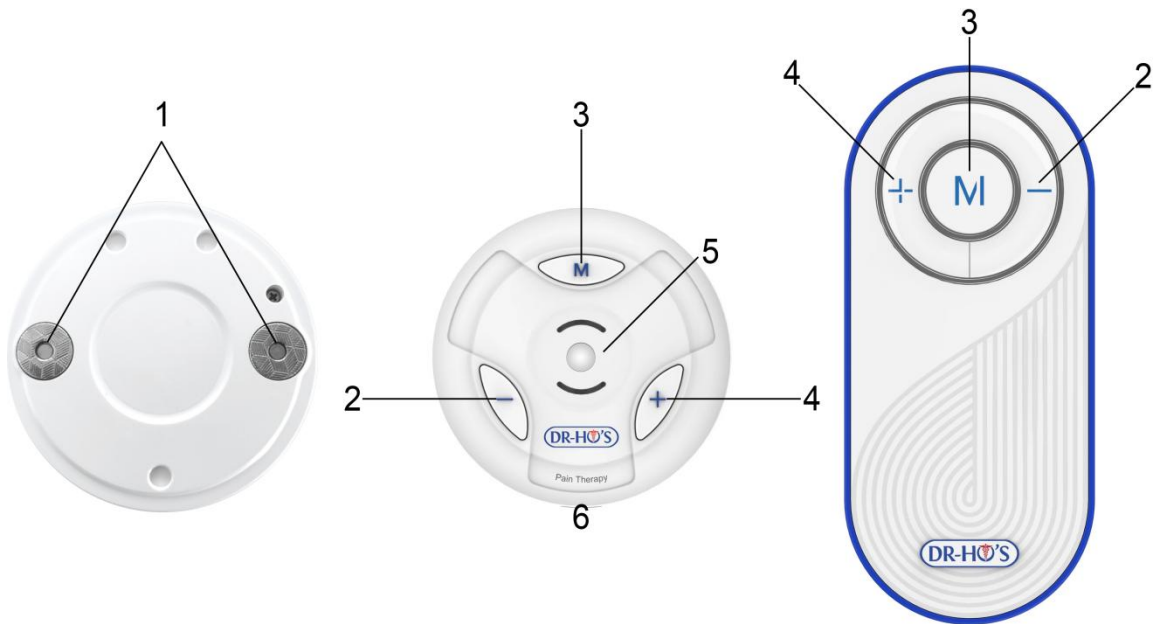

Fig. 2.5.1 Introduction of Pain Therapy Device and Remote Control

Introduction:

1. Metal connectors at back of the Pain Therapy Device: For the Pain Therapy Device to power the electrodes, the 2 metal connectors of the electrodes must be connected to the 2 metal connectors at the back of the Pain Therapy device.
2. Turn Power On by holding down the (M) button on the Pain Therapy device only for 1~2 seconds. **Note:** You cannot turn power ON with the remote control.
3. To increase the intensity, press the (+) button on the device or on the remote control.
4. To decrease the intensity, press the (-) button on the device or on the remote control.
5. To change the Mode, press the (M) button on the device or on the remote control.
6. Turn Power Off by holding down the (M) button on the Pain Therapy device or on the Remote Control for 1~2 seconds.
7. Flashing Indicator lights to indicate the device's operation.
8. Charging port at the side of the device.

Components and Accessories:

Item	Components and Accessories	Amount
Pain Therapy Device and Remote Control		1
Electrodes	<p>Please refer to the section 2.4.2 electrodes table for details.</p> <p>Note: All electrodes can be powered by the Pain Therapy device.</p>	Optional
The Power Adapter (Input: 110-240V Output: DC 5V)		1
Bag		1

<p>Conductive Gel</p> <p>Note:</p> <p>Conductive gel cleared in the K202402</p>		<p>1</p>
---	---	----------

2.6 Treatment plan

How long is each treatment?	The device is set to provide 30 minutes of continuous treatment. You can repeat if needed.
How do I customize the therapy for best results?	You can select from mode 1 to mode 6, and you can adjust the intensity to your comfort level.
What is the duration and frequency of treatment?	You can treat yourself 30 to 60 minutes each session, up to 3 to 5 times per day, or more if needed, depending on the severity of your condition.
When should I stop treatment?	If pain is reduced or relieved, you can stop the treatment or continue to use it to relax your muscles. If there's any unexpected adverse reaction or additional pain, stop the treatment.

Note: While the degree and duration of relief can vary between individuals, most people can experience significant and noticeable muscle relaxation and pain relief after 30 to 40 minutes of treatment. Some people with chronic and severe painful conditions may require longer and more frequent treatments before they experience relief. On occasion, when using the Circulation Promoter to stimulate the bottom of their feet, some people may not feel the stimulation sensation for the first 30 to 40 minutes, even when the intensity is turned up to the maximum level. However, after continuation of the treatment for a longer period, they began to feel the stimulation at the bottom of their feet. The results vary and will depend upon your underlying conditions and how often you use the device. If your pain is not relieved as much as you like, try to increase the intensity, change the mode and treat yourself more often each day and for a longer time will help. Always make sure that the stimulation is comfortable and not painful.

2.7 Specifications

Basic Specification		
Power Source(s)		Lithium Battery (340mA 3.7V) Adapter Input 110-240V Output DC 5V
Method of Line Current Isolation		Type BF Applied Part
Patient Leakage Current	NC	DC: 0.5 μ A
	SFC	DC: 0.6 μ A
Average DC current through electrodes when device is on but no pulses are being applied		< 0.01 μ A
Number of Output Channels		2 Channels (Synchronous)
Number of Output Modes		6
Output Intensity Level		Continue adjustable
Synchronous or alternating?		Synchronous
Method of Channel Isolation		Parallel connection
Regulated Current or Regulated Voltage?		Regulated Voltage
Software/Firmware/Microprocessor Control?		Yes
Automatic Overload Trip		No
Automatic No-Load Trip		No

Automatic Shut Off		Yes
User Override Control		Yes
Indicator Display	On/Off Status	Yes
	Low Battery	No
	Voltage / Current Level	No
Timer Range		20 min
Dimensions		Main Unit: Diameter 57 × 20 mm Remote Control: 106 x 47x14mm Electrode: Please refer to 2.2.2
Weight		Main Unit: About 90g Electrode: Please refer to 2.2.2
Output Specifications		
Waveform		Pulsed, symmetric, biphasic
Shape		Rectangular, with interphase interval
Maximum Output Voltage	80Vp @ 500Ω	
	90Vp @ 2kΩ	
	100Vp @ 10kΩ	
Maximum Output Current	160mA @ 500Ω	
	45mA @ 2kΩ	
	10mA @ 10kΩ	

Pulse Duration	170 μ s
Pulse frequency	1.85~136 Hz
Net Charge (per pulse)	0 μ C @ 500 Ω , Method: Balanced waveform
Maximum Phase Charge	27.2 μ C @ 500 Ω
Maximum Average Current	1.79 mA @ 500 Ω
Maximum Current Density (r.m.s)	7.37 mA/cm ² @ 500 Ω
Maximum Average Power Density	0.1219 mW/cm ² @ 500 Ω
Additional Specification	
Operating Environment	Temperature: 5~40°C Humidity: \leq 80%RH Atmospheric Pressure: 86~106kPa
Storage Environment	Temperature: Main Unit: -20 ~ 55°C Electrode: 5~40°C Humidity: \leq 95% RH Atmospheric Pressure: 50~106 kPa

3. INSTRUCTIONS OF USE

3.1 Recharging the Pain Therapy Device.

If needed, recharge the Pain Therapy Device with the power adapter included with your system. Charging time is approximately 2 hours. Do not use other power adapters except the one included in your system, or it can damage the device.

When fully charged, the device can be used continuously for approximately 5 hours.

When the battery is drained, the indicator light will flash 3 times, and the device will then shut down automatically.



3.2 To insert the Pain Therapy Device onto the Electrodes.



Insert the Pain Therapy device into the harness on the electrode, then rotate the device until the 2 metal connectors of the device and the electrodes are connected in the fixed position. Depending on the electrodes you are using, you can insert the Pain Therapy device before or after you wear the electrodes on your body, whichever way is easier is fine.

3.3 To operate the Pain Therapy Device directly or with the remote control.

Note: You can turn ON / OFF the power by holding down the (M) button for 1~2 seconds on the Pain Therapy device only. Power cannot be turn ON/OFF with the remote control.

Note: After the powered is turned ON, you can adjust the intensity by pressing the (+) or (-) buttons, and you can select the Mode by pressing the (M) button on the Pain Therapy device or on the remote control.

- Turn Power ON by holding down the (M) button on the Pain Therapy device for 1~2 seconds.
- To increase the intensity, press the (+) button on the device or on the remote control.

- To decrease the intensity, press the (-) button on the device or on the remote control.
- To change the Mode, press the (M) button on the device or on the remote control.
- Turn Power Off by holding down the (M) button on the Pain Therapy device for 1~2 seconds. Power cannot be turn ON/OFF with the remote control.

Note: The Pain Therapy Device will turn off automatically after 30 minutes of therapy.

3.4 To prepare the different electrodes to use with PTS-X.

1. Ankle & Foot Therapy Electrodes

Take off your socks.



Flip the electrodes inside out to expose the fabric electrode pads. Spray plenty of conductive gel onto the entire surface of all fabric electrode pads.



Flip the electrodes back inside. Wear the Foot Therapy Electrode.



Insert the device and rotate it to the fixed position.



Position your leg with the ankle and foot in a rested and relaxed position. Turn power ON the Pain Therapy Device by holding down the (M) button for 1~2 seconds, then use the remote control to adjust the intensity to your comfort level and enjoy.

2. Ankle Therapy Electrodes

Take off your socks.



Flip the electrodes inside out to expose the fabric electrode pads. Spray plenty of conductive gel onto the entire surface of the 2 fabric electrode pads.



Flip the electrodes back inside. Wear the ankle therapy electrodes.



Insert the device and rotate it to the fixed position.



Position your leg with the ankle in a rested and relaxed position. Turn power ON the Pain Therapy Device by holding down the (M) button for 1~2 seconds, then use the remote control to adjust the intensity to your comfort level and enjoy.

3. Calf Circulation Promoter Electrodes

Flip the electrodes inside out to expose the fabric electrode pads. Spray plenty of conductive gel onto the entire surface of the 2 fabric electrode pads.



Flip the electrode back inside. Wear the electrodes with the fabric electrodes positioned at the back of your calf muscles.



Insert the device and rotate it to the fixed position.



Position your leg with the calf muscles in a rested and relaxed position. Turn power ON the Pain Therapy Device by holding down the (M) button for 1~2 seconds, then use the remote control to adjust the intensity to your comfort level and enjoy.

4. Knee Therapy Electrodes

Flip the electrodes inside out to expose the fabric electrode pads. Spray plenty of conductive gel onto the entire surface of the 2 fabric electrode pads.



Wear the electrodes with the fabric electrodes around your knee cap.



Insert the device and rotate it to the fixed position.



Position your leg with the knee in a rested and relaxed position. Turn power ON the Pain Therapy Device by holding down the (M) button for 1~2 seconds, then use the remote control to adjust the intensity to your comfort level and enjoy.

5. Shoulder Therapy Electrodes

Expose the fabric electrode pads inside the Shoulder Therapy Electrodes. Spray plenty of conductive gel onto the entire surface of the 2 fabric electrode pads.



Wear the electrodes on your right or left shoulder and adjust the length of the elastic strap to hold the electrodes tight against your shoulder.



Insert the device and rotate it to the fixed position.



Position your arm with the shoulder in a rested and relaxed position. Turn power ON the Pain Therapy Device by holding down the (M) button for 1~2 seconds, then use the remote control to adjust the intensity to your comfort level and enjoy.

6. Elbow Therapy Electrodes

Flip the electrodes inside out to expose the fabric electrode pads. Spray plenty of conductive gel onto the entire surface of the 2 fabric electrode pads.



Wear the electrodes with the fabric electrode pads over the painful area of your elbow. Insert the device and rotate it to the fixed position.



Position your arm with the elbow in a rested and relaxed position. Turn power ON the Pain Therapy Device by holding down the (M) button for 1~2 seconds, then use the remote control to adjust the intensity to your comfort level and enjoy.

7. Hand & Thumb Therapy Electrodes

Flip the electrodes inside out to expose the fabric electrode pads. Spray plenty of conductive gel onto the entire surface of the 2 fabric electrode pads.



Flip the electrodes back inside. Wear the hand & thumb electrodes on your right hand or left hand.

Note: The same electrodes can be worn on your right hand or left hand. When wearing the electrodes on your left hand, the device harness will be on the back of your hand. When wearing it on the right hand, the device harness will be on your palm side.



Insert the device and rotate it to the fixed position.



Position your arm with the hand and wrist in a rested and relaxed position. Turn power ON the Pain Therapy Device by holding down the (M) button for 1~2 seconds, then use the remote control to adjust the intensity to your comfort level and enjoy.

8. Knee Band with Electrodes (Fabric type)

Expose the fabric electrode pads on the inside of the knee band. Spray plenty of conductive gel onto the entire surface of the 2 fabric electrode pads.



Keep your knee straight, put Knee Band with hole over kneecap, first use the middle strap behind your knee to fasten.



Then use the 2 straps at the top and bottom of the Knee Band to fully fasten.



For extra support and comfort, inflate it.



Adjust the brackets on both sides of the Knee Band for desired range of motion limitation.



Insert the device and rotate it to the fixed position.



Position your leg with the knee bent in a rested and relaxed position. Turn power ON the Pain Therapy Device by holding down the (M) button for 1~2 seconds, then use the remote control to adjust the intensity to your comfort level and enjoy.

9. Belt Electrodes I

Spray plenty of conductive gel onto the entire surface of the 2 fabric electrode pads.



Wrap the belt with the 2 electrodes against your back or the abdomen. Velcro the belt tight against your body.



Insert the device and rotate it to the fixed position.



Position yourself in a rested and relaxed position. Turn power ON the Pain Therapy Device by holding down the (M) button for 1~2 seconds, then use the remote control to adjust the intensity to your comfort level and enjoy.

10. Belt Electrodes II

Spray plenty of conductive gel on the 2 fabric electrode pads.



Wrap the belt with the 2 fabric electrode pads against your lower back or the abdomen. Velcro the belt tight against your body.

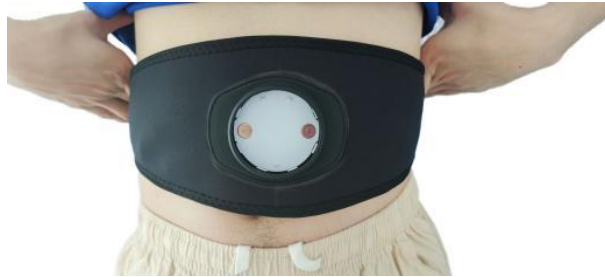

Insert the device and rotate it to the fixed position.



Position yourself in a rested and relaxed position. Turn power ON the Pain Therapy Device by holding down the (M) button for 1~2 seconds, then use the remote control to adjust the intensity to your comfort level and enjoy.

11. Backrest Electrodes

Place the Backrest Electrodes on a chair.



Insert the device and rotate it to the fixed position.



Spray plenty of conductive gel on the 2 fabric electrode pads.



Sit down and lift the back of your shirt to expose the skin of your lower back.



Sit with your lower back firmly against the Backrest Electrodes. Be sure your bare skin is in full contact with the 2 fabric electrode pads.



For extra comfort, inflate the lumbar support.



Sit with your back in a rested and relaxed position. Turn power ON the Pain Therapy Device by holding down the (M) button for 1~2 seconds, then use the remote control to adjust the intensity to your comfort level and enjoy.

12. Neck Comforter Electrodes

Remove any metal necklaces from your neck. Move the collar on your shirt lower to expose the skin at the back of your neck and upper shoulders.



Insert the Pain Therapy device into the Neck Comforter Electrodes and rotate it to the fixed position.



Spray plenty of conductive gel on the 2 fabric electrode pads at the back of the Neck Comforter.



Note: The fabric electrode pads must make full contact with the bare skin at the back of your neck.

Place the Neck Comforter with the fabric electrode pads positioned at the back of your neck.



For extra support and comfort, inflate the Neck Comfort.



Sit with your neck in a rested and relaxed position. Turn power ON the Pain Therapy Device by holding down the (M) button for 1~2 seconds, then use the remote control to adjust the intensity to your comfort level and enjoy.

13. Neck Support Brace Electrodes

Remove any metal necklaces from your neck. Move the collar on your shirt lower to expose the skin at the back of your neck and upper shoulders.



Insert the Pain Therapy Device onto the Neck Brace Electrodes and rotate it to the fixed position.



Spray plenty of conductive gel on the 2 fabric electrode pads at the back of the Neck Support Brace.



Place the Neck Support around your neck with the 2 electrodes at the back of your neck. Use the Velcro strap to fasten the Neck Support Brace.



For extra comfort and support, turn the knob in front of the Neck Support to adjust the chin rest.



For additional comfort, inflate the neck support.



Position your neck and shoulder in a rested and relaxed position. Turn power ON the Pain Therapy Device by holding down the (M) button for 1~2 seconds, then use the remote control to adjust the intensity to your comfort level and enjoy.

14. Circulation Promoter Pro (CP-Pro)

Insert the Pain Therapy Device onto the Circulation Promoter Pro and rotate it to the fixed position.



Note: Treat your legs and feet while sitting down with your feet resting on the Circulation Promoter.

Note: Follow the same instructions for using the Circulation Promoter Pro (CP-Pro) and for using Portable Foot Pain Relief Electrodes.

Remove your socks to reveal your bare feet.



Spray conductive gel onto the entire surface of the two (2) foot shaped electrodes.



Spray conductive gel onto the bottom of your feet.



Place your bare feet onto the electrodes.



15. Large and Small Patch Electrode

Insert the device and rotate it to the fixed position.

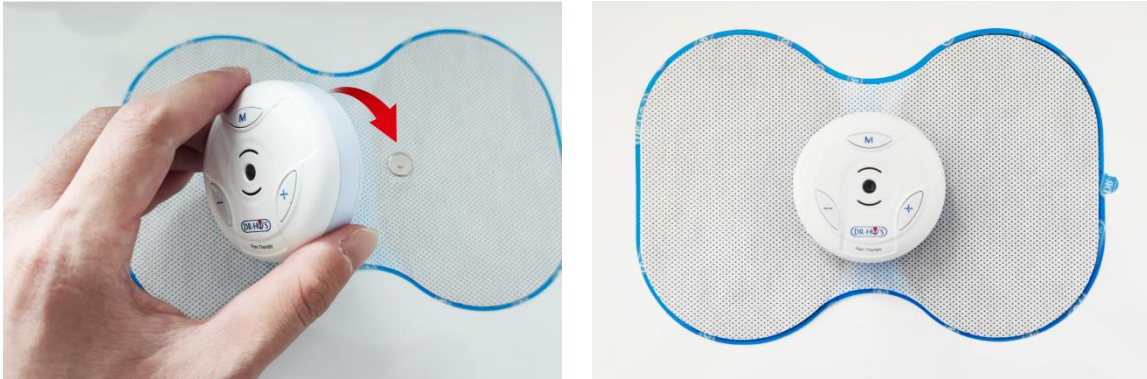

Remove the protective film on the electrode pads, and place the pads on clean, dry and healthy skin over the area with pain.



Position the area of your body being treated in a rested and relaxed position. Turn power ON the Pain Therapy Device by holding down the (M) button for 1~2 seconds, then use the remote control to adjust the intensity to your comfort level and enjoy.

Recommended Patch Electrodes Placements:

Upper Shoulder: Place small electrodes over the upper shoulders.



Lower Back: Place the large electrodes over the lower back with the spine in the middle.



Shoulder Rotator Cuff: Place the large or small electrodes over the shoulder.



Elbow and forearm: Place the small electrodes over the backside or palm side of your arm.



Leg: Place the large electrodes over the Quadriceps, Hamstrings, Calf Muscles or Shin Muscles.



Hip: Place the electrodes over the front, side or back of the hip.



Hand and Wrist: Place the small electrode over the back of the hand or palm side.



Ankle: Place the small electrodes over your ankle.



16. Pain Therapy Belt with Electrodes (Fabric type)

Insert the Pain Therapy device onto the Pain Therapy Belt and rotate it to the fixed position.



Spray conductive gel over the fabric electrode pads.



Wrap the belt with the 2 fabric electrodes centered against your lower back.



Sit with your back in a rested and relaxed position. Turn power ON the Pain Therapy Device by holding down the (M) button for 1~2 seconds, then use the remote control to adjust the intensity to your comfort level and enjoy.

17. Arm Band with Electrodes (Fabric type)

Insert the Pain Therapy device onto the Arm Band and rotate it to the fixed position.



Spray plenty of conductive gel onto the entire surface of the 2 Fabric electrode pads.



Wrap the Arm Band around your elbow with the fabric electrode pads over the painful area.



Sit with your arm in a rested and relaxed position. Turn power ON the Pain Therapy Device by holding down the (M) button for 1~2 seconds, then use the remote control to adjust the intensity to your comfort level and enjoy.

18. Triple Action Back Belt with Electrodes (Fabric type)

Insert the Pain Therapy device onto the belt and rotate it to the fixed position.



Spray plenty of conductive gel onto the 2 fabric electrode pads.



Position the back belt with the 2 electrode pads centered on your lower back.



For extra support and comfort, inflate the back belt.



Position your back in a rested and relaxed position. Turn power ON the Pain Therapy Device by holding down the (M) button for 1~2 seconds, then use the remote control to adjust the intensity to your comfort level and enjoy.

19. Leg Rests with Electrodes - I (Fabric type)

Insert the Pain Therapy device onto the Leg Rests and rotate it to the fixed position.



Spray plenty of conductive gel onto the entire surface of the fabric electrodes on the 2 Leg Rests.



Lay down face up on your bed, place your 2 bare legs on the 2 Leg Rests during the treatment.

Note: Bare skin of both legs must contact both electrode pads on the 2 Leg Rests in order to work.



Turn power ON the Pain Therapy Device by holding down the (M) button for 1~2 seconds, then use the remote control to adjust the intensity to your comfort level and enjoy.

20. Leg Rest with Electrodes - II (Fabric type)

Insert the Pain Therapy device onto the Leg Rest and rotate it to the fixed position.

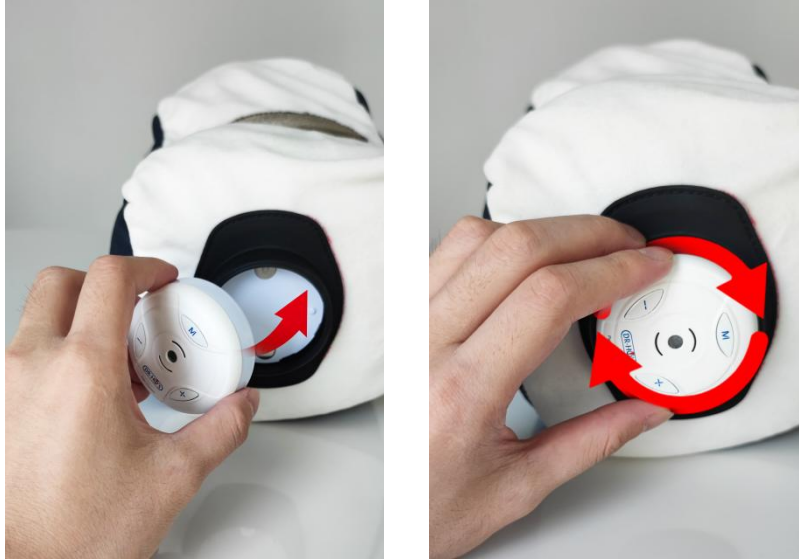

Spray plenty of conductive gel onto the entire surface of the 2 fabric electrodes on the Leg Rest.



Lay down face up on your bed, place your 2 bare legs on the 2 Leg Rests during the treatment.

Note: Bare skin of both legs must contact both electrode pads on the 2 Leg Rest in order to work.



Turn power ON the Pain Therapy Device by holding down the (M) button for 1~2 seconds, then use the remote control to adjust the intensity to your comfort level and enjoy.

21. Knee Band with Electrodes (Fabric type)

Insert the Pain Therapy device onto the Knee Band and rotate it to the fixed position.

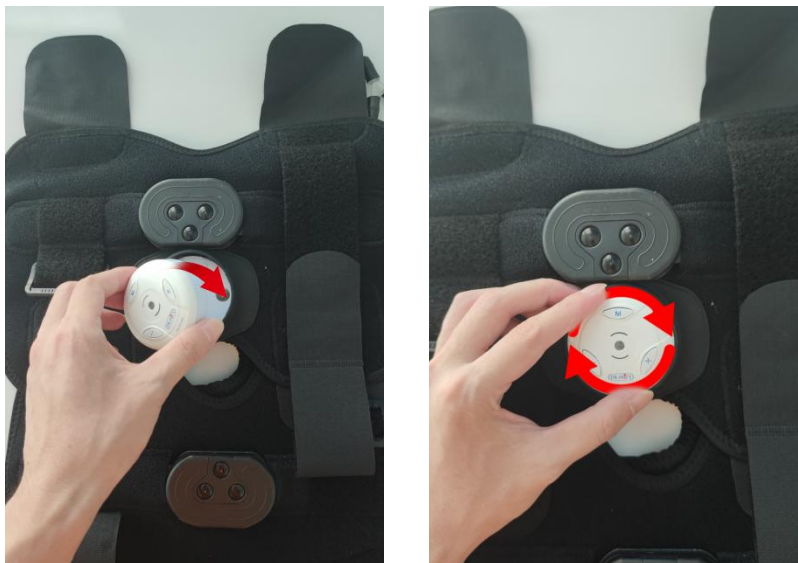

Note: The size of this Knee Band is adjustable. For first time Users, adjust the size of the Knee Band to fit your knee. The fit should be snug and comfortable.

Note: To change the size, unfasten the 2 Velcro tabs holding the Knee Band together, then reposition the two pieces of the Knee Band to desired size, then fasten the 2 Velcro tabs.



Spray plenty of conductive gel onto the entire surface of the 2 Fabric electrode pads.



With your knee and leg straight, position the Knee Band with the electrodes connecting to both sides of your knees, then use the straps to secure the Knee Band around your knee.



For extra comfort and support, inflate the Knee Band.



Position your knee in a rested and relaxed position. Turn power ON the Pain Therapy Device by holding down the (M) button for 1~2 seconds, then use the remote control to adjust the intensity to your comfort level and enjoy.

22. Neck Therapy Pro - I

Remove any metal necklace and lower your shirt collar to bare the skin on the back of your neck and upper shoulders.



Insert the Pain Therapy device onto the Neck Therapy Pro - I and rotate it to the fixed position.

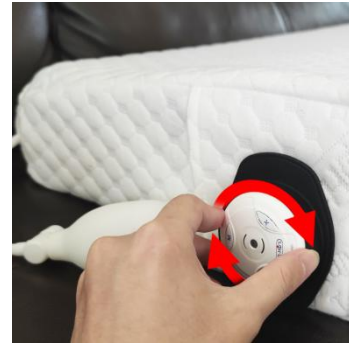

Spray plenty of conductive gel onto the entire surface of the Fabric electrode pads.



Lay face up on the Neck Therapy Pro - I with the electrodes connected to the back of your neck and upper shoulders.

Note: The Fabric electrodes must be contact with your bare skin at the back of your neck to work.



For extra support and comfort, inflate the Neck Therapy Pro - I.



Turn power ON the Pain Therapy Device by holding down the (M) button for 1~2 seconds, then use the remote control to adjust the intensity to your comfort level and enjoy.

23. Neck Therapy Pro - II

Remove any metal necklace and lower your shirt collar to bare the skin on the back of your neck and upper shoulders.



Insert the Pain Therapy device onto the Neck Pain Pro - II and rotate it to the fixed position.

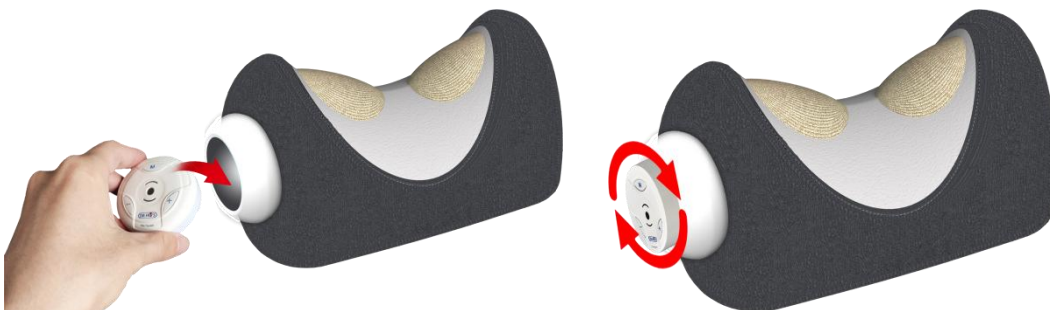

Spray plenty of conductive gel onto the entire surface of the Fabric electrode pads.

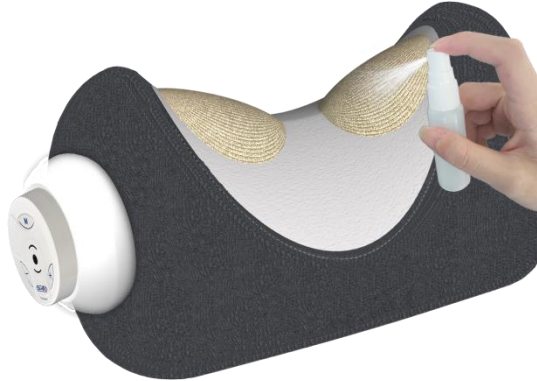

Lay face up on the Neck Therapy Pro - II with the electrodes connected to the back of your neck.

Note: The Fabric electrodes must be contact with your bare skin at the back of your neck to work.



Turn power ON the Pain Therapy Device by holding down the (M) button for 1~2 seconds, then use the remote control to adjust the intensity to your comfort level and enjoy.

24. Neck Therapy Pro - IV

Remove any metal necklace and lower your shirt collar to bare the skin on the back of your neck and upper shoulders.



Insert the Pain Therapy device onto the Neck Pain Pro - II and rotate it to the fixed position.



Spray plenty of conductive gel onto the entire surface of the Fabric electrode pads.

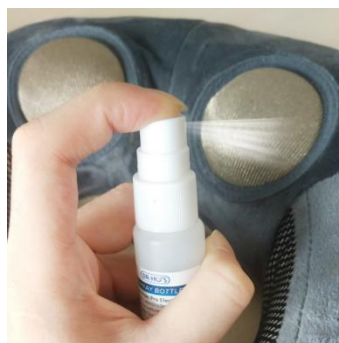

Place the Neck Pain Pro with the electrode pads connected to the skin at the back of your neck. You can do the treatment sitting up or laying down. If laying down, lay face up on the Neck Pain Pro with the electrodes against the bare skin at the back of your neck and upper shoulders. If sitting, position your neck in a rested and relaxed position.



Turn power ON the Pain Therapy Device by holding down the (M) button for 1~2 seconds, then use the remote control to adjust the intensity to your comfort level and enjoy.

25. Perfect Back Relief system with Electrodes

Place the Perfect Back Relief system on your chair.



Insert the Pain Therapy device onto the Perfect Back Relief system and rotate it to the fixed position.



Spray plenty of conductive gel over the entire surface of the 2 Fabric electrodes.



Lift the back of your shirt to expose the bare skin of your lower back.

Note: The Fabric electrodes must be connected to the bare skin of your lower back to work.



Sit with the skin of your lower back resting firmly against the 2 electrodes on the Perfect Back Rest.



Turn power ON the Pain Therapy Device by holding down the (M) button for 1~2 seconds, then use the remote control to adjust the intensity to your comfort level and enjoy.

26. Pain Therapy Shirt

Spray plenty of conductive gel onto the entire surface of the Fabric electrode pads in the shirt.



Put on the Pain Relief Shirt on your upper body with the fabric electrodes positioned against the bare skin of your lower back and the back of your upper shoulders. All 4 electrodes on the shirt are purposely positioned to provide treatment to the back of your upper shoulders and for your lower back only. Do not put the shirt on backwards with the electrodes against your abdomen or you will feel stimulation at your abdomen and not on your lower back.

For treatment of the lower back, use the 2 Velcro straps on the waist area of the shirt to pull the electrode pads firmly against the bare skin on your lower back.



For treatment of your upper shoulders, use the 2 Velcro straps on the upper shoulder areas of the shirt to pull the 2 fabric electrodes firmly against the bare skin of your upper shoulders.



Insert the Pain Therapy device onto the harness on the shirt and rotate it to the fixed position. There are 2 fixed positions in the harness for the device, one for treating your upper shoulders, the second one for treating your lower back.



Turn power ON the Pain Therapy Device by holding down the (M) button for 1~2 seconds, then use the remote control to adjust the intensity to your comfort level and enjoy.

3.5 Operation details

1. Insert the Pain Therapy Device and rotate it to fixed position on the electrode.
2. Power ON: Hold the (M) button on the device for 1~2 seconds to power ON, see green indicator light ON.
3. Select the mode: The device has 3 modes of therapy, 1, 2 and 3. Press the (M) button on the device or on the remote control once will change it to mode 2. Press the (M) button again to change to mode 3.
4. Adjust the intensity: Increase/Decrease the intensity of the stimulation by pressing the (+) or (-) button on the device or on the remote control.
5. Power off: Hold the (M) button on the device for 1~2 seconds to power OFF, see green indicator light OFF.
6. Note: If the green indicator light begins to flash and beep, check if the device is inserted properly in the device harness and check if the electrodes are firmly connected to bare skin.
7. Automatic Time Out: The default time of the Pain Therapy Device is 20 minutes. After 20 minutes, the Pain Therapy Device will go into a Standby mode with yellow indicator light On. After one minute of inactivity by the User, the device will turn OFF automatically.
8. Low battery and charging: A pink indicator light will flash when the battery is low. When charging, a white indicator light will be on, when fully charged, the white indicator light will turn off.

The use of the remote control:

1. The remote control can be used to adjust the intensity of the stimulation and to select the mode of therapy 1, 2 or 3 only when the Pain Therapy device is power ON.
2. Press the (M) button on the device or the remote control to select the mode of therapy. Press the (+) or (-) button on the device or on the remote control to adjust the intensity of stimulation.
3. You cannot power ON or power OFF the Pain Therapy Device with the remote control. To power OFF, hold down the (M) button on the Pain Therapy Device for 1~2 seconds.

Note:

Before repositioning electrode pads, turn the device Off first before disconnecting the electrode pads from your skin. Once you replaced the electrodes back onto your skin, you can turn the device back On.

If you want to stop the treatment before the Time of treatment is completed, turn the device Off first then remove the electrode pads from your skin.

Remove the electrodes from your skin by pulling on the electrode pad. Do not pull on the wire as this will cause damage to the wire connection to the electrode pad.

3.6 Electrode Pads Guideline

1. Only use the electrode pads supplied by the manufacturer; other electrode pads may pose a risk of unsuitable electrical characteristics with your Pain Therapy Device.
2. Do not use the electrode pads on different individuals, otherwise, skin reaction or cross infection may occur.
3. Always turn power off before removing or repositioning the electrodes.
4. Make sure the skin has been washed thoroughly before applying the electrodes. Do not clean the skin with alcohol.
5. For better conduction, moisten your skin with the conductive gel before putting the pads on.
6. Apply the whole surface of the electrode pads firmly to the skin. Do not use patch electrode pads that do not stick properly to the skin or only partially stick to the skin.
7. In case of skin redness under the electrode pads after stimulation, do not stimulate in the same place until the skin turn to normal condition
8. Replace sticky patch electrodes with new ones after using them for 30 times, or earlier if they fail to stick properly. Replacement sticky patch electrodes are available at your place of purchase.

4. CLEANING AND MAINTENANCE

For Pain Therapy Device

Dirt and grime on the device should be wiped with a damp cloth. Use water only, do not use thinner or alcohol because they can cause damage to the device.

For Fabric Electrodes

All fabric electrodes can be cleaned by hand wash with water and light soap. Hang dry or lay out to dry. Do not use dryer or iron to dry as this can damage the wiring and connections inside.

For Patch Electrode Pads

Note: Clean your skin to rid of any dirt, loose skin, oil or cream before placing the Patch Sticky Electrode pads on your skin.

The Patch Electrode sticky pads cannot be cleaned but should be replaced after around 30 uses.

Note: Always place the clear plastic protective film over the Patch Sticky Electrodes pads when not in use. Do not place them on any other surfaces as they will get dirty.

Storage

Please keep the Pain Therapy device and electrodes from the reach of infants, children or pets, inhalation or swallowing of small parts is dangerous or may even be fatal.

Notes For Patch Electrode Sticky Pads

1. Never stick two sticky electrode pads to each other.
2. Keep the sticky electrode pads covered with the protective film. Do not put them under high temperature and direct sunshine.
3. Keep the sticky electrode pads in an environment that is between: 5~40°C, ≤95%RH, when the sticky electrode pad is out of its individual package.
4. When sticky electrode pads are not sticking well to your skin, or if you start to feel uncomfortable pins and needle sensations, that means the sticky electrode pads are worn out and need to be replaced.
5. Replace the Patch Sticky Electrode Pads after around 30 uses.

Method for disposing the electronic devices and accessories

Do not mix the electronic devices and accessories with the household rubbish, these be disposed in accordance with local regulations (Example: put the rubbish into electronics recycling station)

5. STORAGE

Please keep the device from the reach of infants, children or pets, inhalation or swallowing of small parts is dangerous or may even be fatal.

6. TROUBLE SHOOTING

Problem	Have you checked	Solutions
I don't feel anything.	Is the Pain Therapy Device sitting in the right position inside the harness?	Insert the device into the harness so the 2 pairs of metal connectors are connected.
	Are both electrodes firmly touching your skin.	2 electrode pads must be touching your skin in order to feel the stimulation.
	Is the Pain Therapy Device battery depleted?	Recharge the Pain Therapy device with the adapter included before use.
The sensation is weak even with intensity turned up.	Fabric electrodes must be moist with conductive gel to work.	Spray plenty of conductive gel onto the fabric electrodes. Moisten your skin with some conductive gel also helps.
	Sticky patch electrodes must be moist and sticky to work. If dirty or used more than 30 times, they should be replaced.	Replace sticky patch electrode pads if they are dirty, non-sticky or if used more than 30 times.
	Does the Pain Therapy Device need to be recharged?	Use the adapter provided, recharge the Pain Therapy Device before use.
The stimulation feels uncomfortable with pins and needles sensations.	Are there any scratches, cuts, blemishes, pimples, blisters, swelling or other issues with your skin?	Wait until your skin is fully healed before resuming treatment. Do not treat an area with open skin or have other skin issues.

	Did you shaved the skin recently which can cause micro cuts on your skin?	Do not shave the skin a few days before treatment.
The stimulation feels weak and uncomfortable with pins & needles sensations.	Are the electrodes wet with conductive gel, or are they too dry?	Spray plenty of conductive gel onto the fabric electrodes.
	Are the patch electrodes dirty, dry or used more than 30 times?	Replace dirty, old patch electrodes that are used more than 30 times.
I cannot turn the power ON or OFF the Pain Therapy Device.	The Pain Therapy Device will not turn ON when recharging?	When the device is fully charged, unplug it from the recharging adapter first before use.
	To Power ON. Press and hold the (M) button on the Pain Therapy Device for 2 seconds. Note: The power cannot be turned ON using the remoter control.	Press and hold down the (M) button on the Pain Therapy Device for 2 seconds to turn it ON. Note: The power cannot be turned ON using the remoter control.
	To Power OFF. Press and hold the (M) button for 2 seconds on the Pain Therapy Device or on the Remote Control.	Press and hold the (M) button for 2 seconds on the Remote Control or on the Pain Therapy Device to power OFF.
Indicator lights on the Pain Therapy Device.	1 or 2 Solid Green Lights On	Device is ON. Intensity level at zero. Mode One: 1 green light on. Mode Two: 2 green lights on. Mode Three: 1 green light on.
	1 Flashing Yellow Light	Intensity level from level 1 to 29. Flashing in sync with stimulation.
	2 Flashing Yellow Lights.	Intensity level 30, the maximum. Flashing in sync with stimulation.
	Flashing Green & Beeping Noise.	Bad connection between the metal connectors in harness. Adjust the position to ensure good connection.

		One or two electrodes are not firmly connected to your skin. Be sure both electrodes are firmly touching your skin.
	Solid White light On.	Device is connected to recharging adapter. Cannot be used for treatment while recharging.
	Blue Light On.	When using the Remote Control, the Blue Light on the Pain Therapy device to come On, indicating the connection is working.
The treatment has stopped before 30 minutes.	<p>Pain Therapy Device needs to be recharged.</p> <p>Normally, the device will turn OFF automatically after around 30 minutes of treatment.</p>	<p>Use the adapter provided and recharge the Pain Therapy device before use.</p> <p>Device will not work while being recharging.</p>
The skin under where I place the electrode has turned red and/or itches or prickles	<p>It is normal for the skin to turn slightly red after treatment due to increase circulation in the area.</p> <p>If you are prone to skin allergies or have severe redness, swelling and discomfort after treatment, check with your doctor for skin allergies to conductive gel or electrodes.</p>	<p>Do not put electrodes on skin with any cuts or openings. Try placing the electrodes on a different area. If problem continues, stop treatment for a few days before resuming treatment. Find out if you have a skin allergy issue before continuation of treatment.</p>
Remote Control don't work.	Battery is depleted.	Replace the battery in the Remote Control.
	New Remote has not being set up to work with the Pain Therapy Device.	Hold down the (M) button on the Remote Control, then hold down the (M) button on the Pain Therapy device to connect the two. Press any button on the Remote and you should see the blue light ON on the Pain Therapy device.

7. DISPOSAL

1. Device and accessories beyond the shelf life should be disposed of according to local regulations.
2. To dispose of packing materials, take appropriate actions in accordance with the rules and regulations in force in your area to prevent adverse ecological effects.
3. The patch sticky electrode pads can be reused for about 30 times. Please replace the patch electrodes if they have been opened for more than 3 months, if they are dirty, or if they are not sticky, or if they are uncomfortable during treatment with pins and needle sensations.

8. WARRANTY CARD

1. We hereby guarantee this consumer purchased product, if it is used normally according to all instructions in the User's manual in a non-commercial setting, in case of failure, the main electronic unit and electrode cords are warranted for 1 year, and the electrode pads are warranted for 30 days.

Any question, please contact us or your local distributor:

Guangzhou Xinbo Electronic Co., Ltd.

Address: 23 Building, Phase-II Huachuang Industry Park, Panyu Guangzhou Guangdong, CN 511450

E-mail: drtvsammy@hotmail.com



2. For exchange, please mail the failed unit along with copy of receipt as proof of purchase to us or to the local dealer where you purchased the product. Pack the product carefully to prevent damage in transit. Because of possible loss in transit, we recommend you insuring the product with tracking number and return receipt.







Warranty List

Device Name:	Model:
Purchase date:	User's address:
Name:	Telephone:
Dealer:	Address:
Telephone:	
description of the specific problem:	
Stamp:	

9. LABEL SYMBOLS

Label symbols are shown in the following table:

1		Conformity indication with the essential health and safety requirements set out in European Directives. 1639 - Notified body identification (SGS).
2		DATE OF MANUFACTURE. This symbol shall be accompanied by a date to indicate the date of manufacture.
3		Symbol for "MANUFACTURER". This symbol shall be accompanied by the name and the address of the manufacturer.

4		Symbol for "AUTHORISED REPRESENTATIVE IN THE EUROPEAN COMMUNITY". This symbol shall be accompanied by the name and the address of the authorized representative in the European Community, adjacent to the symbol.
5		Collect separately from other household waste
6		Type BF Applied Part
7	IP22	IP classification
8		Symbol for "ATTENTION" Caution! Follow operating instructions! Failure to do so could place the patient or operator at risk.
9		Refer to user manual
10		Batch code
11		Authorized Representative in the European Community

10. ELECTROMAGNETIC COMPATIBILITY

The Pain Therapy Device has been tested and found to comply with the electromagnetic compatibility (EMC) limits for medical devices. These limits are designed to provide reasonable protection against harmful interference in a typical medical installation.

CAUTION: Do not use this device simultaneously with devices having high EMI levels.

Manufacturer's declaration – electromagnetic emissions

The Pain Therapy Device is intended for use in the electromagnetic environments specified below. The customer or the user of the Pain Therapy Device should assume that it is used in such an environment.		
Emissions test	Compliance	Electromagnetic environment - guidance
RF emissions CISPR 11	Group 1	The Pain Therapy Device use RF energy only for its internal function. Therefore, its RF emissions are very low and are not likely to cause any interference in nearby electronic equipment.
RF emissions CISPR 11	Class B	The Pain Therapy Device is suitable for use in all establishments, including domestic establishments and those directly connected to the public low-voltage power supply network that supplies buildings used for domestic purposes.
Harmonic emissions IEC 61000-3-2	Class A	
Voltage function / flicker emissions IEC 61000-3-2	Complies	

Manufacturer's declaration – electromagnetic immunity

The Pain Therapy Device is intended for use in the electromagnetic environment specified below. The customer or the user of the Pain Therapy Device should assure that it is used in such an environment.			
Immunity test	IEC 60601 test level	Compliance level	Electromagnetic environment - guidance

Electrostatic discharge (ESD) IEC 61000-4-2	$\pm 6\text{kV}$ contact $\pm 15\text{kV}$ air	$\pm 6\text{kV}$ contact $\pm 15\text{kV}$ air	Floors should be wood, concrete or ceramic tile. If floors are covered with synthetic material, the relative humidity should be at least 30%.
Electrostatic transient / burst IEC 61000-4-4	$\pm 2\text{kV}$ for power supply lines $\pm 1\text{kV}$ for input/output lines	$\pm 2\text{kV}$ for power supply lines $\pm 1\text{kV}$ for input/output lines	Mains power quality should be that of a typical commercial or hospital environment.
Surge IEC 61000-4-5	$\pm 1\text{kV}$ differential mode $\pm 2\text{kV}$ common mode	$\pm 1\text{kV}$ differential mode $\pm 2\text{kV}$ common mode	Mains power quality should be that of a typical commercial or hospital environment.
Voltage dips, short interruptions and voltage variations on power supply input lines IEC 61000-4-11	$< 5\% U_T (> 95\% \text{ dip in } U_T) \text{ for } 5 \text{ sec}$	$< 5\% U_T (> 95\% \text{ dip in } U_T) \text{ for } 5 \text{ sec}$	Mains power quality should be that of a typical commercial or hospital environment. If the user of the Pain Therapy Device requires continued operation during power mains interruptions, it is recommended that the Pain Therapy Device be powered from an uninterruptible power supply or a battery.

Power frequency (50/60 Hz) magnetic field IEC 61000-4-8	3 A/m	3 A/m	Power frequency magnetic fields should be at levels characteristic of a typical location in a typical commercial or hospital environment.
--	-------	-------	--

NOTE: U_T is the a.c. mains voltage prior to application of the test level.

Manufacturer's declaration – electromagnetic

The Pain Therapy Device is intended for use in the electromagnetic environment specified below. The customer or the user of the Pain Therapy Device should assure that it is used in such an environment.

Immunity test	IEC 60601 test level	Compliance level	Electromagnetic environment - guidance
Conducted RF IEC 61000-4-6	3 Vrms 150kHz to 80MHz	3V	Portable and mobile RF communications equipment should be used no closer to any part of the Pain Therapy Device, including cables, than the recommended separation distance calculated from the equation application to the frequency of the transmitter.
Radiated RF IEC 61000-4-3	3V/m 80MHz to 2.5GHz	3V/m	Recommended separation distance $d = \left[\frac{3.5}{V_1} \right] \sqrt{P}$ $d = \left[\frac{3.5}{E_1} \right] \sqrt{P} \quad 80 \text{ MHz to } 800 \text{ MHz}$ $d = \left[\frac{7}{E_1} \right] \sqrt{P} \quad 800 \text{ MHz to } 2.5 \text{ GHz}$

		<p>Where p is the maximum output power rating of the transmitter in watts(W) according to the transmitter manufacturer and d is the recommended separation distance in metres(m).^b</p> <p>Field strengths from fixed RF transmitters, as determined by an electromagnetic site survey,^a should be less than the compliance level in each frequency range.^b</p> <p>Interference may occur in the vicinity of equipment marked with the following symbol:</p> 
<p>NOTE 1: At 80 MHz and 800 MHz, the higher frequency range applies.</p> <p>NOTE 2: These guidelines may not apply in all situations. Electromagnetic is affected by absorption and reflection from structures, objects and people.</p>		
<p>^a Field strengths from transmitters, such as base stations for radio (cellular/cordless) telephones and land mobile radios, amateur radio, AM and FM radio broadcast and TV broadcast cannot be predicted theoretically with accuracy. To assess the electromagnetic environment due to fixed RF transmitters, an electromagnetic site survey should be considered. If the measured field strength in the location in which the Pain Therapy Device is used exceeds the applicable RF compliance level above. The Pain Therapy Device should be observed to verify normal operation. If abnormal performance is observed, additional measures may be necessary, such as reorienting or relocating the Pain Therapy Device.</p> <p>^b Over the frequency range 150kHz to 80 MHz, field strengths should be less than 3V/m.</p>		

Recommended separation distances between portable and mobile RF communications equipment and the EQUIPMENT or SYSTEM – For EQUIPMENT and SYSTMES that are not LIFE – SUPPORTING

Recommended separation distances between portable and mobile RF communications equipment and the Pain Therapy Device

The Pain Therapy Device is intended for use in an electromagnetic environment in which radiated RF disturbances are controlled. The customer or the user of the Pain Therapy Device can help prevent electromagnetic interference by maintaining a minimum distance between portable and mobile RF communications equipment (transmitters) and the Pain Therapy Device as recommended below, according to the maximum output power of the communications equipment.

Rated maximum output of transmitter W	Separation distance according to frequency of transmitter m		
	150 kHz to 80 MHz $d = [\frac{3.5}{V_1}] \sqrt{P}$	80 MHz to 800 MHz $d = [\frac{3.5}{E_1}] \sqrt{P}$	800 MHz to 2.5 GHz $d = [\frac{7}{E_1}] \sqrt{P}$
0.01	0.12	0.12	0.23
0.1	0.38	0.38	0.73
1	1.2	1.2	2.3
10	3.8	3.8	7.3
100	12	12	23

For transmitters rated at a maximum output power not listed above the recommended separation distance d in meters (m) can be estimated using the equation applicable to the frequency of the transmitter, where P is the maximum output power rating of the transmitter in watts (W) according to the transmitter manufacturer.

NOTE 1: At 80 MHz and 800 MHz, the separation distance for the higher frequency range applies.

NOTE 2: These guidelines may not apply in all situations. Electromagnetic propagation is affected by absorption and reflection from structures, objects and people.

Guangzhou Xinbo Electronic Co., Ltd.

Address: 23 Building, Phase-II Huachuang Industry Park,
Panyu Guangzhou Guangdong, CN 511450

Tel: +86-020-66393598

Fax: +86-020-34822409

E-mail: drtvsammy@hotmail.com

FCC Statement

This equipment has been tested and found to comply with the limits for a Class B digital device, pursuant to part 15 of the FCC Rules. These limits are designed to provide reasonable protection against harmful interference in a residential installation. This equipment generates, uses and can radiate radio frequency energy and, if not installed and used in accordance with the instructions, may cause harmful interference to radio communications. However, there is no guarantee that interference will not occur in a particular installation. If this equipment does cause harmful interference to radio or television reception, which can be determined by turning the equipment off and on, the user is encouraged to try to correct the interference by one or more of the following measures:

- Reorient or relocate the receiving antenna.
- Increase the separation between the equipment and receiver.
- Connect the equipment into an outlet on a circuit different from that to which the receiver is connected.
- Consult the dealer or an experienced radio/TV technician for help.

Caution: Any changes or modifications to this device not explicitly approved by manufacturer could void your authority to operate this equipment.

This device complies with part 15 of the FCC Rules. Operation is subject to the following two conditions: (1) This device may not cause harmful interference, and (2) this device must accept any interference received, including interference that may cause undesired operation.

RF Exposure Information

This equipment complies with FCC radiation exposure limits set forth for an uncontrolled environment. This equipment should be installed and operated with minimum distance 0cm between the radiator and your body.