

Supplier : Shenzhen Kingunion Lighting Co.,Ltd



Product Acknowledgment

Product name: 5050RGB hard light strip

Product No.: KU-5050RGB-60D-LC029E 185

Customer Material No.: //

Supplier material No.: YZDT-2A1014-BB6X26

Version: A0

Effective date: 2022/07/06 Product manager:

Manufacturer		Customer Confirmation	
Draw up	Tang bowen	<input type="checkbox"/> Qualified <input type="checkbox"/> Unqualified	
reviewer	Bai huiben	reviewer	
Approval	Jiang chunhui	Approval	

(Both parties must sign and seal the acceptance letter after confirming that it is qualified)

Supplier address: Second Floor, No.1 Kaixinda Technology Park, No 49th Zhoushi Road,Langxin Community, Shiyan Town, Baoan District, Shenzhen City,Guangdong, China

Tel: 0755-29986056

Fax: 0755-29975455

Change Record

[illegible]

Catalogue

1	Description of basic product parameters	<u>01</u>
2	Product circuit diagram	<u>02</u>
3	Material parameter/performance table	<u>03</u>
4	Product packaging	<u>04</u>
5	RF Controller	<u>05</u>

一、Description of basic product parameters

<div>Picture</div> <div></div> <div>Pictures are for reference only</div>	Product name		5050RGB hard light strip		
	Product No.		KU-5050RGB-60D-LC029E 185		
	Item No.		YZDT-2A1014-BB6X26		
	Description		12V 5050RGB 60led/m,111led/pcs,8.5W/M,0.5m double sided whiteboard 10MM,1.85m/pcs,a white 4PIN master terminal wire 23cm long at one end,LC-029E aluminium profile,surface drop filled with silicone gel, xanthan gum with 8 screws and 4 buckles		
	Voltage rating		DC12V		
	Nominal power per bar		15.5W±10% (@RGB all on)		
	Actual power per bar		13.19W±10% (@RGB All on with power controller)		
	Ambient temperature		-20℃~45℃		
	Each initial luminous flux		≥300LM (@RGB All on with power controller)		
	Initial photoactivity		≥24LM/W (@RGB All on with power controller)		
Size	L1870*W13.7*H7mm±5mm		Spatial color inconsistency		/
Trichrome	wavelength nm		Colour temperature	Chromogenic index	Remarks
	min.	max.			
R	618	625	/	/	/
G	520	530	/	/	/
B	460	470	/	/	/
Beam angle	120°±10°		Central light intensity		/
Nominal lifetime	/		Net weight	5700g±10%	Gross weight 6200g±10%
Packing quantity	Set/box		Carton size	/	
Certification	CCC/CQC <input type="checkbox"/> energy conservation <input type="checkbox"/> explosion-proof <input type="checkbox"/> fire control <input checked="" type="checkbox"/> other				
Executive standard	■GB7000.1-2015 ■GB7000.9				

二、Product circuit diagrams

Schematic diagram of product dimensions, unit mm, for reference!

1.FPCB:503*10mm

Shape via

外形过孔

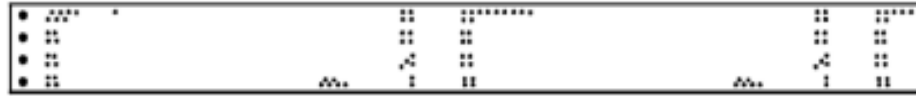

Positive words

正面文字

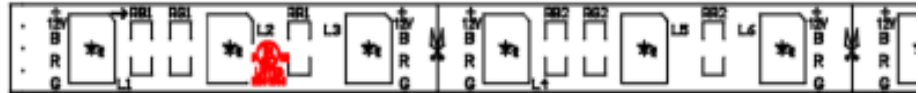

Reverse side welding plate

反面焊盘



Reverse side line

反面线路



Positive line

正面线路



2. Schematic diagram of light source arrangement

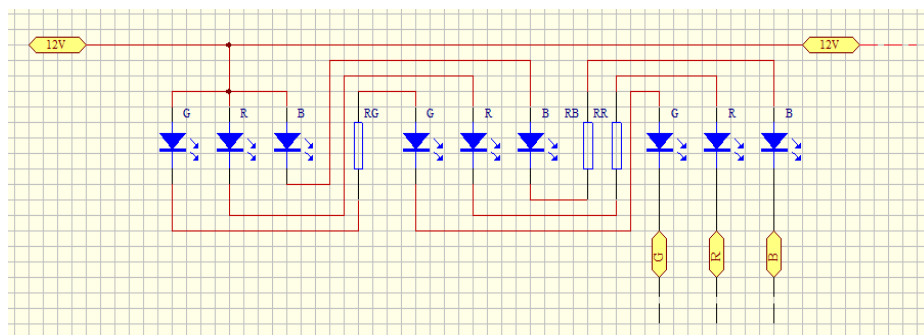

三、Material parameter/performance table

1. Lamp bead parameter list

	Item	Symbol	minimum	typical	maximum	unit
		IF(RGB)	/	3*20	3*30	mA
	direct voltage	VF(R)	1.8	2.0	2.2	V
		VF(G)	2.8	3.0	3.2	V
		VF(B)	2.8	3.0	3.2	V
	wave length	WD(R)	620	/	625	nm
		WD(G)	510	/	515	nm
		WD(B)	460	/	470	nm
	luminance	IV(R)	0.8	/	1.2	Lm
		IV(G)	3.5	/	4.5	Lm
		IV(B)	0.7	/	1.2	Lm
	Beam angle	Deg	/	120	/	°

remarks:

① Test conditions: 60mA, 85 degrees junction temperature, 20ms pulse test

2. Light source panel parts list

No.	Component Name	specification	parameters	quantity
1	LED-RGB	SMD5050-RGB	Patch bead 5050RGB with notch positive / blue, bright, wavelength NM (R:618-625,G:520-530,B:460-470),LV(R:0.8-1.5,G:3.5-5.5,B:0.7-1.3), VF(R:1.8-2.2V G:2.8-3.2V B:2.8-3.2V)。Copper support,(anti-breaking support, anti-vulcanization, can be used for dropping silica gel and silica gel extrusion)	111pcs/条
2	FPC board	Circuit board, flexible 503*10mm	12V 5050 RGB 60 led/ M 10m wide double sided white board 2 oz L = 503mm 3L3R 1206 seal +BRG Model:KU-5050RGB-60D-12V	3.7pcs/条
3	SMD resistor	1206-G/B	chip resistor 270 Ω precision $\pm 5\%$ pack 1206	74pcs/条
4	SMD resistor	1206-R	chip resistor 510 Ω accuracy $\pm 5\%$, encapsulating 1206	37pcs/条

3.other parts list

No.	Component Name	specification	parameters	quantity
1	Aluminum profile	LC-029E Aluminum profile	L1460*W13.7*H7mm ± 5 mm	111pcs/条
2	Plug	LC-029E Plug	Plug, matching with profile LC-029E	2pcs/条
3	Screw	buckle screw	304 stainless steel screws, M3*10	8pcs/条
4	Dorsal gum	Xanthan gum	Double sided thermal conductive glue paper, yellow,10mm(9.7-9.9mm)wide/55M/roll	1.85米/条
5	4PINcommon terminal line	4PIN Female terminal	+BRG/24#/4P/Line sequence "" black blue red green "" / outer cortex white circle line, maternal band line 230 mm long, caudal peeling tin 3MM	1pcs/条
6	Buckle	LC-029E Buckle	Buckle, matching with profile LC-029E	3pcs/条

7	PE bag	Flat mouth PE bag	Flat port PE bag, size: L*W=1910*40*0.05mm (lamp strip)	1pcs/条
8	PE bag	Self sealing PE bag	Self sealing PE bag,,Size: L*W=120*100*0.05MM, 100MM is the opening (screw mounting)	1pcs/条

四、product packaging

1. PE bag packaging : 1910*40*0.05mm



2. Stretch film winding: 10 pieces per bundle



3. Outer packing: 30 pieces per carton 1900*120*100mm



3.1 APP Download

I Scan the QR code



iOS and Android systems can download the "LotusLantern" APP by scanning the QR code. Open the browser or other tools with "Scan QR code" function, scan the "LotusLantern" QR code as below:

3.2 App Operation

(1) Click on the LotusLantern APP icon, enter the APP page:

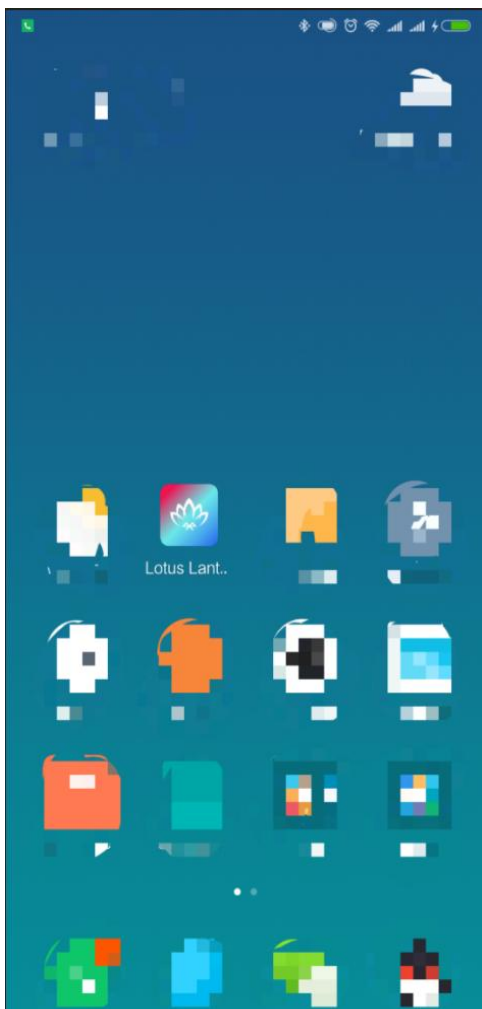

(2) After entering the APP interface, if Bluetooth is not enabled,
"an application wants to enable the Bluetooth function of this device." Click [Allow]

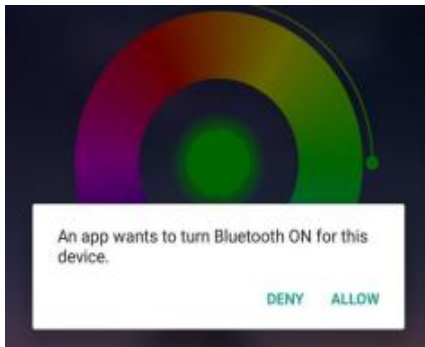

(3) switch to color and brightness interface:

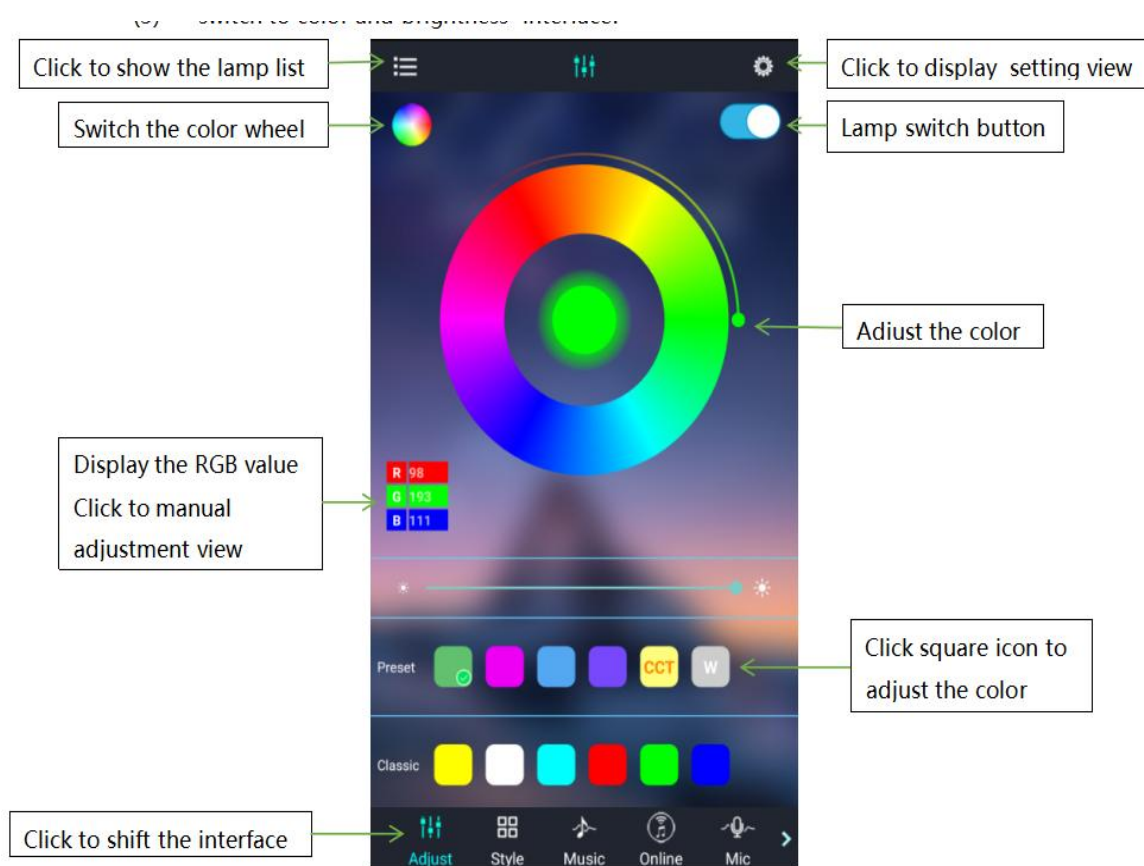

:

FCC WARNING

This device complies with part 15 of the FCC Rules. Operation is subject to the following two conditions: (1) this device may not cause harmful interference, and (2) this device must accept any interference received, including interference that may cause undesired operation.

Any changes or modifications not expressly approved by the party responsible for compliance could void the user's authority to operate the equipment.

NOTE: This equipment has been tested and found to comply with the limits for a Class B digital device, pursuant to Part 15 of the FCC Rules. These limits are designed to provide reasonable protection against harmful interference in a residential installation. This equipment generates, uses and can radiate radio frequency energy and, if not installed and used in accordance with the instructions, may cause harmful interference to radio communications.

However, there is no guarantee that interference will not occur in a particular installation.

If this equipment does cause harmful interference to radio or television reception, which can be determined by turning the equipment off and on, the user is encouraged to try to correct the interference by one or more of the following measures:

- Reorient or relocate the receiving antenna.
- Increase the separation between the equipment and receiver.
- Connect the equipment into an outlet on a circuit different from that to which the receiver is connected.
- Consult the dealer or an experienced radio/TV technician for help.

To maintain compliance with FCC's RF Exposure guidelines, This equipment should be installed and operated with minimum 20cm distance between the radiator and your body: Use only the supplied antenna.