

260.00 mm

6. Connect the power adapter. The smart valve controller can be controlled (Open/Close) by pressing the red button.
7. If power is cut off, then ring under the smart valve controller can be manually pulled down and swing the transfer handle to close or open the valve.

How to Integrate with the App

1. Download "Tuya Smart" or "Smart Life" APP (scan the QR code or download the APP from Google Play/iOS), create new Account ID and password to login (if not already registered)



Tuya Smart



Smart Life

4. Then tighten the screw at both ends of the mounting bracket. After the installation of the smart valve controller, manually pull down the clutch pull ring. Swing the smart valve controller transfer handle, please check if the valve switch is in place.
5. Tighten the screw of the smart valve controller handle clip according to the diagram.

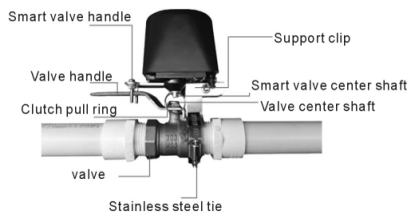

A

B

Product specifications

Power supply voltage	12V/1A
Communication technology	WIFI 2.4g
Valve pressure	1.6 mpa
Valve specifications	4, 6, 1 inch, 1.25 inch
Close valve time	5-10 seconds
Open valve time	5-10 seconds
Torque	30-60 kgf.cm
Application System	IOS/android

How to Install

1. Install the bracket on the installation ear of the smart valve controller (screw is not tightened first).
2. Fix the mounting bracket on the water pipe or gas pipe (as shown in the figure).
3. Adjust the position of the smart valve controller, please make sure smart valve handle fits securely over the valve handle. Ensure that the center line of the smart valve controller and the center line of the valve are in the same line, otherwise the valve cannot be fully opened and closed.

Smart Valve Controller Manual



Thanks for choosing our Smart Valve Controller, please read this manual carefully before using it

65.00 mm

105.00 mm

2. Add device: Click "+", select "Other" from the bottom tab and then select "Others (Wi-Fi)".

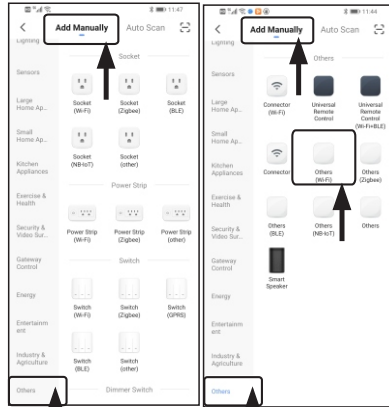

3. Press the power button of smart valve for about 5 seconds until the indicator light flashes quickly, smart valve controller enters into pairing state.

4. Select you Wifi SSID, Input WIFI password and proceed to next screen. (NOTE: The device supports

only 2.4G Wi-Fi)

5. Connection running, wait about 30-60 seconds until the device connects successfully, Perfect!!

6. You can select "Auto Scan" Mode, According to the prompt, the smart valve controller will be connected to the network automatically

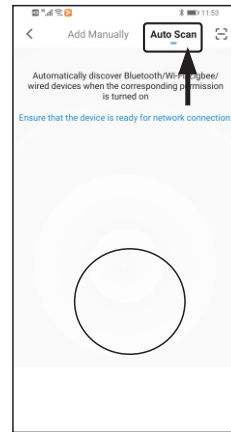

How to link with other smart devices

1. Please open "Tuya Smart" or "Smart Life" APP and the click "Smart" tab located on the mid-bottom of APP screen.

2. Click "+" (top right of screen) to create a link with other smart devices.

3. Select "When device status change" and then select a device which you want Smart Valve to connect with. i.e. Smart Water/flood sensor.

4. Select the status of the device (On/Off).

5. Then Select "Run the device" and select smart valve controller.

6. Click "Next" and finally "Save". Perfect!! You created a smart connection between Water leak sensor and water valve.

7. Whenever water leakage is detected, with this smart linkage water valve will close automatically.

8. Similar linkages can be created with other smart devices.

FAQ

Q1. The valve controller switch is not in place.

Ans. Please check whether the smart valve controller center and the valve center are aligned. If they are

not aligned, then not only it will make the valve switch not work properly but also burn the smart valve controller's motor.

Q2. The valve switch is stuck.

Ans: Please pull down the clutch pull ring and swing the smart valve controller's handle 90 degrees until the valve can be switched smoothly. If the valve is too tight, please apply some grease to it or replace it.

Q3. The smart valve controller cannot be paired into the network.

Ans: Please make sure you're using 2.4Ghz WiFi, Signals are present and strong, and password is correct. While smart valves controller is in pairing mode, please keep it as close to the router as possible. (for best possible results). Please follow instructions as given above.

4. For other troubleshooting problems, please read the Smart Life or Tuya APP's help center in detail.

Packing list

1. Smart Valve Controller
2. Instructions
3. Adapter 12V/1A
4. Pipe clips (clamp)

:

FCC WARNING

This device complies with part 15 of the FCC Rules. Operation is subject to the following two conditions: (1) this device may not cause harmful interference, and (2) this device must accept any interference received, including interference that may cause undesired operation.

Any changes or modifications not expressly approved by the party responsible for compliance could void the user's authority to operate the equipment.

NOTE: This equipment has been tested and found to comply with the limits for a Class B digital device, pursuant to Part 15 of the FCC Rules. These limits are designed to provide reasonable protection against harmful interference in a residential installation. This equipment generates, uses and can radiate radio frequency energy and, if not installed and used in accordance with the instructions, may cause harmful interference to radio communications.

However, there is no guarantee that interference will not occur in a particular installation.

If this equipment does cause harmful interference to radio or television reception, which can be determined by turning the equipment off and on, the user is encouraged to try to correct the interference by one or more of the following measures:

- Reorient or relocate the receiving antenna.
- Increase the separation between the equipment and receiver.
- Connect the equipment into an outlet on a circuit different from that to which the receiver is connected.
- Consult the dealer or an experienced radio/TV technician for help.

To maintain compliance with FCC's RF Exposure guidelines, This equipment should be installed and operated with minimum 20cm distance between the radiator and your body: Use only the supplied antenna.