



HAIZHIMEI

智能可视水牙线使用说明

**Operation Instructions of Intelligent
Visual Dental Water Jet**

注意事项

Notes

使用本产品之前, 请仔细阅读本说明使用书, 并妥善保管以备日后参考。

Read all instructions before using this product, and keep it for future reference.

危险

Dangers

-充电器应远离水。切勿将它放置或存放在任何有水的容器（例如浴盆、脸盆等）的上方或附近。切勿将充电器浸入水或任何其他液体中。在清洁之后连接电源之前, 请确保充电器完全干燥。

-Keep the charger away from water. Do not place or store it on or near any container with water (such as a bathtub, washbasin, etc.). Do not immerse the charger in water or other liquid. Make sure the charger is completely dry before connecting to the power supply after cleaning.

警告

Warning

-只能使用本产品随附的感应充电器为电池充电, 充电座输入电压为DC3.7-5.0V。

-Only use the attached inductive charger to charge the battery of the product, and input voltage of the charging base is DC3.7-5.0V.

*可使用手机充电器连接本产品提供的充电连接线为产品充电。

*Mobile phone charger can be connected to the charging cable to provide

charging for the product.

-如果产品受到任何损坏（水牙线喷嘴、手柄和/或充电器），请勿再使用。

-If any damage happens to the product (jet nozzle, handle and/or charger), do not use it again.

-本产品包含不可维修的部件。如果产品损坏,请联系您所在国家/地区的客户服务中心

-This product has non-repairable parts. If any damage happens to the product, please contact the customer service center in your country/region.

-切勿在户外或高温表面附近使用充电器。

-Do not use the charger outdoors or near high-temperature surfaces.

-产品不建议由有肢体、感官或精神能力缺陷或缺少使用经验和知识的人(包括儿童)使用，除非有负责他们安全的人对他们进行与产品使用有关的监督或指导。

-The product is not advised to be used by people (including children) who have physical, sensory, or mental deficiencies or shortage of experience and knowledge in use, unless they are closely instructed or supervised in the proper use of this product.

-请照看好儿童，本产品不能用于玩耍。

-Do not use for fun, s please pay attention to your child.

警告

Warning

-如果您最近做过口腔或牙龈手术、遭受牙齿问题的持续困扰、在过去两个月接受过大量的口腔治疗或遭遇疑似口腔治疗（补牙、齿冠等）问题，请在**使用本产品之前**咨询牙医。

-If you have recently undergone oral or gum surgery, suffered persistent dental problems, received a lot of oral treatments in the past two months, or encountered suspected oral treatments (dental fillings, corona, etc.), please consult dentists before using this product.

-如果使用本产品后牙龈大量出血或在使用 4 周后仍会出血，请咨询您的牙医。

-If your gum bleeds heavily after using this product or still bleeds after 4 weeks of use, please consult your dentist.

-如果您有医学问题，请在**使用本产品前**咨询您的医生。

-If you have medical problems, please consult your doctor before using this product.

-本款产品符合电磁装置的安全标准。有关任何涉及心脏起搏器或其他植入装置的问题，请在**使用之前**咨询医生或植入装置的制造商。

-This product meets safety standards for electromagnetic device. If you have any questions about cardiac pacemaker or other implants, please consult doctors or manufacturers of implants before using it.

-切勿使用非制造商推荐的其它牙附件。

-Only use dental accessories recommended by the manufacturer.

-切勿对喷嘴的喷嘴尖端施加过大压力。

-Do not apply excessive pressure to the nozzle tip.

-为避免受伤，请勿向储水池注入热水。

-To avoid injury, do not fill the reservoir with hot water.

请勿将异物放入储水池。

Do not drop or insert any foreign object into the reservoir.

-只能将本产品用于本用户手册中所述的原定用途。

-Only use this product for the intended purpose described in instructions.

-为避免受伤，请勿将水牙线喷嘴对于牙龈处呈 45° 角。

-To avoid injury, do not place the nozzle at a 45° angle to the gums.

-切勿使用洗碗机或微波炉,洗衣机清洁本产品的喷嘴、手柄、充电器。

-Do not use dishwashers or microwave ovens, washing machines to clean the nozzles, handles, and chargers of this product.

-本产品为私人用品，不可供牙科诊所或机构对于多位患者使用。

-This product can only be used personally and cannot be used by dental clinics or institutions for multiple patients.

一.产品介绍

I. Product Introduction

感谢您使用我们的产品，本产品是一款智能可视化水牙线，通过手机连接应用软件实现实时导向，低延迟、高画质来满足您对口腔护理的未知体验，改善您的口腔健康。

Thank you for using our product. This product is an intelligent visual dental water jet, which realizes real-time guidance through connecting internet

applications, with low latency and high definition to meet your unknown experience of oral care and improve your oral health.

(图 1)

(Picture.1)



No.	名称 Name
01	摄像头 Camera
02	喷嘴 Nozzle
03	机身 Body
04	电源键 Power Button
05	三档模式 Three Modes
06	感应式充电 Inductive Charger
07	入水口 Water Inlet

充电

Charging

首次使用之前应为智能可视化水牙线充电 8 小时。

Charge the intelligent visual dental water jet for 8 hours before first use.

1. 将充电底座用 USB 线连接手机充电器输出端 DC5V 电源。
1. Connect the charging base to the DC5V power supply at the output end of the mobile phone charger with a USB cable.
- 2.将主机放入充电底座上进行感应式充电。(图)
2. Put the body into the charging base for inductive charging. (Picture.)

充电过程: (图)

Charging Process: (Picture.)



注意: 充满电时, 智能可视化水牙线的续航可达 30 天

Caution: When fully charged, the life of the intelligent visual dental water jet can be up to 30 days.

使用准备

Preparations for Use

1. 使用手机浏览器扫描二维码, 下载 APP

1. Use your mobile phone to scan the QR code and download the APP.

(Android4.0; iOS9.0 或以上系统可支持使用)

(Supported by Android4.0; iOS9.0 or above system)



2. 打开手机 WLAN 列表，并找到与设备名称相同的 Wi-Fi 名称(如 wlan-XXX 或 HZM-xxx 开头的地址)，点击链接。

The 2. opens the cell phone WLAN list and finds the same Wi-Fi name as the device name (such as the address at the beginning of the wlan-XXX or HZM-xxx), Click to link.

3. 点击下载安装好的 APP 进入



-Click Download download installed APP to enter

4. 进入操作界面，第 1 页为公司简介，第 2 页为产品商城。

Go to the operation interface, page 1 is the company profile, and page 2 is the product mall.



5. 向左滑动进入第 3 页“开始链接”，并点击立即链接！完成设备和手机的 WIFI 图传链接。

5. slides left to page 3 "Start link" and click the immediate link!Complete
WIFI map link for device and phone.

6.安装喷嘴：将喷嘴向下按入机身，并向右旋转锁紧。

6.Install the nozzle: press the nozzle down into the body and turn it to the right to lock it.

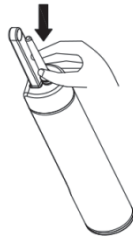

注意：喷嘴孔对向前方！

Warning: the nozzle hole faces forward!

7.将水管插入机身底部入水口。(图)

7.Insert the water pipe into the water inlet at the bottom of the body. (Fig.)

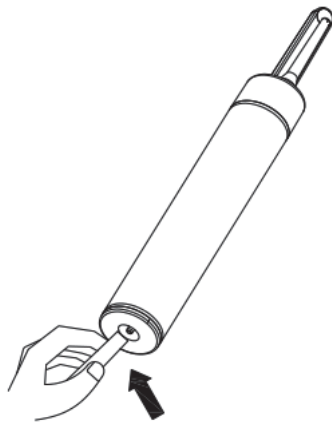

8.向水杯或水瓶内（盛水工具可就近寻找使用）注入水或漱口水。

8.Fill the cup or bottle (finding the convenient tool near you) with water or mouth wash.

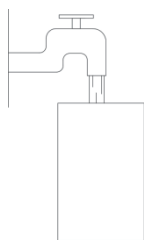

提示：为了获得最佳效果和更令人舒适的体验，建议您可以将智能可视化水牙线和漱口水一起使用。

Tip: In order to get the best results and have a more comfortable experience, you are advised to use the intelligent visual dental water jet and mouthwash together.

注意：切勿使用含十四酸异丙酯或高浓度精油的漱口水和温度过高的水，否则肯能会对您的口腔造成损害或损坏产品。(例如，用除塑料以外包装的漱口水)

Warning: do not use mouthwash with isopropyl tetradecanoate or essential oil in high concentration, and water at high temperature, otherwise your oral cavity may hurt or the product may be damaged. (For example, use mouthwash packaged other than plastics)

9.将装有重力球的进水管放入到装满水的水杯或水瓶内。

9.Place the water inlet pipe with the gravity ball into the cup or bottle filled with water.

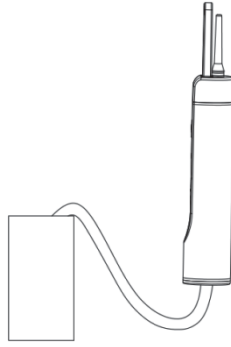

10.按一键操作电源开关(图)

10. Press the OneClick to operate the power switch (Fig.)

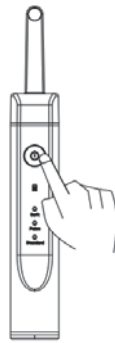

提示：长按两秒是开启/关闭设备，短按一下是切换模式。

Tip: Long press for two seconds to turn on/off the device, short press to switch modes.

模式介绍及使用

Mode Introduction and Usage



1. 确保智能可视化水牙线已开启。如果已关闭，请按下电源键两秒一键操作然后释放，以打开产品。

1. Make sure turn on the intelligent visual dental water floss. If closed, please press power for two seconds and release it to turn on the product.

2. 您可以通过轻按开关，以便更换模式。

2. You can change the mode by tapping the switch.

-轻柔模式(Soft)

- Soft Mode

* 提供 30psi 左右的水压冲洗牙齿和牙龈缝隙内牙渍/污渍，适用于初次使用的人群。

* Provide water pressure about 30 psi to rinse the tooth stains/stains of teeth or in gingival crevices, which is suitable for people who uses it for the first time.

-脉冲模式(pulse)

-Pulse Mode

* 提供 50-70psi 水压的脉冲水流冲洗冲洗牙齿和牙龈缝隙内牙渍/污渍，每冲洗 3 秒停顿 2 秒，停顿的过程中方便用手机视频观察口腔需冲洗的地方和冲洗过程中的效果，并达到 SAP 牙龈的效果。

* Provide pulsed water flow of 50-70psi to rinse the tooth stains/stains of teeth or in gingival crevices, with a pause of 2 seconds for every 3 seconds of rinsing. During the pause, it is convenient to use mobile phone video to observe the place to be rinsed in the oral cavity and the effect of the rinsing process, achieving the SPA effect of gums.

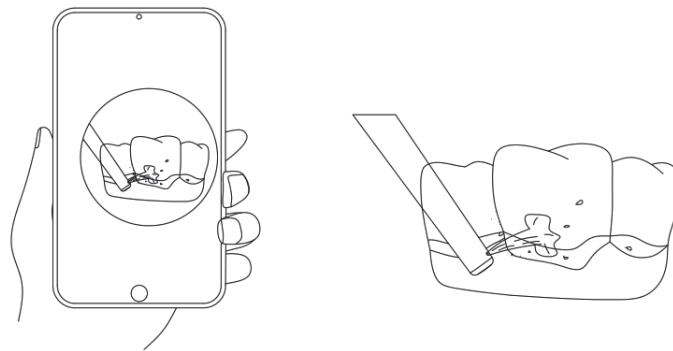

-标准模式 (standard)

- Standard Mode

* 提供 50-70psi 水压的水流冲洗冲洗牙齿和牙龈缝隙内牙渍/污渍。

* Provide water flow of about 50-70 psi to **rinse tooth stains/stains of teeth or in gingival crevices.**

注意：智能可视化水牙线开机的默认模式是轻柔模式(Soft)，目的是为了您将设备放入口中的过程中不受到太强水压的烦恼和初次使用者的适应。

Note: Default mode of the intelligent visual dental water jet is Soft Mode (Soft), in order not to bother you with strong water pressure and for the first-time user to adapt when putting it in the mouth.

3. 使用时将喷嘴尖端沿牙龈线移动冲洗牙齿表面和缝隙。略微闭合喷嘴上方的嘴唇，以免液体飞溅。

3. When using, move the nozzle tip along the gum line to flush the surface and slits between the teeth. Close the lips above the nozzle slightly to avoid splashing liquid.

4. 本产品也可冲洗舌头表面舌苔，冲洗地方和效果可借助本产品的可视功能，WIFI 连接手机的视频观看冲洗效果。

4. This product can also be used to wash the coating on the tongue, and with the help of the visual function of this product, **you can check the area washed and the effect through the video of the mobile phone connected to WIFI.**

常见问题

FAQ

1. 使用时牙龈出血

1. Gums bleeding when using

解决办法:使用时避免水牙线与牙龈呈 45° 角，应和牙齿垂直平行，这样能有效避免牙龈出血的问题或使用轻柔挡位逐步适应。

Solution: **When using, avoid the water jet against the gum at an angle of 45°,**

and place it perpendicularly to the teeth, or use a gentle gear to gradually adapt. These can effectively avoid the problem of gum bleeding.

2. 水压太低

2. Too low water pressure

解决办法:可能喷嘴内有异物堵塞或喷嘴口被压坏, 请更换喷嘴。

Solution: There may be a foreign object clogged in the nozzle or the nozzle orifice is crushed, please replace the nozzle.

3. 产品不运行

3. The project doesn't run

解决办法:刚购买之后电量不足或长时间未使用, 请连续充电 3 小时以上激活电池。

Solution: For low battery after purchasing or not using for a long time, please charge it continuously for more than 3 hours to activate the battery.

4. 产品喷嘴不出水

4. The nozzle does not spray water

解决办法:请检查剩余水量。本产品内置重力球专利技术, 不管用任何角度使用都会正常工作。

Solution: Please check the remaining water level. This product has patented technology of built-in gravity ball, so it can work normally at any angle.

5. 手机连接软件后没有画面

5. There is no interface after mobile phone has been connected to the application.

解决办法:请检查是否连接上产品对应的无线网络。

Solution: Please check whether it is connected to the corresponding wireless network of the product.

6.产品有质保吗？

6. Does the product have a warranty?

解决办法:有的，本款产品承诺非人为质量问题支持 1 年保修，您可以放心购买。

Solution: Yes, this product promises to support one-year warranty for non-manmade quality problems, please rest assured to buy.

产品参数

Product Parameters

产品名称 Name of Product	智能可视水牙线 Intelligent visual water floss	产品型号 Product Model	HZM-P002-01
工作环境温度 Working Environment Temperature	-10--50℃	工作电压 Working Voltage	DC 3.7V
电池 Battery	1800mAh	输入电压 input voltage	DC5V
电池续航 Battery Life	约使用 30 天 About 30 days	输入功率 interiorinput power	4.0W
充电时长 Charging Duration	8h	防水等级 Waterproofing Grade	IPX7
充电方式 Charging Way	感应式充电 Inductive Charger	执行标准 Executive Standard	GB4706.1/59

图像传输速率 Image Transmission Rate	300Mbps	摄像头像素 Camera Pixel	500 万 5 million
网络标准 Network Standard	IEEE 802.11b/g/n		
产品尺寸 Product Dimension	37*235mm		

以下内容请销售单位协助用户完整填写

Sales unit should assist the user to complete the following content

用户姓名：

Name of User:

购买日期：

Date of Purchase:

联系方式：

Contacts:

以下内容请销售单位完整填写

Sales unit shall complete the following content:

产品型号：

Product Model:

出厂日期：

Date of Production:

销售单位名称：

Name of Sales Unit:

符合下列情况之一者，不在免费保修范围内，本公司或其授权服务中心

将实行合理的收费维修：

If it meets any one of the following conditions, the warranty would not cover. The company or its authorized service center will charge reasonable repair fees:

. 超过三包有效期的；

. Three guarantees have been expired

. 无有效发票或保修凭证被涂改；

. Without valid invoice or warranty card has been altered;

. 未按使用说明书要求使用，维护、保养而造成损坏的；

. Damage due to failure to comply with the requirements of the instructions and maintenance;

. 浸水、摔坏或烧毁；

. Damage due to immersing in water, smashing or burning;

. 使用过程中的使产品表面的磨损的，但因产品结构或者材料因素导致的外壳开裂的除外；

. Abrasion of the product surface during use, except for shell cracks caused by product structure or material factors;

. 不可抗力造成的损坏

.Any damage caused by force majeure

This device complies with part 15 of the FCC Rules. Operation is subject to the following two conditions: (1) this device may not cause harmful interference, and (2) this device must accept any interference received, including interference that may cause undesired operation.

Any changes or modifications not expressly approved by the party responsible for compliance could void the user's authority to operate the equipment.

NOTE: This equipment has been tested and found to comply with the limits for a Class B digital device, pursuant to Part 15 of the FCC Rules. These limits are designed to provide reasonable protection against harmful interference in a residential installation. This equipment generates, uses and can radiate radio frequency energy and, if not installed and used in accordance with the instructions, may cause harmful interference to radio communications. However, there is no guarantee that interference will not occur in a particular installation.

If this equipment does cause harmful interference to radio or television reception, which can be determined by turning the equipment off and on, the user is encouraged to try to correct the interference by one or more of the following measures:

- Reorient or relocate the receiving antenna.
- Increase the separation between the equipment and receiver.
- Connect the equipment into an outlet on a circuit different from that to which the receiver is connected.
- Consult the dealer or an experienced radio/TV technician for help.

The device has been evaluated to meet general RF exposure requirement. The device can be used in portable exposure condition without restriction