

AMBITFUL

Product manual

# Aurora EF100 COB Photography fill light professional

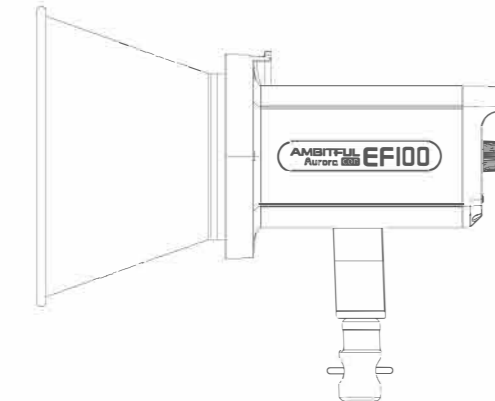

Thank you for choosing AMBITFUL fill light

Executive standard: Q/ZJX.001-2021  
Shenzhen Zhijie Imaging Equipment Co., Ltd.  
Address: Room 702, Building B, Duocai Science and Technology City,  
No. 5, Guanle Road, Luhu Community, Ganhuo Street, Longhua District, Shenzhen  
Tel: 0755-83221105 Email: zhijie@ambitful.com Website: WWW.AMBITFUL.COM

## 1. PRODUCT FEATURES

EF100 COB is a professional monochrome temperature photography fill light, with small and delicate appearance; Adopt high CRI COB bead, high light efficiency and accurate color temperature; It has 6 FX light effects; 100W high power; It is applicable to e-commerce live streaming, studio, character interview, video shooting, makeup and other scenes, with APP wireless dimming to enjoy the ultimate lighting experience.

- Maximum output power: 100W
- FX light effect mode: 6 (adjustable)
- Light effect speed: 3rd gear (adjustable)
- Fan speed: 3rd gear (adjustable)
- Dimming mode: host control/support APP wireless dimming
- Group and channel: 9 groups and 19 channels
- Display screen: LCD screen, more intuitive display
- Appearance features: light body and small volume

## 2. PART IDENTIFICATION

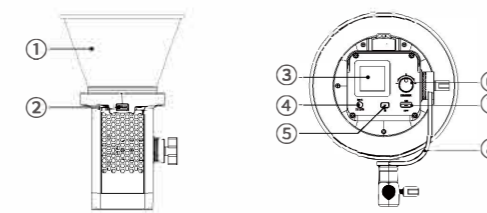

- ① Lampshade
- ② Lampshade connection button
- ③ Display screen
- ④ Power interface
- ⑤ Menu keys
- ⑥ Dimmer knob
- ⑦ ON/OFF keys
- ⑧ Holder

## Display Screen

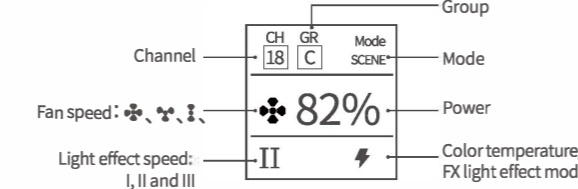

\*Note: Fan speed: , the power is adjustable within 0%-100%;  
Fan speed: , the power is adjustable within 0%-80%;  
Fan speed: , the power is adjustable within 0%-50%;

## 3. INSTRUCTIONS

### 3.1 USE EXTERNAL POWER SUPPLY

1. Connect the power adapter to the <④ Power interface> (As shown in A1).

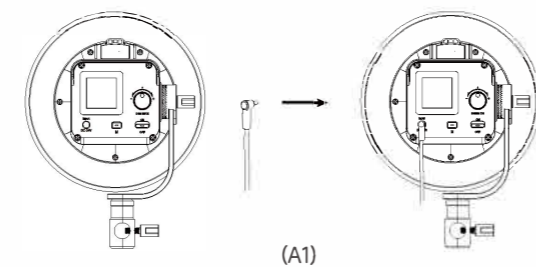

### 3.2 ON/OFF

Turn on <⑦ ON/OFF keys >, the light and the display screen will be on.



### 3.3 CCT Mode

In SCENE mode, short press <⑤ Menu keys> to switch to CCT mode.  
**Power regulation:** Rotate <⑥ Dimmer knob > left and right to regulate the power.  
Note: This equipment has monochromatic temperature, so only the power can be regulated.

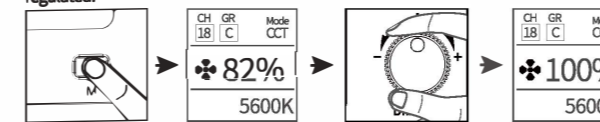

### 3.4 SCENE Mode

In CCT mode, short press <⑤ Menu keys> to switch to SCENE mode.  
**Power regulation:** Rotate <⑥ Dimmer knob > left and right to regulate the power.

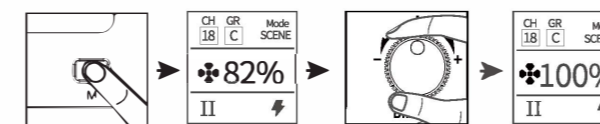

**FX light effect mode:** Short press <⑥ Dimmer knob > to switch to FX light effect mode option; rotate <⑥ Dimmer knob > to select FX light effect modes.

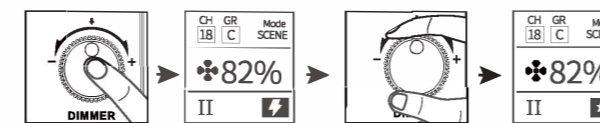

**Light effect speed:** Short press <⑥ Dimmer knob > to switch to light effect speed option; rotate <⑥ Dimmer knob > to regulate the speed 'I, II and III.

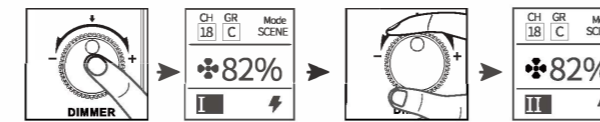

### 3.5 Bluetooth Mode

Long press <⑤ Menu keys > to enter Bluetooth Mode.  
**Adjust group/channel:** Short press <⑥ Dimmer knob > to switch group / channel options, and turn <⑥ Dimmer knob > to adjust parameters under options.  
Long press <⑤ Menu keys > to exit from Bluetooth Mode.

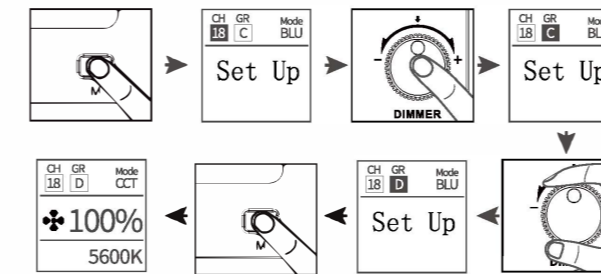

### 3.6 Fan Mode

In Bluetooth mode, short press <⑤ Menu keys> to switch to the fan mode.  
**Adjust the fan speed:** short press <⑥ Dimmer knob > to select the fan speed: , , .  
Long press <⑤ Menu keys > to exit the fan mode.

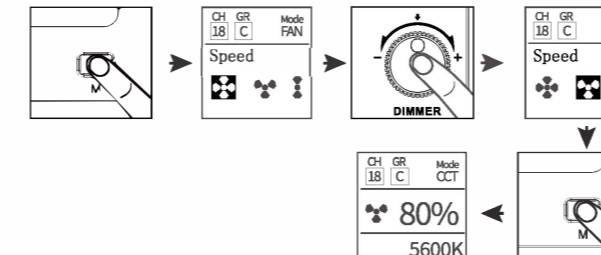

\*Note: Fan speed: , the power is adjustable within 0%-100%;  
Fan speed: , the power is adjustable within 0%-80%;  
Fan speed: , the power is adjustable within 0%-50%;

## 4. APP OPERATION



[ios system] Search "ambitfulpro" in "APP Store" to find the APP and download and install it on the phone; you can also scan the QR code to download the APP.

[Android system] Use the scan code function of the mobile phone browser to download the APP, and install it. (The scan code function of chat software cannot download the APP)

Preview of the APP'S Interface

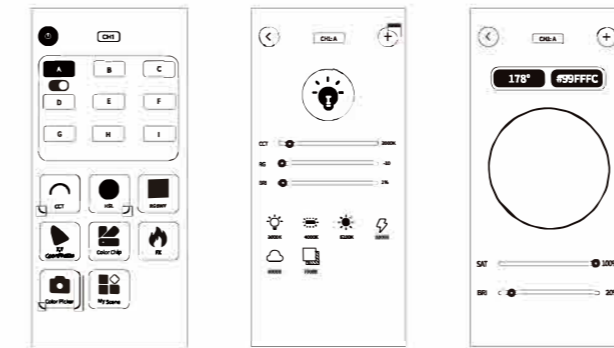

## 5. COMMON PROBLEMS AND NOTES

1. Do not use the fill light directly on other people's eyes at close range, otherwise it may damage their eyes.
2. After long time use, the temperature may exceed 60 °C, pay attention to burns.
3. Do not cover the light with towel, adhesive tape and other articles to avoid damage to the light body and a fire caused by overtemperature.
4. Do not subject the lamp body to strong vibrations, otherwise it may cause malfunctions and cause component damage.
5. Do not attempt to disassemble or repair the fill light by yourself, otherwise it may cause electric shock or malfunction.
6. Please ensure to install the light securely to avoid damage caused by falling of a heavy light.
7. Please keep this equipment out of children's reach.
8. If smoke or burning odor is found, immediately stop operation and unplug the power supply to prevent supplemental fire or burning.
9. The fill light must not be immersed in water or exposed to rain or water vapor water into the lamp, it may cause the fill lamp to catch fire or electric shocks this case, the power should be cut off immediately.
10. Prohibit to use the fill light in places with flammable gas (including propane, gasoline and dust), it may cause explosion or fire.

## 6. PRODUCT PARAMETERS

Model	EF100
Dimming method	Host control /APP control
Color temperature	5600K (Fixed)
Power range	0-100%(Adjustable)
Max.Brightness	12200lm
Max.Illuminance	Naked light>4220Lux@1m, Reflector >35500Lux@1m
Remote-controlled distance	20 meters (the distance will increase or decrease because of obstacles in the operating environment)
Max.Power	100W (Power 100%)
Group	9 Group (A,B,C,D,E,F,G,H,I)
Channel	1-19
Color rendering index	CRI≥ 95, TLCI ≥95
Power Adapter	DC 24V±5%, φ5.5*2.5mm
Size	275x126x142mm
Weight	≈986g

## AMBITFUL

## Warranty Card

AMBITFUL international warranty card is an important file. In case of requiring any warranty services during the warranty period, user needs to show the warranty card and original of invoice, both of which are stamped by the Company's authorized dealer. For any information about the change of our designated maintenance outlets and other information, please visit our website at www.ambitful.com. Please keep the warranty card properly, which will not be reissued once lost.

Product name		Dealer's name/seal	
Model			
Warranty period			
Date of purchase			
Contact			

FCC ID : 2A6K7-EF100

## FCC Warning

This device complies with part 15 of the FCC Rules. Operation is subject to the following two conditions:  
(1) This device may not cause harmful interference, and (2) this device must accept any interference received, including interference that may cause undesired operation. Any Changes or modifications not expressly approved by the party responsible for compliance could void the user's authority to operate the equipment.  
Note: This equipment has been tested and found to comply with the limits for a Class B digital device, pursuant to part 15 of the FCC Rules. These limits are designed to provide reasonable protection against harmful interference in a residential installation. This equipment generates uses and can radiate radio frequency energy and, if not installed and used in accordance with the instructions, may cause harmful interference to radio communications. However, there is no guarantee that interference will not occur in a particular installation. If this equipment does cause harmful interference to radio or television reception, which can be determined by turning the equipment off and on, the user is encouraged to try to correct the interference by one or more of the following measures:  
-Reorient or relocate the receiving antenna.  
-Increase the separation between the equipment and receiver.  
-Connect the equipment into an outlet on a circuit different from that to which the receiver is connected.  
-Consult the dealer or an experienced radio/TV technician for help.  
This equipment complies with FCC radiation exposure limits set forth for an uncontrolled environment.  
This equipment should be installed and operated with minimum distance 20cm between the radiator & your body.