

## 15W Fast Charging

Universal Automatically Clamping Wireless Car Charger

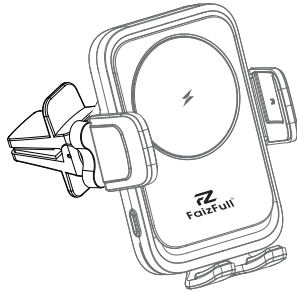

## User Manual

Model: F150

### Product introduction

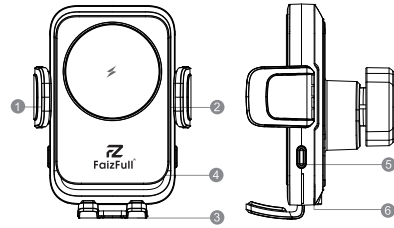

- ① Left arm clamp
- ② Right arm clamp
- ③ Bottom bracket
- ④ Wrap-around ambient light
- ⑤ Buttons to release/close arm clamps
- ⑥ Type-C charging port

### Product parameters

Material	PC+ ABS+Aluminum Alloy(Clamp Arms)
Input	5V/2A,9V/2A,9V/2.22A(QC2.0/3.0/AFC)
Output	5W,7.5W,10W,15W MAX
Charging Efficiency	83%MAX
Support	4.7~6.7 inch Qi-enabled phone
Frequency	105-205KHZ

### Power indicator

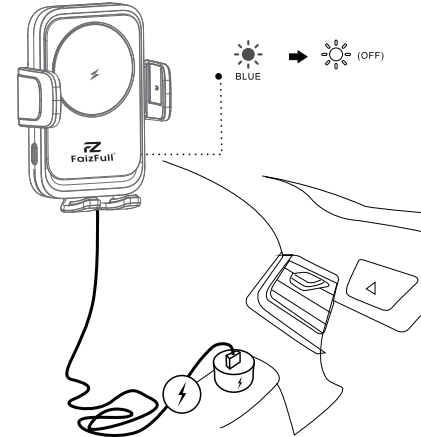

- To ensure a fast charging experience, use a QC2.0/QC3.0 or 18W+ USB Car Charger Adapter.
- Simply press and hold either side of the button for 6S to extinguish the ambient light.
- Press and hold either side of the button again for 6s to reactivate the ambient light.

### Extendable arms

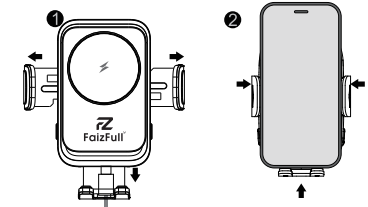

- 1 Arms and foot automatically open after connected to power. (Or touch the side button)
- 2 Place the phone in device will auto clamping and auto-align to the best charging area

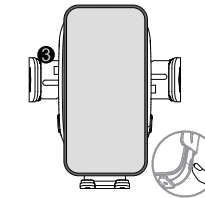

- 3 Touch the side button to open the arms to take your phone

### Air vent mount

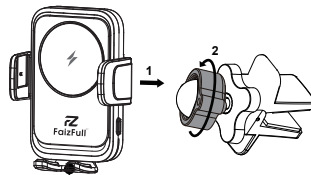

Type C input

Not suitable for round vents!

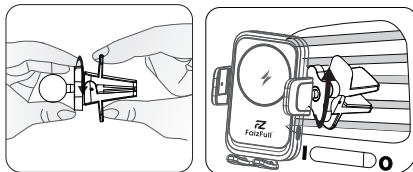
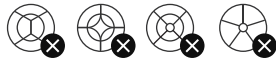

### Incorrect indication

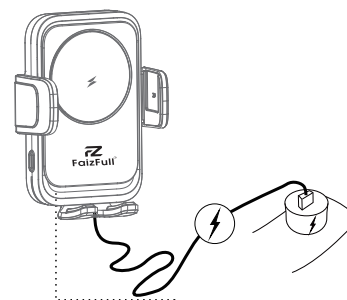

Qi-enabled Phones      non Qi-enabled Phones

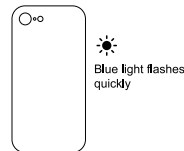
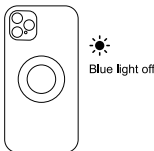

Error: FOD(Foreign Object Detection)/overvoltage protection/ overtemperature protection/overcurrent protection

### Lighting mode

Power on	Indicator light is blue
Charging	Indicator light is green
FOD	Indicator light breathing
Over voltage	Indicator light breathing

### Instructions for use

1. The product and the accessories are assembled and tightened by the ball head nut (compatible with other ball head diameter 17mm), and fixed in the suitable position of the car. Connect the product with QC3.0 car charger or ≥PD18W car charger (optional) by cable, and insert it into cigarette lighter.
2. After power on, the indicator light is always on, and it can automatically detect whether there is a mobile phone on the product:
  - ① When there's a phone on it, the clamping arms hold the phone in a constant state.
  - ② Without a phone on it, the product will automatically open its arms and bottom support within 5 seconds to wait for the phone to be put upon it. When the mobile phone is placed on the product, the bottom support holds the mobile phone, the wireless charging coil will sense the metal parts of the mobile phone through the FOD, depending on the size of the phone, the bottom holder and the clamp-arms move simultaneously to the center of the coil, to automatically clamp the phone and charge it (if the phone has a wireless charging function), because the ratio of length to width of the phone is basically the same, so the positions of the charging coil and the receiving coil are automatically aligned relative to each other. The charging efficiency can be ensured without adjusting the base support manually.

3. In order to ensure the efficiency and stability of charging, the best wireless charging distance is ≤4mm and can not penetrate the metal, so need to avoid using metal or too thick mobile phone case, this allows the phone to charge quickly and wirelessly. (Charging distance ≥4mm is inefficient and ≥6mm may not charge)

4. The Way to remove the phone: Click any button on the left or right, clamp-arms and bottom support are open to the maximum, waiting to take out the phone.

5. If the product does not turn on the light or flicker, button and wireless charging does not work, clamp-arms do not open or close, please stop using and return to the seller for Solving the problem.

### Product description

- Wireless charging for devices that meet Qi wireless charging standards.
- Wireless charger supports 15W fast charging, Universal Apple and Android models.
- Wireless charging detective: when the mobile phone with wireless charging function close to machine and be sensed, it will open the left and right arm to automatically clamp the mobile phone, and start wireless charging.
- Foreign object detective: when a phone without wireless charging function is close to the machine and be sensed, the machine opens the clamp-arms and also automatically clamp the phone, it is used as a normal phone stand without charging.
- Fixed in the car air outlet, 360°adjustable, you can adjust the direction of your phone at will.
- Circuit protection function: over-current protection, overheat protection, short circuit protection
- Certification: FCC CE ROHS

## FCC Warning

This device complies with part 15 of the FCC Rules. Operation is subject to the following two conditions:

(1) This device may not cause harmful interference, and (2) this device must accept any interference received, including interference that may cause undesired operation.

Any Changes or modifications not expressly approved by the party responsible for compliance could void the user's authority to operate the equipment.

Note: This equipment has been tested and found to comply with the limits for a Class B digital device, pursuant to part 15 of the FCC Rules. These limits are designed to provide reasonable protection against harmful interference in a residential installation. This equipment generates uses and can radiate radiofrequency energy and, if not installed and used in accordance with the instructions, may cause harmful interference to radio communications. However, there is no guarantee that interference will not occur in a particular installation. If this equipment does cause harmful interference to radio or television reception, which can be determined by turning the equipment off and on, the user is encouraged to try to correct the interference by one or more of the following measures:

- Reorient or relocate the receiving antenna.
- Increase the separation between the equipment and receiver.
- Connect the equipment into an outlet on a circuit different from that to which the receiver is connected.
- Consult the dealer or an experienced radio/TV technician for help.

The FCC certification of this device refers to RF exposure testing performed in typical operating conditions, where a person is no closer than 20 centimeters from the device surface at all times, except for non-repetitive patterns with transient time intervals in the order of a second. Only in the stated conditions, the device is shown to fully comply with the FCC RF Exposure requirements of KDB 447498.