

VIII. Attentions for security

1. Do not swallow small detachable parts, children usage must be under adult's supervision.
2. Pay attention to prevent children from touching the wheels or nearby to avoid injuries. Make sure to keep other children away from the running car.
3. This car must be assembled by adults or checked by adults before usage.
4. This car is only available for driving on flat grounds. Avoid usage on sands or rugged ground. Choose safe places when playing outside. Playing in dangerous places such as highway, ramp, stairs and pool are forbidden. This car is not for traffic.
5. This car is for singular use with limitation for 20Kg. Do not overload.
6. Charging must follow instructions.
7. Do not change the advance/retreat switch abruptly when the car is running. Change it when the car stops otherwise the drive gear box will be seriously damaged.
8. Take off the battery if the car will not be used for a long time. Avoid storage near fire, in high temperature or under great humidity.
9. Maintenance: the car includes electric components thereby no use in water or damp places. Use wet cloth for cleaning.
10. Keep the dismantled package from children to avoid accidental hurts.
11. The seat belt attached to the car is just a toy to help increase the sense of safety and does not have the safety function as a adult vehicle.
12. Please teach children to step on/let loose the accelerator pedal and stop the car. Also teach them to cope with obstruction when driving.
13. Before children's usage of this product, guardian is obliged to read this manual and teach their children to operate correctly. Keep this manual for later reference.

This manual contains important information and must be reserved.

NOTE: THIS EQUIPMENT HAS BEEN TESTED AND FOUND TO COMPLY WITH THE LIMITS FOR A CLASS B DIGITAL DEVICE, PURSUANT TO PART 15 OF THE FCC RULES. THESE LIMITS ARE DESIGNED TO PROVIDE REASONABLE PROTECTION AGAINST HARMFUL INTERFERENCE IN A RESIDENTIAL INSTALLATION. THIS EQUIPMENT GENERATES USES AND CAN RADIATE RADIO FREQUENCY ENERGY AND, IF NOT INSTALLED AND USED IN ACCORDANCE WITH THE INSTRUCTIONS, MAY CAUSE HARMFUL INTERFERENCE TO RADIO COMMUNICATIONS. HOWEVER, THERE IS NO GUARANTEE THAT INTERFERENCE WILL NOT OCCUR IN A PARTICULAR INSTALLATION. IF THIS EQUIPMENT DOES CAUSE HARMFUL INTERFERENCE TO RADIO OR TELEVISION RECEPTION, WHICH CAN BE DETERMINED BY TURNING THE EQUIPMENT OFF AND ON, THE USER IS ENCOURAGED TO TRY TO CORRECT THE INTERFERENCE BY ONE OR MORE OF THE FOLLOWING MEASURES:

- REORIENT OR RELOCATE THE RECEIVING ANTENNA.
- INCREASE THE SEPARATION BETWEEN THE EQUIPMENT AND RECEIVER.
- CONNECT THE EQUIPMENT INTO AN OUTLET ON A CIRCUIT DIFFERENT FROM THAT TO WHICH THE RECEIVER IS CONNECTED.
- CONSULT THE DEALER OR AN EXPERIENCED RADIO/TV TECHNICIAN FOR HELP

CHANGES OR MODIFICATIONS NOT EXPRESSLY APPROVED BY THE PARTY RESPONSIBLE FOR COMPLIANCE COULD VOID THE USER'S AUTHORITY TO OPERATE THE EQUIPMENT.

THIS DEVICE COMPLIES WITH PART 15 OF THE FCC RULES. OPERATION IS SUBJECT TO THE FOLLOWING TWO CONDITIONS:

- (1) THIS DEVICE MAY NOT CAUSE HARMFUL INTERFERENCE, AND
- (2) THIS DEVICE MUST ACCEPT ANY INTERFERENCE RECEIVED, INCLUDING INTERFERENCE THAT MAY CAUSE UNDESIRABLE OPERATION.

CHILD STORAGE BATTERY CAR SPECIFICATIONS



Child storage battery car

Manuals for A/B Children Toy Car.  
Welcome to use our children toy car. To ensure a pleasant user experience, we suggest you to read the following instructions. This would help you have a clear comprehension of the product and a proper use.

I. Product description

Name: Electric Toy Car  
Type: A/B/C  
User: 36-72 months children only (Use under adult's supervision; Pay attention to security).  
Size: Approximately 102cm (L) X 62cm (W) X 52cm (H)  
Weight: 10.6Kg  
Load: 20Kg maximum  
Suitable temperature: 0-40 C°  
Battery: 6V storage dry cell  
Main material: PP  
Speed: about 1.8-3 Km/h  
Motor: DC 5-6V  
Charge: 8-12 hours charging provide an hour usage, no more charging than 16 hours each time  
Battery life: about 300 times charging  
Charger : Input AC 110V 60Hz Output DC 6V800mA .(Input AC 220V 50Hz Output DC 6V 800mA ) . Input can be customized.

II. Assembly of the components (see figure 1)

1. Front wheels and left rear wheel (the inner of the tire is a "circle - shaped" structure) : If the wheel is equipped with light function, daub lubricant on the axle, and then install tire (2#); a "clap" sound will be heard when you succeeded; If without light function, shim one gasket through the axle before daubing lubricant and further steps.
2. Right rear tire (the inner of the tire is a "gear- shaped" transmission structure) : daub lubricant on the axle, and then putt the (3#) tire (a gear- shaped structure inside) into the axle and match it with the drive gear box; a "clap" sound will be heard when you succeeded.
3. Wheel cap: If the wheel cap is separated from the wheel, buckle the wheel cap (5#) into he wheel to hear a "clap" sound.
4. Batteries and chair: Install a battery (6#) at the battery slot under the chair; connect the red and black main wire to be battery; insert the battery correctly as red wire for plus and black for minus (avoid mistake) ; lock the battery cap (7#) with two 4\*12mm self-tapping screws; plug the chair (9#) in the car.
5. Steering wheel: Put the steering wheel (10#) on the pole; align the screw holes in the sides, lock up with one 5\*37mm machine screw and one M5 hooded nut;align the wires.
6. Goggle frame: Plug the goggle frame (11#) in the front of the car
7. Headstock shell: Plug the headstock shell (12#) in the front of the car.

•01•

- battery according to the following methods and requirements:
1. The charging port is on the side wall under the seat. Make sure the voltage specification comply with the marks on the charge, then insert the DC plug of the charger to the port. With these done, the indicating light will be on and the charging starts.
  2. Charge for 8-12 hours each time.
  3. It is normal to find a slight generation of heat of the charger and battery during the charge, otherwise the charger nor the battery may be damaged.
  4. To extend service lifetime of the batteries, please charge in time before the exhaustion of the battery. If the car were to store up, charge fully in advance and recharge it every three months.
  5. Only the charger and batteries recommended by the factory can be used.
  6. The charger and batteries are not for play as toys.
  7. The charging must be operated by adults. Do not let children charge by themselves to in order to avoid danger
  8. Do not dump the battery into water or fire nor dismantle it, prevent body contact when there is leakage liquid.
  9. If there is any smoke, smell or noise coming out from the running car, please stop using immediately to avoid fire burn and electric shock. Extract the plug and send it for repairing after checking there is not any smoking.
  10. The power source of the car must be turn off. No use is allowed during the charge.

VII. Guidelines for troubleshooting

- (If there is any fault and need to be repaired, power must be cut off to avoid further damage.
1. When the car cannot run:
    - (1) Check whether the switch in on advance/retreat or not;
    - (2) Check whether the car is overload;
    - (3) Check whether the self-protection device is activated due to longtime running, overload driving or short circuit. The car can be reuse after the elimination of failures;
  - (4) Check whether the power source in connected;
  2. Low speed when running:
    - (1) Recharge if the battery is low;
    - (2) Check whether the car is overload;
    - (3) Replace the battery if it is old and lack of capacity;
    - (4) Replace the motor if the motor brush is abraded or other inner malfunctions.
  3. Failure to charge:
    - (1) Check whether the wire connected to the battery fall apart, if so, reconnect it;
    - (2) Check whether the charger or the battery is damaged.
  4. No or low music sound:
    - (1) Check if the wire of the steering wheel in well matched;
    - (2) Check if the volume switch if damaged;
    - (3) Check if the MP3 slot fails to connect.

•06•

- frequency via the Bluetooth function of your cell phone. With this successfully done, various language and music can be played.
- (2) When the MP3 or other corresponding slots are plugged in with player, memory card or U- drive, press the "mode" button to light on corresponding lamps and you can freely enjoy your music trip.
  - (3) Radio function is included in the multimedia system. Press the "mode" button and it will switch to radio mode when the first lamp is on.
  - (4) When the multimedia system is working:1) press the second circle- shaped button to play last song (last radio channel), long press it to turn down the volume; 2) press the third circle- shaped button to pause and again to resume (long press it to search for channel in radio mode); 3) press the fourth circle- shaped button to play next song (next radio channel), long press it to turn up the volume.

V. Battery instruction and attention

1. The car applies one 6V storage battery ; the remote controller applies two "AA 1.5V "batteries .
2. Put in or take out batteries according to the illustration (see figure 4)
3. Non-rechargeable batteries are not to be recharged.
4. Rechargeable batteries are only to be charged under adult supervision.
5. Rechargeable batteries are to be removed from the toy before being charged (for controller)
6. Different types of batteries or new and used batteries are not to be mixed.
7. Only batteries of the same or equivalent type as recommended are to be used.
8. Batteries are to be inserted with the correct polarity.
9. Exhausted batteries are to be removed from the toy.
10. The supply terminals are not to be short-circuited.
11. The battery chargers are to be regularly examined for damage to the and other parts, and in the event of such damage, they must not be used until the damage has been repaired.
12. Do not bent the remote control antenna to avoid injuries .

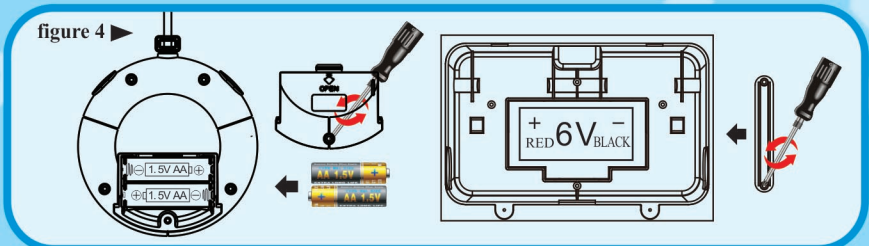

VI. Charging method and attention

Although the voltage of the storage battery has been fully loaded as regulation when leaving the factory, in order to ensure the stability of the voltage, recharging is needed for the initial use. The car will slow down or even stop when the battery is low or exhausted. Please charge the

•05•

figure 1 ▶

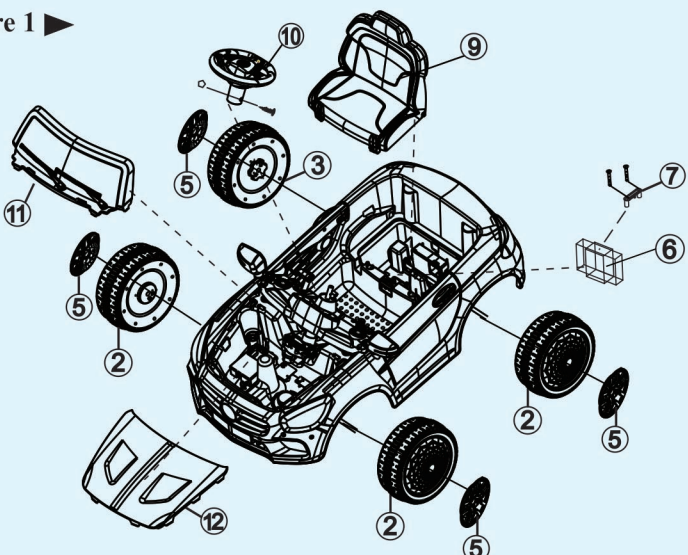

III. Instructions for remote control (see figure 2)

1. Coding: Insert two 1.5V "AA" batteries into the remote controller to initiate using. When the power light of the controller is flashing, press any of the keys and hold for 3 seconds, if the power light is still on and the PWM light in on, that means the coding is successful and the controller is ready for operation.
2. Function of the remote controller: advance, retreat, turn left, turn right, brake and gear shift. Some may also be equipped with function to open/ shut car door.
3. Press the "PWM" button to change the driving speed.
4. There will be soft start function in both remote control and manual driving.
5. If the remote controller or the car's CPU is changed, you should repeat the first step (coding).

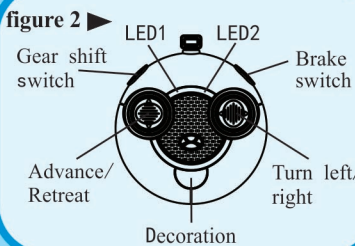

•02•

figure 3 ▶

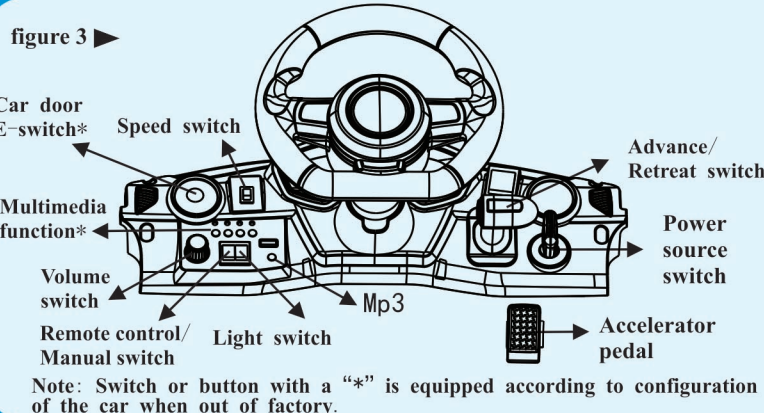

IV. Instruction and function (see figure 3)

- With the successful assembly of wires, battery and the model, this car has the following functions:
1. This is a discast car and applies the "one switch" for power source: when the first round button on the right of the dashboard is pressed, the car is electrified and the indicating light is on. The car enters a standby state.
  2. The second switch on the left of the dashboard controls the headlight. When the switch is on "-", the headlight turns on.
  3. The first switch on the left of the dashboard: function ①if the car is quippedwith a remote control function, this switch controls the change between "remote control" and "electric-driven". When the switch in on "remote control", it can be driven both by remote control or accelerator pedal; when the switch is on "electric- driven, in can only be driven by accelerator pedal. ②if the car is set by electric driven, this switch has no function.
  4. unning: With the car standing by, when the handle on the right of the dashboard is set forwards, step on the accelerate pedal to drive the car forwardsWhen the handle is set backwards, step on the pedal to drive the car backwardsWhen the handle is set in the middle, the car stays in eutraland keeps still. (if hecar has the remote control function, you can use the remote controller to help driving.
  5. teering wheel music: press the buttons on the steering wheel, the car can make corresponding sounds and music.
  6. olume function: The volume switch can adjust the volume size.

•03•

7. he remote controller needs two "AA" 1.5V batteries. It controls within 30m. (If the indicating light of the remote controller in off, check the batteries for power of replace them.
  8. This car is equipped with a self-protection device. When the car is in error (such as longtime running, overload driving and short circuit), the device will cut off the power automatically and the car cannot be driven. Turn off the power for two minutes in that case. NO further usage is allowed before the device restores electricity or removal of faults.
  9. The car process unique light, appearing more charming when driven at night.
  10. The car is equipped with slow start function. The car starts with low speed and automatically accelerates to normal speed after some distance. Both remote control and electric driven can utilize this function. This function is designed to avoid shocking children and ensure the happiness and safety by preventing the car from initiating at a high speed.
  11. The car is equipped with a tire suspension function to enhance the comfort feeling when driving.
  12. If the car is equipped with manual gear shift function, gear shift is possible by operating the speed switch on the dash board.
  13. If the car is equipped with auto car door function, the car door can be controlled by corresponding switch or remote controller.
  14. If the car is equipped with wheel light function, cool light can be switch on by operating the light switch on the dash board.
  15. If the car is equipped with swing function, press the swing button and the car will swing up and down, bringing brand new experience to children. Swinging while driving is possible.
  16. The multimedia function includes Bluetooth, radio, MP3 input and reading audio files in storage card or flash drive. ( Figure 5)
- (1) If the car is equipped with multimedia function, Bluetooth function will be automatically activated and the corresponding light stays on when the car power is on. You can match the

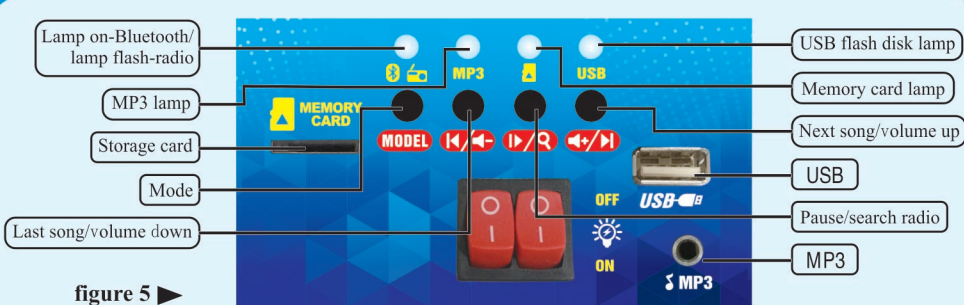

figure 5 ▶

•04•