

## F69 Ear Phones

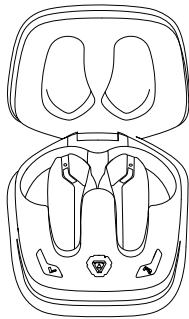

## User manual

### 1、Product Function introduction

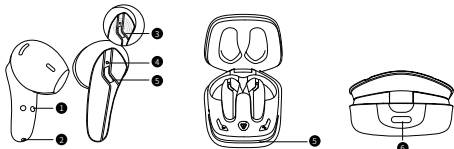

- 1 Earphone charging contact
- 2 ENC Microphones
- 3 Multi-function touch point
- 4 ENC Microphones
- 5 Battery indicator
- 6 Type-c Charging port

### 2、Packaging accessories

- 1 Charging compartment 2 Earphone 3 Charging Cable 4 Certificate 5 User manual



### 3、Instructions for headset touch operation

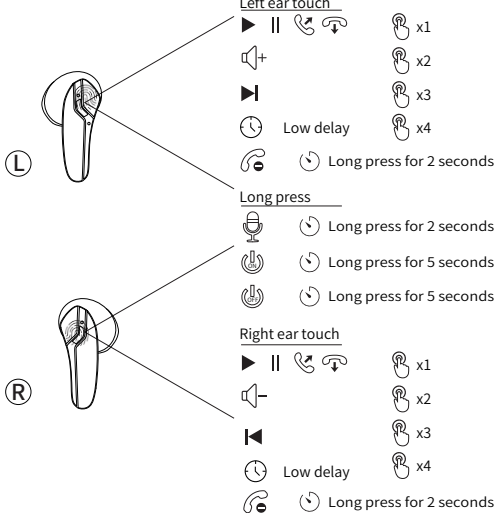

### 4、Earphone connection instructions

A. Singles-ear mode: take out a earphone.  
B. Binaural mode: first turn off the BT of the device and take out the headset. Touch (L) the left ear twice and wait for 3-5 seconds, the pairing is successful with the slow blinking white light on both ears (for details, please refer to the index below)

#### 01 Pair

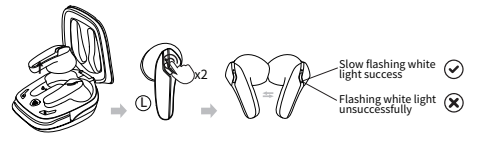

#### 02 Connect

- a. Device connection: Open your phone or other device, search for "F69", and click Connect.  
b. The left and right earphones can be connected separately.

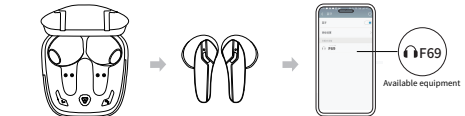

### 03 Turn it off



### 5、Charging instructions

#### 01 Earphone charging

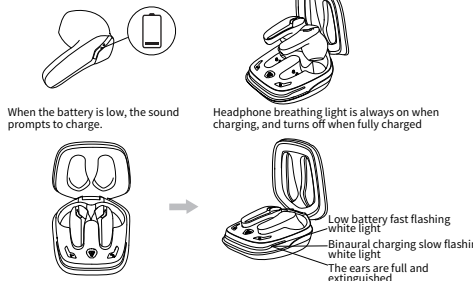

### 02 Charging case Charging

- a. When the charging compartment is charged with a data cable, the white light flashes slowly, and the white light stays on when fully charged

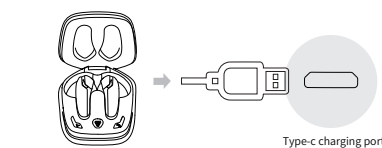

### 6、The basic parameters

|                     |              |                       |          |
|---------------------|--------------|-----------------------|----------|
| Product name        | F69          | Playing time          | 4-5Hours |
| BT                  | 5.2+EDR      | Frequency             | 2.4GHZ   |
| Connection distance | 15m          | Impedance             | 32Ω      |
| Charging time       | About 1 hour | Standby time          | 7-10days |
| Input               | 5V-1A        | Headphone capacity    | 35mah    |
| Talking time        | 3-4hours     | Charging bin capacity | 300mah   |

### ⚠ Safety warning

- Please ensure that the product is not used or stored in high temperature or humid environment to avoid affecting the product performance.
- Do not drop or drop the product from high altitude to avoid damage.
- Please contact manufacturer if there is any product problem, and don't disassemble the product for repair.

### 7、Matters needing attention

- Please make sure the product is fully charged before the first use; Or charge it first.
- Please use a brand charger or computer USB to charge the headset (note: 5V-1A charger).
- Stay away from WIFI and routers and other high frequency transmitting devices, which may affect the signal reception of the unit and cause the phenomenon of sound blocking and disconnection.
- Please use the product in an effective environment (15m) and there should be no physical barriers (such as walls, etc.) between the BT device and the headset.
- Please refer to Item 4 when there is no sound on one side of the earphone and the pairing of two ears is not successful (headset connection instructions) pair and connect the headset again, and the product will work normally after reconnection!

Thanks for buying our F69 TWS earphone which comes with wireless stereo, left and right channel separation and HIFI sound functions. And it can be used alone or in pairs. We welcome your suggestions and comments on our products and services!

## F69 无线耳机

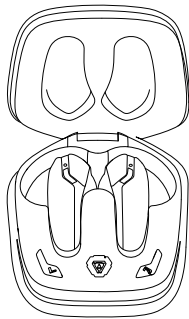

## 用户使用说明书

### 1、产品部件索引

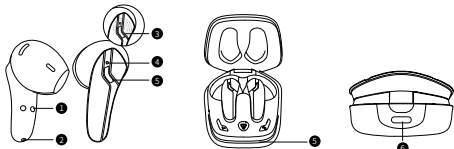

- 1 耳机充电触点
- 2 ENC麦克风
- 3 多功能触摸点
- 4 ENC麦克风
- 5 电量指示灯
- 6 Type-c充电接口

### 2、包装配件

- 1 充电仓 2 耳机 3 充电线 4 合格证 5 使用说明书



### 3、耳机触控操作说明

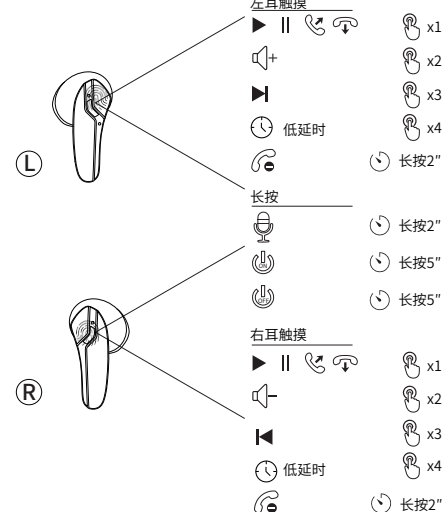

### 4、耳机连接说明

- A. 单耳模式：取出单只使用  
B. 双耳模式：先关闭设备蓝牙，取出耳机。触摸(L)左耳2下等待3-5秒，双耳慢闪白灯配对成功（具体操作请参照下图索引）

#### 01 配对

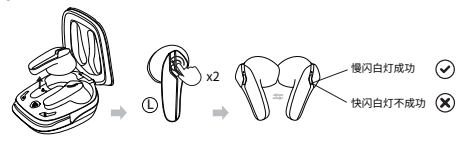

#### 02 连接

- a. 设备连接：打开手机或其它设备，搜索 "F69"，点击连接。  
b. 耳机左右耳均可分开单独连接使用。

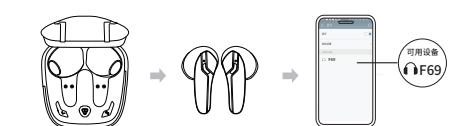

### 03 关机

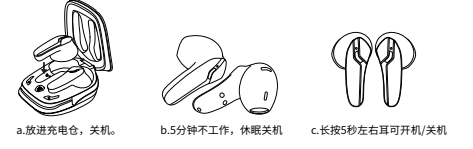

### 5、充电说明

#### 01 耳机充电

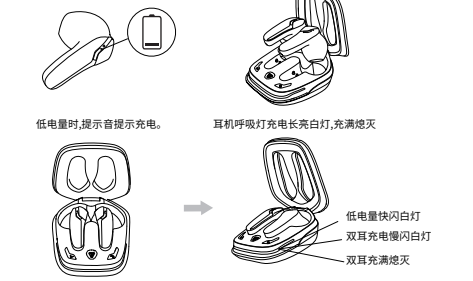

### 02 充电仓充电

- a. 充电仓用数据线充电时，慢闪白灯，充满后长亮白灯

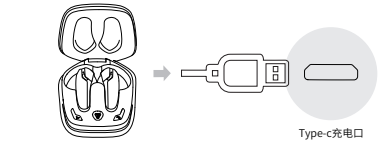

### 6、基本参数

|       |         |       |        |
|-------|---------|-------|--------|
| 产品名   | F69     | 播放时长  | 4-5小时  |
| 蓝牙    | 5.2+EDR | 频率    | 2.4GHZ |
| 连接距离  | 15米     | 阻抗    | 32Ω    |
| 充电时间约 | 1小时     | 待机时间  | 7-10天  |
| 输入    | 5V-1A   | 耳机容量  | 35mah  |
| 通话时长  | 3-4小时   | 充电仓容量 | 300mah |

### ⚠ 安全警告

- 请确保本产品不要在高温环境或者潮湿环境中使用或者存放避免影响产品性能。
- 请勿高空抛落、丢弃以免损坏产品。
- 请勿私自拆卸维修、有问题联系厂家。

### 7、注意事项

- 首次使用前请确认产品充满电；或者先充电。
- 请使用符合安全要求的品牌充电器或者电脑usb为本耳机充电（注：5V-1A充电器）
- 远离WIFI及路由器及其它高频发射设备，这样会影响本机的信号接收，造成声音的卡顿及断连现象。
- 在有效环境（15米）中使用本产品，并且蓝牙耳机与耳机之间不要有实体阻隔（例如墙壁等）。
- 当耳机出现单边无声音，双耳配对不成功等现象时，请参照第4项（耳机连接说明）将耳机重新配对连接，重新连接后产品正常使用！

感谢选择使用F69真正无线连接实现无线立体声，左右声道分离，HIFI音效。可单独使用，也可成对使用。欢迎您给我们的产品及服务提供宝贵的建议和评价！

## **FCC Statement**

This equipment has been tested and found to comply with the limits for a Class B digital device, pursuant to part 15 of the FCC Rules. These limits are designed to provide reasonable protection against harmful interference in a residential installation. This equipment generates, uses and can radiate radio frequency energy and, if not installed and used in accordance with the instructions, may cause harmful interference to radio communications. However, there is no guarantee that interference will not occur in a particular installation. If this equipment does cause harmful interference to radio or television reception, which can be determined by turning the equipment off and on, the user is encouraged to try to correct the interference by one or more of the following measures:

- Reorient or relocate the receiving antenna.
- Increase the separation between the equipment and receiver.
- Connect the equipment into an outlet on a circuit different from that to which the receiver is connected.
- Consult the dealer or an experienced radio/TV technician for help.

Caution: Any changes or modifications to this device not explicitly approved by manufacturer could void your authority to operate this equipment.

This device complies with part 15 of the FCC Rules. Operation is subject to the following two conditions: (1) This device may not cause harmful interference, and (2) this device must accept any interference received, including interference that may cause undesired operation.

### **RF Exposure Information**

The device has been evaluated to meet general RF exposure requirement. The device can be used in portable exposure condition without restriction.