

# YISEELE

## 【User Manual】

Model: **YX-700**



## **Alarm System**

# Contents

Preface .....	2
1. Parts .....	4
1.1 HUB .....	4
1.2 Remote Control .....	4
1.3 Door/Window Detector .....	5
2. Connect to the Wi-Fi .....	6
2.1 The first type: Bluetooth Connection .....	6
2.2 The second type: Hotspot connection method .....	6
3. Installation steps .....	9
4. Add .....	12
4.1 Add Detectors and Remote control .....	12
4.2 Add Alexa and Google Home .....	12
5. APP menu explanation .....	13
6. Maintenance and Troubleshooting .....	14
7. Appendix of Technical Parameters .....	16
7.1 Hub .....	16
7.2 Remote .....	16
7.3 Door/Window Detector .....	16

## Preface:

---

First of all, thank you for choosing our wireless intelligent security burglar alarm system!

This wireless intelligent security burglar alarm system will provide round-the-clock protection for your house and property all year.

The reliable wireless electronic burglar alarm uses the most advanced Israel digital security technology with a low false alarm rate. Although it is a simple design, it is powerful: fireproofing, burglary prevention, anti-gas leakage, indoor robbery prevention, SOS for sudden illness, and other functions. At the same time, wired or wireless detectors are optional with user-friendly control modes, including anti-interference, anti-false alarm, or anti-missing alarm. It has been widely used for families, shops, convenience stores, financial offices, villas, residential quarters, and urban networking alarms.

To protect your safety and enable the alarm system to achieve the best results, it is recommended that you read the user manual in detail before installation and use. If you need further consultation and services in the installation or operation process, please contact us through our technical service email.

**Note:** To ensure that you can enjoy the perfect “Three Guarantees” after-sales service, don’t open the cover of the alarm system, and do not repair or change it yourself. If you do our company won’t provide free warranty services for any unauthorized tampering with the products. All losses and adverse consequences shall be borne by the user.

Please take good care of the manual so you can refer to it later.

# 1. Parts:

## 1.1 HUB:

### 1. WiFi Indicator

Three states:

- a. Off state: factory value, module is normal
- b. Blinking state: waiting to configure the network
- c. Flashing all the time state: Configuration is successful

### 2. Away arm Indicator

### 3. Home arm Indicator

### 4. Disarm Indicator

### 5. Alarm Indicator

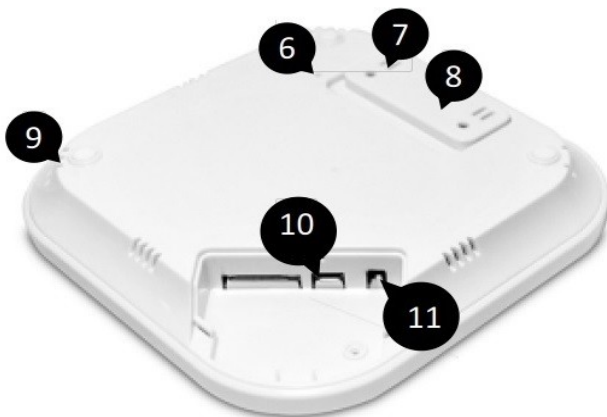
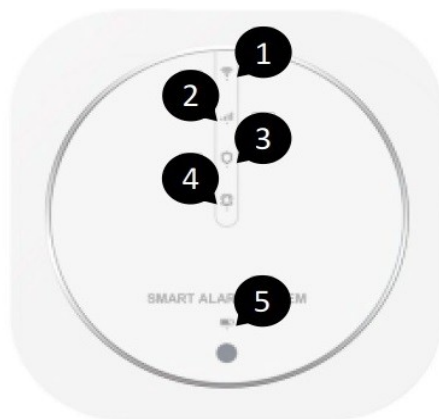

6. Reset Button

7. Tamper Switch

8. Bracket

9. Built-in Siren

10. Power Port (Micro USB)

11. Switch

## 1.2 Remote Control:



Key Name	Key Function
Away	This mode is suitable for when no one is home, any detector triggering will trigger an alarm.
Disarmed	The alarm is in the "disarmed" state, only the "24 hours" zone detector works.
Home	This mode is suitable for when someone is at home, the "Ordinary" and "24 Hours" detectors work normally, but the "Home" detectors do not work (go to "Accessories → Detector → Zone mode" to set).
SOS	Using this mode in an emergency. Alarm goes off and alarm notification is sent to registered users.

## 1.3 Door/Window Detector:



## 2. Connect to the Wi-Fi (Choose one of the following methods):

**2.1 The first type: Bluetooth Connection** ( You can search "YISEELE Smart Alarm System (English) - How to connect Wi-Fi to APP" on YouTube to view the connection video).

**Step 1:** Adjust the Wi-Fi indicator light to blinking state;  
(Method: press and hold the reset button until the HUB has a "prompt tone" and release it).

**Step 2:** Download the "Tuya Smart" APP  
(Scan the QR code on the right, or search for "Tuya Smart" in the app store),  
register an account, and enter the main interface.



**Step 3:** Turn on the "Bluetooth" function  
of the Mobile Phone, enter the main  
interface of the APP, a dialog box will  
pop up immediately (as shown  
in the right picture), click "**Add**".

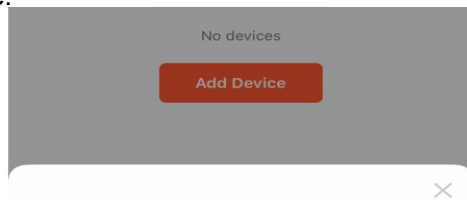

Devices to be added: 1

**Step 4:** Select 2.4G Wi-Fi,  
enter the user password,  
click " Next ",



Wi-Fi Alarm  
System

Add

and wait for the connection to succeed.

**2.2 The second type: Hotspot connection method** (When your mobile phone does not have Bluetooth function, or the connection interface cannot automatically pop up, please use this method) .

**Step 1:** Adjust the Wi-Fi indicator light to blinking (Method: Press and hold the reset button until the HUB displays a "prompt tone" and release it).

**Step 2:** Download the "Tuya Smart" APP (Scan the QR code above, or search for "Tuya Smart" in the app store), register an account, and enter the main interface.

**Step 3:** Click "+" in the upper right corner, click "Add Device" → Sensors → Alarm (Wi-Fi) → select 2.4G Wi-Fi, and enter the password, click "Next" → click "Next", select "Blink Slowly" → click "Go to Connect" → Select SmartLife-XXXX → Click "Tuya Smart" in the upper right corner.

**Please refer to the diagram below for specific steps:**

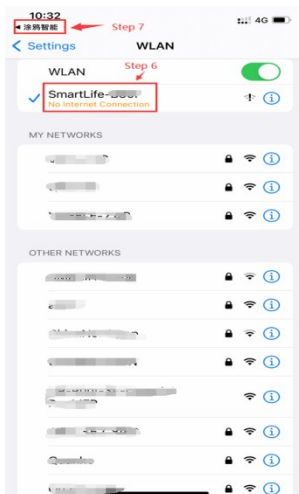
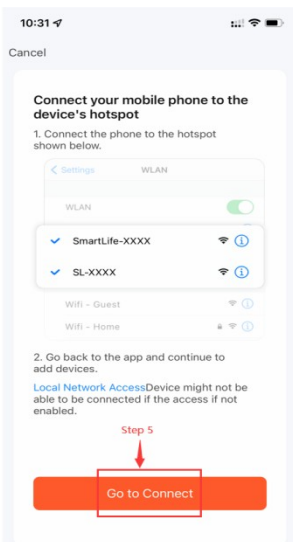
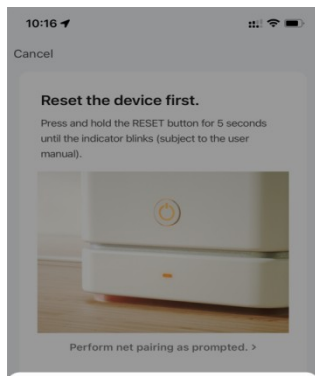
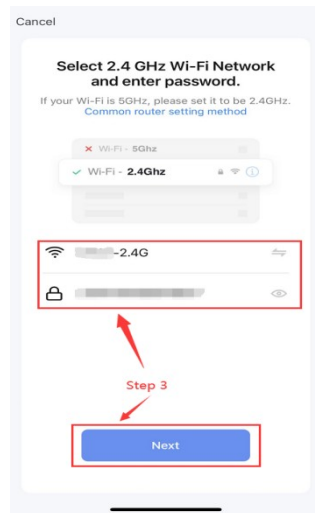
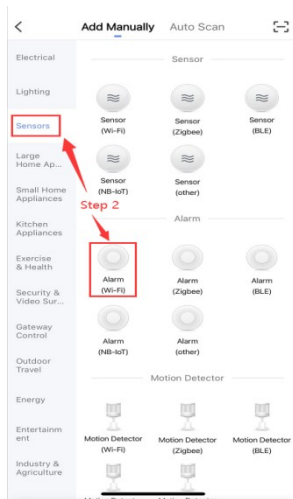
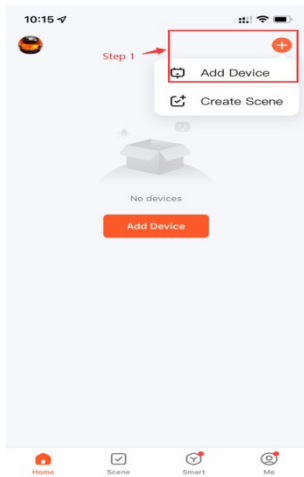



### 3. Installation steps:

---

**Step 1: Plug in the power, and insert the wired siren and turn on the switch** (YX-700 is not equipped with wired siren, need to purchase separately) ;



**Step 2: Refer to “Connect to the Wi-Fi”.**

Connect the alarm system to Wi-Fi. After the connection is successful, the Wi-Fi Indicator is always on.



**Step 3: Install the HUB.**

- 1) . Take off the mounting bracket on the back of the HUB;
- 2) . Screw the mounting bracket to the wall with screws;
- 3) . Hang the HUB on the mounting bracket and plug the power adapter into the socket.

**Step 4: Install the Door/Window detector .**



- 1) . Open the back of the door/window detector, and then turn on the switch on the HUB (switch to the "ON");
- 2) . Paste the double-side adhesive tape to the wireless transmitter and magnetic block.
- 3) . According to the mounting diagram, mount the door/window detector on the position of the door, window, counter, safe box or drawer, etc.

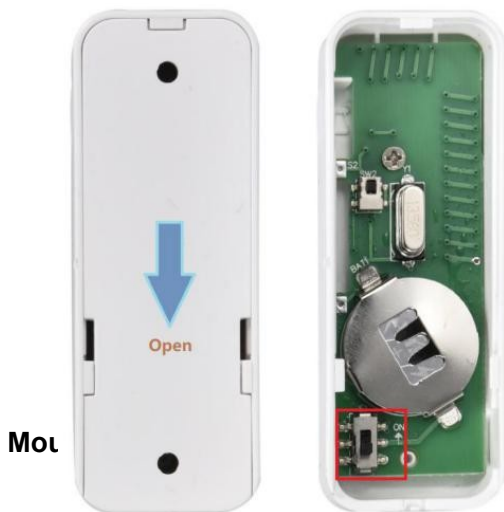

When the door/window detector is triggered, the indicator light flashes quickly: the battery of the door/window detector is low and needs to be replaced. Steps to replace the battery:

1. Unscrew the screw and take out the circuit board;
2. Replace with a new battery (the door/window detector uses a CR2032 battery)



The wireless transmitter is mounted on the door frame and the magnetic block is mounted on the door. In this way, when the user opens the door, the door will separate them and will transmit the alarm signal.



The wireless transmitter is mounted on the window frame and the magnetic block is mounted on the window. In this way, when the user opens the window, the window will separate them and will transmit the alarm signal.

The installation method should conform to the working principles. It is suggested that the position should be tested to confirm that it is correct before mounting it. Not only does the door magnet fit the door and window, but also fits a counter, safe box, and drawer, etc. The user should mount the transmitter somewhere stable as much as possible (door frame and window frame) and mount the magnet patch on the movable part (the door and window) to reduce the chance of it falling off or a shock to the transmitter. **The maximum distance is 15MM between the wireless transmitter and the magnetic block. Over this distance, it will either be an alarm or invalid.**

## 4. Add:

### 4.1 Add Detector and Remote control:

Enter the control interface of the alarm system, select "Accessories", and click the upper right corner "+", enter the countdown and then trigger the detector or the remote control (the indicator light is on, indicating that the trigger is successful), the addition is successful.

**Note: The alarm system automatically distinguishes the detector and the remote control, and there is no need to distinguish the interface when adding.**

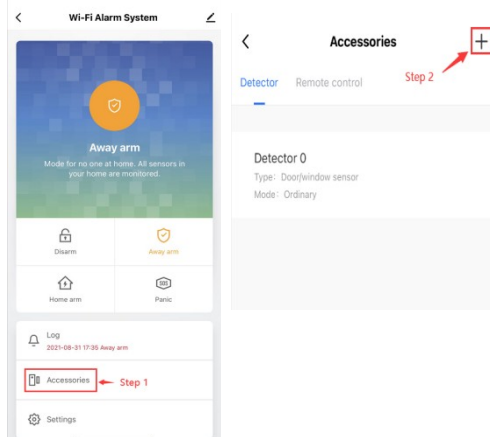

### 4.2 Add Alexa and Google Home:

Enter "Tuya Smart" APP, click "Me", and select the service you need in "Third-Party Voice Services".

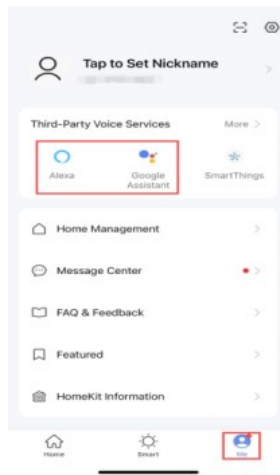

## 5. APP menu explanation:

First-level Menu	Second-level Menu	Three-level menu	Features
Accessories			Including detectors, remote controls and other accessories are edited in this category.
	Detector		Detectors include Door/window detector, Motion Detectors, smoke Detectors, water Detectors, emergency buttons, etc. One alarm system can add up to 100 Detectors.
		Accessory name	Customize the name of the Detector.
		Zone mode	The Detector's defense zone attributes can be Ordinary, Home, 24 Hours; for specific functions, please refer to the "Remote Control" above.
		Equipment Type	The alarm system can automatically identify the detector of this brand (detectors of other brands need to be selected manually).
	Remote control		Remote control interface: An alarm system can be configured with up to 10 remote controls.
		Name	Customize the name of the remote control.
Settings			Function setting interface of alarm system.
	Exit delay		When the system is armed, the HUB starts to count down, and any Detector that is triggered during the countdown will not trigger an alarm. When the countdown is completed, the system starts to arm itself.
	Scheduled arm/disarm		The system automatically arm or disarm within the set time (multiple groups can be set).
	Alarm duration		When the alarm system sounds an alarm, then set the "Alarm duration" to control the ringing time. The factory value is 3 minutes.

	Alarm indicator		Turn on/off the alarm light on the panel of the HUB. After it is turned on, when the alarm system sounds an alarm, the red indicator light on the panel of the HUB will flash.
	Arm/disarm notifications		Turn on/off push messages for arming/disarming the alarm system. After closing, there will be no APP push message for the arming and disarming of the alarm system, but the HUB of the alarm system will have voice prompts for arming/disarming.
	Detector event notifications		Turn on/off the push messages of all Detectors. After turning off, the Detector will be triggered and there will be no APP push messages, but the HUB of the alarm system will have an alarm sound.
	Entry delay		After the detector is triggered, the system starts to count down. During the countdown, the HUB will not sound an alarm; when the countdown is completed, the siren starts to sound an alarm.
	Ticking and voice prompts		Turn on/off the voice and countdown sound of the alarm system. When it turned off, the alarm system will not emit any sound (except for the alarm sound).
	Alarm sound volume		Set the volume of the alarm sound: You can set three levels: High, Low, Mute. When set to Mute, there will be no alarm sound.
	Factory reset		Restore factory settings: All detectors and remote controls will be deleted.
	Hub language		The voice switch of the alarm system can switch different national languages according to different countries. Support 11 languages.
	Virtual password		Only used for Google Home; when the alarm system is disarmed, Google Home will ask for this password.

## 6. Maintenance and Troubleshooting :

---

- Keep this product and accessories out of children's reach.
- Keep the product and accessories dry. Rainwater, moisture and liquids are likely to contain minerals that will corrode electronic circuits.
- Do not use or store the system in dusty or dirty places, other wise it may damage the electronic components.
- Do not expose the system to high temperature. High temperatures can shorten the life of electronic components, damage batteries, and cause melting deformation of plastic parts.
- Do not store the system in cold areas. Otherwise, when the temperature of the alarm system rises to the normal level, moisture appears inside, damaging PCB.
- The hub doesn't respond to APP operation.
  - a). Check whether the local network is working.
  - b). Make sure the smart phone is connected to internet.
- Remote control doesn't work.
  - a). Check if the remote control has been paired to the smart hub.
  - b). The distance between the smart hub and remote control is too far away.
- The hub cannot respond to detector.
  - a). Check whether the system is armed; b). Check if the detector has been paired to the hub; c). Check if the detector is far away from the hub.
- Fail to connect the hub to the router.
  - a). Make sure the hub is under AP mode and you smart phone is connected to the hub during Wi-Fi setting.

b).Reset the hub and try it again.

## 7. Appendix of Technical Parameters:

### 7.1 Hub:

Power Supply	Backup Battery	Consumption	Siren Output
Micro USB 110/220VAC to 5V, 1000mA	3.7V, 500mAh Rechargeable Battery	<55mA@normal	<500mA
Radio Frequency	WiFi Standard	Operation Temperature	Alarm loudness
433Mhz	2.4GHz	0~55℃	100DB

### 7.2 Remote:

Power Supply	Standby Current	Alarm Current	Radio Frequency
DC 3V (CR2025 Lithium Battery x1)	<5uA	<15mA	433Mhz
Transmitting Distance		Operation Temperature	
<80m (Open Area and No Interference)		0~55℃	

### 7.3 Door/Window detector:

Power Supply	Standby Current	Alarm Current	Radio Frequency
DC 3V (CR2032 Lithium Battery x1)	<8uA	<15mA	433Mhz
Transmitting Distance		Operation Temperature	
<80m (Open Area and No Interference)		0~55℃	



## FCC Warning

This device complies with part 15 of the FCC Rules. Operation is subject to the following two conditions:(1) This device may not cause harmful interference, and (2) this device must accept any interference received, including interference that may cause undesired operation.

Any Changes or modifications not expressly approved by the party responsible for compliance could void the user's authority to operate the equipment.

This equipment has been tested and found to comply with the limits for a Class B digital device, pursuant to part 15 of the FCC Rules. These limits are designed to provide reasonable protection against harmful interference in a residential installation. This equipment generates uses and can

radiate radio frequency energy and, if not installed and used in accordance with the instructions, may cause harmful interference to radio communications. However, there is no guarantee that interference will not occur in a particular installation. If this equipment does cause harmful interference to radio or television reception, which can be determined by turning the equipment off and on, the user is encouraged to try to correct the interference by one or more of the following measures:

- Reorient or relocate the receiving antenna.
- Increase the separation between the equipment and receiver.
- Connect the equipment into an outlet on a circuit different from that to which the receiver is connected.

- Consult the dealer or an experienced radio/TV technician for help.

#### FCC RF exposure statement:

The equipment complies with FCC radiation exposure limits set forth for an uncontrolled environment. This equipment should be installed and operated with minimum distance between 20cm the radiator your body.