

LED MAGIC COLOR DESKTOP LIGHTS

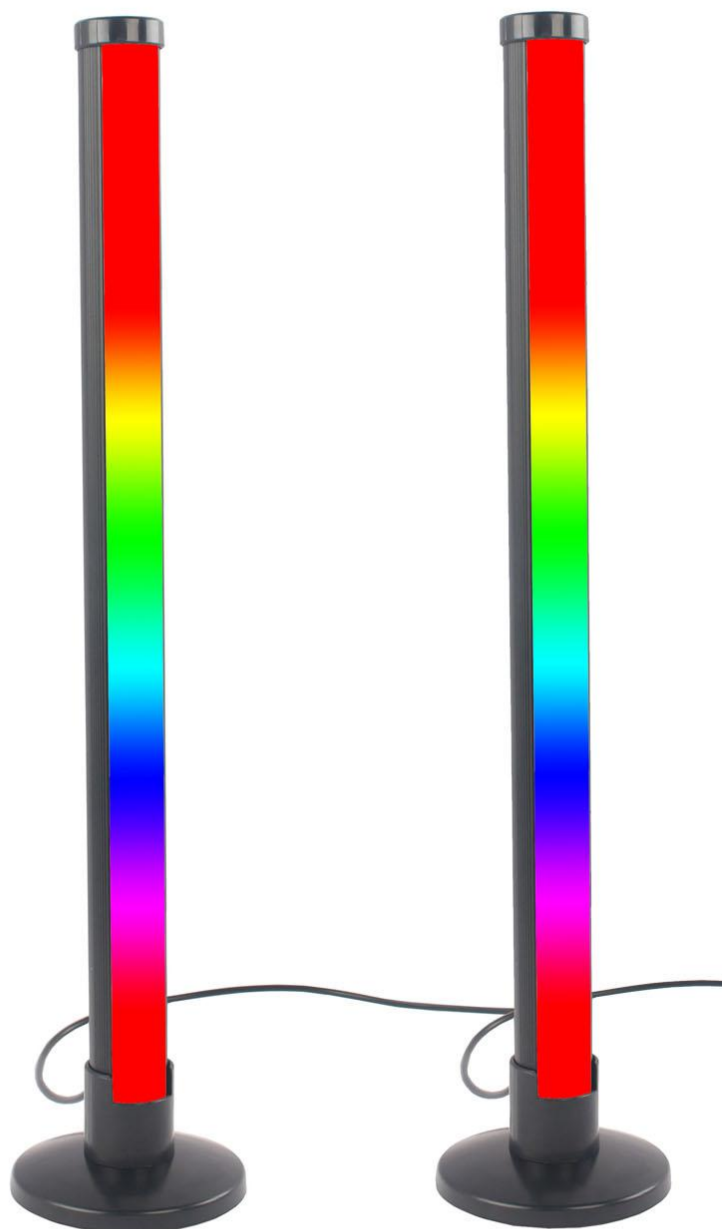

USER MANUAL

This device complies with Part 15 of the FCC Rules. Operation is subject to the following two conditions: (1) this device may not cause harmful interference, and (2) this device must accept any interference received, including interference that may cause undesired operation

NOTE: This equipment has been tested and found to comply with the limits for a Class B digital device, pursuant to Part 15 of the FCC Rules. These limits are designed to provide reasonable protection against harmful interference in a residential installation. This equipment generates, uses and can radiate radio frequency energy and, if not installed and used in accordance with the instructions, may cause harmful interference to radio communications. However, there is no guarantee that

interference will not occur in a particular installation.

If this equipment does cause harmful interference to radio or television reception, which can be determined by turning the equipment off and on, the user is encouraged to try to correct the interference by one or more of the following measures:

- Reorient or relocate the receiving antenna.
- Increase the separation between the equipment and receiver.
- Connect the equipment into an outlet on a circuit different from that to which the receiver is connected.
- Consult the dealer or an experienced radio/TV technician for help.

Warning: changes or modifications not expressly approved by the party responsible for compliance could void the user's authority to operate the equipment

The device has been evaluated to meet general RF exposure requirement, the device can be used in portable exposure condition without restriction

Installation diagram:

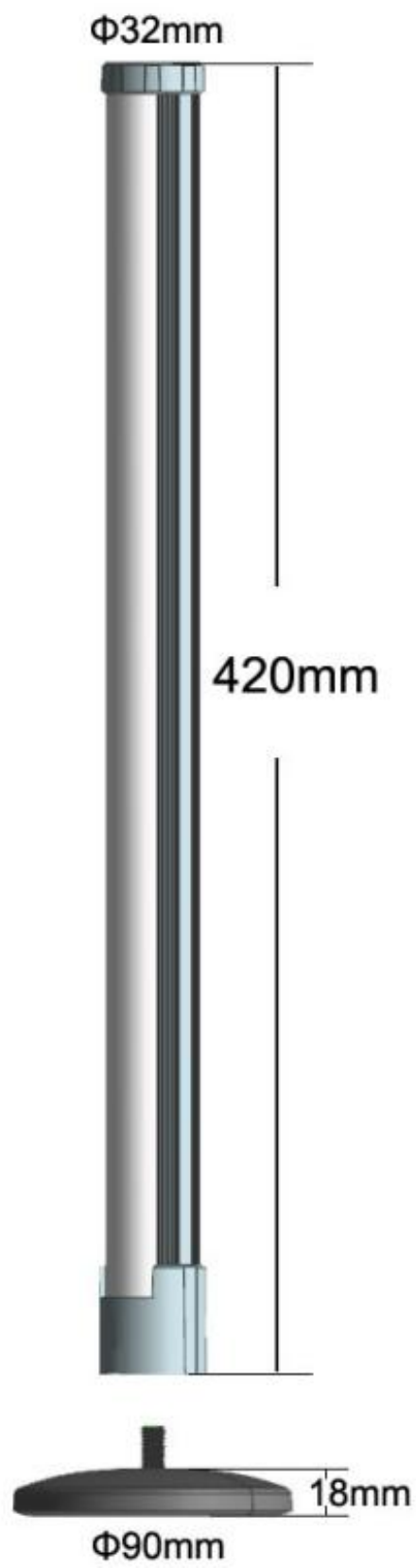

Product List:

- Receiving controller



- Base x2



- LAMP x2



- Remote Control x1

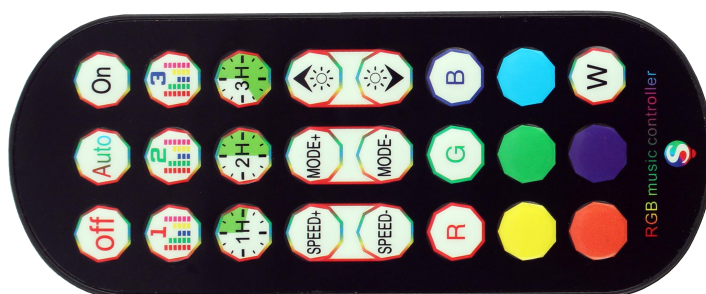

Instructions for the receiving controller

USB:5V/2A



Mode Switching
Switch
Music mode

You need to pay attention:

- Working temperature: -10~50°C
- Input Volt.: 4.5~5.2V / $\geq 2A$
- Remote control distance: 10~20meters.
- Remote control: Advanced RF / 2.4G technology

Instructions for Remote Control:

The remote has 24 buttons

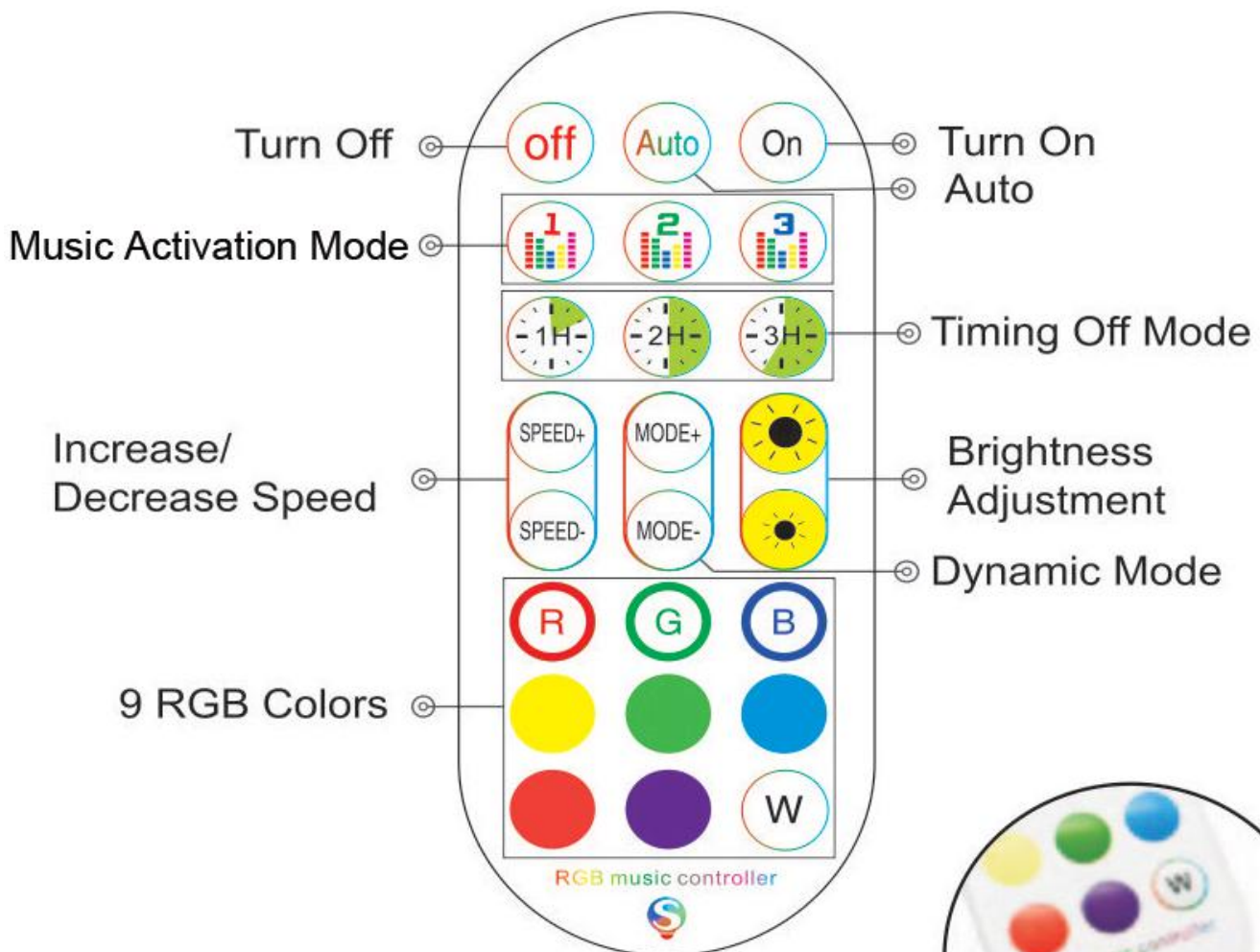

Plastic film

Note:

- 1: Don't set it arbitrarily, otherwise the corresponding color will be changed, such as red to blue
- 2: If the remote control is out of control, please check if it is locked or check its battery.
- 3: Remove the plastic film before use.

Instructions for use of led controller:

ios and android systems can download the APP by scanning the QR code.

open the browser or other tools with "scan QR code" function,scan the QR code as below:

Use your phone to scan the QR code



APP download

APP Installation steps

Click DuoCol StripX on the APP icon enter the app page.

After entering the App interface, if bluetooth is not enabled, an application wants to enable the bluetooth function of this device click allow



- 1: Connect the lamp to power.
- 2: Turn on the Bluetooth function of the mobile phone, scan the code on the receiver Box, download the APP of the mobile phone, or use the remote control to operate directly.
- 3: The product uses USB cable 5V/2A, can connect any USB port power supply, convenient, stable and safe.

Note:

- (1) Check if the power supply is normal.
- (2) Check if the Bluetooth is turned on.
- (3) Check if there are other mobile phones connected, only support connections one to many, does not support many to many.
- (4) Check APP Bluetooth setting if the phone is connected to the device, if connected, exit the APP and reopen, the APP will go to connect automatically.
- (5) Normal operations and cannot connect, please exit the APP and reopen.
- (6) Exit APP, restart mobile phone, power on the strip light, reopen the APP, then they will connect

automatically.

5

App Instructions:

- 1: Enter the mobile APP interface and open the upper right corner Settings to view Guide. You'll have all the instructions here.
- 2: Please do not change the "Modify Pin Sequence", Otherwise will change the corresponding color. For example: choosing blue shows red.

Click to show the lamp list,view lamp list:

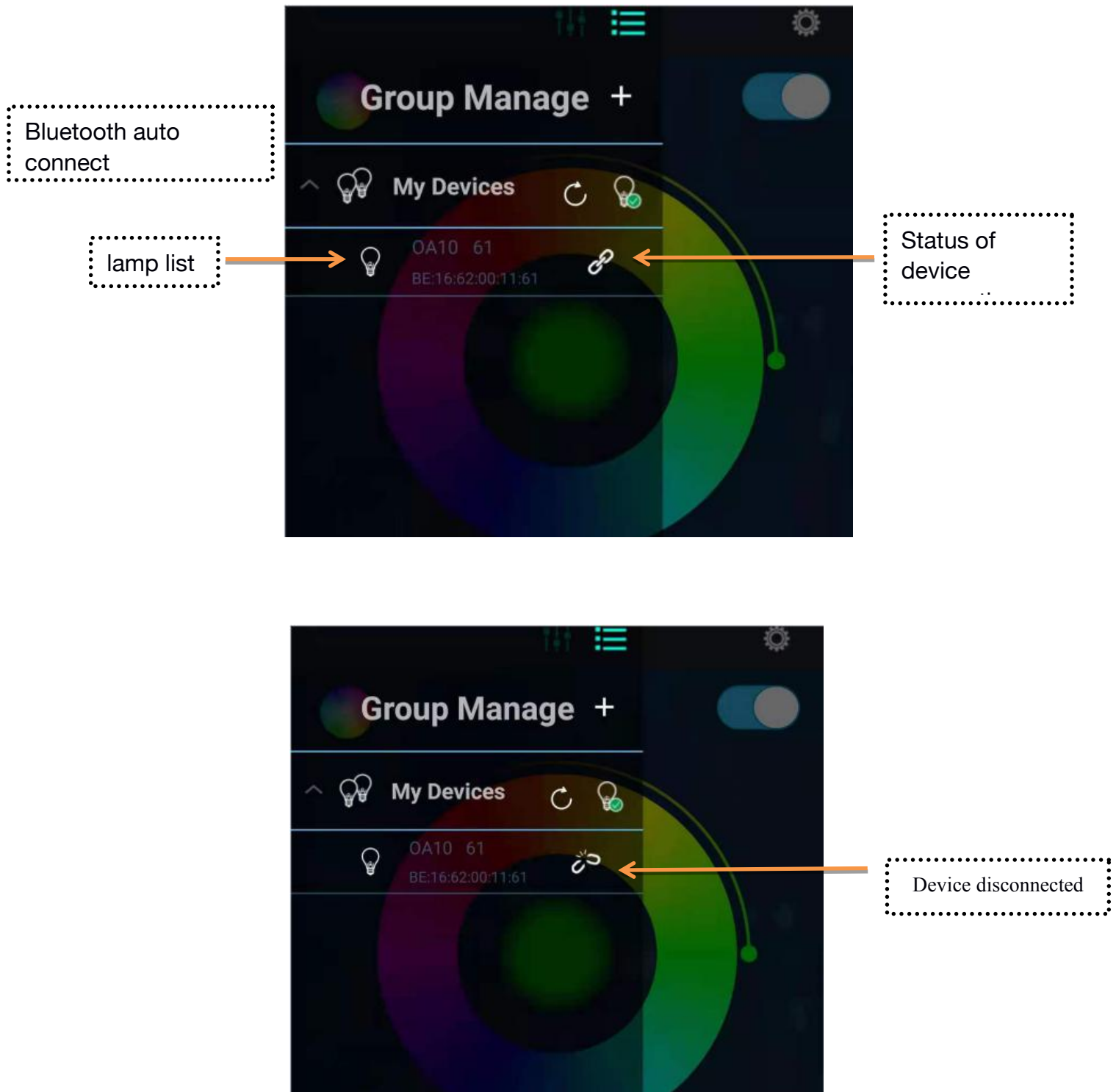

Switch to color and brightness interface:

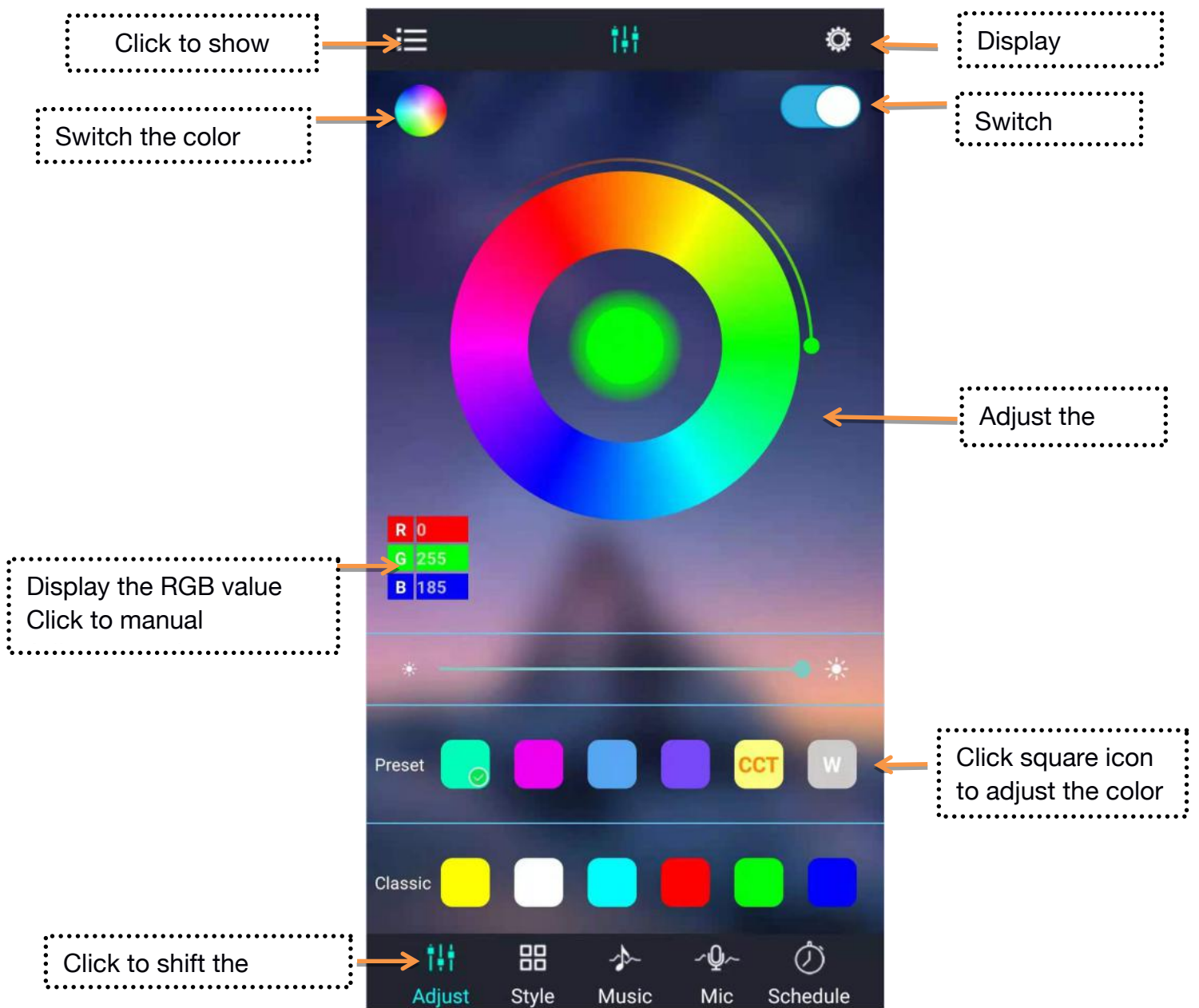

Click to RGB manual adjustment view:

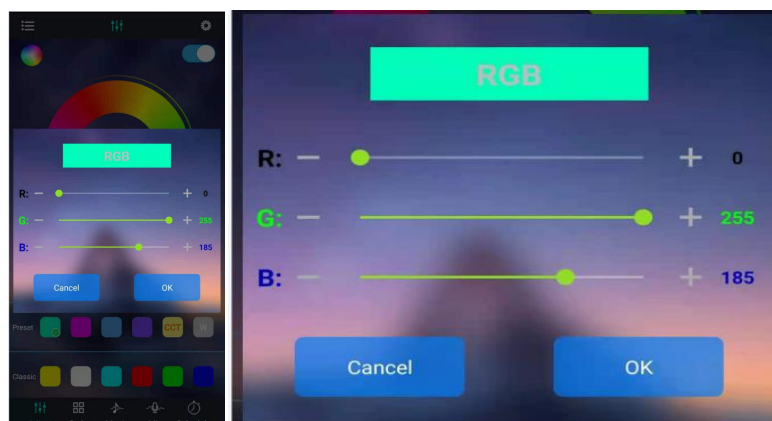

Switch to the mode interface:

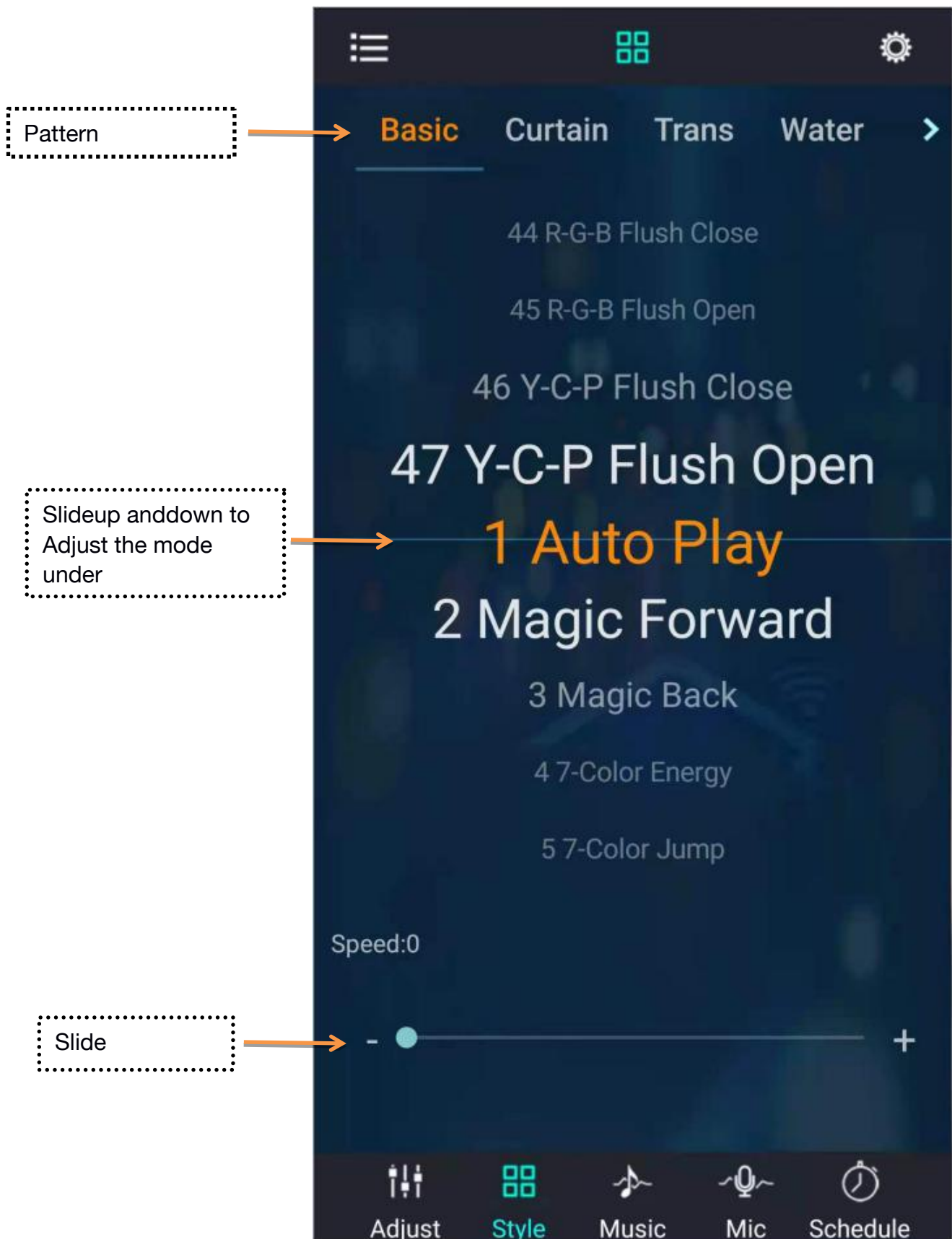

Switch to the music rhythm interface:

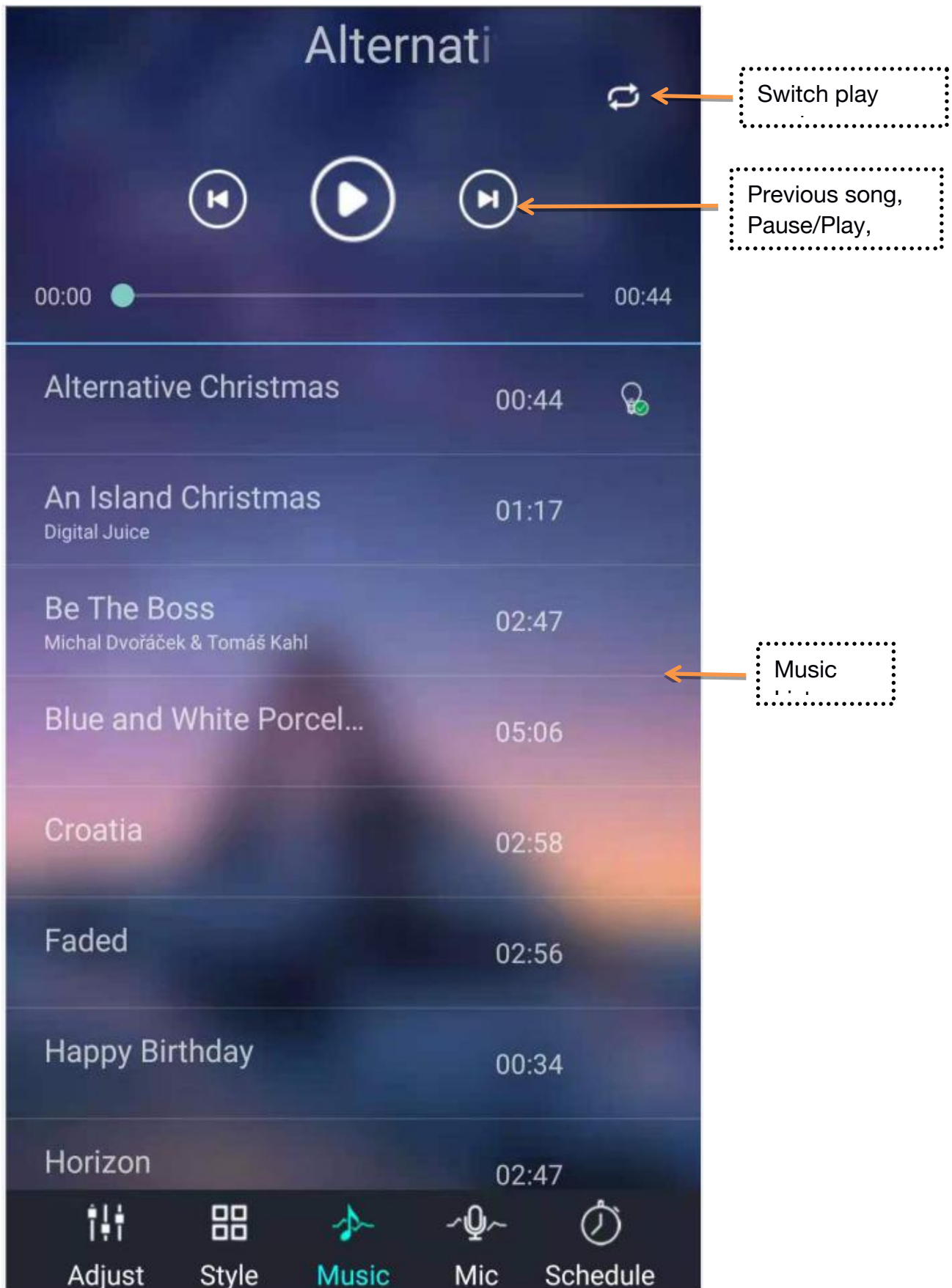

Switch to the microphone rhythm interface:

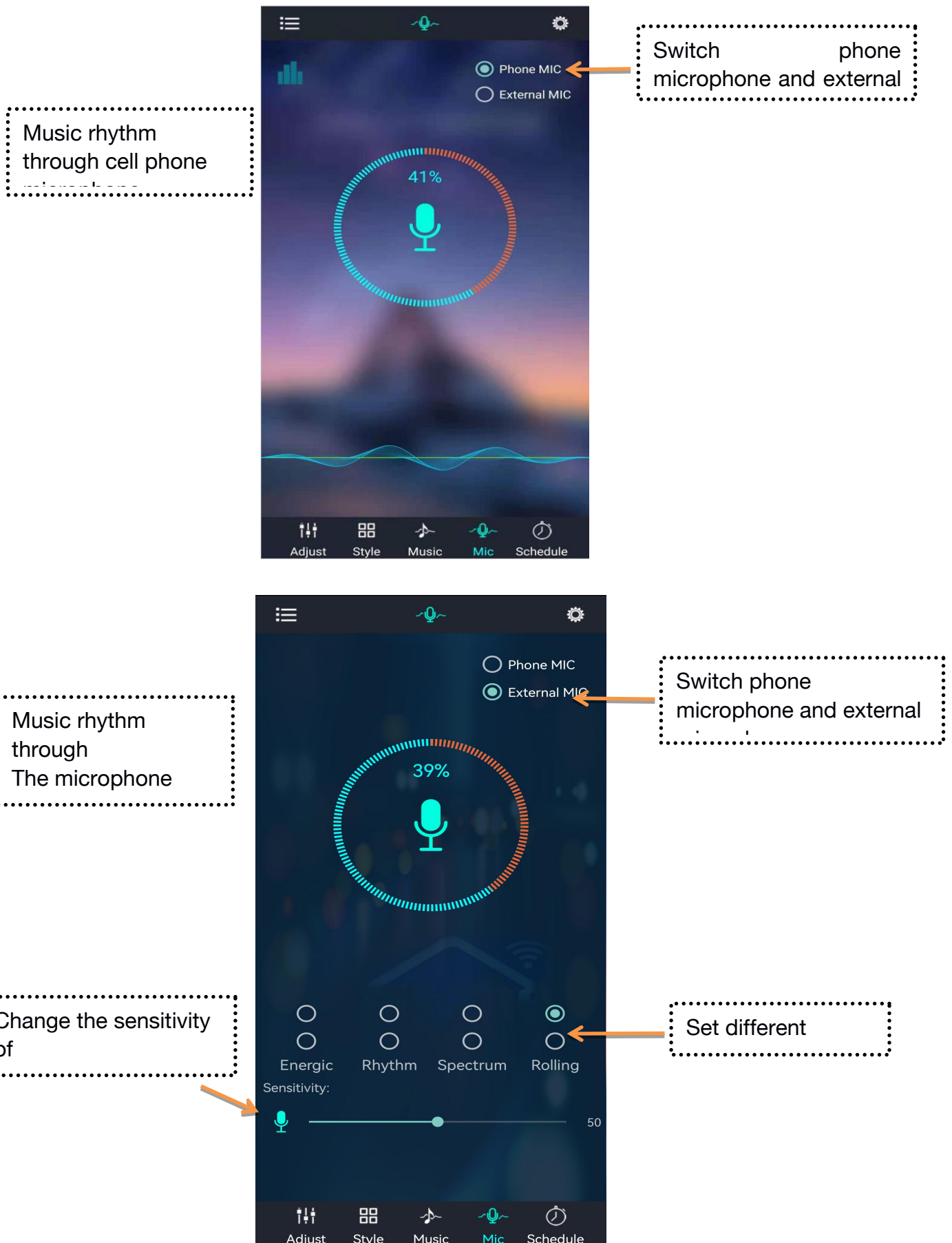

Switch to the timing interface:

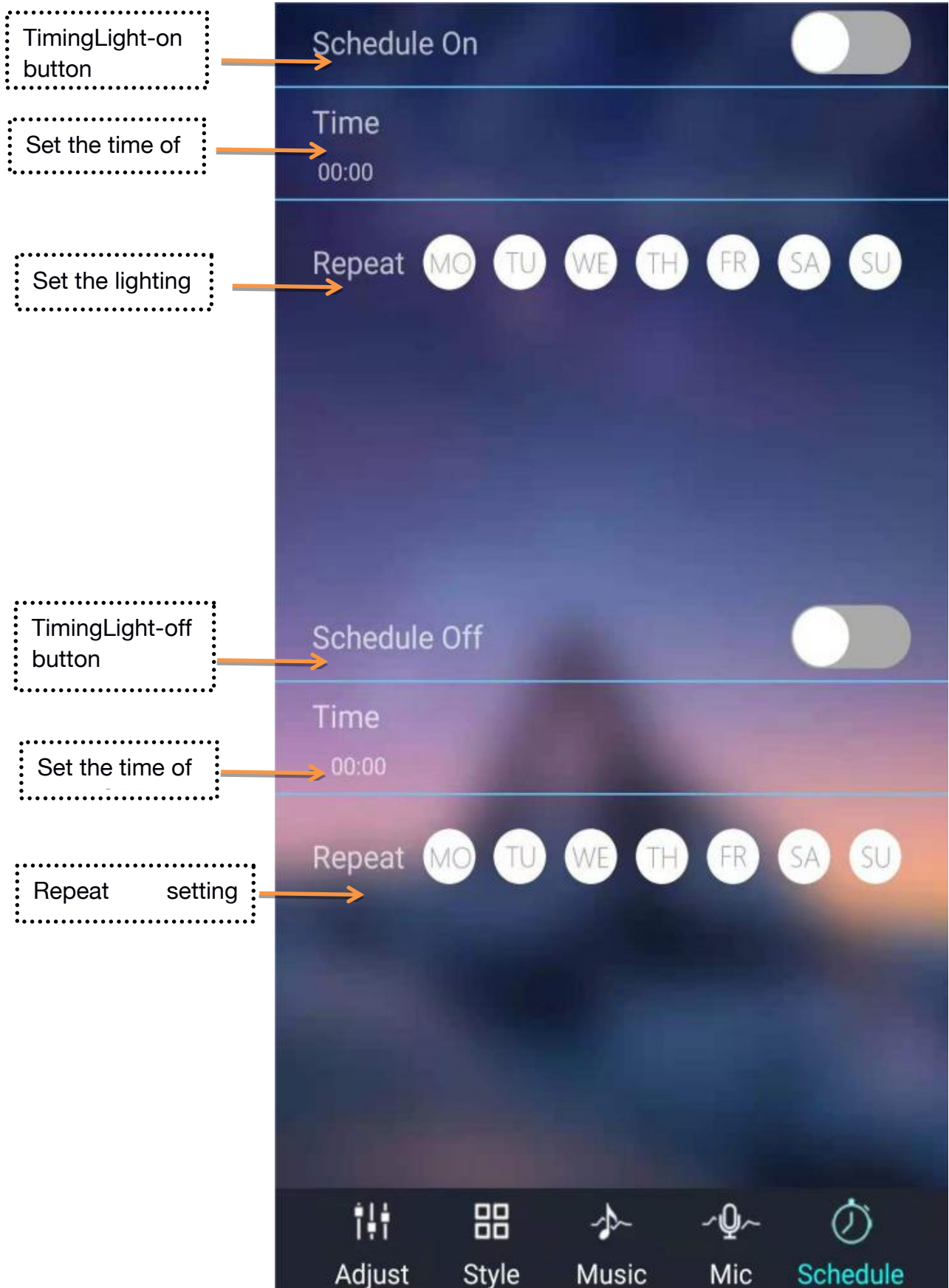

Switch to the setting interface:

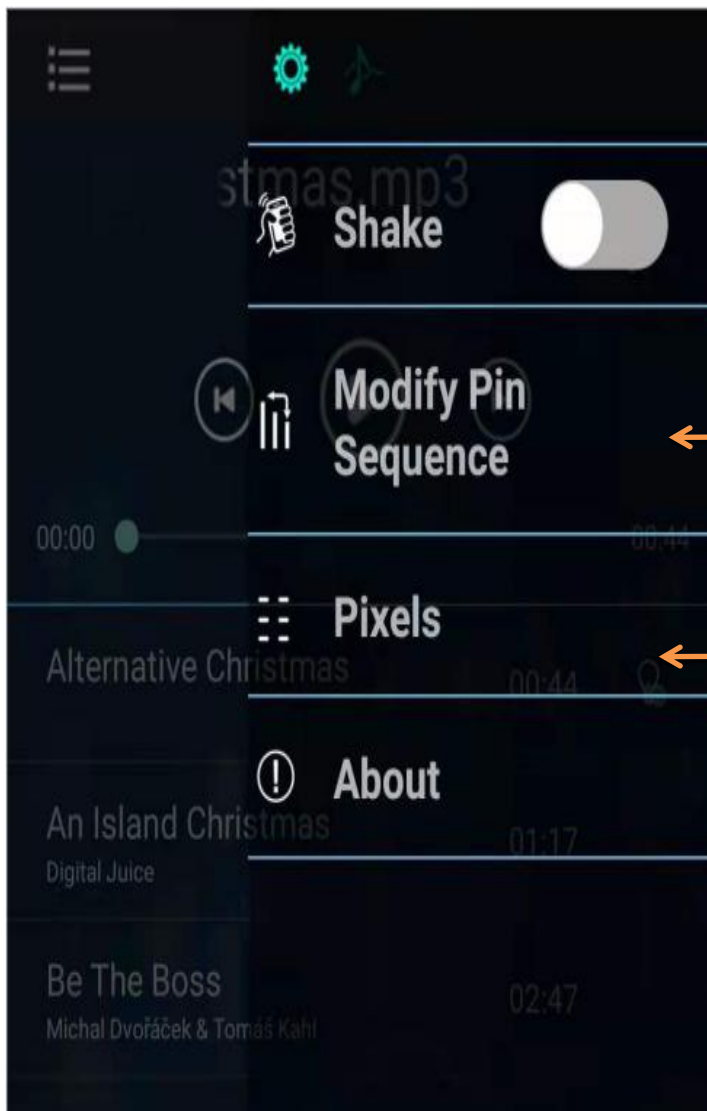

RGB color

The number of points corresponds to the number of light sources of the luminaire.

*Do not change the settings at will

if you change it, it will affect the normal use of the product:

- 1: The color should not match the remote control.
- 2: The change of the number of points will affect the dynamic effect of the light.

If you have any question after receiving the products, please contact

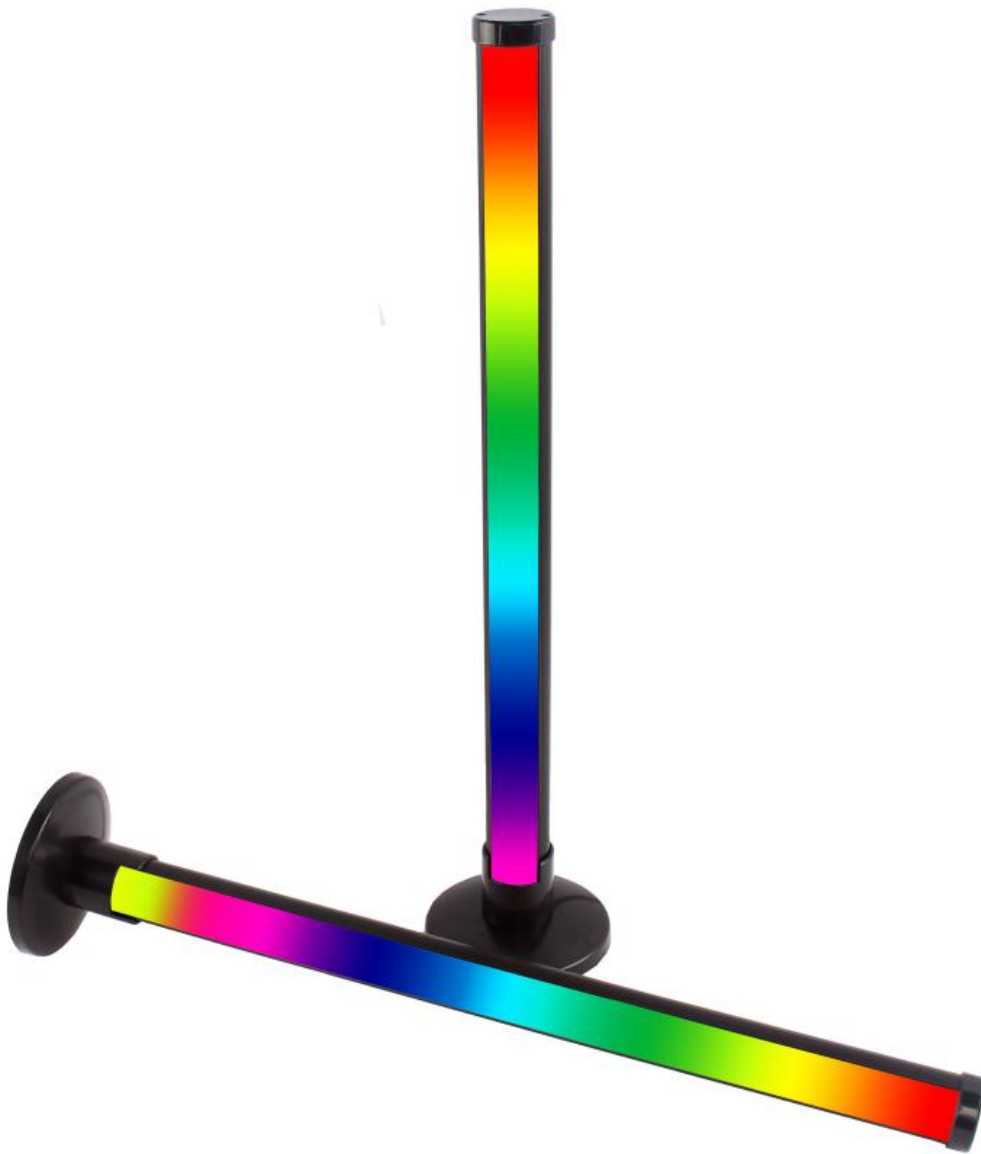

Thank you for buying this product.

To Provide an excellent user experience,
please install it according to these instructions and then give the
instructions to appropriate person for retention and future reference.

UK
CA

CE

RoHS

FC



