

## 1.Home Screen

Including two main functions,the RGB Slider and the Brightness Control.The color is quite easily changed by sliding the wheel around the RGB circle to the desired color.The current color will appear in the center circle.

The Brightness Color can be adjusted via the slider below.

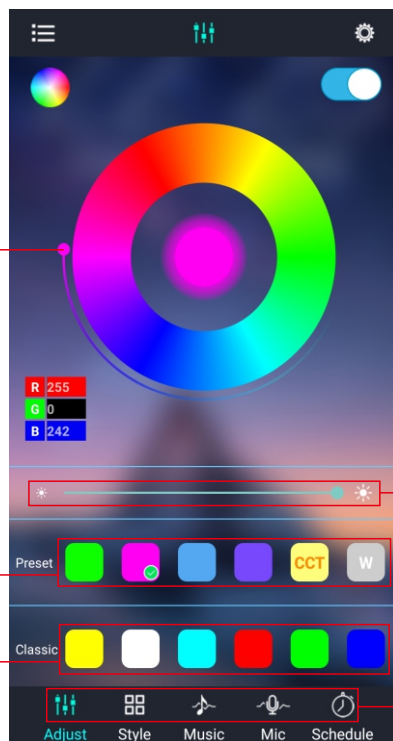

Your frequently used colors will appear and save in the top 'Preset' bar.

At the bottom of the screen you will find the functions menu. These will alter the characteristics of the RGB LED Light.

## 2. Group Manage

Make sure your phone or device is successfully connected with the RGB LED Light.

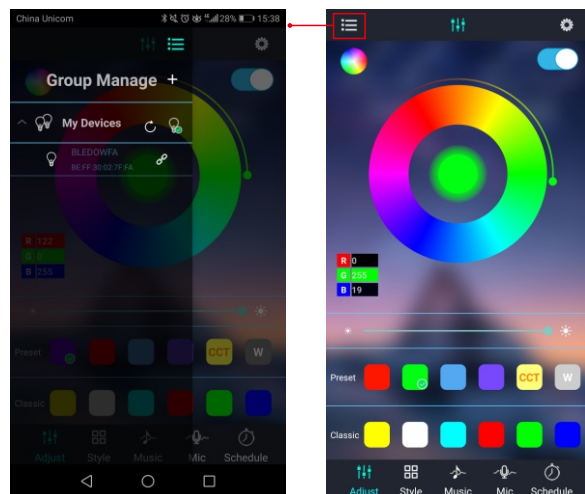

## 3. Shake Selection

The shake feature will randomly select a color everytime you shake your phone.

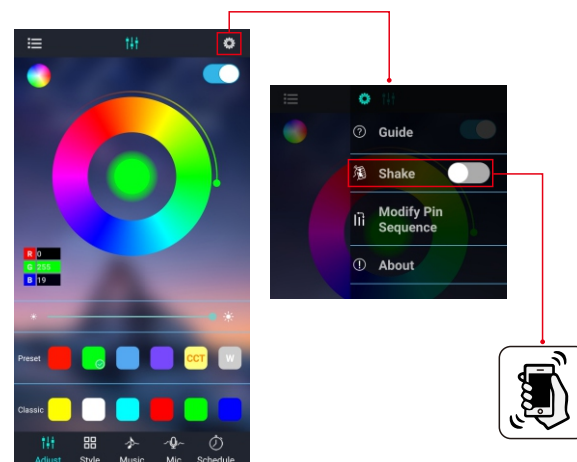

## 4. Modify Pin Sequence

1. Select to set up a new color setting.
2. Click to save on when selection completed.

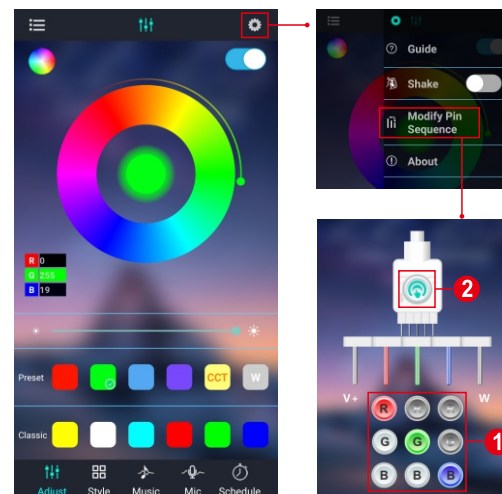

## 5. RGB Value Setup

1. Click to open the interface of the RGB Value Setup.
2. Slide the R - G - B progress bar to change the RGB value.
3. Or press the button minus '-' or plus '+' to change the RGB value.
4. Click 'Cancel' or 'OK' when setup completed.

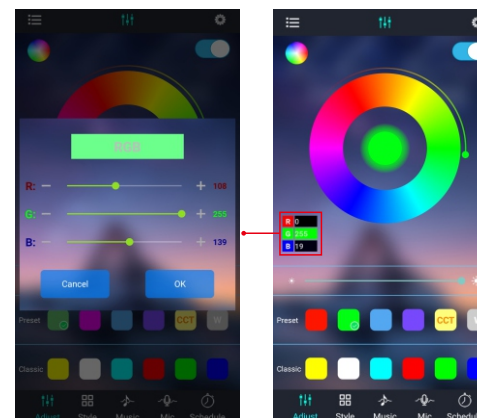

## 6. Style

This Style Interface has a variety of functions, including Static colors, Color Jumping Change, Color Cross Fade and etc.

Below is a slider progress bar that will adjust the rate in which the selected function will operate at.

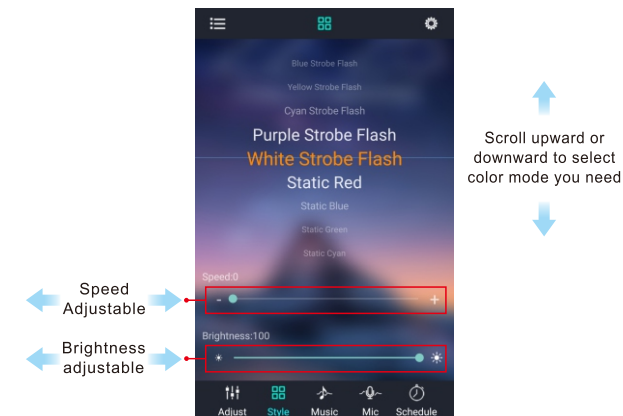

## 7. Music

Select the Music mode to play music with the RGB LED Light. The brightness and colors will randomly changed base on the music.

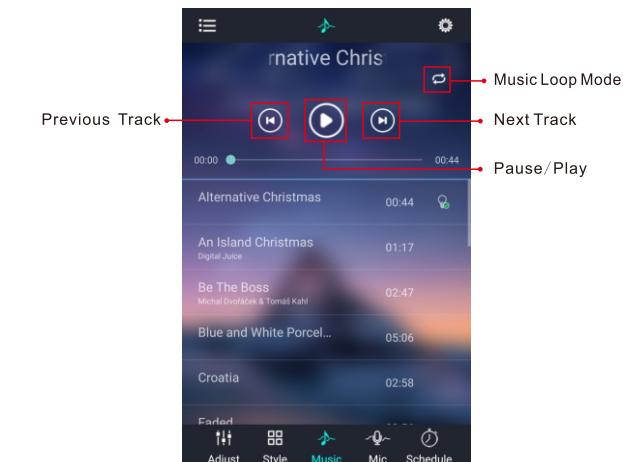

⚠ Thank you for purchasing our products; your satisfaction is very important to us. If you have any questions regarding this product, please feel free to contact us.

This Lotus Lantern App allows you to interact, customized and control your RGB LED Light. Using bluetooth wireless technology change the colors and brightness of your RGB LED Light all from your smart phone. Additionally, take advantage of our schedule, music to light sync, shake to random colors and other features that are continuously introduced.

Note:  
Before instillation of this App - Lotus Lantern, please check with your phone or device and make sure which operation system is **Android 4.3 or iOS 9.0 above**.

Remote control range distance is within 10 meters.

Step 1:  
After installing your RGB LED Light, download & install 'Lotus Lantern' from Apple Store or Google Play Store or scan the QR code below.

Step 2:  
Once installed turn ON your phone's bluetooth and open the 'Lotus Lantern' App.



Android 4.3 or iOS 9.0 above

## 8. Phone MIC

Voice control and music are also options that are able to be selected to alter the characteristics of the RGB LED Light, adjusting the brightness in sync with the volume of the selected audio input from Phone or External MIC.

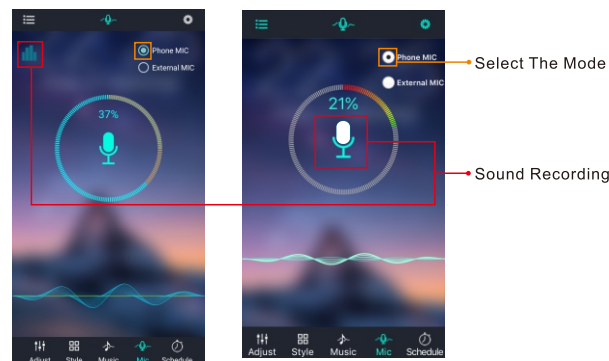

Android

iOS

## 9. External MIC

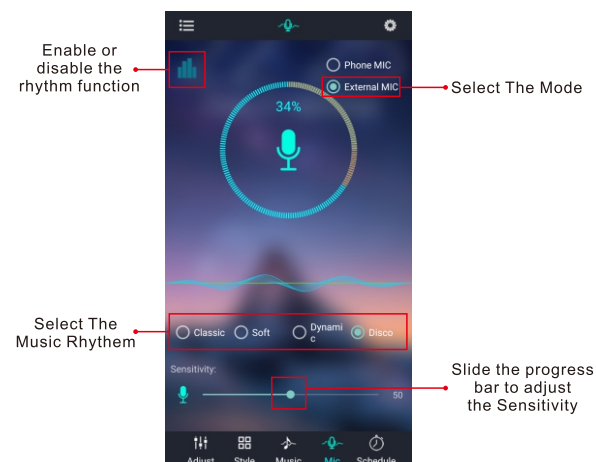

## 10. Schedule

This Schedule Interface will allow you to set alarms that once reached will turn the RGB LED Light on or off.

To set a specific run period just set a time to switch on and a separate time after which will turn the off.

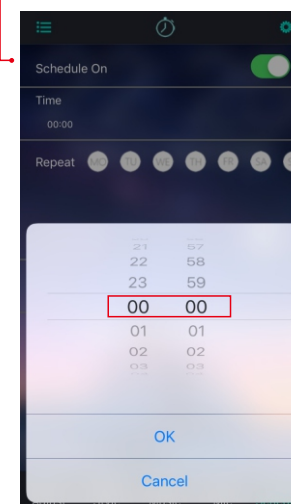
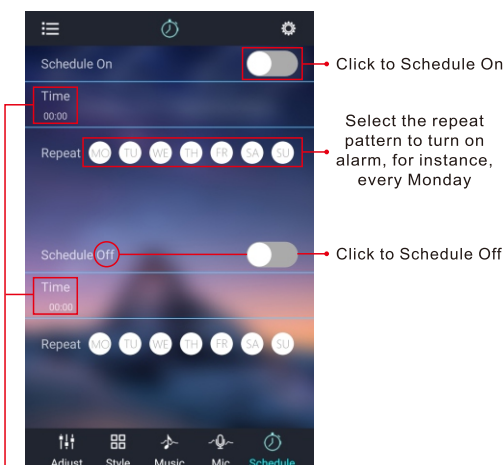

Scroll upward or  
downward to set up  
the alarm you need



# Lotus Lantern APP User Guide



This device complies with Part 15 of the FCC Rules. Operation is subject to the following two conditions: (1) this device may not cause harmful interference, and (2) this device must accept any interference received, including interference that may cause undesired operation

NOTE: This equipment has been tested and found to comply with the limits for a Class B digital device, pursuant to Part 15 of the FCC Rules. These limits are designed to provide reasonable protection against harmful interference in a residential installation. This equipment generates, uses and can radiate radio frequency energy and, if not installed and used in accordance with the instructions, may cause harmful interference to radio communications. However, there is no guarantee that interference will not occur in a particular installation.

If this equipment does cause harmful interference to radio or television reception, which can be determined by turning the equipment off and on, the user is encouraged to try to correct the interference by one or more of the following measures:

- Reorient or relocate the receiving antenna.
- Increase the separation between the equipment and receiver.
- Connect the equipment into an outlet on a circuit different from that to which the receiver is connected.
- Consult the dealer or an experienced radio/TV technician for help.

Warning: changes or modifications not expressly approved by the party responsible for compliance could void the user's authority to operate the equipment