

## About the Guide

- This manual is for reference only. The operation of the actual product shall prevail if there is any inconsistency.
- All the designs and software are subject to change without prior written notice.
- All trademarks and registered trademarks mentioned are the properties of their respective owners.
- Please visit our website or contact your local customer service if there is any problem when using the device.
- If there is any uncertainty or controversy, we reserve the right of final explanation.

## Functions

Function	Description
Video Resolution	2160P, 1440P, 1080P (Optional)
Time-lapse Photography	Record by time-lapse photography at 1 fps when vehicle stops.
Parking Mode	Lock video of collision during parking and the sensitivity is optional.
Collision Detection	Lock video of collision during driving and the sensitivity is optional.
File Browsing	View videos, locked videos and images.
Recording Time	Time of recording files. You can select from 1, 2 and 3 minutes.
Screen Setup	Close. Screen off time can be 1 or 2 minutes.
Audio Recording	Enable or disable audio recording.
Date&Time	Adjust date and time.
Volume	Adjust volume.
Button Sound	Enable or disable button sound.
Time Zone	Adjust time zone.
Light Source	50HZ, 60HZ (Optional)
System Reset	Restore factory settings
Delete Files	Select files and select it.
Format	Format the TF card.

## Technical Specification

Parameter	Description
Sensor	1/2.9 inch CMOS
Effective Pixels	2560 (H)×1440 (V)
Frame Rate	400 W
Screen Resolution	480 × 854
Screen Size	3 inch
Frame Rate	2K@30fps
Iris	F2.2
Field of View	123°
Code	H.265
Audio Input	Built-in MIC
Audio Output	Built-in 1 speaker
Storage	1 TF card port, supports max 128G.
Vehicle Detection	G-Sensor
Power Consumption	≤ 5W
Operating Temperature	-20°C to +70°C (-4°F to +158°C )
Operating Humidity	< 95% (non-condensing)
Protection Grade	IP52

## FAQ

If some functions do not work properly or the relevant setting values are changed, try restarting the camera or restoring the factory settings.

### ► Q: Low power/settings not saved/automatic shutdown when start the vehicle? camera

- Remove the memory card, start the camera for charging for 4 hours.
- Contact manufacturer and return the camera to the factory to replace the battery.

### ► Q: Memory card full?

- Format or change the memory card.
- Adjust the “gravity sensing” to low, and format the memory card once a month.

### ► Q: Memory card error?

Format or change the memory card.

### ► Q: Please insert a SD card/SD card is not detected?

Memory card is damaged; low read/write speed; memory card is not compatible with the camera; no card; replace it with a genuine high-speed TF card.

### ► Q: Unable to play video / file corrupted?

- Please check whether the file name or folder name has been changed on the computer.
- This camera cannot guarantee the normal playback of active images that have been post processed by the computer or not taken by this camera.
- The memory card is damaged, please replace it.

### ► Q: Camera crashes?

- Restart or reset system.
- Remove the memory card.
- Contact the manufacturer for repair.

### ► Q: Camera can not be powered on?

- Check whether the power cable is connected normally.
- Start the camera without memory card .
- Connect the camera to the computer and start it.
- Reset system.

# Imou

## Quick Start Guide

### Dash Camera S400

Version 1.0.0

## Packing List

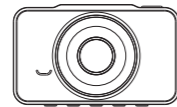

Dash Camera×1



Car Charger×1



Electrostatic Stickers×1



Bracket×1



Quick Start Guide×1



Power Cable×1

## Camera Introduction

Cut off the power supply before installing TF card.

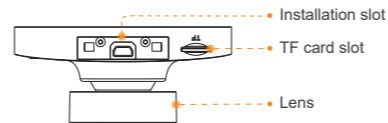

Installation slot

TF card slot

Lens

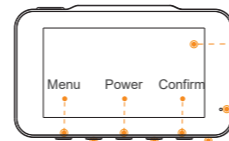

Screen

Menu Power Confirm

Indicator light

Up Down Speaker

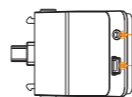

Peripheral port

Power port

## Operating with App

Download and register the App

- 1 Scan the following QR code to download and install the App.



iOS



Android

- 2 Run the App, select and connect Wi-Fi of the camera.
- 3 After successful connection to the camera, you can set parameters and real-time preview video.

### Factory Default Information

Wi-Fi: Imou-xxxxxx (The last 6 digits of serial number)

Password: 12345678

## Installing Camera

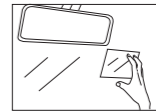

- 1 Wipe the front windshield clean. Stick the electrostatic paste on the glass and ensure that it is free of bubbles.

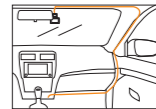

- 3 Tear off the 3M glue on the bracket, paste the camera on the electrostatic paste, and lay cable as shown in the figure.

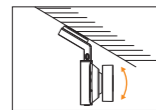

- 5 Adjust the lens to the appropriate angle, and the installation is completed.

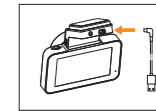

- 2 Install the bracket on the camera along the installation slot, and insert one end of the power cable into the power port.

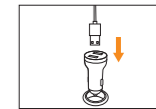

- 4 Insert the car charger into the cigarette lighter and connect the power cable of the camera.

**FCC Statement**

This equipment has been tested and found to comply with the limits for a Class B digital device, pursuant to part 15 of the FCC rules. These limits are designed to provide reasonable protection against harmful interference in a residential installation. This equipment generates, uses and can radiate radio frequency energy and, if not installed and used in accordance with the instructions, may cause harmful interference to radio communications. However, there is no guarantee that interference will not occur in a particular installation. If this equipment does cause harmful interference to radio or television reception, which can be determined by turning the equipment off and on, the user is encouraged to try to correct the interference by one or more of the following measures:

-Reorient or relocate the receiving antenna.

-Increase the separation between the equipment and receiver.

-Connect the equipment into an outlet on a circuit different from that to which the receiver is connected.

-Consult the dealer or an experienced radio/TV technician for help.

To assure continued compliance, any changes or modifications not expressly approved by the party.

Responsible for compliance could void the user's authority to operate this equipment. (Example- use only shielded interface cables when connecting to computer or peripheral devices).

This equipment complies with Part 15 of the FCC Rules. Operation is subject to the following two conditions:

(1) This device may not cause harmful interference, and

(2) This device must accept any interference received, including interference that may cause undesired operation.

**Radiation Exposure Statement**

The device has been evaluated to meet general RF exposure requirement.

The device can be used in portable exposure condition without restriction.