

尺寸: 70X100mm  
 材质: 105g双铜纸  
 工艺: 风琴折页, 单黑印刷

封面

# USER MANUAL

For more details, please consult online customer service.

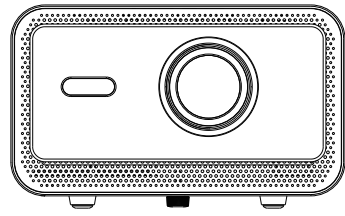

**HDMI** The terms HDMI, HDMI High-Definition Multimedia Interface, and the HDMI Logo are trademarks or registered trademarks of HDMI Licensing Administrator, Inc.

**Notice** Please read this user manual carefully before use.

## Safety Tips

- For the best viewing effect, please use the projector in dark room.
- Do not install this projector in the area which directly blown by the air conditioner, to prevent projector failed caused by water vapor condensation or excessive temperature.
  - Ensure that the environment is ventilated to prevent overheat caused by heats build-up.
  - Prevent foreign objects from falling into the machine. Never insert any metal objects into the machine. If foreign objects fall into the machine accidentally, please power off immediately and seek professional assistance.
  - Do not place any liquid on the machine to avoid leakage.
  - Avoid violent vibrations when transporting. Please protect the lens from wear.
  - Do not touch the vents when using the projector to avoid burns due to excessive temperature.
  - Do not look directly at the lens while the projector is running to prevent eye injury.
  - Please clean the filter regularly to prevent malfunction caused by clogging.

### Notice

Do not open the case of projector to prevent electric shock. Please seek professional assistance for maintenance matters.

### Warn

Do not touch! The inside of the projector contains uninsulated voltage.

### Warn

Do not install the projector around flammable objects to prevent fire.

1

## Safety Tips

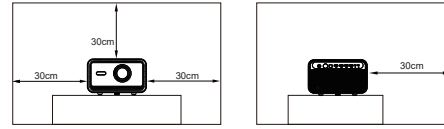

To ensure the performance and stability of the projector, please place it horizontally and leave a space of about 30cm between the projector and the wall.

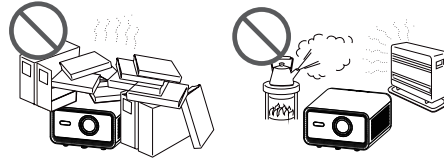

Do not install in place with poor ventilation.

Do not install in high temperature or humid places.

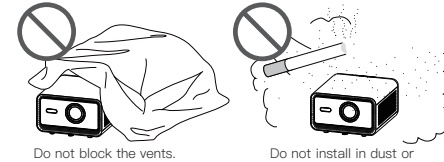

Do not block the vents.

Do not install in dust or smoky places.

2

## Specifications

Item	Specification
Product	HA110-B
Native Resolution	1920x1080
Projection Technology	LCD Display
Lamp Type	LED Lamp
WiFi	Dual Band WiFi 2.4/5GHz
BT	BT 5.0
Ethernet	100Mbps
Interface	HD: HD IN*2 USB: USB 2.0 Port*2 Earphone: 3.5mm Audio Port *1 LAN: LAN IN*1 AV: AV IN*1
<b>Environment</b>	
Power Input	AC 100-240V 50-60HZ
Operating Temperature	0 ~ 30°C
Storage Temperature	-20 ~ 65°C
Operating Humidity	0 ~ 90% Non-condensing

## 1 Package Contents

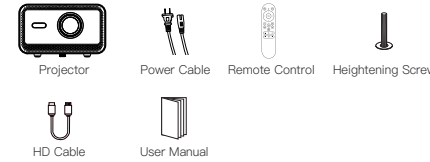

3

## Projector Introduction

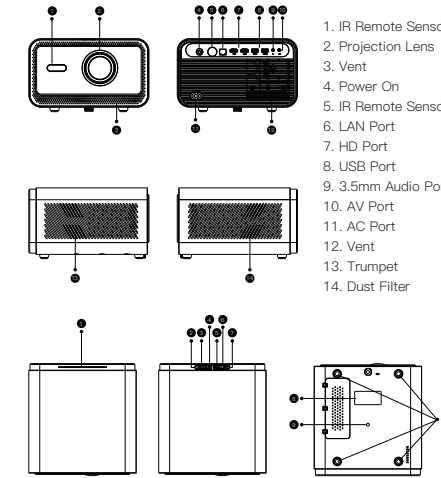

- IR Remote Sensor
- Projection Lens
- Vent
- Power On
- IR Remote Sensor
- LAN Port
- HD Port
- USB Port
- 3.5mm Audio Port
- AV Port
- AC Port
- Vent
- Trumpet
- Dust Filter

- Light Bar
- Left
- Right
- Return
- Power On/OK
- Up
- Down
- Dust-removal Hole
- Wall-mount Hole
- Lifting Hole \* 4 (Foot pad needs to be removed)

The appearance of the projector may vary, please refer to the actual product.

4

## Remote Control Introduction

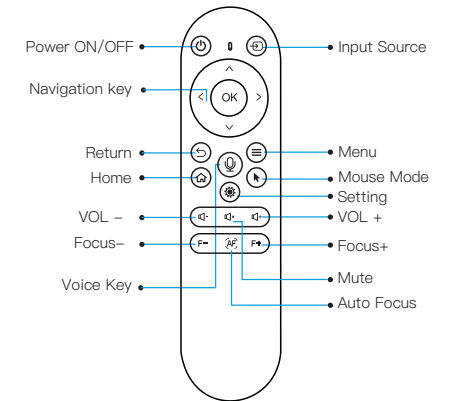

5

## Electric Focus Buttons

Press Focus +/- to adjust the image sharpness.

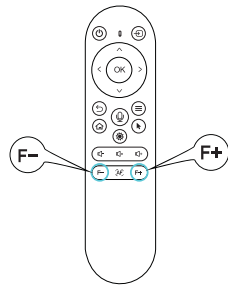
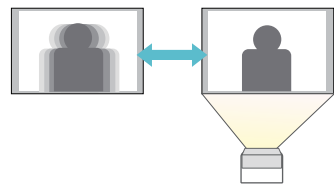

6

## Q&A

### 1 Unable to Boot Up

\* Check if the power cord is connected properly when power light is on. Try to unplug and plug the power cord if the projector still can not boot up.

### 2 Remote Controller is Insensitive or Unresponsive

\* Do not cover IR receiver.  
 \* In the infrared mode, make sure remote point at IR receiver directly.  
 \* There is an obstacle between the remote control and the projector.  
 \* The batteries are out of power or the battery is not installed correctly.

### 3 Why is there no display when I connect HD port?

\* Check if the interface is securely connected.  
 \* The devices may be incompatible.

### 4 Blurry Display

\* The lens is not clean.  
 \* The projection lens is not correctly focused.  
 \* The environment is too bright.

### 5 Screen Freeze

\* Please reboot the projector to test again. If the screen still freeze, please turn off for 10 minutes and turn on again.

If you have any questions or suggestions, please contact our online customer service.

7

## Maintenance Suggestions

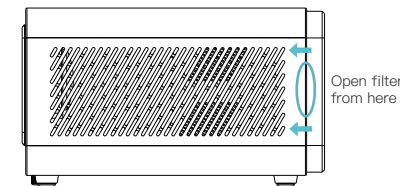

## Notice

To make this projector work longer, we recommend you to follow the suggestions:

- Before cleaning the projector, turn off the projector, then turn off the main power and unplug it from the outlet.
- Clean the filter regularly every month to prevent clogging.
- Make sure the projector off once you finish using it.
- Make sure not to use it continuously for more than 6 hours.

8

## Warranty Card

Client Name: \_\_\_\_\_ Client ID: \_\_\_\_\_

Client Phone Number: \_\_\_\_\_

Purchase shop: \_\_\_\_\_

Return Address: \_\_\_\_\_

Fault description: \_\_\_\_\_

(For quick repair, please describe the problem in details.)

This device complies with part 15 of the FCC Rules. Operation is subject to the following two conditions: (1) This device may not cause harmful interference, and (2) this device must accept any interference received, including interference that may cause undesired operation.

Any Changes or modifications not expressly approved by the party responsible for compliance could void the user's authority to operate the equipment.

**Note:** This equipment has been tested and found to comply with the limits for a Class B digital device, pursuant to part 15 of the FCC Rules. These limits are designed to provide reasonable protection against harmful interference in a residential installation. This equipment generates uses and can radiate radio frequency energy and, if not installed and used in accordance with the instructions, may cause harmful interference to radio communications. However, there is no guarantee that interference will not occur in a particular installation. If this equipment does cause harmful interference to radio or television reception, which can be determined by turning the equipment off and on, the user is encouraged to try to correct the interference by one or more of the following measures: Reorient or relocate the receiving antenna.

-Increase the separation between the equipment and receiver.

-Connect the equipment into an outlet on a circuit different from that to which the receiver is connected.

-Consult the dealer or an experienced radio/TV technician for help.

-This equipment complies with FCC radiation exposure limits set forth for an uncontrolled environment. This equipment should be installed and operated with minimum distance 20cm between the radiator & your body.

CE RoHS

封底