

I152 SMART WATCH USER MANUAL

PLEASE READ THE USER MANUAL BEFORE USE

English—1

Français—9

Deutsch—18

Italiano—27

Español—35

Nederlands—43

日本語—52

Product Overview



2. Switch watch on: long press the side button for 3-5 seconds. Please turn on the phone's Bluetooth and location service and make sure the watch is not bonded to other devices.

1. Open the phone's Bluetooth and location service and make sure the watch is not bonded to other devices. Open the FitCloudPro APP on your mobile phone. Set your personal information enter the device interface. Click on "Bind Device". Right-click on the main dial interface of watch to view MAC address. You can use the MAC address from the device list to determine your device. The device name and the corresponding MAC address are paired. Device is successfully connected.

Step 1: Open "FitCloudPro APP"—"OK, Allow"—"Add A DEVICE"—"Find I152 and choose"—"Pair"—"Allow"—"Done"

2. On the watch face page, you can go to the following page by touching the finger from top to bottom. Do not disturb: you can turn on or off do not disturb function. Brightness: you can adjust the brightness.

Settings: you can set stopwatch, alarm clock, timer, brightness, phone watch, call settings, vibration/strong mode, factory reset, shutdown, about APP download.

Vibration setting/Brightness adjustment/Bracelet reset Down slide screen will display the interface. As in the first picture. 1. Click brightness adjustment, you can adjust the screen brightness you need according to the usage.

Why the watch can't receive the message notification? Since Android mobile phone background will automatically clean up the App which not commonly used, it will cause the watch connection to drop and no longer push the message.

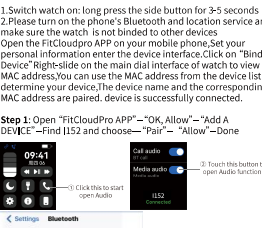

1. Make sure turn on message push in FitCloudPro setting. 2. Make sure the message can be displayed in mobile phone's notification bar. Message notification is pushed by reading the phone notification bar. The watch can't get notification if the message push closed in mobile phone setting.

Note: Find notification settings in phone settings, turn on Note APP, Facebook, Twitter, Phone, SMS.

Getting to know your Device It is forbidden to throw this product into the fire to avoid explosion. The battery life varies according to the environment and usage mode.

Why can't wear the smart watch to take a bath? The bath water temperature is relatively high, it will produce a lot of water vapor, and the water vapor is gas phase. Its

Tips for the first time use: 1. Open the box, use the I152 charging cable, then insert the USB to your laptop or any USB port with 5V to charge the Watch before use to ensure that the Watch is fully charged. The charging time is about 2 hours. To ensure that the charging contact is good. Please ensure that the metal surfaces are not dirty, oxidizing and impurities. When charging, the screen will display the charging symbol. If the watch is not used for a long time, please be sure to replenish it every one month.

APP Functions and Settings Main interface / dial Switch the customized dial through the APP. Discover more dials through APP.

Special attention: For other issues of watch's usage, you can get detailed answers in the APP suggestion feedback.

FCC Warning Note: This equipment has been tested and found to comply with the limits for a Class B digital device, which is applicable to residential environments.

This device complies with part 15 of the FCC Rules. Operation is subject to the following conditions: (1) This device may not cause harmful interference. (2) This device must accept any interference received, including interference that may cause unintended operation.

Personal Profile Set personal information when you login. My date-personal date. Gender - height - weight - age. Call reminder Keep connected, if the call alert function is enabled, the wristband will vibrate and display the name or number of the caller when the call.

Notifications Keep connected, if this function is enabled, the bracelet will vibrate when there are messages such as Wechat, Facebook, Twitter and so on. (Give the APP access to system permission).

Alarms: set the alarms. Shutter: this function will control your mobile phone to take photos from watch.

Alarms: set the alarms. Shutter: this function will control your mobile phone to take photos from watch. Favorite Contact: you can add your mobile phone contacts to your watch.

Others: you can set Find a bracelet, Time format, Secondary reminder, Raise your wrist to brighten the screen, drink water reminder. Upgrade: upgrade the watch software when necessary.

Note: 1. When using GPS/ outdoor sports mode, please turn on location services for phone and device, the watch does not have GPS function; you can open the GPS function in the app. 2. Each time you enter the App, the watch will automatically connect to the phone. After right-click of the main interface of watch to enter the MAC address interface. The Bluetooth icon will appear indicating that Bluetooth is connected. If there is no Bluetooth icon, Bluetooth is not connected.

Watch function interface 1. Watch face: long press the watch face button, it can be changed to 4 different watch faces, showed Dates, Time etc. More default watch faces: go to APP "FitCloudPro"—"Watch faces"—"Discover more dials"—"Choose dial"—"Download immediately"—"Done". Then, you can see the dial will be showed in your watch.

Alarms: set the alarms. Shutter: this function will control your mobile phone to take photos from watch. Favorite Contact: you can add your mobile phone contacts to your watch.

Others: you can set Find a bracelet, Time format, Secondary reminder, Raise your wrist to brighten the screen, drink water reminder. Upgrade: upgrade the watch software when necessary.

Note: 1. When using GPS/ outdoor sports mode, please turn on location services for phone and device, the watch does not have GPS function; you can open the GPS function in the app. 2. Each time you enter the App, the watch will automatically connect to the phone. After right-click of the main interface of watch to enter the MAC address interface. The Bluetooth icon will appear indicating that Bluetooth is connected. If there is no Bluetooth icon, Bluetooth is not connected.

Watch function interface 1. Watch face: long press the watch face button, it can be changed to 4 different watch faces, showed Dates, Time etc. More default watch faces: go to APP "FitCloudPro"—"Watch faces"—"Discover more dials"—"Choose dial"—"Download immediately"—"Done". Then, you can see the dial will be showed in your watch.

1. Click brightness adjustment, you can adjust the screen brightness you need according to the usage. 2. You need to use the watch with another phone, you need to reset the watch. 3. Click Restore factory settings, the watch will be restored to the initial state and restart automatically, at this time all data on the wristband is cleared.

1. Make sure turn on message push in FitCloudPro setting. 2. Make sure the message can be displayed in mobile phone's notification bar. Message notification is pushed by reading the phone notification bar. The watch can't get notification if the message push closed in mobile phone setting.

molecular radius is small, it is easy to infiltrate from the shell gap of the watch and when the temperature drops, it will recondense into a liquid phase. Water droplets can easily cause short circuit inside the watch, damage the circuit board and damage watch itself.

Appliquez longuement pendant 5 secondes pour allumer/l'éteindre, appuyez brièvement pour revenir. Bouton de retour

1. Allumer la montre: appuyez longuement sur le bouton latéral pendant 3 à 5 secondes. 2. Veillez activer le Bluetooth et le service de localisation de votre téléphone mobile avant d'utiliser la montre. La montre n'est pas associée à un autre appareil. Ouvrez l'application FitCloudPro sur votre téléphone mobile. Réglez vos informations personnelles, entrez dans l'interface de l'appareil. Cliquez sur "Lier l'appareil". Faites glisser vers la droite sur l'interface principale du cadran de la montre pour voir l'adresse MAC. Vous pouvez utiliser l'adresse MAC de la liste des appareils pour identifier votre appareil. Le nom de l'appareil et l'adresse MAC correspondante sont apparus. L'appareil est connecté avec succès.

Conseils pour une première utilisation: La première fois que vous utilisez la montre, veuillez vous assurer que la batterie est complètement chargée. 1. Ouvrez la boîte, utilisez le câble de charge I152, puis insérez le USB dans votre ordinateur portable ou tout port USB avec 5V pour charger la montre avant de l'utiliser, afin de garantir que la montre est entièrement chargée. 2. Lorsque vous utilisez la montre pendant longtemps, assurez-vous que les contacts de charge sont bons. Veuillez vous assurer que les surfaces métalliques ne sont pas sales, oxydées ou impures. Lorsque vous chargez, l'écran affichera le symbole de charge. Si l'appareil n'est pas utilisé pendant longtemps, veuillez vous assurer de le recharger tous les mois.

2. On the watch face page, you can go to the following page by touching the finger from top to bottom. Do not disturb: you can turn on or off do not disturb function. Brightness: you can adjust the brightness. Settings: you can set stopwatch, alarm clock, timer, brightness, phone watch, call settings, vibration/strong mode, factory reset, shutdown, about APP download.

Retsez connecté, si cette fonction est activée, le bracelet vibrera lorsque des messages tels que WeChat, Facebook, Twitter, etc. seront reçus. (Accordez à l'APP l'accès aux autorisations système).

1. Recherchez "FitCloudPro" dans l'App Store (Apple store/Google store). 2. Scannez le code QR pour télécharger.

1. Allumer la montre: appuyez longuement sur le bouton latéral pendant 3 à 5 secondes. 2. Veillez activer le Bluetooth et le service de localisation de votre téléphone mobile avant d'utiliser la montre. La montre n'est pas associée à un autre appareil. Ouvrez l'application FitCloudPro sur votre téléphone mobile. Réglez vos informations personnelles, entrez dans l'interface de l'appareil. Cliquez sur "Lier l'appareil". Faites glisser vers la droite sur l'interface principale du cadran de la montre pour voir l'adresse MAC. Vous pouvez utiliser l'adresse MAC de la liste des appareils pour identifier votre appareil. Le nom de l'appareil et l'adresse MAC correspondante sont apparus. L'appareil est connecté avec succès.

1. Cliquez sur "SYSTEM" icon, you can check the version information, Bluetooth MAC address, battery percentage display and Bluetooth connection status.

1. Cliquez sur "SYSTEM" icon, you can check the version information, Bluetooth MAC address, battery percentage display and Bluetooth connection status.

1. Cliquez sur "SYSTEM" icon, you can check the version information, Bluetooth MAC address, battery percentage display and Bluetooth connection status.

1. Cliquez sur "SYSTEM" icon, you can check the version information, Bluetooth MAC address, battery percentage display and Bluetooth connection status.

1. Cliquez sur "SYSTEM" icon, you can check the version information, Bluetooth MAC address, battery percentage display and Bluetooth connection status.

1. Cliquez sur "SYSTEM" icon, you can check the version information, Bluetooth MAC address, battery percentage display and Bluetooth connection status.

1. Cliquez sur "SYSTEM" icon, you can check the version information, Bluetooth MAC address, battery percentage display and Bluetooth connection status.

1. Cliquez sur "SYSTEM" icon, you can check the version information, Bluetooth MAC address, battery percentage display and Bluetooth connection status.

1. Cliquez sur "SYSTEM" icon, you can check the version information, Bluetooth MAC address, battery percentage display and Bluetooth connection status.

1. Cliquez sur "SYSTEM" icon, you can check the version information, Bluetooth MAC address, battery percentage display and Bluetooth connection status.

1. Cliquez sur "SYSTEM" icon, you can check the version information, Bluetooth MAC address, battery percentage display and Bluetooth connection status.

1. Cliquez sur "SYSTEM" icon, you can check the version information, Bluetooth MAC address, battery percentage display and Bluetooth connection status.

1. Cliquez sur "SYSTEM" icon, you can check the version information, Bluetooth MAC address, battery percentage display and Bluetooth connection status.

1. Cliquez sur "SYSTEM" icon, you can check the version information, Bluetooth MAC address, battery percentage display and Bluetooth connection status.

1. Cliquez sur "SYSTEM" icon, you can check the version information, Bluetooth MAC address, battery percentage display and Bluetooth connection status.

1. Cliquez sur "SYSTEM" icon, you can check the version information, Bluetooth MAC address, battery percentage display and Bluetooth connection status.

1. Cliquez sur "SYSTEM" icon, you can check the version information, Bluetooth MAC address, battery percentage display and Bluetooth connection status.

1. Cliquez sur "SYSTEM" icon, you can check the version information, Bluetooth MAC address, battery percentage display and Bluetooth connection status.

1. Cliquez sur "SYSTEM" icon, you can check the version information, Bluetooth MAC address, battery percentage display and Bluetooth connection status.

1. Cliquez sur "SYSTEM" icon, you can check the version information, Bluetooth MAC address, battery percentage display and Bluetooth connection status.

1. Cliquez sur "SYSTEM" icon, you can check the version information, Bluetooth MAC address, battery percentage display and Bluetooth connection status.

1. Cliquez sur "SYSTEM" icon, you can check the version information, Bluetooth MAC address, battery percentage display and Bluetooth connection status.

1. Cliquez sur "SYSTEM" icon, you can check the version information, Bluetooth MAC address, battery percentage display and Bluetooth connection status.

1. Cliquez sur "SYSTEM" icon, you can check the version information, Bluetooth MAC address, battery percentage display and Bluetooth connection status.

1. Cliquez sur "SYSTEM" icon, you can check the version information, Bluetooth MAC address, battery percentage display and Bluetooth connection status.

1. Cliquez sur "SYSTEM" icon, you can check the version information, Bluetooth MAC address, battery percentage display and Bluetooth connection status.

1. Cliquez sur "SYSTEM" icon, you can check the version information, Bluetooth MAC address, battery percentage display and Bluetooth connection status.

1. Cliquez sur "SYSTEM" icon, you can check the version information, Bluetooth MAC address, battery percentage display and Bluetooth connection status.

1. Cliquez sur "SYSTEM" icon, you can check the version information, Bluetooth MAC address, battery percentage display and Bluetooth connection status.

1. Cliquez sur "SYSTEM" icon, you can check the version information, Bluetooth MAC address, battery percentage display and Bluetooth connection status.

1. Cliquez sur "SYSTEM" icon, you can check the version information, Bluetooth MAC address, battery percentage display and Bluetooth connection status.

1. Cliquez sur "SYSTEM" icon, you can check the version information, Bluetooth MAC address, battery percentage display and Bluetooth connection status.

1. Cliquez sur "SYSTEM" icon, you can check the version information, Bluetooth MAC address, battery percentage display and Bluetooth connection status.

1. Cliquez sur "SYSTEM" icon, you can check the version information, Bluetooth MAC address, battery percentage display and Bluetooth connection status.

1. Cliquez sur "SYSTEM" icon, you can check the version information, Bluetooth MAC address, battery percentage display and Bluetooth connection status.

1. Cliquez sur "SYSTEM" icon, you can check the version information, Bluetooth MAC address, battery percentage display and Bluetooth connection status.

1. Cliquez sur "SYSTEM" icon, you can check the version information, Bluetooth MAC address, battery percentage display and Bluetooth connection status.

1. Cliquez sur "SYSTEM" icon, you can check the version information, Bluetooth MAC address, battery percentage display and Bluetooth connection status.

1. Cliquez sur "SYSTEM" icon, you can check the version information, Bluetooth MAC address, battery percentage display and Bluetooth connection status.

1. Cliquez sur "SYSTEM" icon, you can check the version information, Bluetooth MAC address, battery percentage display and Bluetooth connection status.

1. Cliquez sur "SYSTEM" icon, you can check the version information, Bluetooth MAC address, battery percentage display and Bluetooth connection status.

1. Cliquez sur "SYSTEM" icon, you can check the version information, Bluetooth MAC address, battery percentage display and Bluetooth connection status.

1. Cliquez sur "SYSTEM" icon, you can check the version information, Bluetooth MAC address, battery percentage display and Bluetooth connection status.

1. Cliquez sur "SYSTEM" icon, you can check the version information, Bluetooth MAC address, battery percentage display and Bluetooth connection status.

1. Cliquez sur "SYSTEM" icon, you can check the version information, Bluetooth MAC address, battery percentage display and Bluetooth connection status.

