

LYTDZ-CA

BYH7098



After-sales service:

SZSLYTDZCAR (INS)

SZSLYTDZCAR (Facebook)

LYTDZCA@126.COM

After-sales service

If you have any question about installation or operation, please feel free to contact us as below!

Email Add:

LYTDZCA@126.COM

For online installation tutorial



Scan QR Code

Thank you!

CarPlay Mamual

LYTDZ-CA

Suitable for
Apple Carplay

Android Auto

Resolution 1280x720

HD display, stereo radio

Bluetooth&Carplay

Audio/video/picture playback



Before installation

Note: Before Installation

Thank you for purchasing and using our product. Please read the instruction carefully before installation. First of all, to prevent transportation damage, please check and test the product instead of installing directly. Besides, please make sure the product can work normally before installation.

Testing method:

Please test the product with car battery. (NOTE: The product working power is 12VDC). The approach is to connect the product power cable to the car battery terminal, as Red wire ACC and Yellow wire B+ to the positive, and the black wire GND to the negative. Next, please press each button to check whether it can work normally after turning on 10 seconds.

We suggest that you could follow our testing step to check the product strictly. And if you have any problem, please contact us freely. Thank you for your cooperation.

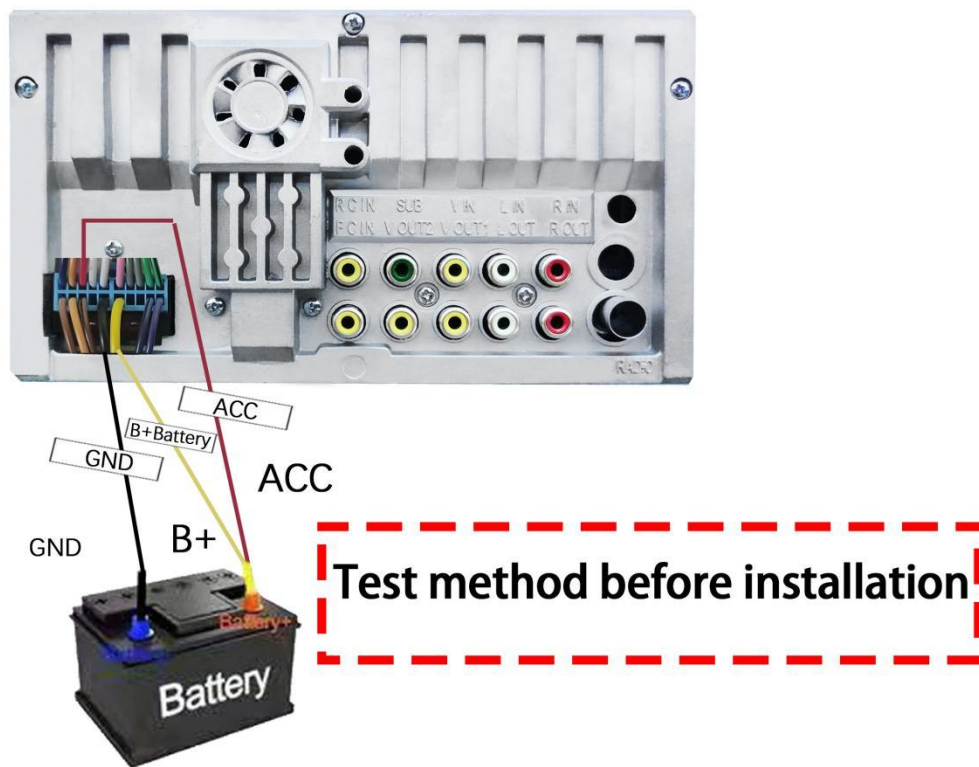

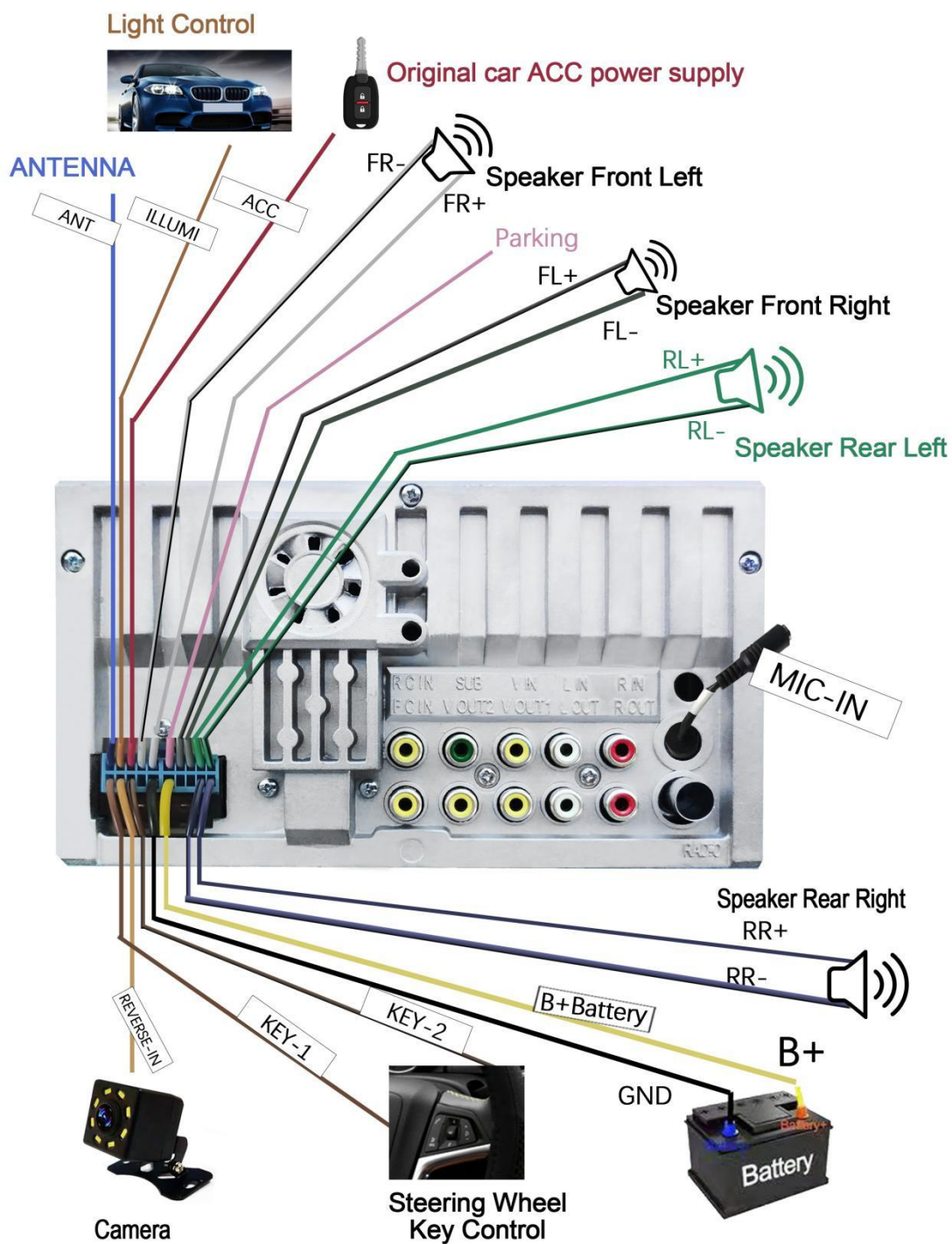

Machine wiring diagram

Rear interface description

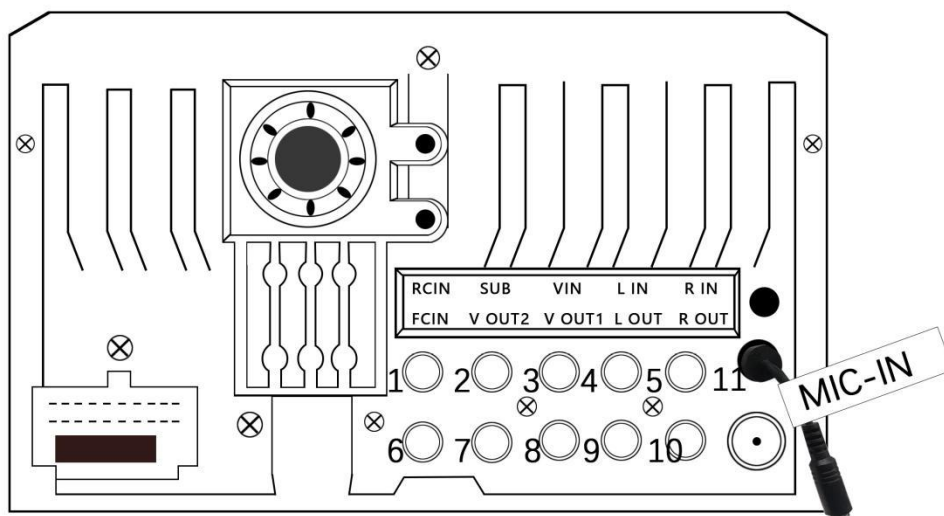

- 1.Blue ANT
- 2.Orange:ILLUMI
- 3.Red:ACC
- 4.White and black:FL-
- 5.White:FL+
- 6.Pink:BRAKE-IN
- 7.Gray and black:FR-
- 8.Gray:FR+
- 9.Green:RL+
- 10.Green and black:RL-

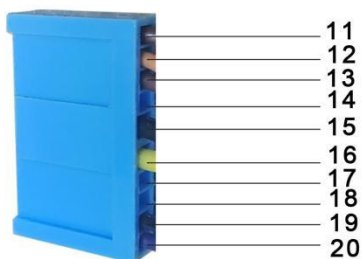

11. Brown:KEY1/CAN+
- 12.Orange and black:REVERSE-IN
- 13.Brown and black:KEY2/CAN-
- 14.NC
- 15.Black:GND
- 16.Yellow:B+12V
- 17.NC
- 18.NC
- 19.Violet and black:RR-
- 20.Violet:RR+

1.RCIN	5.R IN	9.L OUT
2.SUB	6.FCIN	10.R OUT
3.VIN	7.V OUT2	11.MIC
4.L IN	8.V OUT1	

Note: 1.Each wire of the speaker cables cannot be grounded or shared.

2.Do not touch each other between the lines, otherwise there will be no sound output.

Installation method of reversing camera

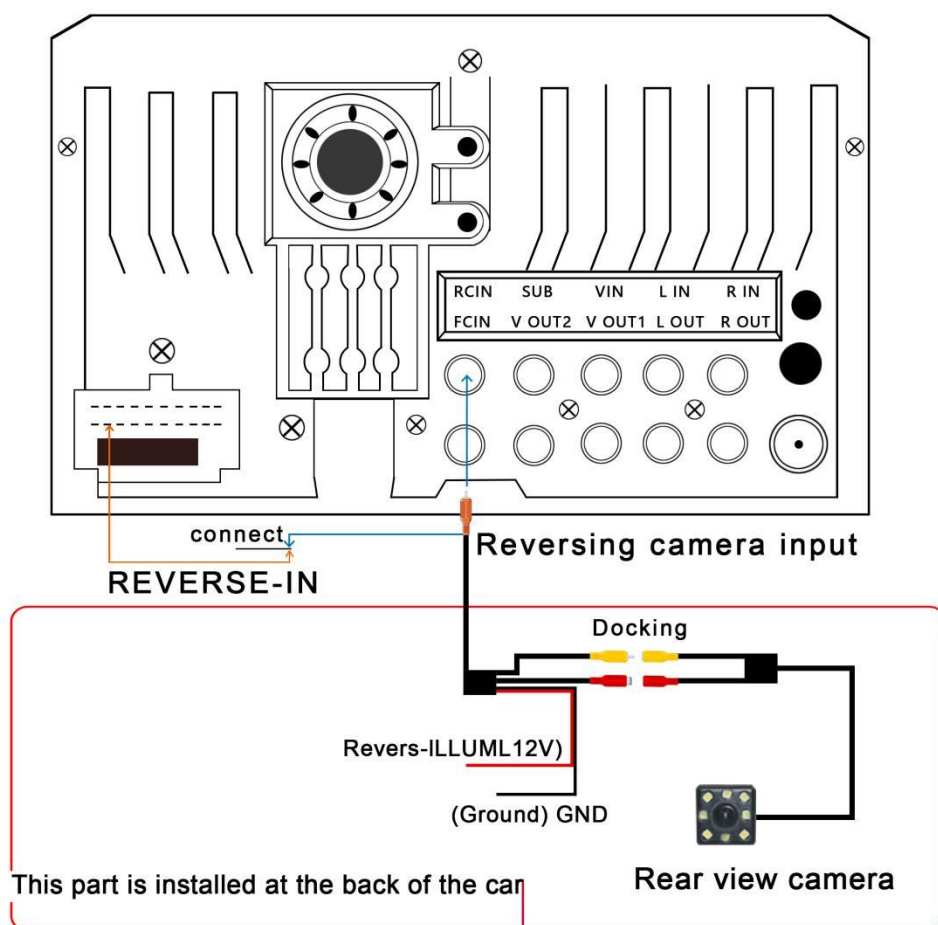

If the rear-Camera is not be installed correctly, please do not connect the REVERSE/BACK wire.
Otherwise, the device will not display or switch mode.

Machine-fixed reference method

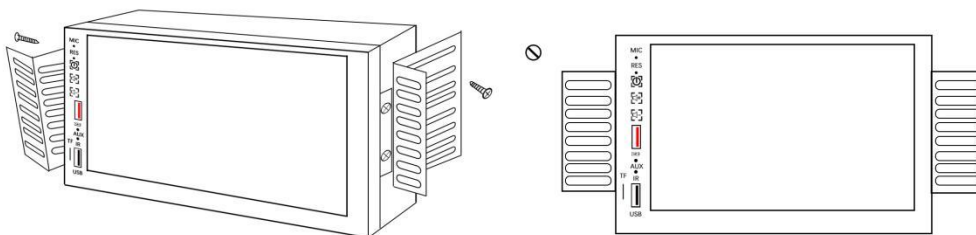

Rear Camera Installation



- A** Camera
- B** Power: Connect to the reversing light
- C** Monitor

Note: Because it has a ruler line, it cannot be used as a front-view camera

If you wanna use your original camera or buy another camera, please make sure it has the CVBS signal and RCA jack.

C to B: We provide an 6 meters long(other:3m) extension cable for you to install. So it is long enough for the installation.

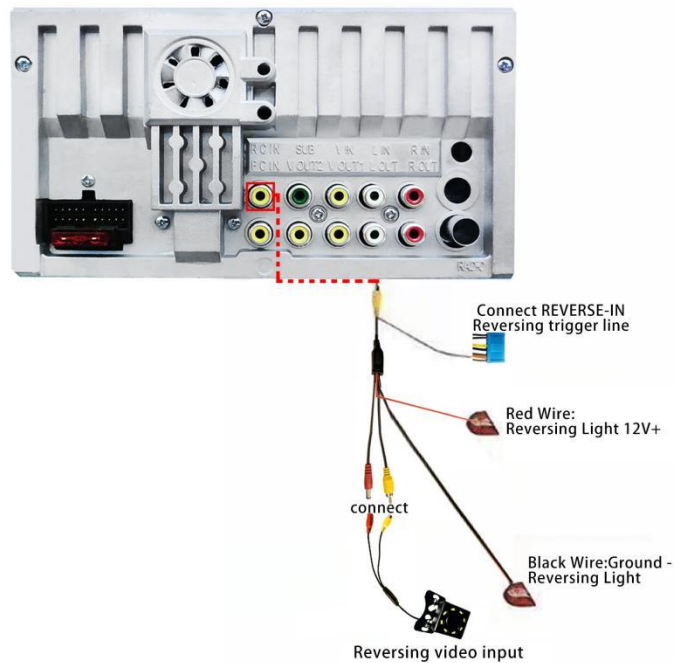

2-channel amplifier

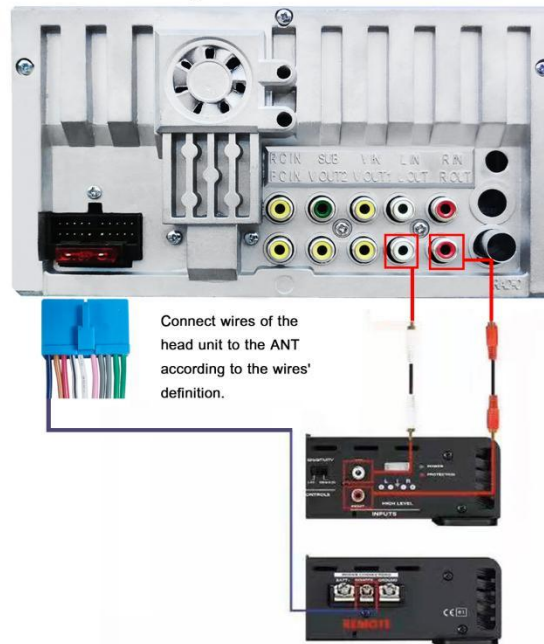

4-channel amplifier

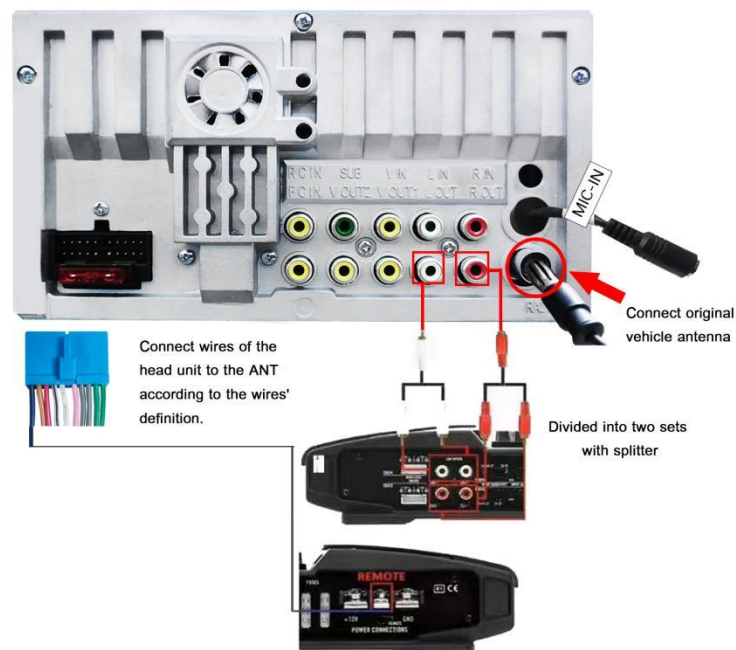

Main interface

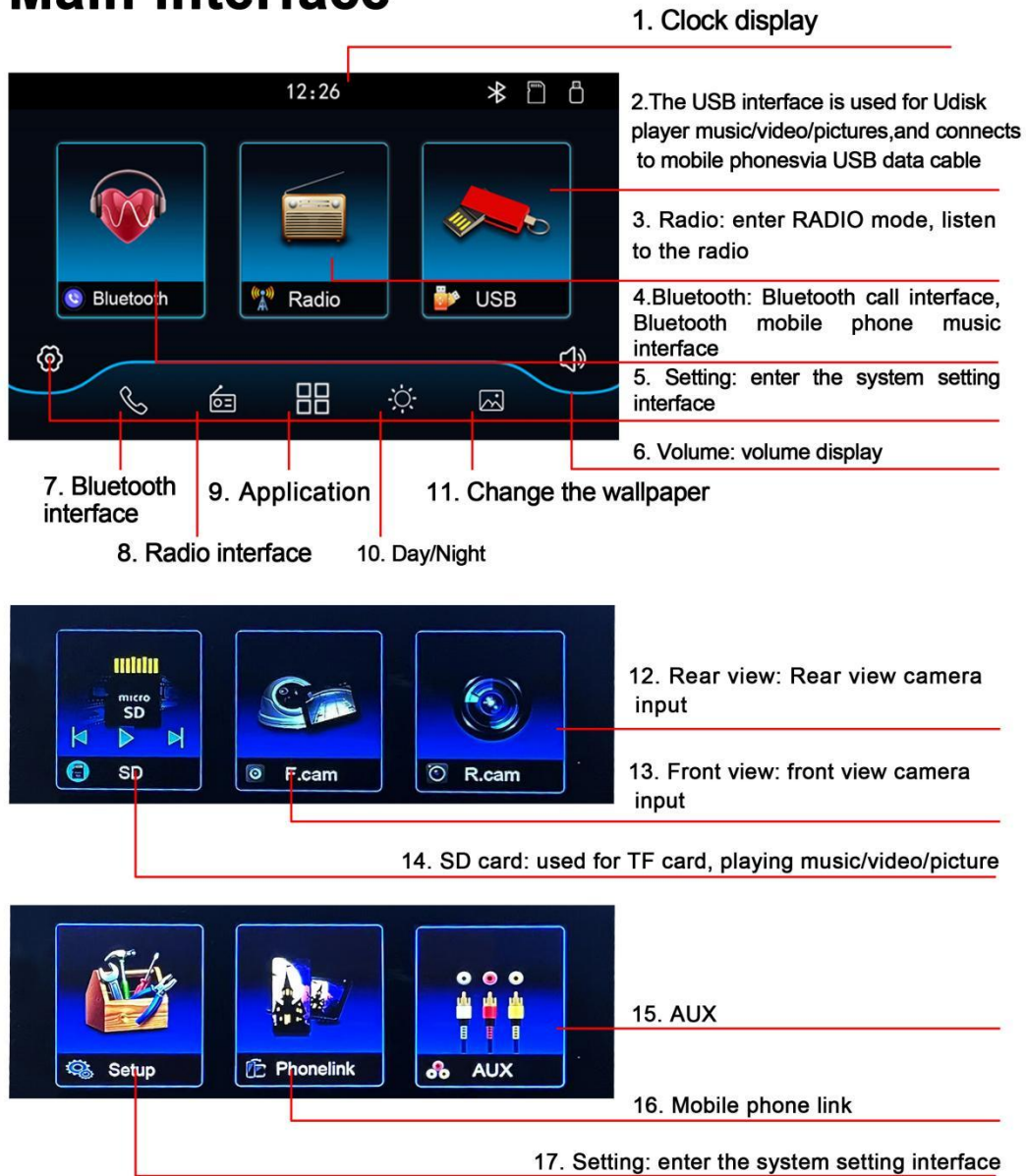

Video decoding format: H264 HD (720P 1080I/1080P) AVI/FLV/MKV/RMVB/MPEG/ASF/H264/QT
 Audio decoding format: MP3/AAC/APE/OGG/M4A/RA/WAV
 Picture decoding format: JPEG/PNG/BMP/GIF/TIFF

Bluetooth interface

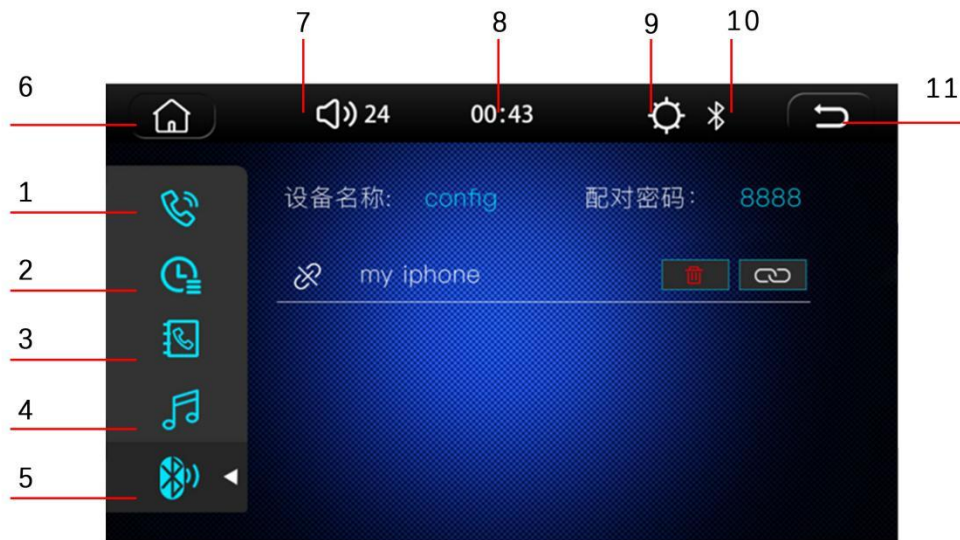

- | | |
|-----------------------------------|--|
| 1. Phone interface | 6. Main interface |
| 2. Communication record interface | 7. Volume display |
| 3. Phonebook interface | 8. Clock |
| 4. Bluetooth music interface | 9. Day mode / night mode / turn off the screen |
| 5. Bluetooth pairing interface | 10. Bluetooth logo 11. Back |

Equipment name: CAR-KIT

Pairing method:

Turn on the Bluetooth function of the mobile phone, when CAR-KIT is found in the mobile device list, click "Search Device*1 to pair the device.

Steering wheel controls

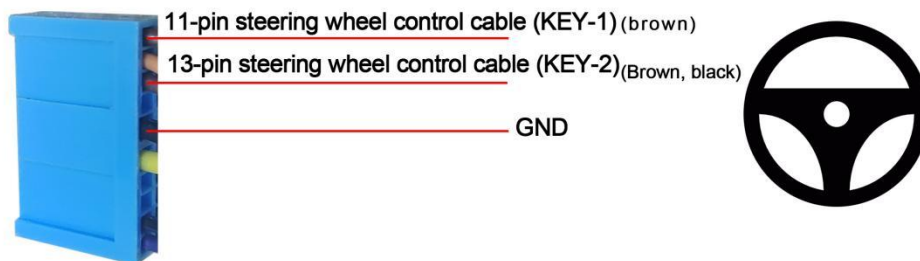
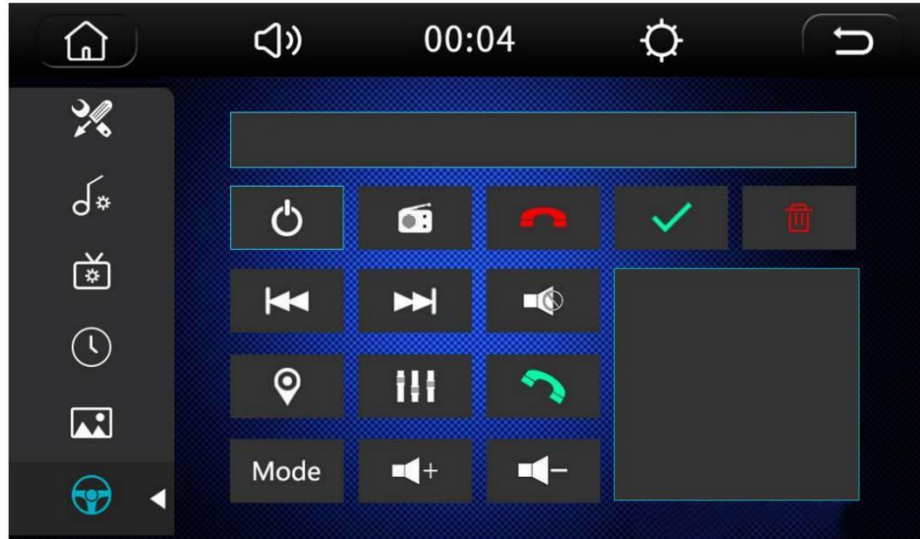

Wiring Method:

1. Connect the KEY wire to the positive terminal of car steering wheel control wire.
2. Connect the GND wire to the negative terminal of car steering wheel control wire.

Learning Step:

1. Press the button on steering wheel control, and click the corresponding function on touch screen. If the screen can be turned on which indicates the success of setting. Repeat the operation to complete the learning step.
2. Reset the button and re-learn if error occurs.

Setting Interface

General settings

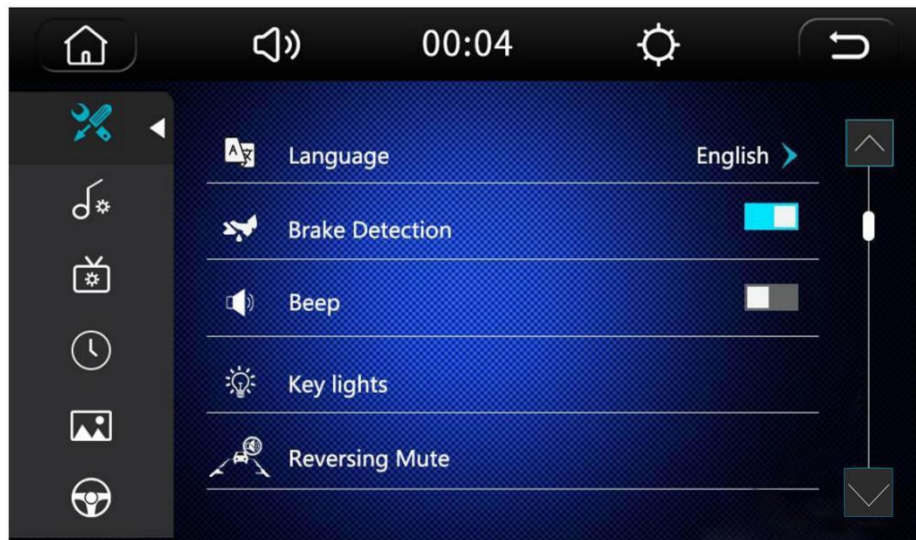

Audio/sound effect settings



Remote control instructions

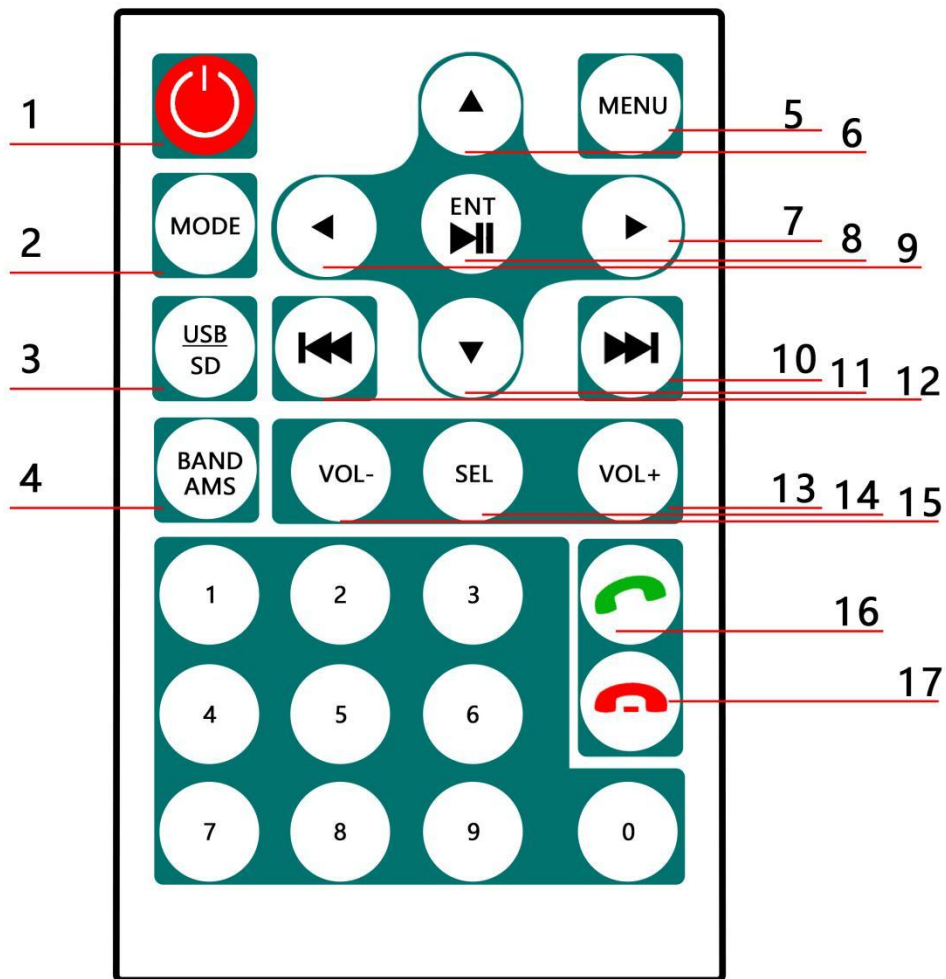

- | | | |
|-------------------------|---------------------------|----------------------|
| 1. Power | 7. Direction to the right | 13. Sound plus |
| 2. Mode conversion | 8. Play/pause | 14. Settings |
| 3. Switch USB/interface | 9. Direction to the left | 15. Sound reduction |
| 4. Radio interface | 10. Fast forward | 16. Answer the phone |
| 5. Menu | 11. Direction down | 17. Hang up |
| 6. Direction up | 12. Go backwards | |

Note: The product does not contain batteries in the remote control.

Bluetooth interface

Bluetooth function introduction: compatible with Bluetooth V4.2+BR+EDR+BLE specification.
It supports A2DP/AVCTP/AVDTP/AVRCP/HFP/SPP/ATT/GAP/GATT/RFCOMM/SDP/L2CAP.

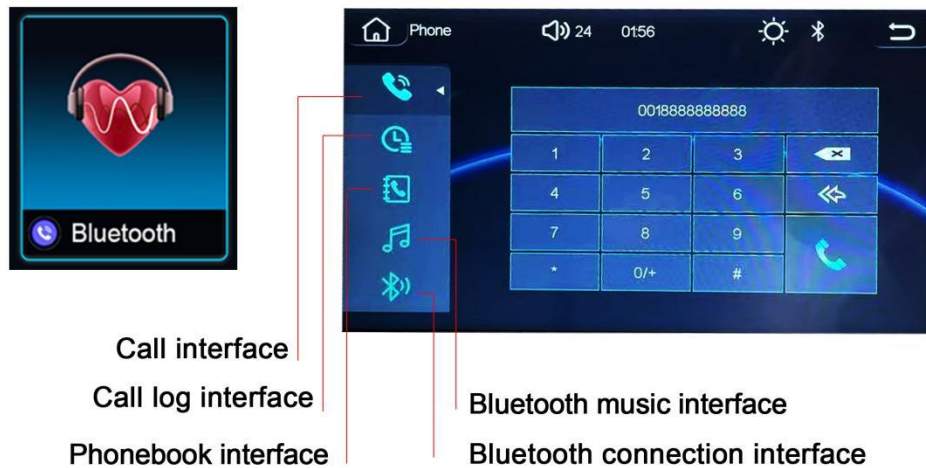

Bluetooth connection interface



IOS

1. Connect the iPhone and the machine with a USB data cable.
2. Then the machine will automatically enter the Carplay interface.
3. You can press "AutoPlay" on the homepage to enter the Carplay function again after you log out.

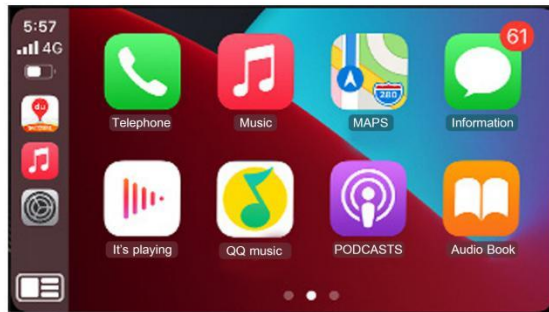

Android Auto

Not all countries support this feature. The "Google Play" service needs to be available locally.

1. Download and install the "Android Auto" software in the Google Play.

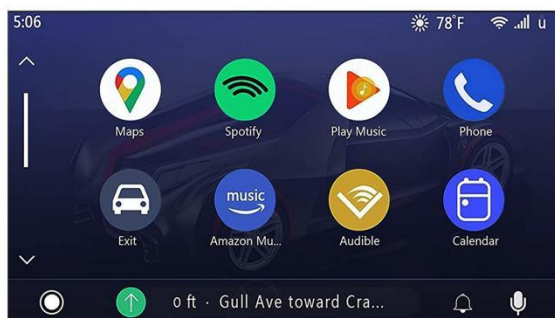

2. A mobile phone with Android 5.0 and above must be needed. A valid data cable must be used for connection.
3. Open the "Android Auto software" on the phone. (No need to open the USB debugging mode).
4. After the connection is successful, you can use the functions provided by Android Auto in the car.

Common problems of mobile phone interconnection function:

1. The interconnection of wired mobile phone function needs to be connected to Bluetooth before it can be used.
2. For some Android phones, you need to turn on "Forced full screen display" in the phone terminal > Application management > Auto link.
3. If there is no response after connecting the USB. Please unplug and plug repeatedly or replace the original USB data cable to check the USB data cable. Or changing another mobile phone to avoid the problems from phone.
4. When the machine is in the Carplay/Android Auto/Mirror interface, the radio will automatically shut down.

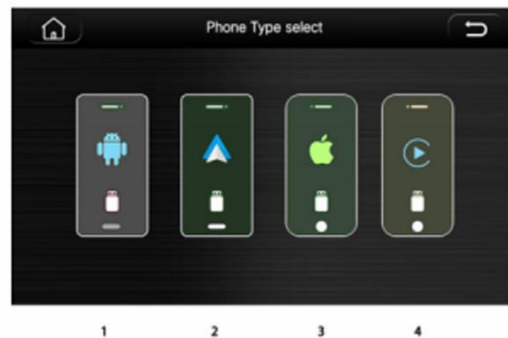

MP5 player mobile phone interconnection interface description:

1. Android Mirror Link : When connecting to Android USB mirror screen for the first time, please click Figure 1 to enter the Android USB mirror function interface, and scan the QR-code to download & install the application software on the mobile phone. Then, plug in the mobile phone. It is time to click the "start now" on the mobile phone according to the mobile phone prompt. The mobile phone screen will be automatically mirrored to the unit. If you exit the Android USB screen mirror function, but do not switch to other wired mobile phone interconnection modes. It is no need to enter before connecting to Android USB screen mirror and Android USB screen mirror function.

2. Android Auto: Firstly, download the Android Auto application software for Android phones. When connecting to the wired Android Auto function for the first time, you need to connect to Bluetooth. If there is no connection to the machine, there will be no sound. Then, click the icon in Figure 2 on the car side to enter the wired AndroidAuto function interface and plug it. The mobile phone runs the AndroidAuto application software as prompted by the mobile phone. After the mobile phone runs AndroidAuto, it will automatically prompt to download the Google application, voice search and map. It is easy to download the application software through following the prompts to log in to the Google account. And it will automatically connect to AndroidAuto after the application is installed. If you have not switched to other wired mobile phone interconnection mode after exiting the AndroidAuto function, you do not need to enter it in advance to connect to AndroidAuto again.

3. IOS Mirror Link: When connecting to the IOS wired screen mirror function for the first time, click the icon in Figure 3 on the car terminal to enter IOS wired screen mirror interface, and plug in the phone. Then, click on "Trust" on the phone according to the phone prompt and the phone screen will automatically connect to the unit. If after exiting the Apple wired screen mirror projection function, it does not switch to the other wired mobile phone interconnection mode, connect again. There is no need to enter the Apple Wired Projection mirror function in advance. The back control function needs to connect to Bluetooth and it only supports versions below IOS 13.4.

4. Carplay: When connecting to the Apple wired CARPLAY function for the first time, click the icon in Figure 4 on the car terminal to enter the Apple wired CARPLAY interface and plug in the phone. After inserting the mobile phone, the mobile phone will automatically start CARPLAY, and the car terminal will automatically enter CARPLAY. If exiting CARPLAY function, and it does not switch to other wired mobile phone interconnection mode, but you do not need to enter the CARPLAY function before connecting to CARPLAY again.

This device complies with part 15 of the FCC Rules. Operation is subject to the condition that this device does not cause harmful interference (1) this device may not cause harmful interference, and (2) this device must accept any interference received, including interference that may cause undesired operation.

Any changes or modifications not expressly approved by the party responsible for compliance

could void the user's authority to operate the equipment.

NOTE: This equipment has been tested and found to comply with the limits for a Class B digital device, pursuant to Part 15 of the FCC Rules. These limits are designed to provide reasonable protection against harmful interference in a residential installation. This equipment generates, uses and can radiate radio frequency energy and, if not installed and used in accordance with the instructions, may cause harmful interference to radio communications. However, there is no guarantee that interference will not occur in a particular installation.

If this equipment does cause harmful interference to radio or television reception,

which can be determined by turning the equipment off and on, the user is encouraged to try to correct the interference by one or more of the following measures:

- Reorient or relocate the receiving antenna.
- Increase the separation between the equipment and receiver.
- Connect the equipment into an outlet on a circuit different from that to which the receiver is connected.
- Consult the dealer or an experienced radio/TV technician for help.

To maintain compliance with FCC's RF Exposure guidelines, This equipment should be installed and operated with minimum distance between 20cm the radiator your body: Use only the supplied antenna.

FCC ID: 2A4XW-BYH7098