

THANK YOU
To My Dear Customer

HARISON
CARDIO · STRENGTH · BEAUTY

info@harisonfitness.com
www.harisonfitness.com
TEL: +81 336 9420825

USER MANUAL Bluetooth Smart Scale

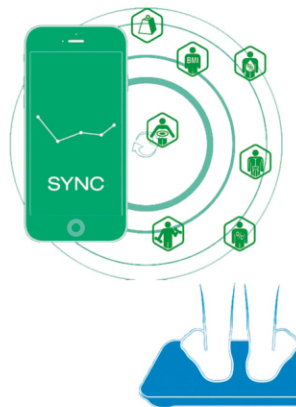

Sync your progress
easily to any Bluetooth
smart ready device.
Smartphone not required
for scale use.

Step 1 Check required specification for Phone or Tablet

① Before installing OKOK App, kindly check if the phone or tablet meets following requirement:

Compatible with IOS7.0 and above with Bluetooth 4.0 and above

Phone 4s, iPhone 5, iPhone 5c, iPhone 5s
iPhone 6, iPhone 6 Plus, iPhone 6s, iPhone 6s Plus
iPhone 7, iPhone 7 Plus, iPhone 8, iPhone 8 Plus, iPhone X
iPad 1, iPad 2, iPad 3, iPad 4, iPad 5, iPad mini
iPad mini 2, iPad mini 3, iPad mini 4, iPad Air
iPad Air 2, iPad Pro, iPad Pro 2等

Compatible with Android 4.3 and above with Bluetooth 4.0 and above

SAMSUNG: galaxy s8, galaxy s7, galaxy s6, galaxy s5, galaxy s4
galaxy s3, galaxy note8, galaxy note7, galaxy note6, note5
galaxy note4, galaxy note3, galaxy note2, galaxy grand2
XIAOMI: Hongmi Note 4x, Xiaomi 5c, Hongmi 4x, Xiaomi Note 2
Xiaomi 6, Xiaomi Max 2, Hongmi 5x, Hongmi Note 5A, Xiaomi Mix 2
Xiaomi Note 3, Hongmi 4, Hongmi 5, Hongmi 5 Plus, Xiaomi 4
HUAWEI: Ascend P8, Ascend P7, Honor6Plus, Honor6, Mate 10
mate 10Pro, Mate 9, Mate 9Pro, AscendG7, nove 2, nove 2Plus
P10, P9, P10 Plus, P9 Plus
Support Android4.3 and above for selected Android
devices with Bluetooth 4.0 and above

Step 2 Install the batteries

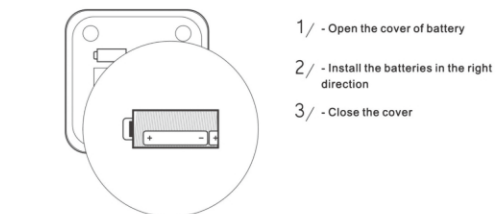

- 1/ - Open the cover of battery
- 2/ - Install the batteries in the right direction
- 3/ - Close the cover

2

Step 3 Install App

Use your device to scan QR Code or search OKOK from App Store/Google Play to install App.



- 1/ Switch on Bluetooth
- 2/ Phone or Tablet connects to Net (WIFI, 3G or 4G)

Step 4 Pair the devices, register and complete user information

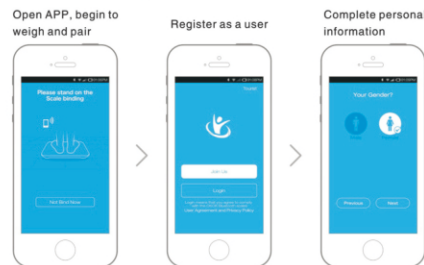

3

Step 5 Weighing

Enter into "Dynamic Weight" interface



Stand on the scale and synchronize weight data onto APP



Step 6 View the test result

Enter into "Weight Trend" interface



View test report



4

Specification

Display: All data displayed when power on
Capacity: 3kg-180kgs
Division: 1D=100g/0.2lb
Unit: KG/LB/ST
Voltage: 3V
Battery: 2*AAA battery
Low battery indication: 2.4V±0.2V, display "Lo" and power off
Current: ≤25mA
Standby current: ≤10 μA
Overload indication: overload more than 2.5kgs, total 182.5kgs display "Err"
Best working temperature: 5~35℃
Storage temperature: -10~60℃
Moisture Environment: ≤90%RH

Instruction for OKOK App

- **Instantly weighing**
Open the OKOK APP, it will remind you to switch on Bluetooth. Turn Bluetooth on and the auto-pair process completed automatically. User begin weighing, the weight data will be synchronizing to APP. If the Bluetooth disconnected, the weight data will be saved into memory of the scale, then synced to APP while the Bluetooth connected.
- **Type weight data into APP**
The user can type weight data into APP to keep a track
- **Current weight**
Current weight interface displays weight information of the user and family members, and generates the report and give health advice based on the measurement. Including current weight interface, weight list interface, date report and notice.
- **Weight trend**
Including weekly report, monthly report and quarterly report, indicating the changes of weight through curves.

Notice For fat scale, in addition to weighing data, it also includes body shape, obesity, weight, BMI, body fat rate, Fat weight, muscle rate, muscle weight, visceral fat, water, water content, basal metabolism, bone mass, Protein, fat free weight fifteen item data

5

Management of scale

Management of scale including two parts: scale management and connection management

Scale management

Manage the process of pairing, bind and unbind

Connection management

Including Bluetooth status indication and Bluetooth connection

Account and user

Including account management and user management

Account Management

Including registration, login in, change password, forget password, links to Facebook, Twitter...etc

User management

Manage user information, including nickname, birthday, height, gender...etc, also managing family member account and information (under the same registration account).

Warnings

1. Please keep the scale away from wet floor, don't use the scale if the glass is wet in case of slip.
2. Please stand on the middle of the scale in case of turnover.
3. The platform of the scale is made of glass, please avoid sharp or harsh things scratching the surface, excessive forces or sudden shocks, unexpected fallen-off will break the glass and injure the user.
4. The Bluetooth scale is not waterproof. Keep the surrounding environment dry, do not submerge it in water.
5. Use soft cloth with neutral cleaning liquids to clean the surface, keep away contacting with organic solvent nor chemicals.
6. When the batteries are in low power status, please remove the batteries in case of leaking liquids corrode the scale.

Notices

1. Please stand on the scale in the right direction.
2. Please stand on the scale no less than 10 seconds if you measure body fat.
3. Please confirm gender, height, weight data is correct

6

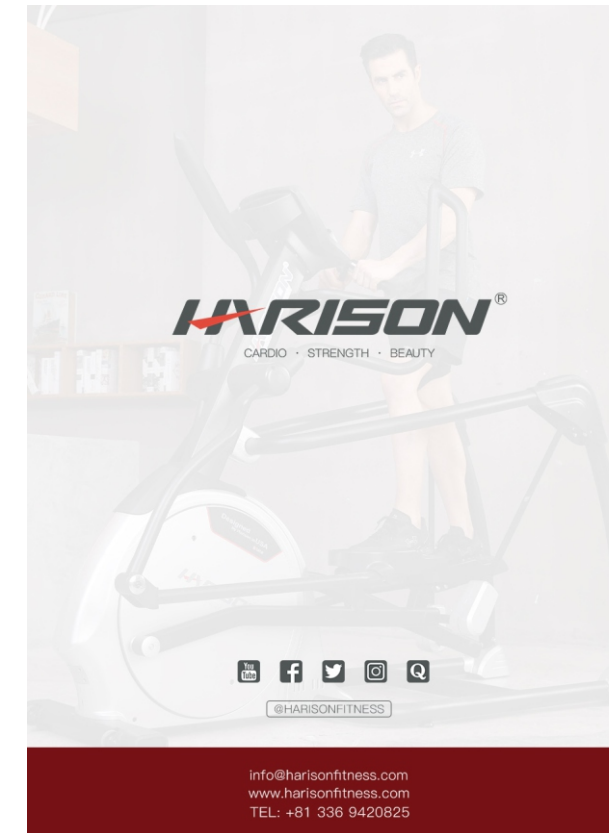

HARISON
CARDIO · STRENGTH · BEAUTY



@HARISONFITNESS

info@harisonfitness.com
www.harisonfitness.com
TEL: +81 336 9420825

FCC Statement

This device complies with part 15 of the FCC rules. Operation is subject to the following two conditions: (1) this device may not cause harmful interference, and (2) this device must accept any interference received, including interference that may cause undesired operation.

Changes or modifications not expressly approved by the party responsible for compliance could void the user's authority to operate the equipment.

NOTE: This equipment has been tested and found to comply with the limits for a Class B digital device, pursuant to part 15 of the FCC Rules. These limits are designed to provide reasonable protection against harmful interference in a residential installation. This equipment generates uses and can radiate radio frequency energy and, if not installed and used in accordance with the instructions, may cause harmful interference to radio communications. However, there is no guarantee that interference will not occur in a particular installation. If this equipment does cause harmful interference to radio or television reception, which can be determined by turning the equipment off and on, the user is encouraged to try to correct the interference by one or more of the following measures:

- Reorient or relocate the receiving antenna.
- Increase the separation between the equipment and receiver.
- Connect the equipment into an outlet on a circuit different from that to which the receiver is connected.
- Consult the dealer or an experienced radio/TV technician for help.

The device has been evaluated to meet general RF exposure requirement. The device can be used in portable exposure condition without restriction.