



1. Do not leave a fully charged battery connected to charger/overcharging may shorten its lifetime.
2. If not intend to use the battery for long period, it should be removed and kept in dry and low-temperature environment with full charge. If left unused, a fully charged battery will lose its charge over time. Though equipped with low-voltage protection we still suggest avoiding excessive discharge to a low voltage condition that may cause the failure to charge again.
3. Do not leave the battery to charge over 24 hours/when the charger after using.
4. Storing the battery in hot places such as a close car in summer will reduce the capacity and lifetime of the battery.
5. Do not dispose of battery in a fire as they may explode, battery may also exploded if damaged.
6. Do not disassemble or modify the battery for any purpose.
7. Do not short-circuit the battery. Accidental short-circuiting can occur when a metallic object such as a coin, clip or pen causes direct connection of the positive (+) and negative (-) terminals of the battery.
8. Short-circuiting the terminals may damage the battery or the connecting object.
9. Do not expose the battery to liquid or subject to strong mechanical shocks.
- How to treat Waste Electrical and Electronic Products
1. Do not place the products household waste.
2. Follow the local regulations and laws for proper disposal of discarded electronic products.

Instructions Before Flying

Read through the manual before using.
Keep the small parts of the accessories out of the reach of kids.
Keep the drone 3 meters away from the other people when flying.

Flying Precautions

1. Keep small parts out of the reach of children to avoid choking hazard.
2. The DRONE is powerful, when taking off, move the throttle stick forward gradually, to avoid it's rising too fast.
3. After flight, turn off the BRONE first then turn off the controller.
4. Do not put the battery in high temperature or near heat source.
5. Note, to avoid injury or damage the DRONE should not be flown nearer than 2 meters 7 feet from people or other obstacles.
6. Children should fly the DRONE under adult supervision only. Always keep the DRONE in clear sight while flying.
7. Always turn off the power of the controller and DRONE when not in use.

Notification

Equipped with low-voltage and over current protection, the drone will land slowly when the battery is low and the power will be cut if any of the 4 blades is jammed.

Maintenance

1. Keep the Drone clean and dry.
2. Don't fly the Drone into the water or in the rain.
3. Check the Drone before every flying and if any damage is found, don't fly the Drone until it is well repaired.

1

1.0 PRODUCT OVERVIEW

1.1 Transmitter



1.2 Propellers



Connect each propeller to its corresponding motor shaft, either position 'A/B'.

▲ Pay attention to the 'A' or 'B' printed on the each propeller. The drone will not fly unless the correct propeller is installed in the correct motor shaft.

2

2.0 FLIGHT PREPARATION

1. Install the remote batteries.



2. Charge the battery of the drone.

3. Install the drone battery after it's fully charged.

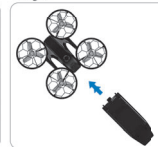

Tips:

1. For your safety, please use the original battery and USB cable.
2. If you fast-charge, the electric current may increase sharply and the rubber part may melt.
3. Plug the USB charging cable into a USB charging port on the computer, power bank or USB adapter (5V/0.5-2A).
4. Free the battery of any sharp objects that could puncture into the battery to avoid risks of explosions and fire.
5. There is continuous beeping sound from the remote when the battery of the remote is low.
6. The LED on the drone will flash quickly when the battery of the drone is low. About 40-50 seconds, the drone will land automatically.
7. To extend the battery's lifespan, recharge it at least once every three months if not using it for long periods of time.

3

3.0 FLIGHT OPERATION GUIDE

3.1 Pairing

1. Long press the power switch to turn on the drone, the indicator light of the drone will keep flashing.



2. Place the drone on a flat and level surface with the head forward and the tail facing towards the pilot.

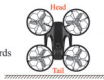

3. Turn on the transmitter, and you will hear the 'DF' sound, then the indicator lights keep flashing.



4. Push the throttle joystick up then down to pair the drone with the transmitter. The indicator light on the drone will turn solid if the drone is paired successfully.



4

3.2 Calibrate the Gyro



Push two levers down to 45° as picture shows, the indicator light on drone will blink and turn solid that indicates the calibration is completed.
▲ To ensure a stable flight, we suggest that the pilot calibrates the gyro every time after pairing the drone and after a crash.

3.3 Unlocking / Locking the motors



Unlocking the motors: As the shown above, move the Left Control Stick to lower left at 45° and the Right Control Stick to lower right at 45° at the same time until four rotor blades start rotating.
Locking the motors: Repeat this operation, the motors will stop immediately.

5

3.4 One key take-off / Landing

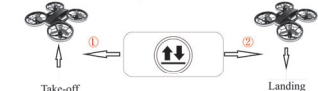

1. After pairing/calibration, press the One Key Take-Off button, the drone will take off automatically and hover at 5 feet altitude.
2. When the drone is flying, press the One Key Landing button again, the drone will land on the ground automatically.

3.5 Emergency Stop

▲ The Emergency Stop function should only be used in case of emergency during the flight to avoid any of damage or injury.



As shown above, long press the Emergency Stop button for 3 seconds, the drone will fall rapidly.
Attention: Be aware that you risk breakage of the drone if it falls a large distance or hits anything at a high rate of speed.

6

3.6 Instructions of the Remote

3.6.1 Left Control Stick

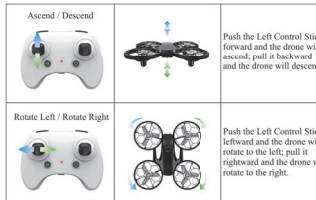

3.6.2 Right Control Stick

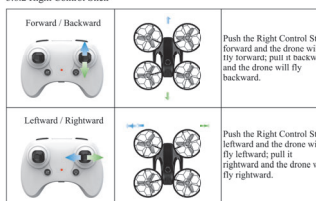

7

3.6.3 Flight Trimming

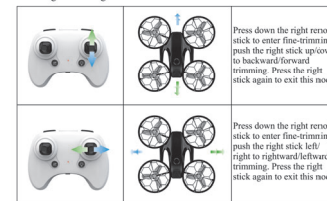

3.7 Altitude Hold / Hover

This is one of the default settings in the drone. When you release the Left Control Stick after the ascending/descending action, the drone will hover at the current flight height. For a stable flight, press the trim buttons to adjust accordingly.

3.8 360° Flip

After flying the drone to a height over 2 meters, press the 360° flip button to activate 360° flip function. Then move the Right Control Stick forward/backward/leftward/rightward to flip the drone accordingly.



▲ This function can't be activated when the battery of the drone is low. (This function only can achieve in the first four minutes of full charge)

8

3.9 Headless Mode

1. To ensure headless mode works well, please ensure correct take off position as below shows.
2. Press the left upper button to active headless function. You will hear one beeps. In this mode, the drone will fly following the direction of the Right Control Stick regardless of the position of your drone's head or the tail. The LED on the drone will flash during headless mode. Press the same button again to exit this mode.

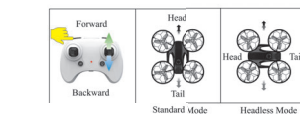
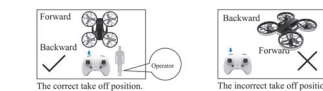

- 3.10 High-Speed Rotation
Long press the High-speed rotation button to make the drone rotate at high speed. The drone automatically goes into headless mode. Long press the button again to exit this mode.



9

3.11 Speed Switch

The drone is set to low speed by default. Press down the left joystick once for medium speed and there are two beeps from the remote. Press it down again for high speed and there are three beeps from the remote. A third press will get back to low speed and there is one beep from the remote.



| Speed | mph | km/h | m/s |
|-------|------|-------|---------|
| Low | 1-3 | 1-5 | 0.3-1.5 |
| Mid | 4-7 | 6-11 | 1.6-3.3 |
| High | 8-12 | 12-19 | 3.4-5.4 |

▲ When you fly in high wind, please use the high speed to control your drone.

Content

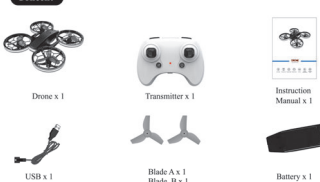

10

This device complies with part 15 of the FCC Rules. Operation is subject to the following two conditions: (1) this device may not cause harmful interference, and (2) this device must accept any interference received, including interference that may cause undesired operation.

Any changes or modifications not expressly approved by the party responsible for compliance could void the user's authority to operate the equipment.

NOTE: This equipment has been tested and found to comply with the limits for a Class B digital device, pursuant to Part 15 of the FCC Rules. These limits are designed to provide reasonable protection against harmful interference in a residential installation. This equipment generates, uses and can radiate radio frequency energy and, if not installed and used in accordance with the instructions, may cause harmful interference to radio communications. However, there is no guarantee that interference will not occur in a particular installation.

If this equipment does cause harmful interference to radio or television reception, which can be determined by turning the equipment off and on, the user is encouraged to try to correct the interference by one or more of the following measures:

- Reorient or relocate the receiving antenna.
- Increase the separation between the equipment and receiver.
- Connect the equipment into an outlet on a circuit different from that to which the receiver is connected.
- Consult the dealer or an experienced radio/TV technician for help.

The device has been evaluated to meet general RF exposure requirement. The device can be used in portable exposure condition without restriction