

GEONFINO



Smart Lock
Model No.G5 Pro
Installation instruction



FINGERPRINT



PASSWORD



APP



RFID CARD



BLUETOOTH

Please keep and read this instruction before installation, we also prepared instruction video to help on Amazon Page. If you need further assistance, please contact Customer Service by email: geonfino@afterservice.vip

Table of Contents

- < 1 > Installation Video
- < 2 > Installation Guide
- < 11 > How to Use
- < 12 > Programming Instructions
- < 13 > APP Guide
- < 22 > Auto Re-lock Mode
- < 23 > Gateway management
- < 24 > Low Power/Emergenct Power
- < 24 > Factory Default Settings
- < 25 > Restore Factory Settings
- < 25 > Troubleshooting
- < 26 > FCC Warning
- < 27 > About GEONFINO

Installation Video



Please scan the QR code to watch installation video for the smart lock before you install it.

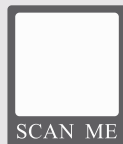

1.How to Confirm the direction of the door



2.How to add a RFID card

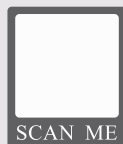

3.How to restore Factory Settings



For more FAQ Videos,please follow us on YouTube

Installation Guide

What is inside

A.Latch

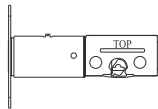

B.Keypad



C.Battery Cover

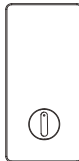

D.Interior Assembly

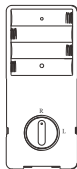

E.Mounting Plate



F.Strike/Strike Box

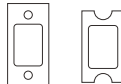

G.Waterproof Rubber Pad



H.Interior Assembly Screws



I/J.Mounting Plate Screws



K.Latch / Strike Screws



L.RFID Card



M.Keys

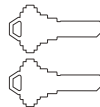

1 Prepare the door and check dimensions

- A** Measure to confirm that the backset is either 2-3/8" or 2-3/4" (60 or 70 mm) .

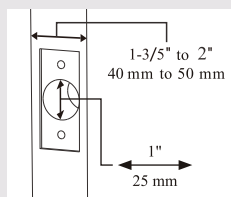
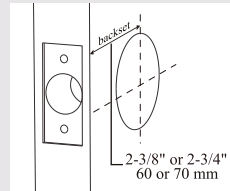

- B** Measure to confirm that the hole in the door edge is 1"(25mm). And measure to confirm that the door is 1-3/5" to 2"(40 mm to 50 mm)thick.

2 Install the latch and strike

- A** Hold the latch in front of the door hole, with the latch face flush against the door edge.

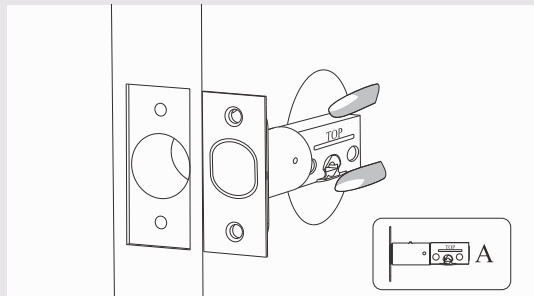

Is the slotted hole centered in the door hole?

YES

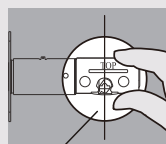

Slotted hole is centered.

No adjustment is required. Proceed to next step.

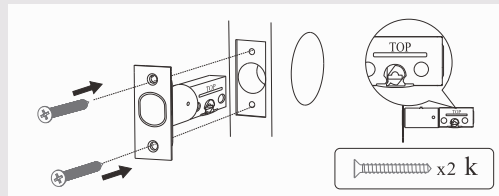

NO

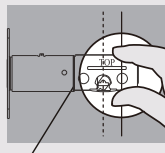

Slotted hole is not centered.



Rotate and pull the latch as shown to extend latch.

a

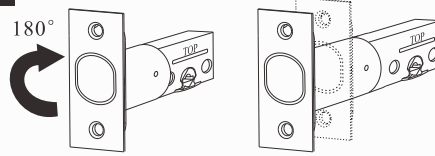

Rotate the head of latch 180°

b

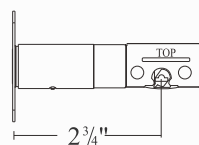

B

Use a screwdriver to test if deadbolt works smoothly. When the screwdriver turn, the deadbolt would be lock/unlock.

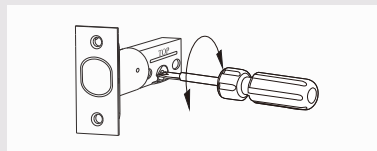

C Install strike on the door frame.

⚠ IMPORTANT: Make sure hole in door frame is drilled a minimum of 1" (25 mm) deep.

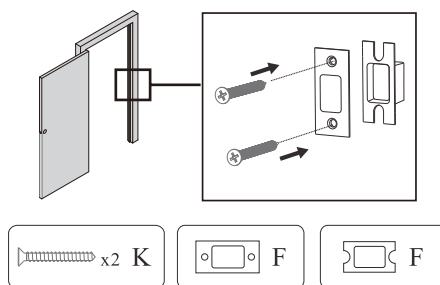

3 Installation instructions

A **⚠ IMPORTANT:** Before installation, make sure the latch is fully retracted (in the unlocked position) .

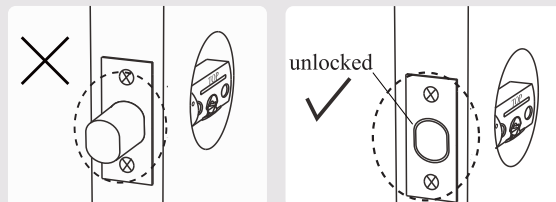

B Install Keypad

If the hole is bigger than 2 1/8"(54mm),install the keypad directly

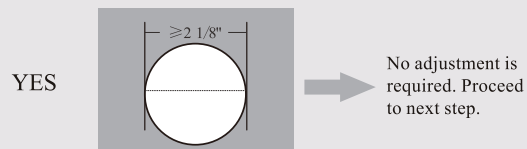

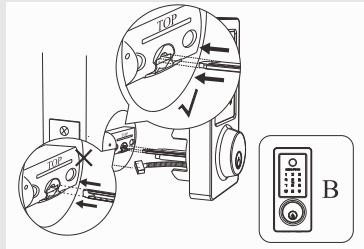

Please ensure the tail bar is Horizontal \triangle during installation. The IC wired need to under the deadbolt.

NO

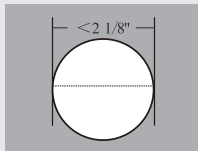

Remove the hole cover

a

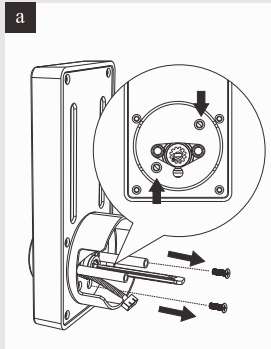

Remove screw from hole cover

b

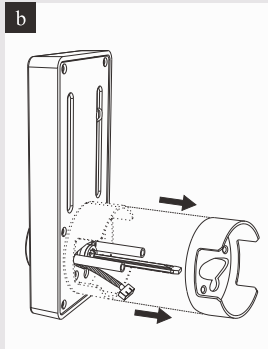

Remove the hole cover

c

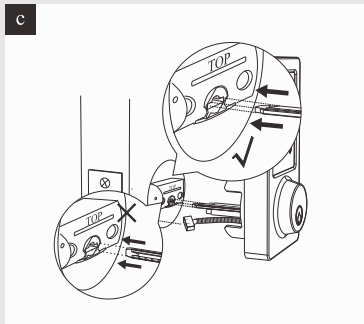

Please ensure the tail bar is Horizontal \triangle during installation. The IC wired need to under the deadbolt.

C Install Mounting Plate

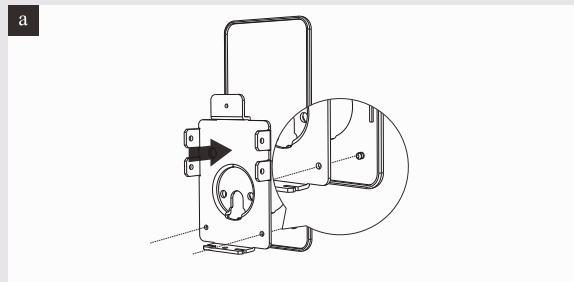

Put the mounting plate on the waterproof rubber pad

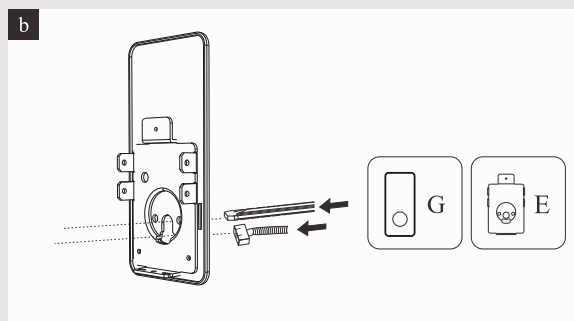

The IC wired and tail bar go through the hole of mounting plate

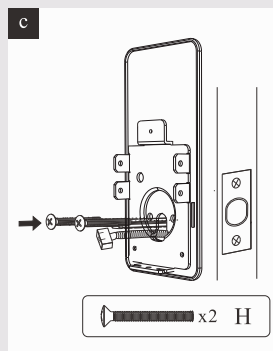

Secure the mounting plate with the supplied screws.

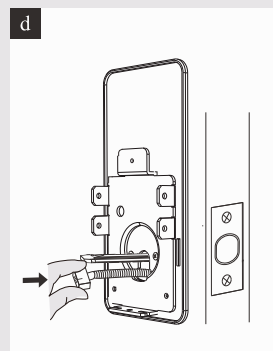

Make sure the IC wired not too long.

D Confirm the direction of the door

 **Look at the door from the OUTSIDE**

Left Hand Door

Right Hand Door

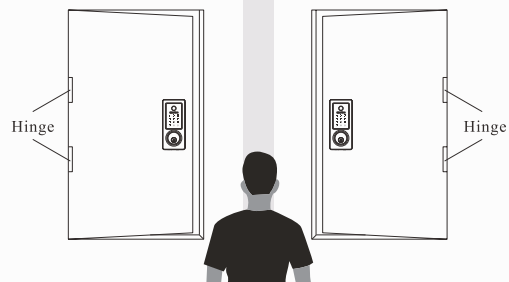

Adjust the Toggle Switch (in the bottom right corner of the back panel) and Turn Piece.

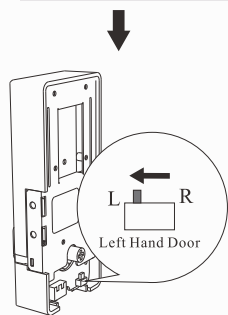

Flip to L for Left-handle

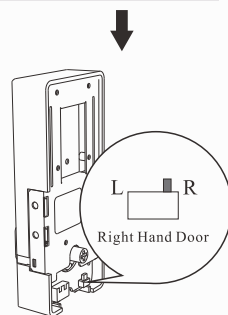

Flip to R for Right-handle

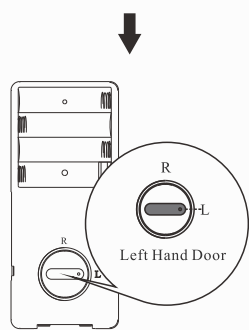

Horizontal for Left-handle

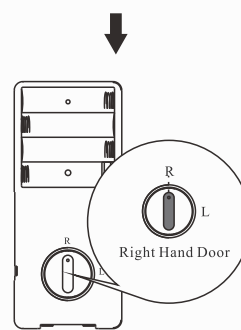

Vertical for Right-handle

E Install Interior Assembly

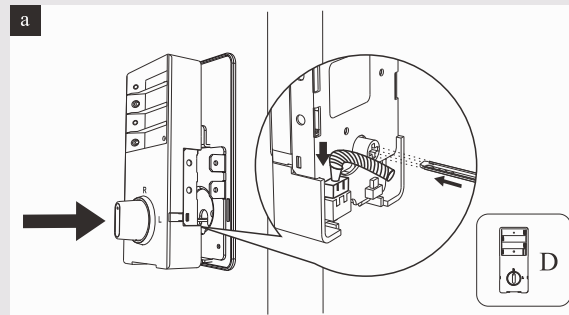

Connect the cable and ensure tight cable connection. And the tail bar insert the turnpiece hole.

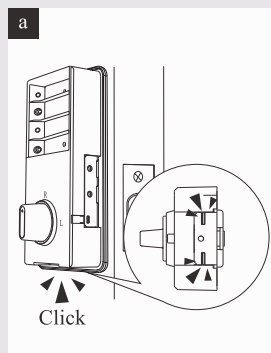

Install the interior assembly on mounting plate and make sure they click on together

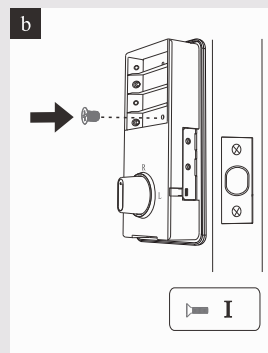

Secure the interior assembly with the supplied screws.

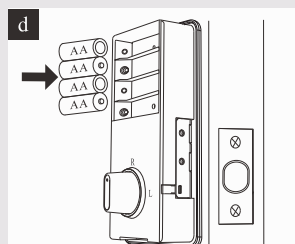

Load 4 AA batteries into the interior assembly.

⚠ IMPORTANT: For best results, use new, non-rechargeable Alkaline batteries only.

F Install Battery Cover

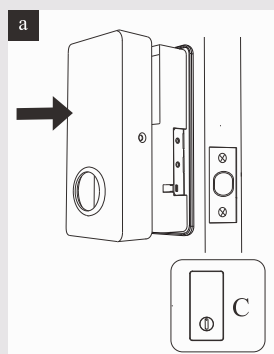

Install battery cover

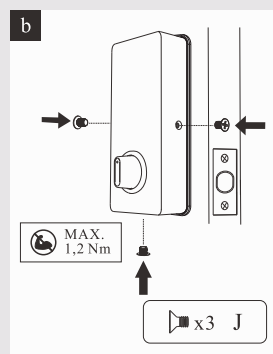

Secure the interior assembly with the supplied screws.

How to Use

LOCK the door from outside

Manual Mode

Press "✓" key on keypad for 3 seconds.



LOCK the door from inside

Manual Mode

Rotate the thumb turn to Lock position.



UNLOCK the door from outside

RFID Card



Key

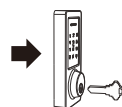

RFID Card needs to be added first

Master/
User
code



FingerPrint



UNLOCK the door from inside

Rotate the thumb turn to
Unlock position.

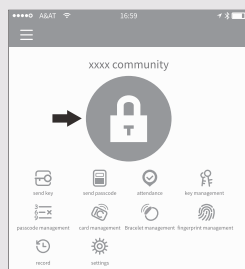

Via APP

Long press "🔒" to LOCK the door from outside or inside. Click "🔓" to UNLOCK the door from outside or inside.

Note : Please keep your phone near the door lock within 32.8ft(10m).

Programming Instructions

Information & Safety Warnings

- Protect your User Codes and Master Code.
- Protect your key. It is suggested to put it outside the door, such as your car.
- Restrict access to your lock's interior assembly and routinely check your settings to ensure they have not been altered without your knowledge.
- This lockset is designed to provide the highest standard of product quality and performance. Care should be taken to ensure a long-lasting finish. When cleaning is required use a soft, damp cloth. Using lacquer thinner, caustic soaps, abrasive cleaners or polishes could damage the coating and result in tarnishing.

⚠ IMPORTANT: Do not load batteries until lock is completely installed.

Definitions

Master Code

Required for programming and feature settings. Master code can be used to unlock the door under vacation mode. The default master code needs to be changed before programming. Property owner/manager should keep this information confidential.

- 1.Master Code(6 to 8)digits:The default Master Code is 123456. It is required that you change it to a code of your own before programming.
- 2.User Code(6 to 8)digits:A total of 200 User Codes may be programmed.

Auto Lock

Automatically locks the deadbolt after unlocking. This feature is off by default. You can set the auto lock time in the app.

Wrong Entry Limit

After 5 unsuccessful attempts at entering a valid PIN code, the unit will shut down for 5 minutes.

Unlock with Fake Code

User can prevent PIN code exposure from strangers by entering random digits before or after PIN code.

83618 137192 14710

 password
----- Random digits -----

< 12 >

APP Guide

A Download APP "TTLock "



Android Mobile Phone--Search "TTLock" from Google Play.
Apple Mobile Phone--Please search "TTLock" from App Store.

B Register a new account(phone number or email)

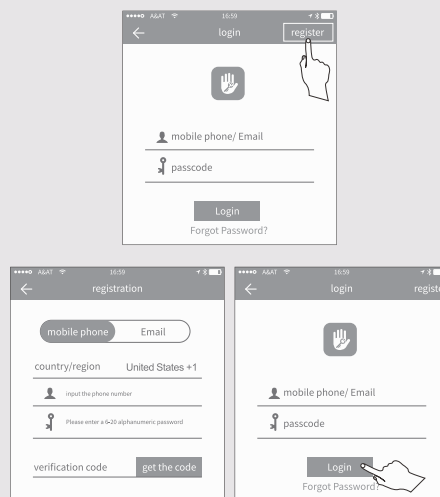

C Lock adding

- a Turn on Bluetooth and enter the interface of adding lock in app.

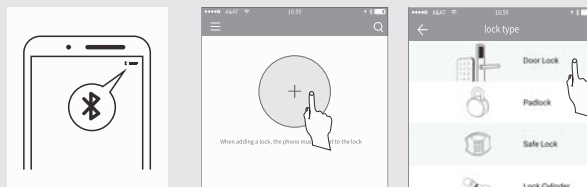

b Light up the screen and add the lock

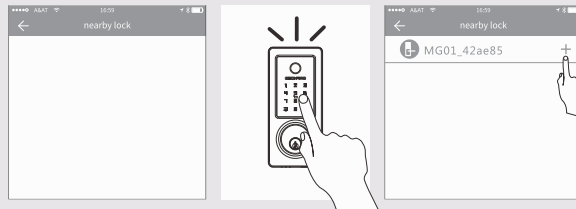

Note: Please keep your phone near the door lock within **10** meters.

D Key management

After the administrator successfully adds the lock, owner owns the highest administrative rights to the lock. owner can send keys to others. Meanwhile owner can increase the key management that is about to expire.

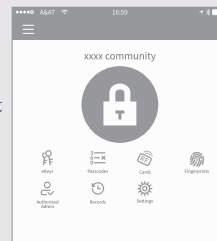

Click the type of lock it will show the time-limited ekey, one-time ekey and permanent ekey.

Time-limited ekey: The ekey is valid for the specified time.

Permanent ekey: The ekey can be used permanently.

One-time ekey: The ekey will be automatically deleted once it has been used.

