

DREO

Air Circulator Fan

USER MANUAL

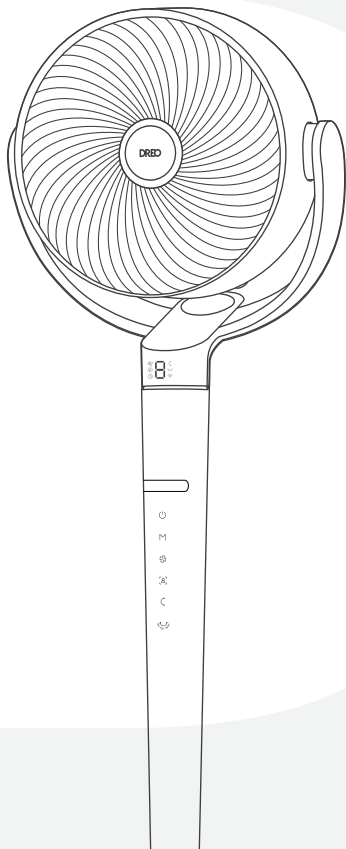

//

Thanks for Choosing **DREO!**

Your support means the world to us. We hope you enjoy our product as much as we did creating it.

CONTENTS

01

IMPORTANT SAFETY
INSTRUCTIONS

1-2

02

ASSEMBLING YOUR
PEDESTAL AIR
CIRCULATOR

3-5

03

CONNECTING TO YOUR
PEDESTAL AIR CIRCULATOR

6

04

KNOWING YOUR
PEDESTAL AIR
CIRCULATOR

7-8

05

USING YOUR PEDESTAL
AIR CIRCULATOR

9-13

06

CLEANING
AND MAINTENANCE

14-16

07

TROUBLESHOOTING

17

08

DREO CUSTOMER
CARE

18-20

IMPORTANT SAFETY INSTRUCTIONS

01



READ ALL CAUTIONARY MARKINGS ON THE APPLIANCE AND SAFETY INSTRUCTIONS IN THE USER MANUAL BEFORE USE.



Do not cover the air inlet and outlet while in operation.



Do not use the air circulator near flammables and combustibles.

General Safety

1. Children shall not play with the appliance. Cleaning and maintenance shall not be performed by children without supervision.
2. Use the appliance as described in the user manual only. Any other use not recommended in the user manual may cause fire, electrical shock, or personal injury.
3. This appliance is not intended for use by persons (including children) with reduced physical, sensory or mental capabilities, or lack of experience and knowledge, unless they have been given supervision or instruction concerning use of the appliance by a person responsible for their safety.

Operation Safety

1. Place the appliance on a flat, dry surface before use.
2. **Do not** immerse in water and any other liquids.
3. **Do not** use the appliance until the base is installed.
4. **Do not** insert your fingers, pencil and any other objects into the grilles under any circumstances.
5. **Do not** attempt to repair or modify any electrical or mechanical functions on the appliance. Doing so will void your warranty. All servicing should be performed by qualified personnel only.
6. Ensure that the fan is switched off from the supply mains before removing the guard.

Electricity Safety

1. Make sure that the voltage of your electricity supply is the same as that indicated on the appliance.
2. Always unplug before cleaning or leaving the appliance unused for a long period of time. Keep your hands dry when plugging/unplugging.
3. Do not operate any air circulator with a damaged cord or plug. Discard air circulator or return to an authorized service facility for examination and/or repair.
4. Do not run cord under carpeting. Do not cover cord with throw rugs, runners, or similar coverings. Do not route cord under furniture or appliances. Arrange cord away from traffic area and where it will not be tripped over
5. **WARNING:** To Reduce The Risk Of Fire, Electric Shock Or Injury To Persons, Do Not Use Replacement Parts That Have Not Been Recommended By The Manufacturer (e.g. Parts Made At Home Using A 3D Printer).
6. **WARNING:** To Reduce The Risk Of Fire Or Electric Shock, Do Not Use This Fan With Any Solid-State Speed Control Device.
7. The appliance shall not be modified by users, such as by adding supplemental filters to the appliance.

FOR HOUSEHOLD USE ONLY READ AND SAVE THESE INSTRUCTIONS

Gentle Reminder:



Check the appliance regularly and refer to TROUBLESHOOTING or contact our customer support if it shows any of the following signs:

- Power cord or plug is damaged.
- Loud noise, unusual smell or excessive heat.

Specifications

| | |
|---------------|--|
| Model No. | DR-HPF007S |
| Power Supply | 24V \equiv 2A |
| Rated Power | 48W |
| Power Adapter | Input: 100-240V – 50/60Hz 1.2A Output: 24V \equiv 2.0A |
| Battery Type | CR2025 3V |

ASSEMBLING YOUR PEDESTAL AIR CIRCULATOR

02

Assembly Instructions

When using the appliance for the first time, remove the wraps and attach the parts by following the steps below.

1

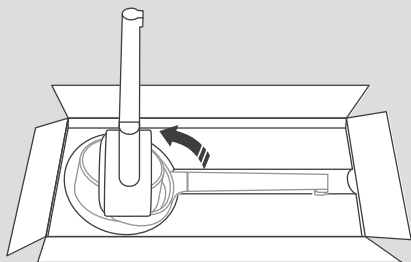

Turn the fan body
upside down.

2



Install the short pedestal into the fan
body column by rotating the pedestal
until tightened.

3

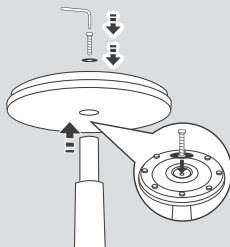

Push the column into the base, then
thread the screw through the flat
washer and use the included
screwdriver to drive the screw into the
bottom of the column.

4

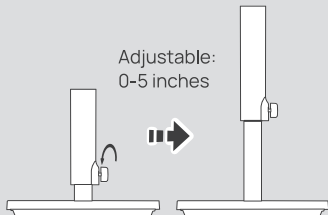

Turn the pedestal air circulator fan right side up. Hold the main body while rotating the Adjustment Collar counterclockwise to raise or lower the air circulator to the desired height.

5

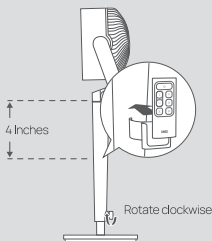

Tighten the adjustment collar and install the remote control holder

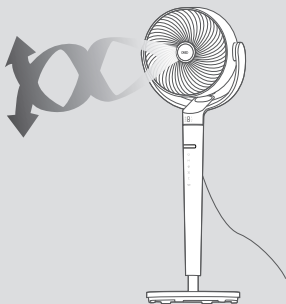

CAUTION

Do not operate the air circulator if the base has not been installed.

Please exercise caution and handle the base with care during installation.

Package Contents

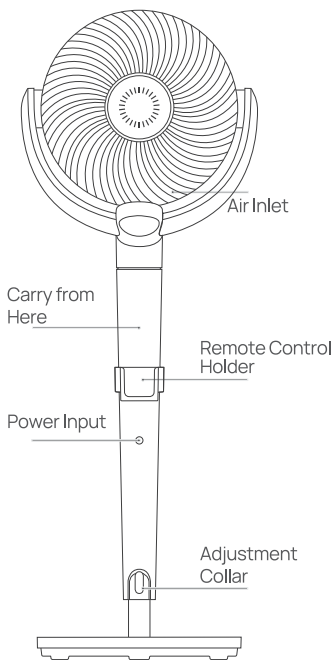
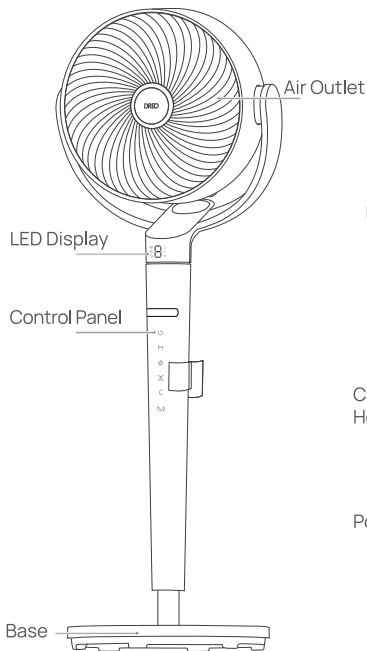

Remote Control
(Battery Included)



Power Adapter



Screw
for Base



Screwdriver
for Base



Flat Washer



Remote
Control Holder

CONNECTING TO YOUR PEDESTAL AIR CIRCULATOR

03



Before connecting the appliance to your mobile device, please scan the QR code on the left or go to the app store and search “DREO”, then select and download the app.







Look for “TurboPoly™ Fan 707S” when connecting your new pedestal air circulator



You can use the DREO app to connect your smart pedestal air circulator to **Amazon Alexa** or **Google Home**. Please follow the in-app instructions to set up your voice assistant.

NOTE: You must create a DREO account to access voice assistants.

- 1 Launch DREO and sign in or create account by following in-app instructions.
- 2 Enable Bluetooth on your mobile device and plug in your air circulator.
- 3 Hold the Oscillation button  for 5 seconds to start WiFi connection settings.
(Tip: The WiFi icon  will keep flashing when pairing.)
- 4 Tap + Add Device and select TurboPoly™ Fan 707S.
- 5 Follow in-app instructions to complete WiFi connection.
- 6 You're now ready to control the appliance on your app.
(Tip: To restart network setup, hold the button  again for 5 seconds. Long press 10 seconds power button  to unpair WiFi and restore factory settings.)

KNOWING YOUR PEDESTAL AIR CIRCULATOR

04

Control Panel



Power Button

- Turn power on/off
- Long press 10 seconds to reset to factory settings.



Mode Button

- Switch between Normal/Auto/Turbo
- Long press for 3 seconds to mute/unmute



Fan Speed Button

- Adjust airflow speed (1-9 levels)



Dynamic Wind Motion Button

- Automatically detects and directs airflow towards the area with the strongest movement.
- Fan speed auto-adjusts based on your distance (3-9 levels).
- The indicator light turns red when tracking.
- The timer function is disabled during use.
- Switches to 150° oscillation if no movement is detected for 5 seconds.



Vertical Oscillation Button

- Touch to change the vertical angle.
- Display will flash  & 0/1/2/3 indicating the current angle 0°/30°/60°/90°



Horizontal Oscillation Button

- Touch to change the horizontal angle.
- Display will flash  & 0/1/2/3/4/5 indicating the current angle (0°/30°/60°/90°/120°/150°) Long press for 5 seconds to start network settings and device pairing.

Note: This appliance is muted by default. To turn on button sounds, go to the DREO app.

LED Display



Normal Mode



Auto Mode



Timer



Fan Speed / Timer
Hour / Oscillation
Angle



Vertical
Oscillation



Horizontal
Oscillation



WiFi

USING YOUR PEDESTAL AIR CIRCULATOR

05

Getting the Most out of Your Air Circulator

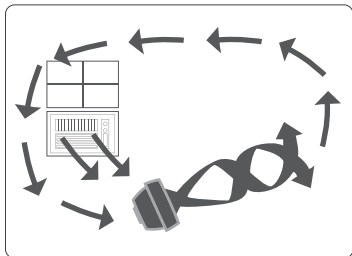

Summer:

Use with Air Conditioner

Position the air circulator in front of your AC to circulate cold air and provide better cooling.

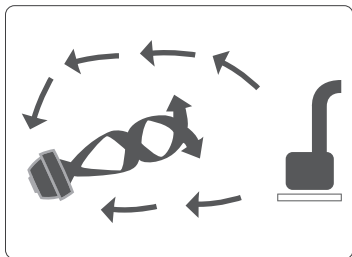

Winter:

Use with Heater

Send the heat to corner of the room and circulate warm air faster.

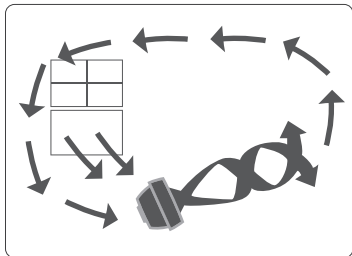

Spring & Fall:

Circulation

Make the indoors as fresh and pleasant as the outdoors.

Working Modes (Press on the remote)



Normal Mode

Air circulator runs at the fixed speed.



Auto Mode

Air circulator speed adapts to the ambient temperature.



Turbo Mode

Air circulator runs at the maximum speed.



Natural Mode

(Available in the DREO app)

Air circulator runs at alternating speeds.



Custom Mode

(Available in the DREO app)

Air circulator speed changes according to temperatures or time you desire.



Sleep Mode

(Available in the DREO app)

Balance comfort and noise by automatically decreasing fan speed as you fall sleep.

If the fan speed is higher than 3, it will decrease two times at most, one speed every 30 minutes, then it will remain constant.

If the fan speed is 3 or lower it will remain constant.

Additional Features



Timer

When the fan is ON/OFF, touch the timer button  repeatedly to set a timer from 1 to 8 hours. When the timer ends, the fan will stop/start running automatically. To cancel, set the time to 0 hour.

Note: When the auto off timer is enabled, display will return to fan speed after 3 seconds. Display will show 8 if the timer is beyond 8 hours. To set a timer beyond 8 hours, please go to the DREO app.



Child Lock

Long press the Mode button  and Vertical Oscillation button  at the same time for 3 seconds to turn on/off Child Lock.

Note: Child Lock doesn't apply to operations from the remote control and the DREO app. You can also turn off Child Lock by re-plugging in, resetting to factory settings, or through the DREO app.



Memory

If the fan is turned OFF or disconnected from power, it will operate under the previous settings (except the Timer setting) when it is turned ON again.



Firmware Update

Check the firmware version on the DREO app and update regularly for the air circulator to work more efficiently.



Display will show "U" during the update process.
Do not operate until the update is completed.



Countdown Display

When long pressing buttons for Factory Reset, Child Lock, and Mute, a countdown will show on the display accordingly.



Display Auto Off

Display turns off after 5 seconds of non-use in dark environment or in sleep mode.

Wake up the display with any button.

To disable this feature, please go to the DREO app.

Remote Control

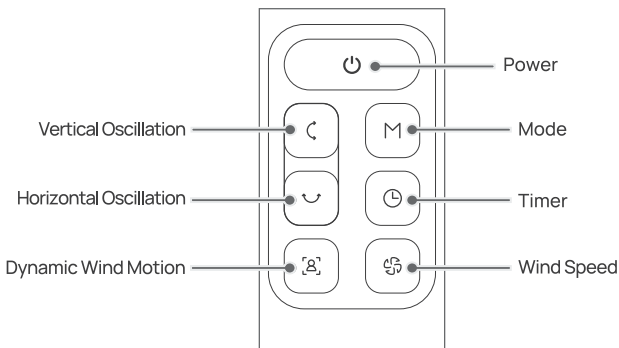

Battery Replacement

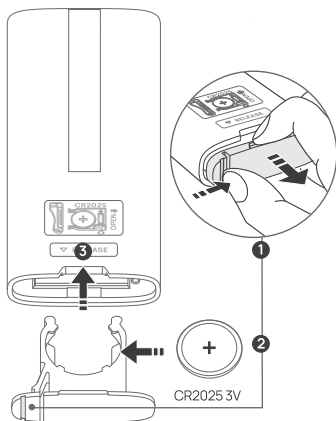

- 1 Keep the locking tab pressed while pulling out the battery holder from the slot at the back.
- 2 Replace with the same battery type with the (+) side facing up.
- 3 Push in the holder until securely locked in place.

Note: If the appliance doesn't respond when using the remote control in close range please consider replacing the battery.



WARNING

- **INGESTION HAZARD:** This product contains a button cell or coin battery
- **DEATH** or serious injury can occur if ingested.
- A swallowed button cell or coin battery can cause **Internal Chemical Burns** in as little as **2 hours**.
- **KEEP** new and used batteries **OUT OF REACH of CHILDREN**
- **Seek immediate medical attention** if a battery is suspected to be swallowed or inserted inside any part of the body.



- a) Remove and immediately recycle or dispose of used batteries according to local regulations and keep away from children. Do NOT dispose of batteries in household trash or incinerate.
- b) Even used batteries may cause severe injury or death.
- c) Call a local poison control center for treatment information.
- d) Compatible battery type: CR2025.
- e) Battery nominal voltage: 3.0 Vdc
- f) Non-rechargeable batteries are not to be recharged.
- g) Do not force discharge, recharge, disassemble, heat above (rated temperature: 140 °F) or incinerate. Doing so may result in injury due to venting, leakage or explosion resulting in chemical burns.
- h) Ensure the batteries are installed correctly according to polarity (+ and -).
- i) Do not mix old and new batteries, different brands or types of batteries, such as alkaline, carbon-zinc, or rechargeable batteries.
- j) Remove and immediately recycle or dispose of batteries from equipment not used for an extended period of time according to local regulations.
- k) Always completely secure the battery compartment. If the battery compartment does not close securely, stop using the product, remove the batteries, and keep them away from children.

CLEANING AND MAINTENANCE

06

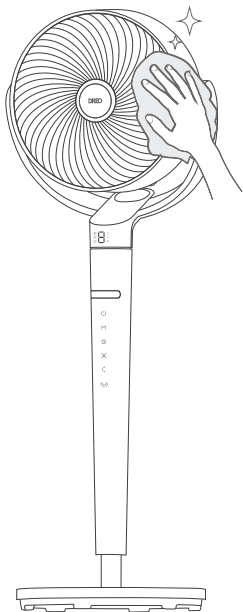

Outer Surface

Gently wipe off the dust with a soft, dry cloth.

Base

The base can be disassembled in the reverse order of assembly.

CAUTION



1. Always unplug the fan before any cleaning or maintenance to avoid the risk of fire, electric shock, or injury to persons.
2. Do not immerse in water or get water inside the motor housing.
3. Do not use any chemical agents when cleaning the fan.
4. Store in a cool, dry place and cover it to protect from dust.



WARNING

To reduce the risk of electrical shock and injury to persons, turn off and unplug the appliance before any cleaning and maintenance.

1

Front

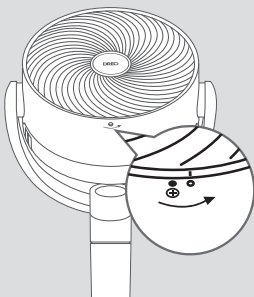

Remove the screws on the front and rear grilles, rotate the grilles counterclockwise to take them off.

2

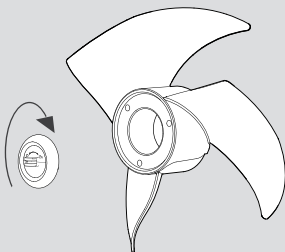

Remove the blade cap by rotating it as shown and take the blade assembly out of the shaft.

3

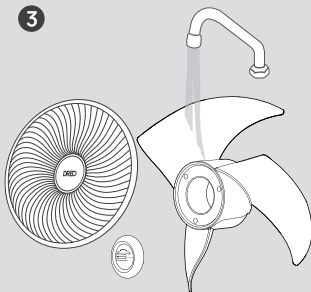

Rinse cap, blades, and grilles under running water or with a clean, damp cloth.

4

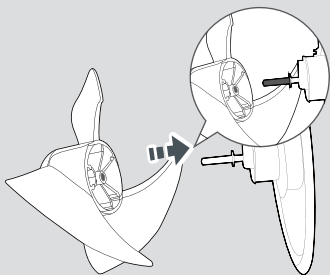

Dry up all parts, and insert the blade assembly back into the shaft by aligning the D-shaped points on the center.

5

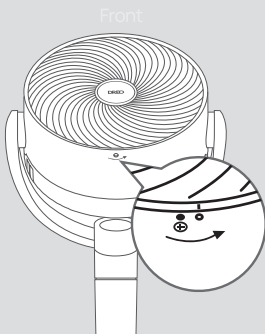

Align the point on the front grille with the right point on the casing, then rotate the grille clockwise and install the screw back in place. Repeat the steps for the rear grille.

My air circulator won't turn on!

Make sure that the cord is connected to a powered outlet and the mains voltage corresponds with the voltage indicated on the air circulator.

My air circulator is shaky and wobbling!

1. Place the air circulator on a flat, level surface.
2. Incorrect installation might also cause shakiness. Please refer to the assembly instructions in page 3- 4.

My air circulator is making vibration and noise!

1. Place the air circulator on a flat, level surface.
2. Be sure not to insert anything into the air inlet and outlet.

If your problem is not listed or still persists, please contact our Customer Support (see page 20)

DREO CUSTOMER CARE 08

12-MONTH LIMITED WARRANTY

What is Covered

DREO warrants to you that your product will be free from original defects in materials and workmanship for a period of twelve (12) months from the date of your purchase, when you use your product for intended purposes in accordance with this User Manual.

Please retain your proof of purchase. If you do not retain your proof of purchase, your warranty will start two (2) months from the date of manufacture printed on your product label.

What is Not Covered

This limited warranty only applies to the original purchaser of your product and is non-transferable. This warranty is only valid if your product is used in the country in which you originally purchased it. In addition, this warranty will not apply, and DREO will not be liable for any costs, damages, or repairs, in connection with any of the following:

- Accidents or use of your product with inappropriate force;
- Damage or destruction caused by wrong voltage or unstable electric current;
- Normal wear and tear;
- Careless operation or handling, misuse, abuse, neglect, and/or failure to maintain or use your product in accordance with this User Manual;
- Any partially or completely altered, modified and/or dismantled products;
- Reduction in battery discharge time due to battery age or use (as applicable);
- Products with altered or removed serial numbers;
- Clearing any blockages from the product;
- Purchases from retailers and distributors not authorized by DREO to sell this product;
- Defects caused by or resulting from damages from shipping or handling by any third party not authorized by DREO to ship or handle your product; or
- Defects caused by or resulting from repairs, service, improper maintenance, or alteration to your product or any of its components by anyone other than a repair person authorized by DREO.

Any service and customer support that DREO provides to you under this limited warranty will not extend the duration of this limited warranty.

Warranty Limitations and Exclusions

ANY IMPLIED WARRANTIES RELATING TO YOUR PRODUCT, INCLUDING BUT NOT LIMITED TO THE WARRANTY OF MERCHANTABILITY AND THE WARRANTY OF FITNESS FOR A PARTICULAR PURPOSE, ARE LIMITED TO THE DURATION OF THE LIMITED WARRANTY SET FORTH ABOVE AND ARE OTHERWISE DISCLAIMED.

THIS LIMITED WARRANTY SHALL BE THE SOLE REMEDY OF THE PURCHASER OR USER OF THE PRODUCT, AND DREO SHALL NOT BE LIABLE FOR AN ALLEGEDLY DEFECTIVE OR DAMAGED PRODUCT EXCEPT TO REPAIR OR REPLACE IT IN ACCORDANCE WITH THIS LIMITED WARRANTY. DREO WILL NOT BE LIABLE FOR SPECIAL, INCIDENTAL, INDIRECT, CONTINGENT, OR CONSEQUENTIAL DAMAGES OR LOSSES OF ANY NATURE THAT YOU MAY INCUR IN CONNECTION WITH YOUR PURCHASE OR USE OF YOUR PRODUCT.

Some jurisdictions do not allow limitations on how long an implied warranty lasts or the exclusion or limitation of incidental or consequential damages, so the above limitations or exclusions may not apply to you. This limited warranty gives you specific legal rights, and you also may have other rights which vary from jurisdiction to jurisdiction.

Limited Remedies

If your product fails because of an original defect in material and/or workmanship during the warranty period, DREO will repair or replace (in DREO's sole discretion) your product.

To obtain warranty service on your product, contact us at support@dreo.com or at (888) 290-1688 (available from Monday-Friday, 9:00 AM-5:00 PM PST/PDT) for further instructions.

IN THE EVENT OF AN ORIGINAL DEFECT IN MATERIAL AND/OR WORKMANSHIP, TO THE EXTENT PERMITTED BY LAW, THE REMEDIES SET FORTH IMMEDIATELY ABOVE ARE YOUR SOLE AND EXCLUSIVE REMEDIES.

FCC Statement

This device complies with Part 15 of the FCC Rules. Operation is subject to the following two conditions: (1) this device may not cause harmful interference, and (2) this device must accept any interference received, including interference that may cause undesired operation.

Please note that changes or modifications of this product is not expressly approved by the party responsible for compliance could void the user's authority to operate the equipment.

NOTE: This equipment has been tested and found to comply with the limits for a Class B digital device, pursuant to Part 15 of the FCC Rules. These limits are designed to provide reasonable protection against harmful interference in a residential installation. This equipment generates, uses and can radiate radio frequency energy and, if not installed and used in accordance with the instructions, may cause harmful interference to radio communications. However, there is no guarantee that interference will not occur in a particular installation.

If this equipment does cause harmful interference to radio or television reception, which can be determined by turning the equipment off and on, the user is encouraged to try to correct the interference by one or more of the following measures:

- Reorient or relocate the receiving antenna.
- Increase the separation between the equipment and receiver.
- Connect the equipment into an outlet on a circuit different from that to which the receiver is connected.
- Consult the dealer or an experienced radio/TV technician for help.

This equipment complies with FCC radiation exposure limits set forth for an uncontrolled environment. This equipment should be installed and operated with a minimum distance of 20cm between the radiator & your body. This transmitter must not be co-located or operating in conjunction with any other antenna or transmitter.

Model No.: DR-HPF007S
Rev_1.0_EN

We're Here to Help!

 **(888) 290-1688** Mon - Fri, 9:00 am-5:00 pm PST/PDT

 **support@dreo.com**

 **www.dreo.com**

 **Shenzhen Hesung Innovation Technology Co., LTD**

 **26F, Bldg A7, Creative City, Shenzhen, China**



MADE IN CHINA

www.dreo.com

Looking for help?

Contact us to get expert support.



support@dreo.com



[\(888\) 290-1688](tel:(888)290-1688)



www.dreo.com

Mon - Fri, 9:00 am-5:00 pm PST/PDT