

DREO

Smart Dehumidifier DH711S

USER MANUAL

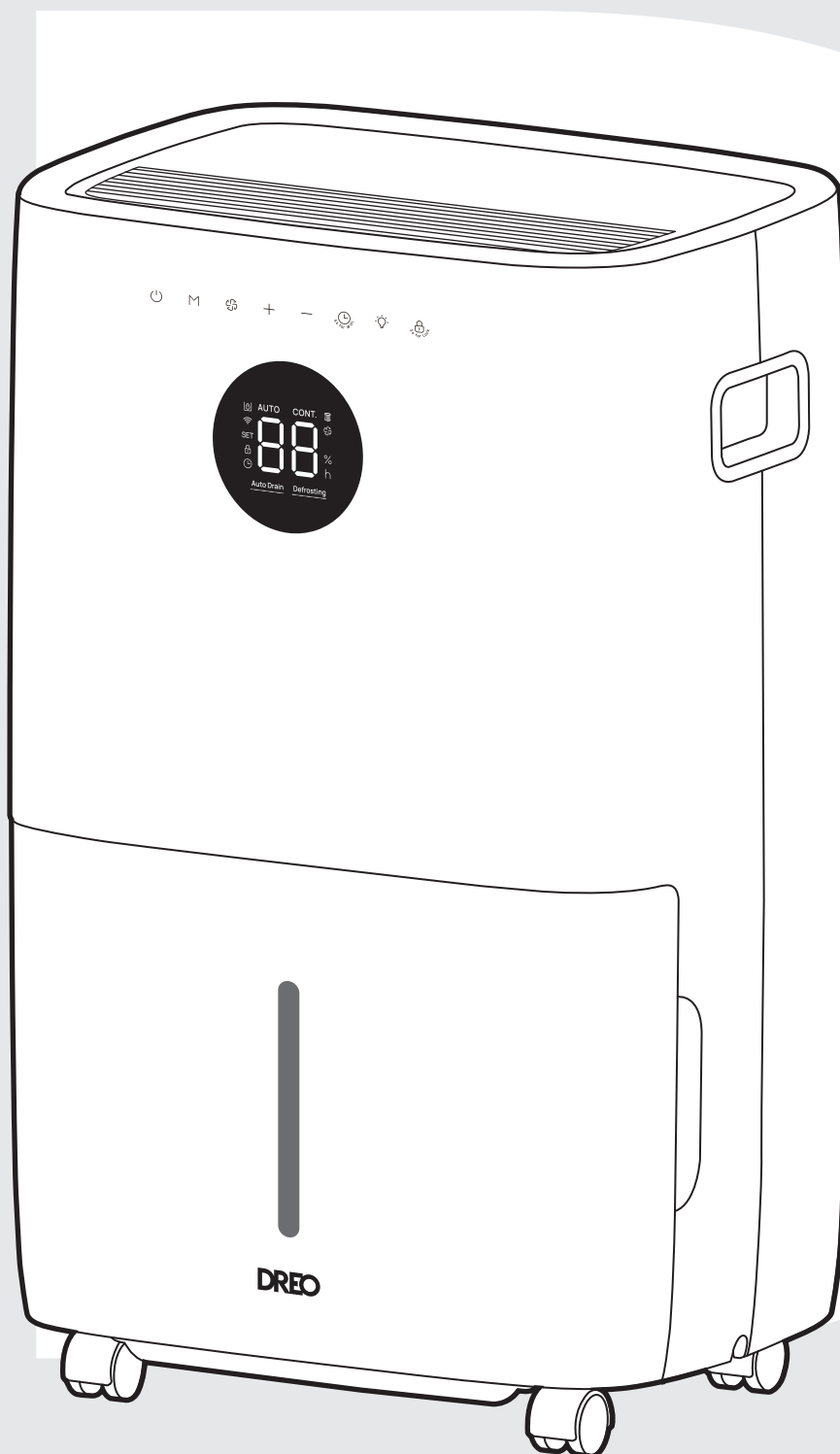

//

Thanks for Choosing **DREO!**

Your support means the world to us. We hope you enjoy our product as much as we did creating it.

EXTEND YOUR WARRANTY FOR FREE

Scan or visit dreo.com/warranty

To extend your warranty for free by registering your product. If you have any product issues, we always stand ready to help.



support@dreo.com



www.dreo.com



(888) 290-1688

Mon - Fri, 9:00 am-5:00 pm PST/PDT

Find the digital version of this manual at
support.dreo.com/en/support/product

CONTENTS

01

IMPORTANT SAFETY INSTRUCTIONS

1-3

02

KNOWING YOUR APPLIANCE

4

03

USING YOUR APPLIANCE

5-8

04

CONNECTING TO YOUR APPLIANCE

9

05

CLEANING AND MAINTENANCE

10-13

06

TROUBLESHOOTING

14

07

DREO CUSTOMER CARE

15

IMPORTANT SAFETY INSTRUCTIONS

01



DANGER

DANGER - This symbol indicates immediate hazards which **WILL** result in severe personal injury or death



WARNING

WARNING - This symbol indicates hazards or unsafe practices which **COULD** result in severe personal injury or death



CAUTION

CAUTION - This symbol indicates hazards or unsafe practices which **COULD** result in minor personal injury



WARNING

When using electrical appliances, basic safety precautions should be followed, including the following

General Safety

1. To reduce risk of injury, read this guide before using the appliance.
2. This appliance is not intended for use by persons (including children) with reduced physical sensory or mental capabilities or lack of experience & knowledge, unless they have been given supervision or instruction concerning the use of the appliance by a person responsible for their safety.
3. Children should be supervised to ensure that they do not play with the appliance.
4. Always unplug the air conditioner before servicing or moving the unit.

Electrical Safety

1. This appliance must be connected to proper electrical outlet with the correct electrical supply.
2. Proper grounding must be ensured to reduce the risk of shock and fire. **DO NOT CUT OR REMOVE THE GROUNDING PRONG.** If you do not have a three-prong electric receptacle outlet in the wall, have a certified electrician install the proper receptacle. The wall receptacle **MUST** be properly grounded.
3. **DO NOT USE AN ADAPTER OR AN EXTENSION CORD.**
4. Do not place any object on the top of the unit.
5. If the **SUPPLY CORD** is damaged, it must be replaced by the manufacturer, a service agent or similarly qualified persons in order to avoid a hazard.
6. This appliance shall be installed in accordance with national wiring regulations.

Operation Safety

1. Do not use this appliance near a bathtub, shower or wash basin.
2. Never operate this appliance without filters in place.
3. Do not operate this appliance if the power cord is frayed or otherwise damaged. Avoid using this appliance if there are any cracks or abrasion damage along the length, plug connector or if the unit malfunctions or is damaged in any manner. Contact an authorized service technician for examination, repairs or adjustments.
4. Do not block the airflow around this appliance. The exhaust hose should be free of any obstructions.
5. Do not install or use this appliance in any area where the atmosphere contains combustible gases or where the atmosphere is oily or sulphurous. Avoid any chemical coming in contact with this appliance.

Handling Alkaline Batteries



WARNING

When handling alkaline batteries, basic safety precautions should be followed, including the following

1. Should fluid from the battery accidentally get into your eyes, there is a threat of loss of eyesight, do not rub them. Immediately rinse your eyes with clean tap water and then consult a physician immediately.
2. Do not put the battery in a fire, expose it to heat, dismantle or modify it. If the insulation or safety valve is damaged, the battery may leak fluid, overheat or explode.
3. Do not insert the battery with the poles reversed. Doing so may cause some abnormality or a short and the battery may leak fluid, overheat or explode.
4. Keep the battery out of the reach of children. If the battery is swallowed, contact a physician immediately.
5. If the alkali fluid gets in your mouth, rinse your mouth with water and contact a physician immediately.
6. If the alkali fluid gets on your skin or clothes, it may burn your skin, thoroughly rinse the affected area with tap water.
7. Do not mix new and old batteries or other makes of batteries. The different attributes may cause the battery to leak fluid, overheat or explode.
8. This battery was not made to be recharged. Recharging this battery may damage the insulation or internal structure and may cause the battery to leak fluid, overheat or explode.
9. Do not damage or remove the label on the exterior of the battery. Doing so may cause the battery to short, leak fluid, overheat or explode.
10. Do not drop, throw or expose the battery to extreme impact. Doing so may cause the battery to leak fluid, overheat or explode.
11. Do not alter the shape of the battery. If the insulation of safety valve is damaged, the battery may leak fluid, overheat or explode.
12. Immediately remove batteries when they have lost all power. Leaving the batteries in the unit for a long time may cause the batteries to leak fluid, overheat or explode due to gas that is generated by the batteries.
13. Remove the batteries from the unit when not using the unit for an extended period of time. The batteries may leak fluid, overheat or explode due to gas that is generated by the batteries.
14. Do not apply solder directly to the batteries. The heat may cause the batteries to leak fluid, overheat or explode.
15. Do not get the batteries wet. Doing so may cause the batteries to overheat.
16. Store batteries someplace out of direct sunlight where the temperature and humidity are not high. Not doing so may cause the batteries to leak fluid, overheat or explode. Also, it may cause the life and performance of the batteries to decline.
17. Follow the regulations of the local government when disposing of these batteries.
18. NEVER mix alkaline, standard (carbon-zinc), rechargeable (nickel-cadmium) batteries with this product.

Grounding Instructions

ELECTRICAL REQUIREMENTS

In the event of malfunction or breakdown, grounding provides a path of least resistance for electric current to reduce the risk of electric shock. The appliance must be connected to a cord having an equipment-grounding conductor and a grounding plug. The plug must be plugged into an appropriate outlet that is properly installed and grounded in accordance with all local codes and ordinances.

 **DANGER** - Improper connection of the equipment grounding conductor can result in a risk of electric shock. The conductor with insulation having an outer surface that is green with or without yellow stripes is the equipment grounding conductor. If repair or replacement of the cord or plug is necessary, do not connect the equipment-grounding conductor to a live terminal. Check with a qualified electrician or service person if the grounding instructions are not completely understood, or if in doubt as to whether the appliance is properly grounded. Do not modify the plug connected to the appliance - if it will not fit the outlet, have a proper outlet installed by a qualified electrician.

FOR GROUNDED, CORD-CONNECTED APPLIANCE RATED LESS THAN 15A AND INTENDED FOR USE ON A NOMINAL 120V SUPPLY CIRCUIT

- The appliance is for use on a nominal 115V circuit and should be connected to a grounding outlet that looks like the one illustrated below.
- The use of a temporary adapter is not recommended.

SAFETY GUIDELINES

 **WARNING:** To prevent injury to the user or other people and property damage, the following instruction must be followed. Incorrect operation due to ignoring of instructions may cause harm or damage.





- This appliance should be used in such a way that it is protected from moisture. E.g. condensation, splashed water, etc. Do not place or store this appliance where it can fall or be pulled into water or any other liquid. Unplug immediately.

- Always transport this appliance in a vertical position and stand on a stable, level surface during use.
- Turn off the product when not in use.
- Always use the switch on the control to start or shut off the unit.
- Always contact a qualified person to carry out repairs. If the supply cord is damaged it must be repaired by a qualified technician.
- Keep an air path of at least 12 inches all around the unit from walls, furniture and curtains.
- If the appliance is knocked over during use, turn off the unit and unplug from the power supply immediately.
- Do not operate this appliance in a wet room such as a bathroom or laundry room.
- Do not touch the unit with wet or damp hands or when barefoot.
- Do not press the buttons on the control panel with anything other than your fingers.
- Do not remove any fixed covers. Never use this appliance if it is not working properly, or if it has been dropped or damaged.
- Never use the plug to start and stop the unit.
- Always use the switch on the control panel to start or shut off the unit.
- Do not cover or obstruct the inlet or outlet grilles.
- Do not use hazardous chemicals to clean or come into contact with the unit. Do not use the unit in the presence of inflammable substances or vapor such as alcohol, insecticides, petrol, etc.
- Do not allow children to operate the unit unsupervised.
- Do not use this product for functions other than those described in this instruction manual.
- Locate the unit where furniture cannot obstruct the air flow.
- Keep blinds/curtains drawn.
- Keep the filters clean.
- Keep doors and windows closed to keep cool air in and warm air out.



IMPORTANT NOTE: Read this manual carefully before installing or operating your new air conditioning unit. Make sure to save this manual for future reference.

EXPLANATION OF SYMBOLS DISPLAYED ON THIS UNIT

	WARNING	This symbol shows that this appliance used a flammable refrigerant. If the refrigerant is leaked and exposed to an external ignition source, there is a risk of fire.
	CAUTION	This symbol shows that the operation manual should be read carefully.
	CAUTION	This symbol shows that a service personnel should be handling this equipment with reference to the installation manual.
	CAUTION	This symbol shows that information is available such as the operating manual or installation manual.

Specifications

Model No.	DR-HDH001S
Power Source	115V~60Hz
Rated Power	850W
Operating Conditions	Temperature: 41~89°F (5~32°C)
	Humidity: <95%RH
Moisture Removal (65°F, 60%RH)	50.0 Pints/Day
Moisture Removal (80°F, 60%RH)	66 Pints/Day
Moisture Removal (86°F, 80%RH)	109 Pints/Day
IEF (65°F, 60%RH)	1.85 liters/kWh

KNOWING YOUR APPLIANCE

02



Please keep the dehumidifier upright for at least 6 hours before using the unit for the first time.

Package Contents

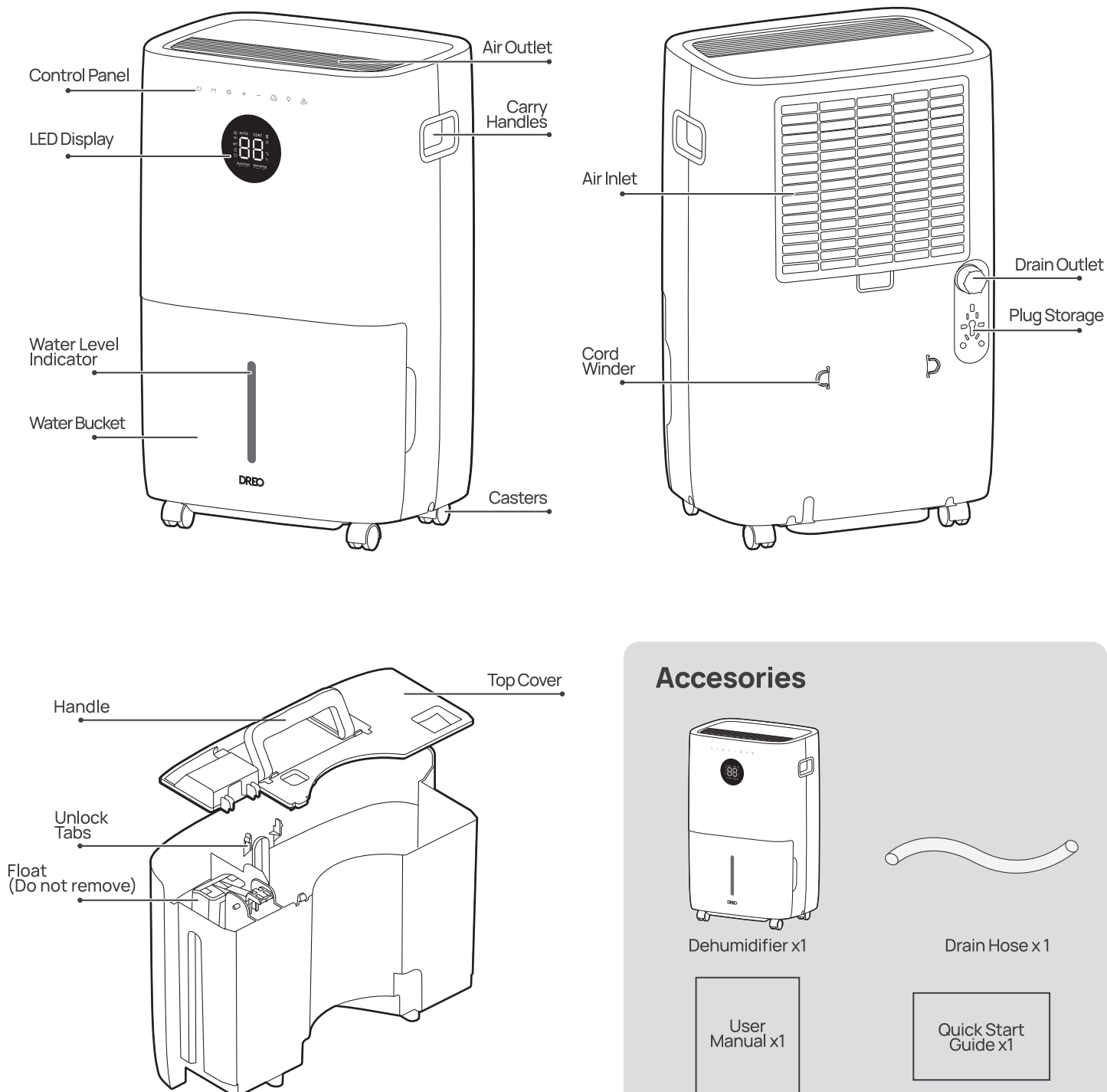

Getting the Most out of This Appliance

1

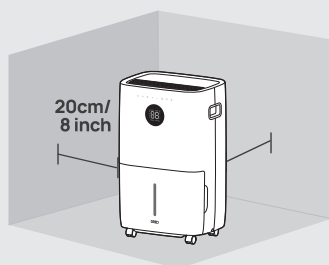

Keep this appliance at least 20 cm/8 inch away from walls for any major obstacles.

2

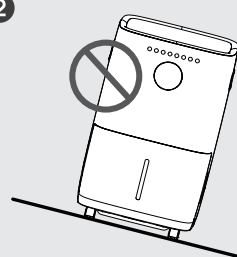

Only use this appliance indoors and on a smooth, level surface.

Note:

- Do not use this appliance in tight environments.
- This appliance works best in 41-89°F environments with a Relative Humidity of 95% or below.
- For safety reasons, after turning off the appliance, there is a 3-minute cooldown before it can be turned back on again.

Control Panel



Power Button

- Turn on/off the appliance.
- Long press for 5 seconds to reset to factory settings.



Mode Button

- Switch between Auto / Continuous Mode.



Fan Speed Button

- Adjust fan speed across 1-3 levels.
- Long press for 5 seconds to reset the Filter Life Indicator.
- When the fan is running at level 3, the dehumidifier works at maximum capacity to reduce moisture and dampness. Once the humidity is lowered to the desired level, switch to level 1 for quieter operation.



Humidity Level Buttons

- Touch \oplus or \ominus to adjust the humidity level (30%-85%, 5% increment).
- When setting a timer, touch \oplus or \ominus to adjust the duration of timer.



Timer Button

- When the appliance is on, touch to set a timer (0-24h) After the timer ends, the appliance will turn off automatically.
- To cancel, set the timer to 0 hour.
- Long press for 5 seconds to start network settings and device pairing.



LED Display ON/OFF

- Touch to turn the LED Display on or off.



Child Lock

- Long press for 3 seconds to activate / deactivate the Child Lock function. When activated, the display will show "LC", and all the buttons on the space heater will be locked.

LED Display

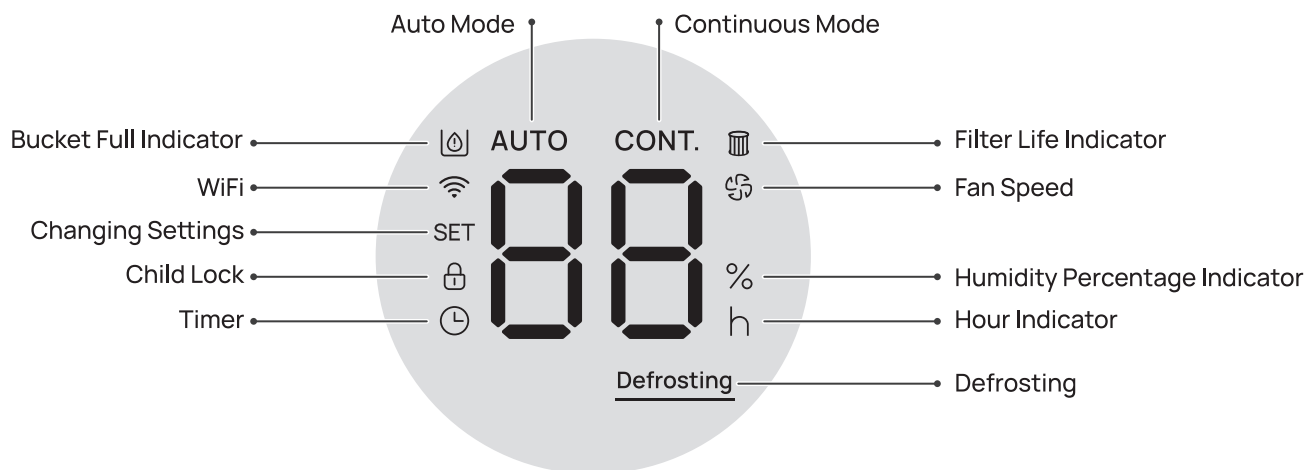

Working Modes

AUTO

Auto Mode

- Change the fan speed level and target humidity to your desired settings at any time (30%-85%, 5% increment). When the target humidity is reached, dehumidification will automatically stop.
- After the compressor stops dehumidifying, the fan will continue to run for 3 minutes to blow out water vapor from the appliance.

CONT.

Continuous Mode

- The dehumidifier runs non-stop until the water bucket is full or it is turned off.
- When continuous mode is enabled, there is no need to set the target humidity, and the fan speed level is locked to 2.

Note: To ensure safe operations, the appliance will go into standby for 8 minutes after running constantly for 8 hours.

Water Drainage

When the water bucket is full, the Water Level Indicator will light up, and the unit will stop operating until the water bucket is emptied and put back in place. There are two ways to empty the water bucket:

Manual Drain

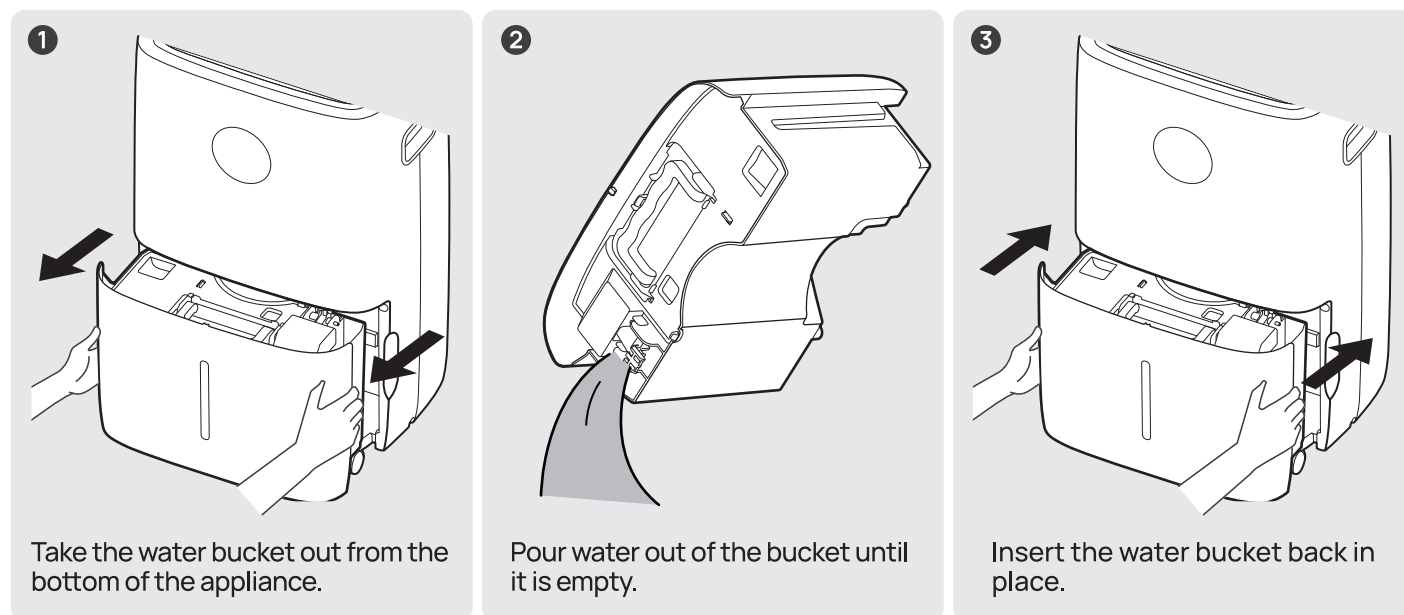

Note: When taking out the water bucket after turning off the appliance, please wait for several minutes to prevent water spills.

Continuous Drain

You can attach a drain hose to the drain outlet on the back of the humidifier to automatically empty water from the appliance. This allows for continuous operation without the need to manually empty the water bucket. Follow the steps below to set this up:

1

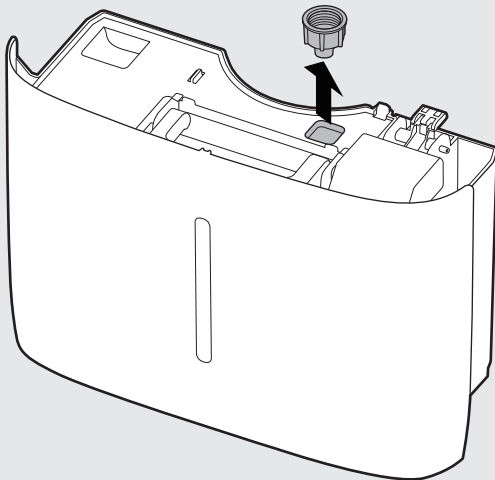

Take out the hose adaptor from the water tank cover.

2

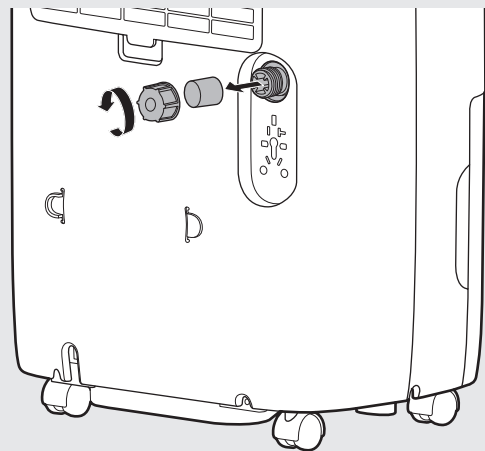

Remove the drain outlet cap.

Note: some water may spill out when taking off the cap.

3

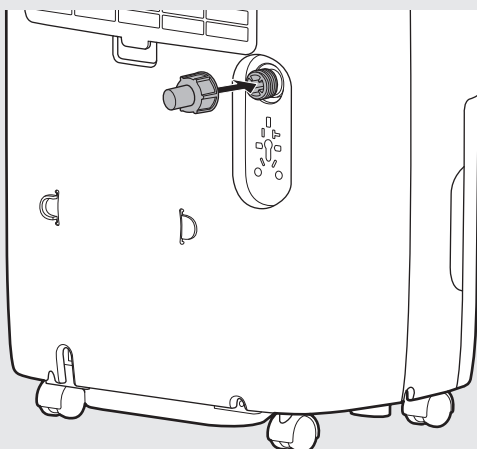

Plug the hose adapter into the outlet.

4

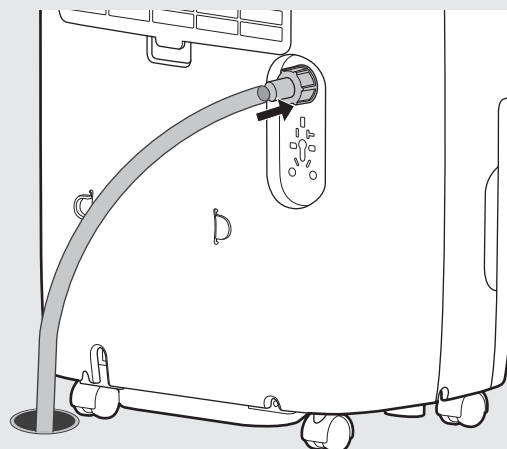

Plug the drain hose onto the adapter and connect the other end to a floor drain.

5



Hose Height Limit

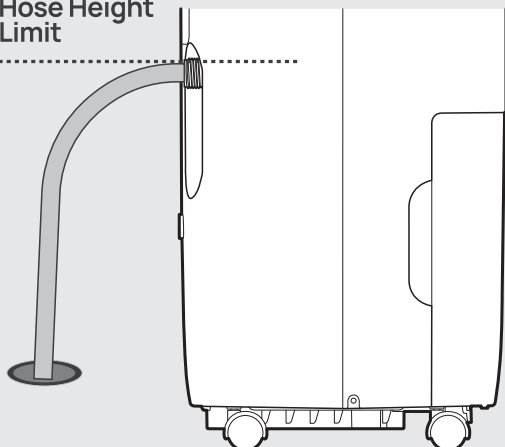

Hose Height Limit

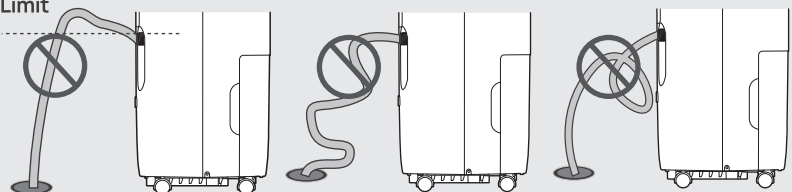

Make sure to straighten any kink or knot on the hose.

Note: The floor drain must not be in a position that is higher than the drain outlet on the dehumidifier.

This appliance supports standard garden hose (GHT) with a thread size of 25.4mm (not included).

Additional Features



Automatic Defrosting

When necessary, the compressor will automatically cycle off the frost build-up on the evaporator coils, and the Defrosting indicator will light up. After defrosting is completed, the compressor will automatically restart and the appliance will resume normal operation.



Timer

When the appliance is ON/OFF, touch the timer button repeatedly to set a timer (0-24h). When the timer ends, the appliance will stop/start running automatically. To cancel, set the time to 0 hour.



Memory

If the appliance is turned OFF or disconnected from power, it will operate under the previous settings (except the Timer setting) when it is turned ON again.



Firmware Update

Check the firmware version on the DREO app and update regularly for the air circulator to work more efficiently.



Display will show "⬆" during the update process. Do not operate until the update is completed.



Mute (Available in the DREO app)

To turn on/off the button sounds of this appliance, please go to the DREO app.

CONNECTING TO YOUR APPLIANCE

04



Before connecting the appliance to your mobile device, please scan the QR code on the left or go to the app store and search "DREO", then select and download the app.



Download on the
App Store



GET IT ON
Google Play

Look for "DH711S" when connecting your new appliance.



You can use the DREO app to connect your appliance to **Amazon Alexa** or **Google Home**. Please follow the in-app instructions to set up your voice assistant.

NOTE: You must create a DREO account to access voice assistants.





Launch DREO and sign in or create account by following in-app instructions.

1

2

Enable Bluetooth on your mobile device and plug in your appliance.



Hold the timer button  for 5 seconds to start WiFi connection settings.
(Tip: The WiFi icon  will keep flashing when pairing.)

3

4

Tap + Add Device and select DH711S.

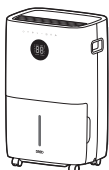

Follow in-app instructions to complete WiFi connection.

5

6

You're now ready to control the appliance on your app.
(Tip: To restart connection settings, hold the timer button  again for 5 seconds)



CLEANING AND MAINTENANCE

05



Scan the QR code to see the cleaning and installation guide:

- Always turn off and UNPLUG the humidifier before any cleaning or maintenance.
- Do not clean the main body under running water.
- Do not let water splash into the air outlets.
- Do not use any chemical agents when cleaning the humidifier.
- Store in a cool, dry place and cover it to protect from dust.
- Do not overfill the humidifier due to the potential risk of electric shock.

Outer Surface

Clean the outer surface using a damp, lint-free cloth and mild detergent. Dry the appliance with a dry, lint-free cloth.



Air Filter

RECOMMENDED ONCE A MONTH

1

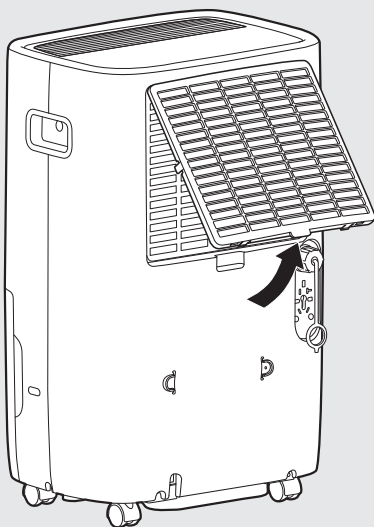

Remove the grill from the back of the unit.

2

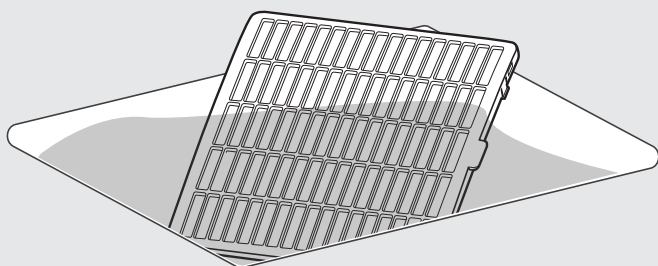

If there is stubborn dirt or dust, immerse in lukewarm water and rinse a couple of times.

3

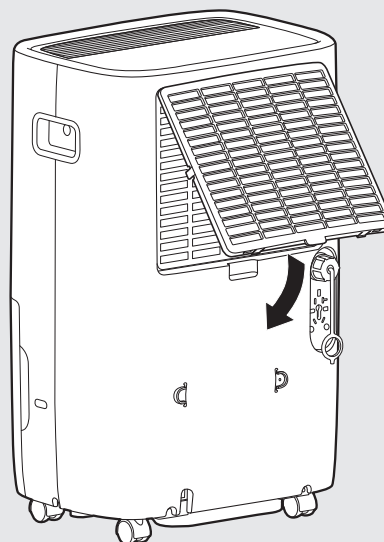

Let the filter dry before re-attaching to the main unit.

Water Bucket

RECOMMENDED ONCE EVERY YEAR

1

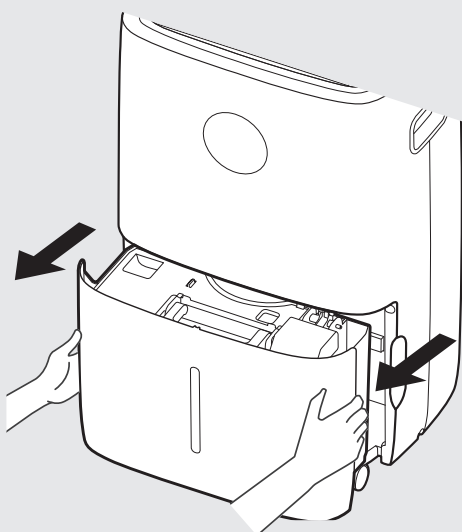

Take the water bucket out from the bottom of the appliance.

2

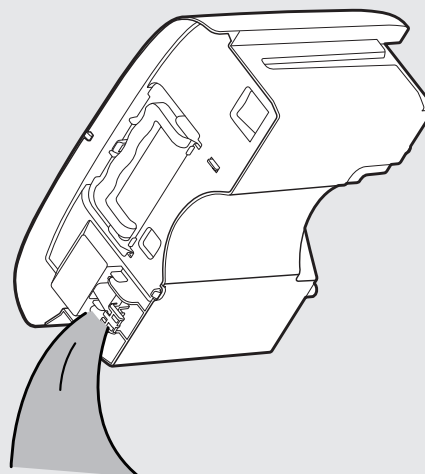

Pour water out of the bucket until it is empty.

3

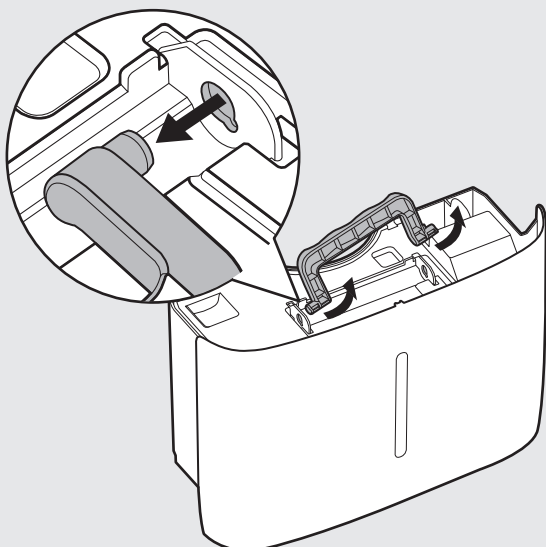

Remove the handle.

4

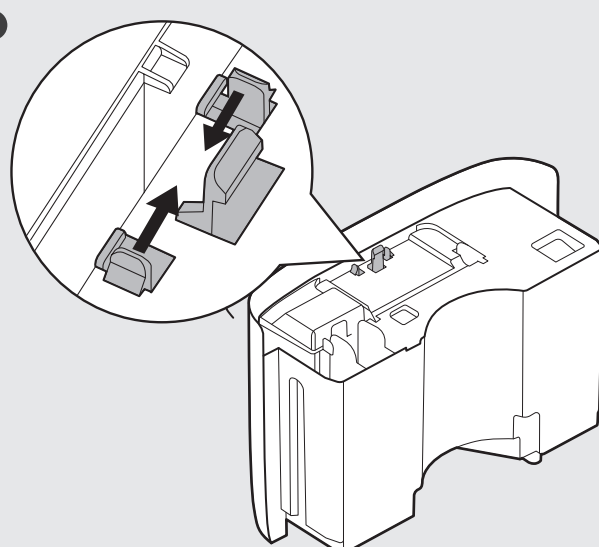

Press the tabs as show in the image.

5

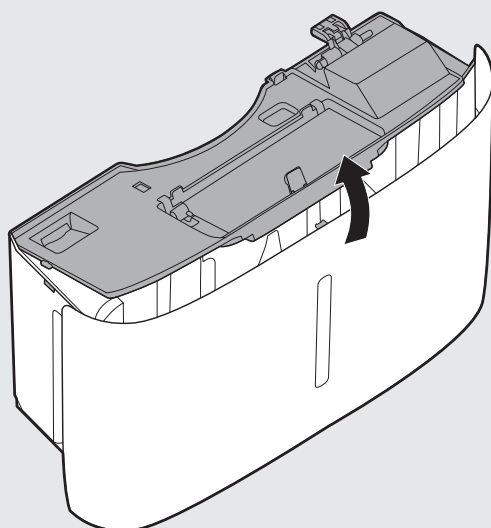

Gradually take the top cover off.

6

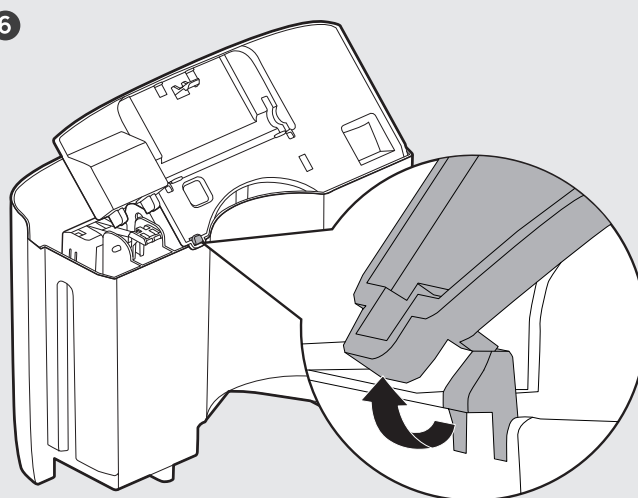

Detach the top cover from the lock to completely remove it.

7

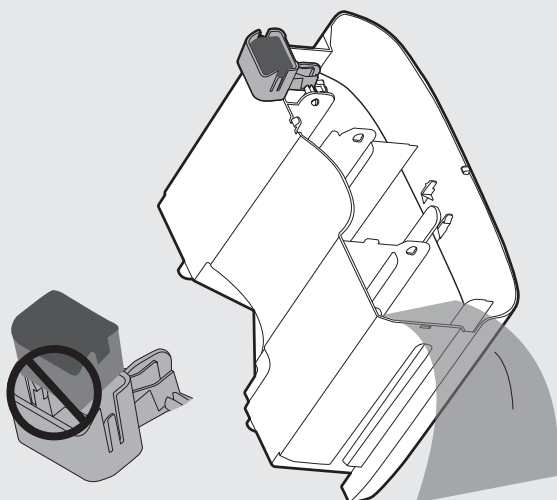

Clean the water bucket and the float under running water. **DO NOT** take the foam out of the float

8

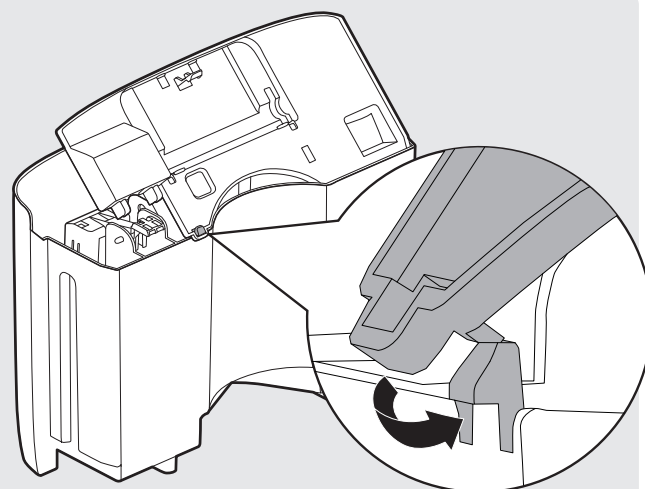

Align the cutouts on the top cover with the sockets on the water bucket.

9

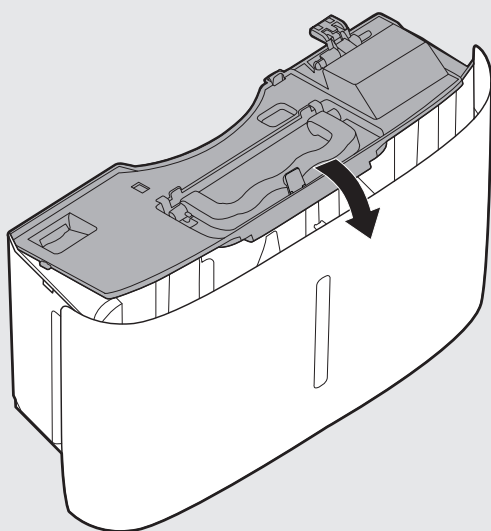

Re-attach the top cover to the water bucket.

10

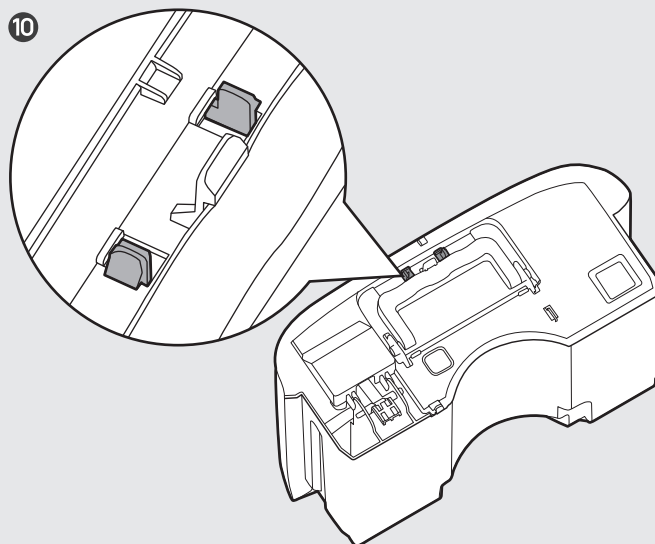

Lock the top cover back in place

11

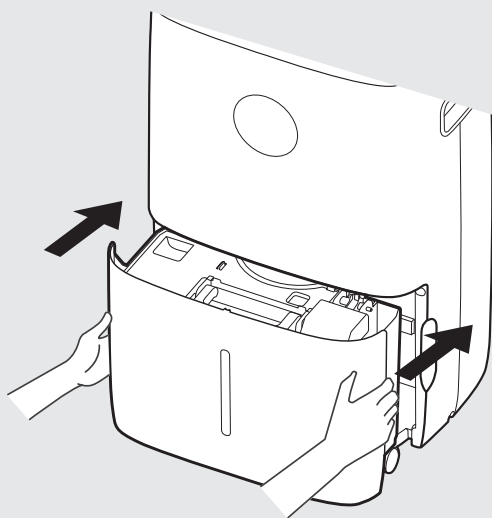

Insert the water bucket back in place.

Problem	Possible Causes & Reason
The dehumidifier does not work	Check if the power plug is firmly connected into the wall outlet.
	Check the house fuse/circuit breaker box.
	The dehumidifier has reached the target temperature in Auto Mode or the water bucket is already full.
	The float in the tank is stuck and is not properly positioned. Push the float down to the lowest position.
	Water bucket is not in the proper position, put it back in place.
The drain hose is leaking water when the dehumidifier	The drain hose is not connected correctly or the other end of the drain hose is blocked, so the water cannot be appropriately discharged.
	Ensure that both ends of the drain hose are unimpeded after connecting the water pipe to the drain outlet. Keeping the drain hose in an inclined state is more conducive to gravity drainage.
Dehumidifier does not dry the air as it should	The time is not enough to remove the moisture.
	The ambient humidity is too low, affecting the performance of dehumidifying.
	Make sure there are no curtains, blinds or furniture blocking the top or back of the dehumidifier.
	The dehumidifier is in Auto Mode and its target humidity is higher than the ambient humidity.
	Check if all doors, windows, and other openings are securely closed.
	Room temperature is too low, below 41°F (5°C). Heat up the room.
	There is water vapor source in the room such as a humidifier.
	The air filter is dirty. Clean the air filter.
The dehumidifier makes a loud noise when running	The air filter may be dirty. Follow the instructions to clean it.
	The dehumidifier is tilted. Put it upright.
	The floor surface is not level.
	Check if the filter is properly positioned.
Frost appears on the coils	This is a normal phenomenon when the dehumidifier is running at low ambient temperature.
	The dehumidifier will automatically start defrosting, and the whole process may take 15 to 20 minutes. When the dehumidifier completes defrosting, it will automatically restart dehumidifying.
Water on the floor	The hose port may be loose.
	Intended to use the bucket to collect water, but the drain outlet cap is not in place.
The dehumidifier produces a strange noise when it is turned on	The refrigerant may not be stable yet. Keep the device working for an hour and observe whether the strange noise has disappeared.

If your problem is not listed or still persists, please contact our Customer Support (see page 15)

Default 12-Month Warranty

This appliance is covered by DREO warranty for 12 months from the date of its original purchase.

Extend Your Warranty

Extend your warranty by registering your new appliance on our website

<https://dreo.com/warranty>

The warranty will not apply in cases of:

1. Accident, misuse, or repairs performed by unauthorized personnel.
2. Any unit that has been tampered with or used for commercial purposes.
3. Normal wear and tear of wearable parts.
4. Use of force, damage caused by external influences.
5. Damage caused by non-observance of the User Manual, e.g. connection to an unsuitable mains supply or noncompliance with the instructions.
6. Partially or completely dismantled appliances.
7. Defects caused by or resulting from damages from shipping or from repairs, service, or alteration to the product or any of its parts that have been performed by a repair person not authorized by DREO.

We can only provide after-sales service for products that are sold by DREO or DREO authorized retailers and distributors. If you have purchased the appliance from a different place, please contact your seller for return and warranty issues.

FCC Statement

This device complies with Part 15 of the FCC Rules. Operation is subject to the following two conditions: (1) this device may not cause harmful interference, and (2) this device must accept any interference received, including interference that may cause undesired operation.

Please note that changes or modifications of this product is not expressly approved by the party responsible for compliance could void the user's authority to operate the equipment.

NOTE: This equipment has been tested and found to comply with the limits for a Class B digital device, pursuant to Part 15 of the FCC Rules. These limits are designed to provide reasonable protection against harmful interference in a residential installation. This equipment generates, uses and can radiate radio frequency energy and, if not installed and used in accordance with the instructions, may cause harmful interference to radio communications. However, there is no guarantee that interference will not occur in a particular installation.

If this equipment does cause harmful interference to radio or television reception, which can be determined by turning the equipment off and on, the user is encouraged to try to correct the interference by one or more of the following measures:

- Reorient or relocate the receiving antenna.
- Increase the separation between the equipment and receiver.
- Connect the equipment into an outlet on a circuit different from that to which the receiver is connected.
- Consult the dealer or an experienced radio/TV technician for help."

This equipment complies with FCC radiation exposure limits set forth for an uncontrolled environment. This equipment should be installed and operated with a minimum distance of 20cm between the radiator & your body. This transmitter must not be co-located or operating in conjunction with any other antenna or transmitter.

Model No.: DR-HDH001S
Rev_1.0_EN

We're Here to Help!

 (888) 290-1688 Mon - Fri, 9:00 am-5:00 pm PST/PDT

 support@dreo.com

 www.dreo.com

 Shenzhen Hesung Innovation Technology Co., LTD

 26F, Bldg A7, Creative City, Shenzhen, China



MADE IN CHINA

www.dreo.com

Looking for help?

Contact us to get expert support.



support@dreo.com



[\(888\) 290-1688](tel:(888)290-1688)



www.dreo.com

Mon - Fri, 9:00 am-5:00 pm PST/PDT