

Quick installation guide

Model:U11

1.Panel Layout

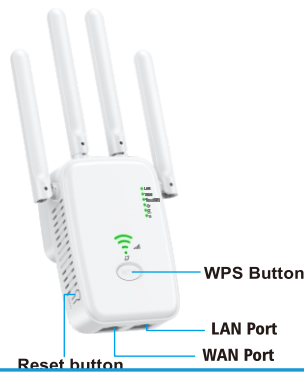

LED Explanation

Name	Status	Indication
	Red	Power indicator
	On	The 2.4GHz wireless band is enabled.
	Off	The 2.4GHz wireless band is disabled.
	Blinking Blue	WPS connection is in process. This may take up to 2 minutes.
	Blinking Blue	The extender is connected to the Internet.
	Solid orange	The U11 router is connected to the Host router, but is too far away from the Host router.
	Solid green	The U11 router is connected to the router, and is in a good location.
	Blinking green	One powered-on device is connected to the router's LAN / WAN port.
	Off	No powered-on device is connected to the router's LAN / WAN port.

Button and port Explanation

Item	Description
Reset Button	Pressand hold this button for more than 5 seconds to reset the router to its factory default settings.
WPS Button	Pressthis button to enable the WPS function.
LAN / WAN port	For connecting to a DSL/Cable modem, or an Ethernet jack.

WiFi Repeater mode

In this mode, the router boosts the existing wireless coverage in your home.

1 Connect Your Router

Plug the extender into an electrical outlet near your host router, and then wait until the LED is on and then off.

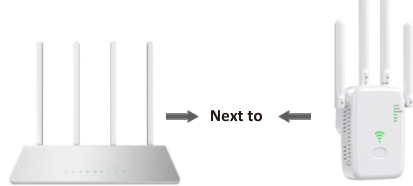

2 Configure repeater mode

Method ONE Using WPS (Wi-Fi Protected Setup)

Using WPS is an easier way to extend your host network. You are recommended to use this method if your host router has the WPS button. The button might look like one of these: . If not, please refer to **Method Two**.

Connect

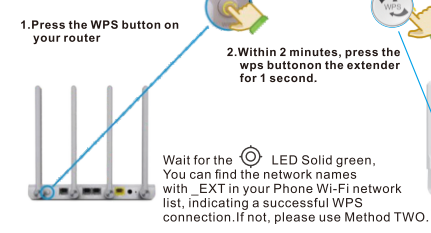

Relocate

- 1.Plug the extender into an electrical outlet between your router (Host Network) and the Wi-Fi "dead" zone. The location you choose must be within the range of your existing host network.
2. Wait until the LED is lit and solid Green. If not, relocate it closer to the router to achieve a good (or better) signal quality.

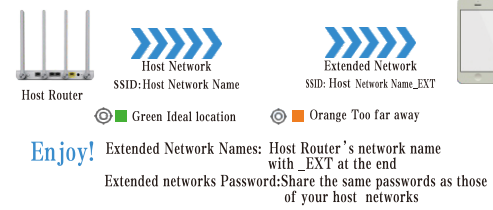

Enjoy! Extended Network Names: Host Router's network name with _EXT at the end
Extended networks Password:Share the same passwords as those of your host networks

Method TWO Using a Web Browser

For Mobile phone users

- 1.Find the SSID(Network Name) printed on the label of the U11 router.
- 2.Connect your Mobile phone to the U11 router's network

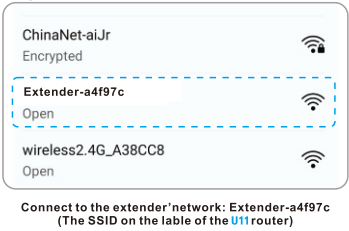

Connect to the extender's network: Extender-a4f97c
(The SSID on the label of the U11 router)

3 Mode selection

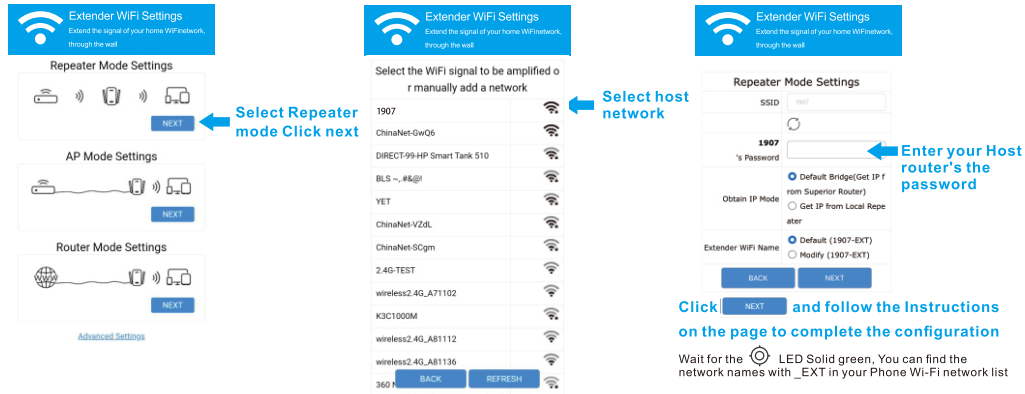

Relocate

- 1.Plug the extender into an electrical outlet between your router (Host Network) and the Wi-Fi "dead" zone.

The location you choose must be within the range of your existing host network.

2. Wait until the LED is lit and solid Green. If not, relocate it closer to the router to achieve a good (or better) signal quality.

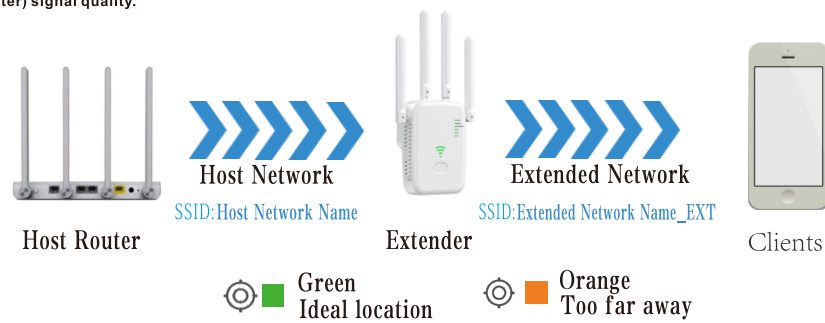

Enjoy!

Extended Network Names: Host Router's network name with _EXT at the end, but may have different SSIDs (network names) if you have customized them during the configuration.
Extended networks Password:Share the same passwords as those of your host networks.

Frequently Asked Questions(FAQ)

Q1. What can I do if the login window does not appear?

- If the computer is set to a static or fixed IP address, change the setting to obtain an IP address automatically.
- Verify if http://192.168.11.1 is correctly entered I in the web browser.
- Make sure your computer is connected to the Mini Router's network.
- Use another web browser and try again.
- Reboot your router and try again.
- Disable the network adapter used currently and then enable it again.

Q2. What can I do if I cannot access the Internet?

- Check if the internet is working properly by connecting a computer directly to the modem via Ethernet cable. If not, connect your internet provider.
- Reboot your router and try again.

Q3. How do I restore the router to its factory default setting?

- While the router is powered on, press and hold the reset button on the rear panel of the router for approximately 5 seconds.

Q4. Why set the repeater mode is unsuccessfully?

- You may have typed in the router's wireless password incorrectly, please log in and check the wireless password.
- The Mini router may be out of range, please move it closer to the router.
- Please reset the Mini Router and go through the configuration again.

A. If you need reset the extender. You need press and hold the reset button inside the tiny hole for 10 seconds.

AP mode

In this mode, the router transforms your existing wired network to a wireless.

1.Connect Your Router

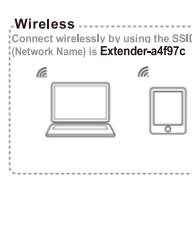
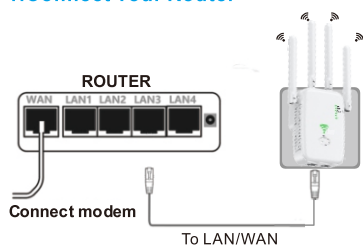

2.Connect to the U11 router

- 1.Find the SSID(Network Name) printed on the label of the U11 router.
- 2.Connect your Mobile phone to the U11 router's network

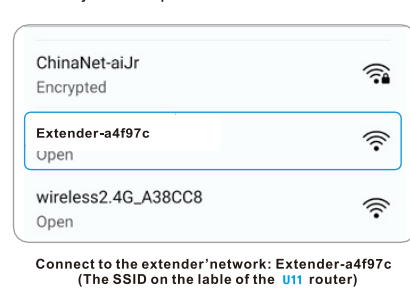

Connect to the extender's network: Extender-a4f97c
(The SSID on the label of the U11 router)

3. Mode selection

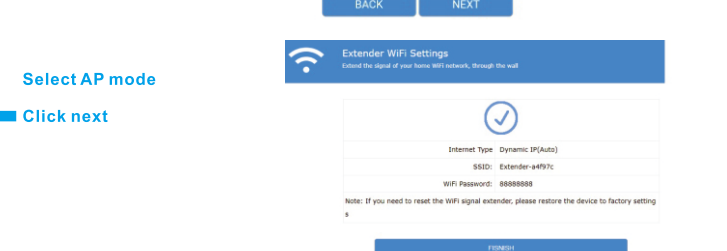
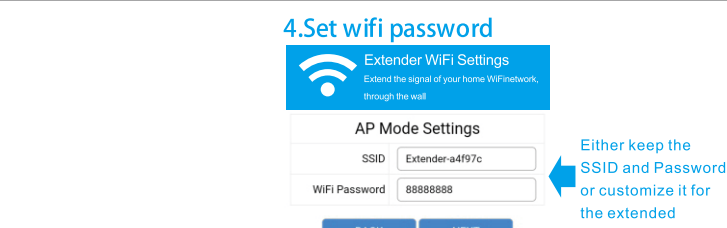
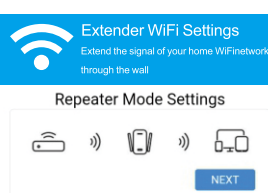

5.Device restart



Note:
Setup is complete, reconnect to the network after 30s.
Please check the signal indicator status of the extender when using it.

Frequently Asked Questions(FAQ)

Q1. What can I do if the login window does not appear?

- If the computer is set to a static or fixed IP address, change the setting to obtain an IP address automatically.
- Verify if http://192.168.11.1 is correctly entered I in the web browser.
- Make sure your computer is connected to the Mini Router's network.
- Use another web browser and try again.
- Reboot your router and try again.
- Disable the network adapter used currently and then enable it again.

Q2. What can I do if I cannot access the Internet?

- Check if the internet is working properly by connecting a computer directly to the modem via Ethernet cable. If not, connect your internet provider.
- Reboot your router and try again.

Q3. How do I restore the router to its factory default setting?

- While the router is powered on, press and hold the reset button on the rear panel of the router for approximately 5 seconds.

Q4. Why set the repeater mode is unsuccessfully?

- You may have typed in the router's wireless password incorrectly, please log in and check the wireless password.
- The Mini router may be out of range, please move it closer to the router.
- Please reset the Mini Router and go through the configuration again.

A. If you need reset the extender. You need press and hold the reset button inside the tiny hole for 10 seconds.

Router mode

1.Connect Your Router

If your Internet connection is through a DSL/Cable modem, follow steps 1, 2 and 4 to complete the hardware connections.

If your Internet connection is through an Ethernet cable from the wall, follow steps 3 and 4 to complete the hardware connections.

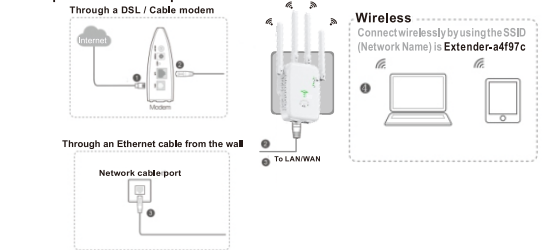

2.Connect to the U11 router

- 1.Find the SSID(Network Name) printed on the label of the U11 router.
- 2.Connect your Mobile phone to the U11 router's network

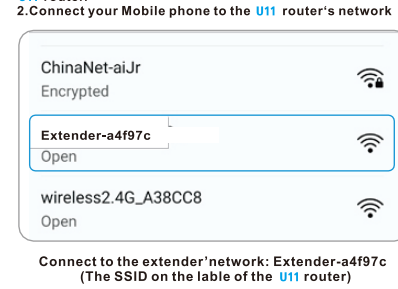

Connect to the extender's network: Extender-a4f97c
(The SSID on the label of the U11 router)

3. Mode selection

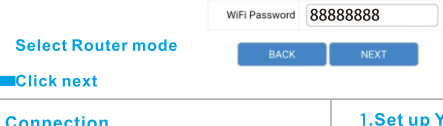
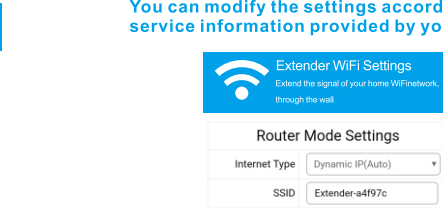
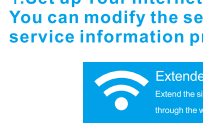
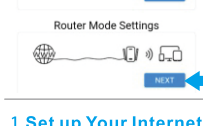
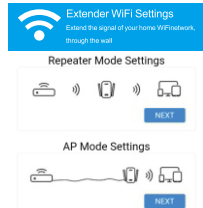

- 1.Set up Your Internet Connection
You can modify the settings according to the service information provided by your ISP.

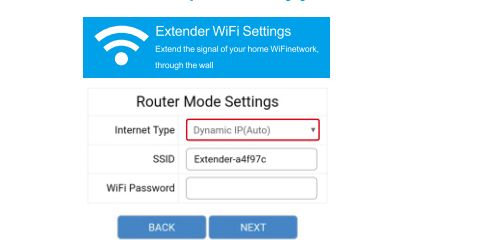

2. If you choose Static IP, enter the information provided by your ISP in the corresponding fields.

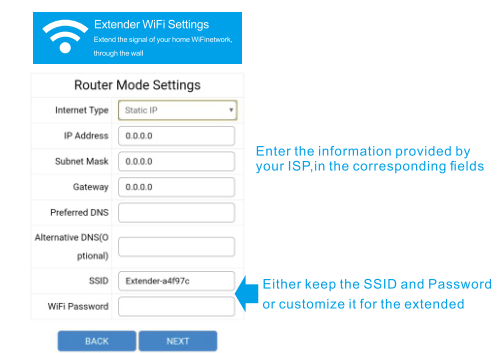

Click **NEXT** and follow the prompts on the page to complete the Router mode configuration

4.Set up Your Internet Connection

You can modify the settings according to the service information provided by your ISP.

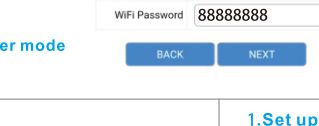
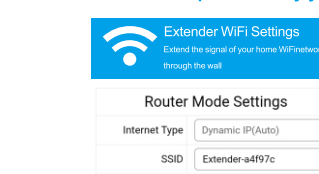

- 1.Set up Your Internet Connection
You can modify the settings according to the service information provided by your ISP.

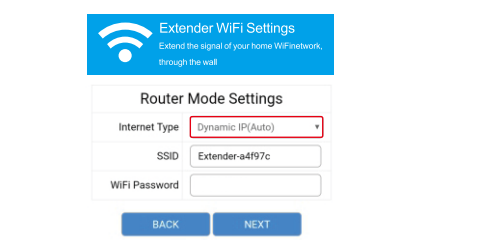

2. If you choose PPPoE, enter the username and password provided by your ISP. PPPoE users usually have DSL cable modems.

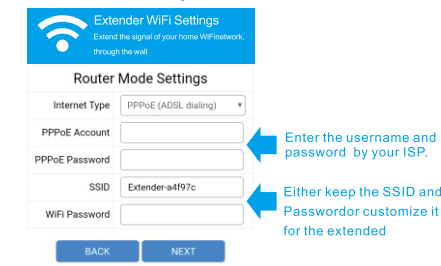

Click **NEXT** and follow the prompts on the page to complete the Router mode configuration

Enjoy! Connect to the Extended networks (default SSID and password) and enjoy internet, but may have different network name and password, if you have customized them during the configuration.

FCC Warning:

This equipment has been tested and found to comply with the limits for a Class B digital device, pursuant to part 15 of the FCC Rules. These limits are designed to provide reasonable protection against harmful interference in a residential installation. This equipment generates, uses and can radiate radio frequency energy and, if not installed and used in accordance with the instructions, may cause harmful interference to radio communications. However, there is no guarantee that interference will not occur in a particular installation. If this equipment does cause harmful interference to radio or television reception, which can be determined by turning the equipment off and on, the user is encouraged to try to correct the interference by one or more of the following measures:

- Reorient or relocate the receiving antenna.
- Increase the separation between the equipment and receiver.
- Connect the equipment into an outlet on a circuit different from that to which the receiver is connected.
- Consult the dealer or an experienced radio/TV technician for help.

Caution: Any changes or modifications to this device not explicitly approved by manufacturer could void your authority to operate this equipment.

This device complies with part 15 of the FCC Rules. Operation is subject to the following two conditions:

(1) This device may not cause harmful interference, and (2) this device must accept any interference received, including interference that may cause undesired operation.

This equipment complies with FCC radiation exposure limits set forth for an uncontrolled environment. This equipment should be installed and operated with minimum distance 20cm between the radiator and your body.