

DNG-RMCB-01/02/03

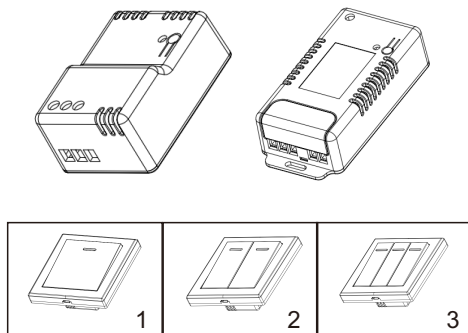

- It requires professionals with electrician operation qualifications to do the installation.
- It is forbidden to install the controller in a place where it is easy for people to touch.
- Besides preparing various tools before installation, you also need to read the installation precautions in detail.
- After unpacking, please do not place the product in the hot, humid, dusty and greasy place for a long time.
- There is a lifespan for the remote control battery. If you find that you need to press the switch multiple times to make it work, it means that the battery is insufficient and you need to replace the battery with the same specification.

- ① The power supply should be cut off before installing the controller to avoid electric shock.
- ② The wire interface must be connected correctly.
- ③ The controller should not be installed in places near to heat source, high-frequency transformer, or magnet, so as not to affect its normal use.
- ④ If the controller is installed on the top of the ceiling, fix it with the bottom facing upwards.
- ⑤ If the controller is installed in a metal box, the receiving antenna needs to be led out of the metal shell with a piece of wire, and the exposed length is not less than 30cm.
- ⑥ This controller cannot be used beyond the load power (normally less than 500W is appropriate).
- ⑦ The wiring ports are connected according to L, L1, L2, N, N1 (refer to the figure).

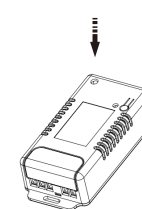
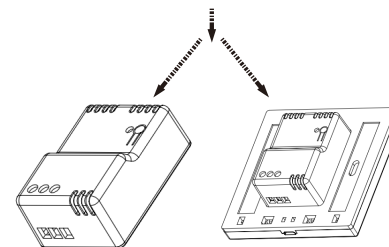

1. After connecting the controller wiring port and power on, press the button on the controller, if the light will turn on once and then go out, it means that the controller is working normally and is in the standby state:

2. The remote controller and the controller are paired with devices (a controller can support 20 remote control commands)
 - ①Single-channel controller: Press the button on the controller twice, wait for the red light to turn on, and then press the button on the remote control, if the pairing is fine, the light will immediately go out;
 - ②Two-way controller: L1 operates according to method ① L2 setting: press the button on the controller 3 times, wait for the red light to turn on, and then press the button on the remote control, if the pairing is fine, light will immediately go out;
 - ③Two-way controller: Press the button on the controller 4 times, wait for the red light to turn on, and then press the button on the remote controller, the light will go out immediately if the pairing is fine. This mode is the L1+L2 two-way synchronous opening or synchronous closing.
 - ④If the setting is unreasonable and the buttons need to be redistributed, press the key of the controller 8 times to clear the setting parameters.

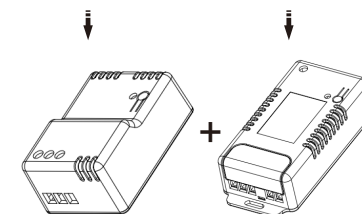

Model name	DNG-RMCB-01/02/03
Plastic material	ABS(UL94-V0 & Rohs)
AC Input power	Ac90 ~ 260V
AC Output power	< 500W
DC Input power	DC12V/300mA(±1V)
DC Output power	< 150W
Standby power	< 0.13W
Receiving Frequency	433MHz
Receiving range	20~50m
Application environmen	Indoor+Shield (-30 ~ 60deg)

This device complies with part 15 of the FCC Rules. Operation is subject to the following two conditions: (1) this device may not cause harmful interference, and (2) this device must accept any interference received, including interference that may cause undesired operation.

Any changes or modifications not expressly approved by the party responsible for compliance could void the user's authority to operate the equipment.

NOTE: This equipment has been tested and found to comply with the limits for a Class B digital device, pursuant to Part 15 of the FCC Rules. These limits are designed to provide reasonable protection against harmful interference in a residential installation. This equipment generates, uses and can radiate radio frequency energy and, if not installed and used in accordance with the instructions, may cause harmful interference to radio communications. However, there is no guarantee that interference will not occur in a particular installation.

If this equipment does cause harmful interference to radio or television reception, which can be determined by turning the equipment off and on, the user is encouraged to try to correct the interference by one or more of the following measures:

- Reorient or relocate the receiving antenna.
- Increase the separation between the equipment and receiver.
- Connect the equipment into an outlet on a circuit different from that to which the receiver is connected.
- Consult the dealer or an experienced radio/TV technician for help.

The device has been evaluated to meet general RF exposure requirement. The device can be used in portable exposure condition without restriction